

LYNN COUNTY NEWS.

VOLUME 6, NUMBER 45

TAHOKA, LYNN COUNTY, TEXAS, FRIDAY, JUNE 24, 1910

\$1.00 PER YEAR IN ADVANCE

Mrs. H. O. CRIE, Editor

THE OFFICIAL ORGAN OF LYNN COUNTY

H. C. CRIE, Manager

O'DONNELL'S CAMPAIGN

HON. T. J. O'DONNELL FORMALLY OPENS HIS CAMPAIGN AT COURT HOUSE

MONDAY JUNE TWENTIETH

His Friends Were Well Pleased And His Enemies Were Thoroughly Surprised

T. J. O'Donnell, our candidate for Representative for this the first District, formally opened his campaign at the court house here Monday afternoon at half past three o'clock.

Mr. O'Donnell spoke on his platform as printed, going into detail and explaining his position and opinions, more fully.

He spoke at length on the instability of our railroad laws, that work against the development of our state. He explained how even a bad law that would stand for a number of years was better than a good law that was likely to be repealed or changed without notice. "What the railroads want," said Mr. O'Donnell, "are laws that can be depended on."

He stated that he was not only a prohibitionist in theory but also in practice, being a teetotaler when it came to spirituous liquors. He believes in submission, in constitutional prohibition if possible, or failing in that, in statutory laws. But whatever form is used he believes in the rigid enforcement of any and all laws. And in this connection he advocates retaining the Rangers, so that when the local authorities can not or will not enforce the laws, there will be a way to enforce them.

Mr. O'Donnell's speech pleased his friends and astonished his enemies by the force, power and mental capacity shown. All good citizens of whatever party can join together and vote for him without any misgivings as to his suitability for the high office to which he aspires. With a majority of men in the Legislature like O'Donnell, the next one will be a great improvement over the present one.

NOTICE.

H. C. Mayes, who was a member of the Tahoka Mercantile Co., has sold his interest to W. W. Mayes who is the sole owner and who will pay all bills and collect all accounts.

Tahoka mercantile Co.
Tahoka Texas
June 10, A. D. 1910 45-2t

Life is real, life is earnest, and the grave is not the goal; every dollar that thou tustest helps to make the old town roll. But enjoyment and not sorrow is our destined end or way; if you have no money, borrow—buy a corner lot each day! Lives of great men all remind us we can win immortal fame; let us leave the chumps behind us and we'll get there just the same. In this world's bread battle, in the bivouac of life, let us make the dry bones rattle—buy a corner for your wife! Let us then be up and doing with a heart for any fate; still achieving, still pursuing, boosting early, boosting late.

A moderately fond father discovered his young hopeful reading a dime novel.

"Unhand me, villain, the detested boy thundered, "or there will be bloodshed!"

"No," said the father grimly, tightening his hold on his son's collar. "Not bloodshed—woodshed."

Manufacturing

The factory is the farmers' market house and he must travel until he reaches it and pay the freight all the way. Building factories in Texas to manufacture the raw material we produce, will increase the market value of farm products \$150,000,000 per annum. The farms of Texas produce annually \$527,905,000 of raw material for the factory and of this amount \$75,905,000 is manufactured in the state and \$452,000,000 is shipped to other countries. The cut shown below clearly exhibits the proportion of raw material manufactured and shipped out of the state.

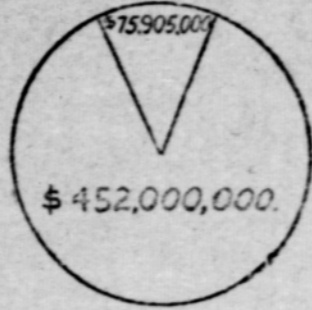

"Texas Manufactures."

A few general rules governing manufacturing are of interest in this connection. As a rule the factory doubles the price of the raw material. A factory investment of \$2,000 gives employment to one man. One factory laborer creates \$1,300 of wealth annually. These are general averages and may not apply in every specific instance. We need a billion dollars invested in factories to manufacture the raw material we ship out of the state. The advantages of the factory may well be illustrated by the bale of cotton, and what we say of cotton applies with equal force to most all products. Texas produces a bale of cotton valued at \$50. This cotton is shipped to England and manufactured into cotton goods and its value doubled or \$100 added to it. The finished product is shipped back to Texas and at the port of entry the Federal Government levies a tariff of \$50 per bale making a total value of \$150 per bale instead of \$50 as at present.

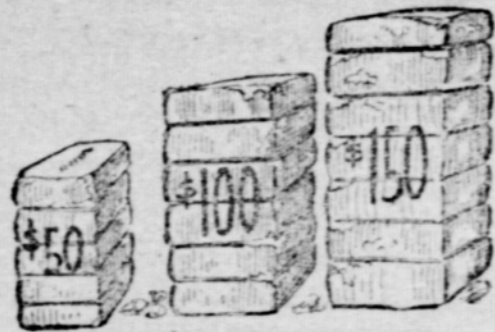

"Increased Value of Manufactured Bale of Cotton."

If Texas manufactured all her cotton, we would save the transportation expense, import duty and the manufacturing expense would remain at home. We would then get \$150 per bale for cotton instead of \$50 as at present multiplying our prosperity and commercial importance. We manufacture one bale out of every 70 bales produced in the state. Texas needs cotton factories. The cotton manufacturer employs cheap labor but so must the cotton farmer and if we are going to be a manufacturing country we must manufacture the things we produce, says the Texas Commercial Secretaries' Association.

Rev. A. E. Estes baptised the following persons in the Will Montgomery tank about two miles north-west of town Tuesday June 21st in the afternoon:

Mr. and Mrs. J. H. Harrison, Virga Davis, Vivian Estes, Nellie Honea and Rescola McDaniel.

S. S. Ramsey and son, of Grandview, Texas, came in on the train last Saturday and will make their home in Tahoka from now on. Mr. Ramsey has purchased lots 13, 14, 15, 16, in block 48 in North Tahoka, and will at once begin the erection of a \$3,000 residence. We call attention to the advertisement of Ramsey & Ramsey, Contractors and Builders, to be found elsewhere in this paper. They are certainly starting in right and deserve a liberal share of the work to be done here.

Hall & Majors had a car of coal come in this week which they are delivering at \$9.50 per ton, a saving of \$6 on every ton from what it cost when hauled from Lubbock, and \$12 a ton when it had to be hauled Plainview or Big Springs. Yep, railroad helps some.

Belton Howell and his mother Mrs. S. H. Howell are improving slowly.



Evangelist Rev. Abe Mulkey WILL BEGIN A MEETING HERE JULY 22. COME OUT

We, the undersigned citizens of Tahoka and vicinity, join in an invitation to Evangelist Abe Mulkey to come over and help us in Tahoka's Co-operative meeting beginning July 22nd, continuously for ten days.

C. M. Whipp,
M. M. Herring,
S. N. McDaniel,
J. B. Walker,
J. E. Ketner,
H. C. Burk,
Arthur Black,
O. T. Bryant,
J. W. D. Davis,
H. C. Crie,
J. Harry Binkley,
S. N. Weathers,
R. D. Mortis,
A. B. McLoud,
B. H. Black,
W. P. Phenix,
C. C. Whipp,
J. A. Hutto,
W. D. Nevels,
I. P. Metcalf,
B. B. Stice,
C. T. Shook,
Thomas Bros. & Co.,
Dr. W. A. Womack,
E. T. Payne,
W. E. Reed,
K. D. Jones,
J. H. Edwards,
W. R. Duncan,
P. B. Hall.

"Nellie," said the teacher of the drawing class, "you may tell us how to make a Maltese cross."
"Step on its tail," answered Nellie promptly.

Agentman from the East, while traveling through Arizona, noticed the dry, dusty appearance of the country.

"Does it ever rain around here he asked one of the natives.

"Rain?" replied the native, "why pardener there's a bullfrog in this yere town over five years old that hain't learned to swim yet.

Some people are never satisfied. For example, a prisoner complained of the magazines that the prison angle brought him to read.

Nutt, n but continued stories," he grumbled, "and me to be hung next Tuesday."

O. M. Wylie,
B. H. Robinson,
J. L. Russell,
J. D. Donaldson,
E. D. Skinner,
S. C. McCrawley,
C. E. Brown,
J. E. Stokes,
A. J. DeBoard,
J. A. Elliott,
Mr. Ethel Robinson,
Mrs. R. J. Roberts,
J. W. McGill,
G. R. Milliken,
H. B. Howell,
Frank Forry,
Fred McDaniel,
I. S. Doak,
B. L. Hill,
R. A. Chambers,
G. W. Small,
D. T. Rogers,
J. Macfarlane,
J. W. McReynolds,
H. M. Larkin,
G. W. Perryman,
T. M. Bartley,
Jack Alley,
Jno. E. Marrs.

The cordial unanimity of the signers to this invitation indicates that this meeting will be well attended and that undoubtedly great interest will be manifested by all. It is hoped that much permanent good will result and Bro. Doak may be made to feel that his labors are not without reward.

Mr. and Mrs. Sumner Clayton who have been sick for some weeks are improving slowly.

We are pleased to be able to report Mrs. B. H. Black as improving after her relapse.

Attention is called to the quarter page advertisement of Wells & Welch elsewhere in this paper. Whenever they advertise a "Sale" there is something doing.

T. J. Blankenship and daughter Gertrude, left for Guthrie, King county, Wednesday, where they will visit friends and relatives, going from there to Paducah, Cottle county, after Mrs. Blankenship's sister Mrs. L. E. Davidson who will move to the Plains.

The first car of mixed freight came in Thursday.

Markets

It is as important to properly market as it is to properly raise farm products. We are a producing country and therefore interested in markets and market facilities for our products. The world's average is two acres of cultivated land per capita while in Texas we have seven acres of cultivated land per capita leaving a surplus production of five acres of cultivated land for each individual which must be sold. The world's average in consumption of cotton is thirteen bales per 1,000 population; in Texas we raise one thousand bales of cotton per one thousand population or one bale per capita. We have a surplus production of 987 bales of cotton per one thousand population for sale. Texas produces 20 per cent of the cotton of the world and on a per capita basis uses one fourth of one per cent. We not only produce a large surplus but, through lack of diversification, concentrate our production—making a deficit in certain lines of production, equally as abnormal as our surplus production in other lines. We are a people of producers and interested in receiving a high price for our products. An increase of one cent per pound in the market price of cotton on 1908 basis of production will place in the hands of the Texas producers of cotton \$20,000,000 and take out of the pockets of the Texas consumers of cotton goods \$250,000 leaving a trade balance of \$19,750,000 in our favor, says the Texas Commercial Secretaries' Association.

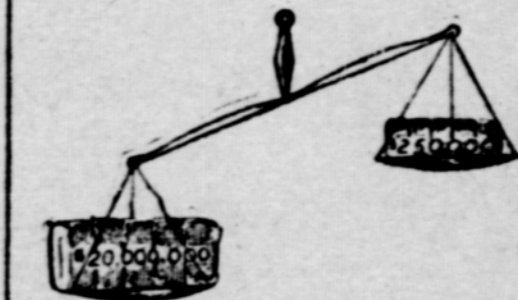

"Balance in Favor of Texas Producer."

Our prosperity depends upon the producer getting a high price for his products. The Farmers Associations, Fruit and Truck Growers Associations and all organizations and influences that tend to raise the price of products should be encouraged by all the people.

Texas is more seriously in need of factories than perhaps any other state in the union. Our principle products are cotton and cattle and the entire output of the cotton field and the ranch must pass through the factory before it is consumed. The Texas farmers ship \$1,200,000 of raw material daily to the factories out side the state and buy a portion of this back as a consumer.

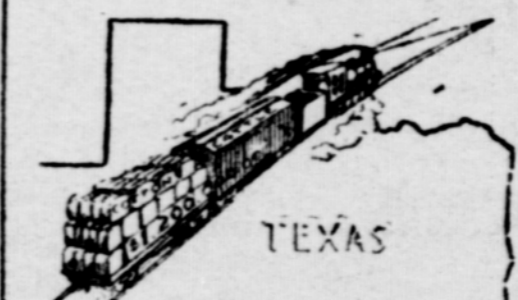

"Raw Material Leaving Texas Daily."

The farmer must pay the freight to the factory and although his products may cross the ocean he must foot the bill every mile of the way. By moving the factory to Texas we move the market to Texas, and eliminate the expense of transportation.

Nothing more clearly expresses the sentiment of Harvard college men in seasons of athletic rivalry, than the time honored battle cry, "To Hell with Yale."

Once, when Dean Brigs, of Harvard and Edward Everett Hale were on their way to witness a game of foot ball between the two colleges, a friend asked:

"Where are you going, Dean?"
"To yell with Hale," answered Brigg with a meaning smile.

E. I. Johnson, of Winfield, Kansas, came in last week and has been visiting with T. G. Marks, of Pride. Mr. Marks' father who also lives at Winfield, was out here on a visit last fall and after he returned home mentioned The News to Mr. Johnson who wrote for it and from what Mr. Marks told him and what he read in The News Mr. Johnson was induced to come here on a prospecting tour. He says that we have not exaggerated conditions and opportunities here in the least and that he is well pleased with Lynn county and thinks likely he will locate here.

Moral: Send the Lynn County News to your friends and relatives if you want them to come out here to live near you.

DOINGS AT THE CAPITAL

SPECIAL ELECTIONS TO BE HELD AT PRIMARIES TO FILL VACANCIES

THE FILE RATING LAW

Has Its Friends As Well As Its Enemies And Its Repeal Will Be Stubornly Fought

Austn, Texas, June 20, 1910.

The Comptroller has received the following estimates of taxable values of counties over the State:

Wheeler county Values, \$3,387,945; increase, \$134,660.

Dallas County Values, \$6,357,800; increase, \$201,888.

Kendall county Values, \$3,200,298; increase, \$64,021.

The Comptroller received the estimate of the taxable value of the rolling stock of the International & Great Northern Railway \$2,394,727 for the entire road.

Governor Campbell has issued the proclamation calling for a special election in nine Representative district and three senatorial districts July 23 to fill vacancies caused by resignations and death among the members of the Thirty-first Legislature. The districts in which vacancies are to be filled will not be represented in the special session of July 19 until after they hold their election and their new representatives duly qualify, which will throw them without representation for a week or more.

The proclamations were mailed out to the various county judges, who must post them thirty days in advance.

The proclamation calls for vacancies to be filled in the following senatorial districts: second senatorial District, where H. Bascom Thomas of Sulpher Springs has resigned. Seventeenth senatorial district, where T. W. Masterson of Galveston has resigned. Thirty first Senatorial district, where J. B. Hayter of Decatur has resigned.

Vacancies are to be filled in the following Representative Districts: Twenty-ninth Districts were John A. Modley of Athens has resigned; Thirty-third District, where R. E. Westbrook of Wolfe City has resigned; Forty ninth District, where W. A. Trenckmann of Bellville has resigned; Ninetieth District, where William Giesen of San Marcos has died. One Hundred and Fourth District where D. J. Brookerson of Benjamin has resigned; One Hundred and Seventh District, where C. H. Jenkins of Brownwood has resigned; One Hundred and sixth District, where J. R. Bowman of Amarillo has resigned; Forty eight District, where C. O. Mheks of Somerville has resigned; Sixty-sixth District, where E. C. Gaines of Commanche has resigned.

The State Fire Rating Board has heard from Newt M. Smith of Dallas, a State agent in the fire insurance business, advising the board that he had reviewed carefully their request for a suspension of the new rates, and it seemed that such would be contrary to law on the part of the insurance companies, and his companies would be unable to comply with this request. As shown in yesterday's dispatches it seems that none of the companies will comply with the request of the board, as they believe that it would be a violation of the Fire Rating Board law and discriminatory to so.

continued on page four

Three Cars Of Furniture

Let Us Show You

Our Fancy Line of Piano, Sewing Machines Dressers, Combination Desks, Book Cases, Kitchen Cabinets, Dining Tables, Old Mission Chairs and Center Tables, Beds, Office Tables, Chairs, Davenport, Mattresses, Etc.

Undertakers Goods

W. E. BORINSON FURNITURE CO.

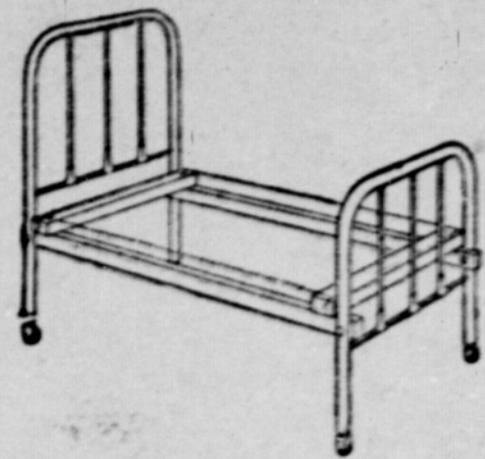
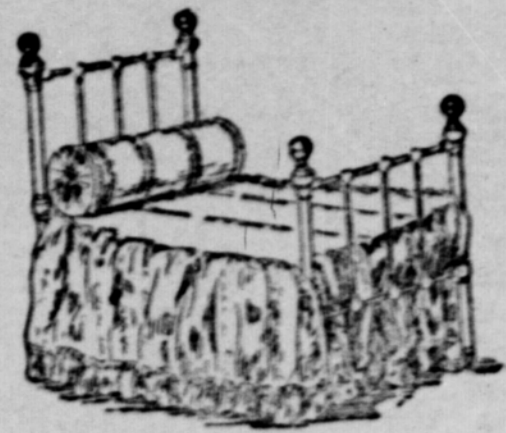

LARKIN WEATHERS,
Manager.

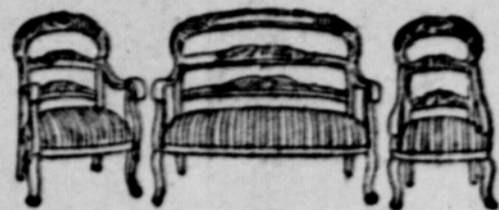

IN THE WOODMAN
Building.

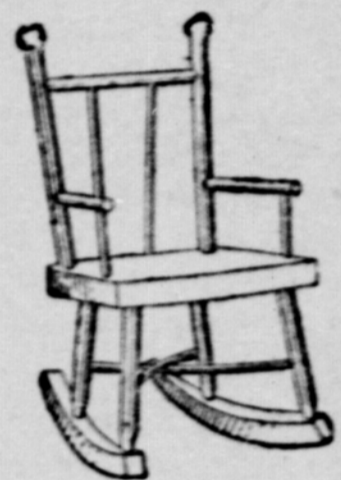

Tahoka, Texas.

B. HALL

W. R. MAJORS

Tahoka Livery, Feed and Sale Stable

HALL & MAJORS, Proprietors. PHONE No. 9.
We have good teams, good rigs, and our prices are reasonable. We sell all kinds of feed and will deliver anywhere.
North of the square, Tahoka, Texas.

Subscribe for the Lynn County News to read this summer.

DIRECTORS

N. McDaniel,
B. Slaton,
D. Nevels,
L. Lockwood,
L. Slaton.

OFFICERS

O. L. Slaton, President
A. L. Lockwood, Vice President
W. D. Nevels, Cashier
W. B. Slaton, Assistant Cashier

First National Bank

TAHOKA, TEXAS

\$25,000.00 Capital.

We Extend All The Accommodations Consistent With Business Principals.

Tahoka Blacksmith Shop

Jim Macfarlane, Manager

WE ARE READY AND ABLE TO DO ALL KINDS OF BLACKSMITHING AND WOOD WORKING EXPERT HORSE SHOEING FOR CASH GOOD WORK, COURTEOUS TREATMENT, PRICE REASONABLE. WORK FINISHED PROMPTLY

South of Public Square

Tahoka, Texas.

HOW TEXAS WAS NAMED.

An old newspaper article copied from the Galveston News of April 11, 1870, gives the meaning of the word "Texas" as follows:

"In the correspondence between John Quincy Adams and the Spanish Minister, on the boundary line between Louisiana and the Spanish Provinces, Don Ornis, in order to prove the prior possession of Spain, gives the official report of a Spanish officer, who took possession of the country (West I believe) on Matagorda bay. He states that he met a tribe of Indians, soon after his arrival, who saluted them with the word "Tehas," which, in their language, meant "Friends." This is doubtless the true meaning of the word. This correspondence will be found in the state papers published by Congress.

Money may pay for Religion but it cannot buy Christianity unless your heart reaches out to humanity and lends a helping hand to the needy you're a religious bankrupt and a candidate for Hell—Ex.

HUSTLE.

Be progressive. Do not wear your life away struggling along in the old ruts that your forefathers cut so deep by continual travel. While they are good in their way, and no doubt considered safe, yet the wheels of your vehicle turn so slowly that you are left far behind by your more progressive fellow travelers. Keep a moving and pushing and a crawling toward the front.

You'll not much more than hold your place in the procession the best you can do. The men at the front these days are those of brains and energy combined.

You have a place there if you will hustle for it. If you don't hustle your place will be taken by the fellow who does. Be alive.—Ex.]

SAVING THE MOISTURE.

The one uncertain factor in the problem of production is the weather. It is so uncertain that this paper has never made it a point to indulge in predictions.

We have never been able to work our faith up to the sticking place in long range forecasts as applied to a specific locality. On the other hand with our extensive staff of writers, we claim to be in a position to give up-to-date advice on how to handle land or how to handle crops under a given set of conditions.

Up to the time of writing, the great central west has had an unusually dry spring. Baring the warm weather in the month of May, the spring has been cold.

In view of the fact that the temperature has averaged low, the lack of moisture has, in the main, been a good thing, but we are rapidly coming to the point when our crops need rain and need it badly. We are helpless to aid in any way our meadows or small grain crops, but as the great inter-tillage crop, corn is the revenue producer of the central West, farmers generally have a splendid opportunity to carry out the principles of water conservation.

The fundamental principle of this conservation is simply surface tillage, as this creates a mulch and the mulch acts as a blanket to hold the moisture.

The best work, of course, has been done by those farmers who harrowed their soil frequently before planting, and who continue the process until the crop is far enough above ground to make more harrowing unwise.

After that it is a case of doing plenty of work in the soil without cutting into it more than two or three inches. The shallow cultivators ought to be more popular than ever this year if our dry weather continues.—Farmer Stockman.

Dr. S. E. Snodgrass and daughter.

ter, Inez Mrs. E. J. Bryant mother of O. T. Bryant, Principle of the Tahoka Public School, came in Sunday evening to visit Mrs. O. T. Bryant, who will soon be able to be

around again.

Mrs. J. B. Walker and children, left on the noon train Monday for a visit with relatives in Stonewall county.

Tahoka Saddle Shop

G. R. MILLIKEN Prop.

Saddles, Harness,
Fancy Belts Made
Repairing Done



Tahoka Real Estate Co.

City And Farm
Property

Largest List

Exclusive

Agents For The

Chamber's Addition

A. G. McAdams Lumber Co.

Lumber, Bois D'Arc, Lath, Shingles, Sash
Doors, Blinds, Mouldings and Paint
Lime, Cement and Brick
Rubber Roofing

Let Us Figure Your Bills. Tahoka Texas

C. E. BROWN, The First Real- Estate Man In Tahoka, Texas.

I have the Largest and Best
List of lands and town lots of
any one in Lynn County.

LET ME SELL YOU A HOME LIKE
THE ONE SHOWN BELOW.



A LYNN COUNTY HOME, NEAR TAHOKA

A Word To The Wise Is Sufficient

Lynn County now has railroad facilities and the Values in Real Estate will steadily advance until Cheap Property will be a thing of the past in a very few months.

Let me sell you some Cheap, but Good, land "Now" that will double in value in a couple of months. Write for my list of bargains.

C. E. BROWN,

The Original Land Man

Buy Lots In

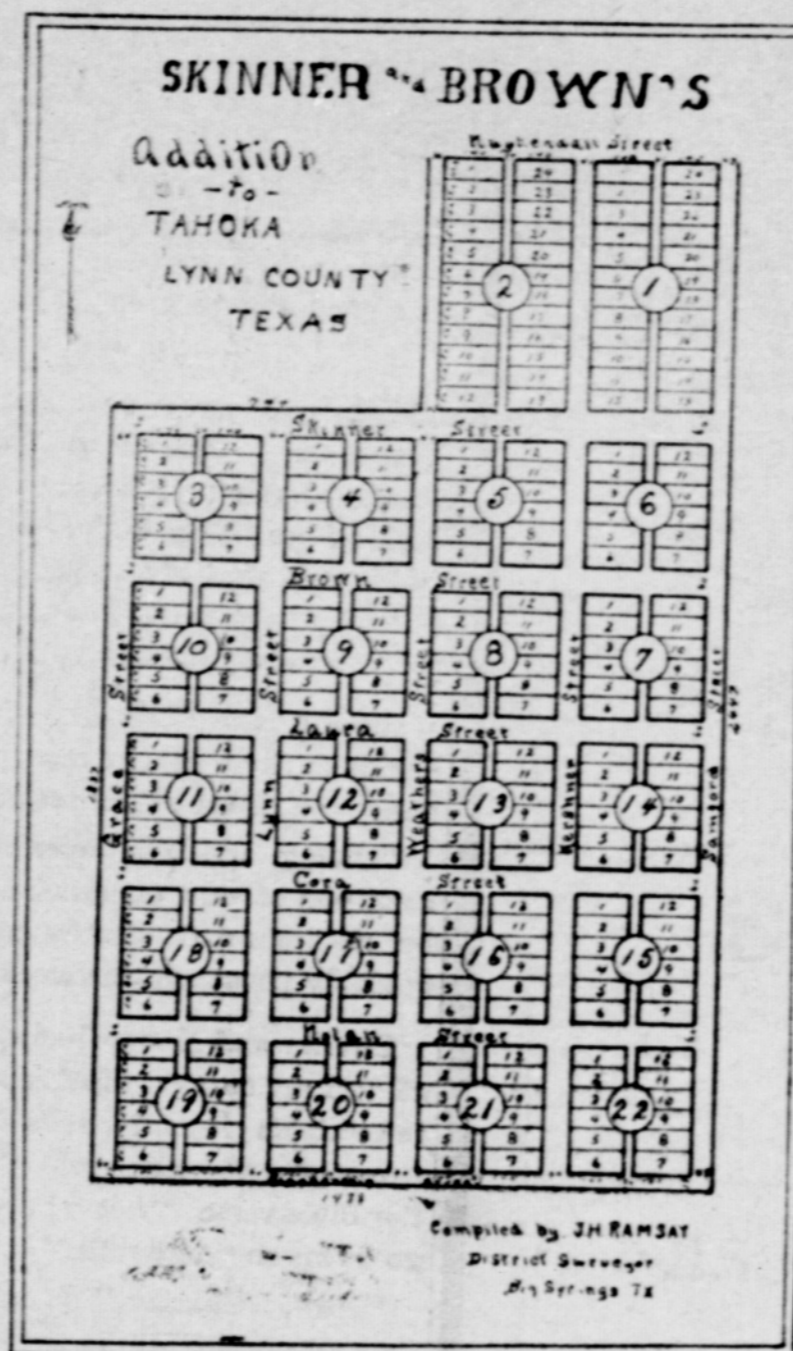

If You Want A Home

E. D. Skinner & Son
Tahoka, Tex on the



The Opportunity For Buying Land Cheap

Will never again be as good in Lynn County as it is at present. We are selling lands cheaper today than the same lands will ever sell for again. Opportunity knocks once at every mans door.

Purchase a home now while a little money will pay for it. The valley of the Nile will not surpass our Lynn County land for productiveness; nor will it produce a greater variety of crops. Few Bargains, Look them over.

480 acres First Class Farm land, 100 acres in cultivation, good improvements. To exchange for small well watered ranch.

We also have an Electric Light Plant for sale or exchange for Plains land. Plant situated in a town of 3500 people, about 900 drops, 30 street lamps, 3 arc lamps, 3 dynamos and one nearly new Corless engine. Receipts from lights about \$500 per month. Expenses about \$300 per month. Earnings could be increased to \$800 per month with but very little extra expense.

We have one of the best improved 320 acre farms in Lynn county to exchange for good mule or horse teams. Will take 4 to 8 good mule or horse teams on the first payment and good terms on balance.

No. 2. Is 320 acres of improved patented land with 80 acres in cultivation, house, small orchard, well and windmill, 5 miles from a railroad town. Price \$18 per acre, or will trade for a small stock of goods or small well improved farm in the East. This is first class land.

No. 3. Is 640 acres of smooth level land, fenced on three sides, to trade for good rental (Brick) property.

No. 4. Is 2080 acres of good farm land to exchange for good rental, brick buildings. Buildings must be worth the money, and well located in good town.

No. 5. Is 320 acres patented land within three miles of a railroad to wa. Price \$8.50 per acre with 1/4 cash, balance in 10 annual payments at 8 per cent.

No. 6. Is 4160 acres of first class farming land, three sets of improvements; a splendid proposition for colonization. Price \$13.50 per acre, good terms.

No. 7. Is 640 acres of patented land Price \$10 per acre, \$2000 cash, balance 1, 2 and 3 years at 8 per cent; or will take \$5,500 cash.

No. 8. Is 320 acres of school land; \$2 to the State. Price \$8.50 per acre cash. This is first class farm land, and lies within 6 miles of a railroad town.

No. 9. Is 320 acres, patented land, 8 miles from a railroad town, all first class farming land. Price \$11.50 per acre 1/2 cash, balance easy.

No. 10. Is 640 acres of first class farm land, 8 miles from a railroad town. Price \$14 per acre, 1/3 cash, balance in 1, 2, 3 and 4 years at 8 per cent interest.

No. 11. Is 320 acres of patented land, within 1 mile of railroad and 4 miles of a railroad town. All first class land. Price \$13.50 per acre, with \$5.50 per acre cash, balance in 1, 2 and 3 years at 8 per cent interest.

No. 12. Is 640 acres of patented land, within 4 miles of a railroad town. All first class farm land. Price \$15 per acre, 1/2 cash, balance easy.

No. 13. Is 160 acres, patented, three room house well and windmill, 35 acres in cultivation, all first class land and every foot tillable. Price \$2500 1/2 cash balance, 1 and 2 years at 8 per cent.

No. 14. Is 320 acres; one of the best improved farms in the county. 140 acres in cultivation, two dwellings, well and windmill, good young orchard, all first class farm land. Price \$20 per acre, with 1/3 cash, balance easy terms.

No. 15. Is 320 acres, improved, good house, well and windmill, 90 acres in cultivation, good orchard. Price \$20 per acre, \$2500 cash, balance easy at 8 per cent.

No. 16. Is 640 acres of patented land; every foot tillable. \$10500 cash.

No. 17. Is 640 acres of well improved farm, 80 acres in cultivation, good house, well and windmill, all first class farming land. Price \$17.50 per acre, 1/4 cash and balance easy at 8 per cent.

No. 18. Is 320 acres of patented land, all first class. Price \$13.50 per acre, \$2000 cash, balance easy.

No. 19. Is 320 acres, patented land all being the town of Tahoka, with 140 acres in cultivation, good improvements. Price \$60 per acre, 1/3 cash, balance easy at 8 per cent.

No. 20. 1280 acres of mixed sage and mesquite land, 100 acres in cultivation, good house and barn, lots, well and windmill, good orchard, cistern good fences, 4 acres in orchard and garden, 3 pastures. An ideal stock farm. Price \$13.50 per acre, 1/2 cash, balance in 1, 2 and 3 years at 8 per cent interest.

No. 21. 163 1/2 acres, 1 mile north-east of the town of Brownfield, 6 room house, barn, smoke house, chicken house, well and windmill, good fences, 70 acres in cultivation. This is a well improved and ideal home, located close to county seat, with first class school privileges. Price \$25 per acre, 1/2 cash, balance in 1 and 2 years at 8 per cent.

WHAT HAVE YOU FOR SALE OR EXCHANGE

Write Us. We are always on the look out for bargains and we may have exactly the property you WANT. There is no trade so small or so large that we cannot handle it. Tell us what you want and we we will find it.

We have one of the best improved 320 acre farms in Lynn County to exchange for good mule or horse teams. Will take 4 to 8 good horse or mule teams on the first payment and good terms on balance.

SHOES

SHOES

SHOES

One of the Largest Consignments of SHOES ever shipped into Tahoka will arrive at our store in a few days and to room for this large consignment we will sell, regardless of cost, every shoe in our store in the next ten days. This is \$s to you---Remarkable Values In Every Department---This is \$s to you come and see for yourself, everything marked in plain figures, we will appreciate your patronage and guarantee you entire satisfaction. We cordially invite you to come and price our goods whether you want to buy or not.

Jells & Welcher, -One-seven

Tahoka Hardware Co.

Tools and shelf hardware, queensware, crockery, tinware, stoves. We do all kinds of pipe, tin and tank work as gutter your house. Screen Screen Doors. See them

RACINE VEHICLE

Carry a full line of windmill repairs, piping, casing and rod. Exclusive agents for Star and Eclipse windmills

GRAND BARBECUE

July 1st & 2nd, 1910
And Celebration of the opening of the town of
O'Donnell, Texas

On the Santa Fe Railroad between Tahoka and Lamesa

Public Speaking by County Candidates

Hon. I. S. Crumpton.

OF LAMESA, ONE OF THE MOST ELOQUENT ORATORS IN WEST TEXAS WILL ADDRESS THE PEOPLE IN THE INTEREST OF CONE JOHNSON, FOR GOVERNOR

BASE BALL

Amarillo Bob Cats---Tahoka Tigers

First Excursion on the New Railroad, built through Lynn and Dawson Counties, from Amarillo right through the heart of the Great South Plains. Big Auction Sale Of O'Donnell Town Lots. Biggest Lot Sale ever pulled off in Texas. Come, to see will be to buy, Come.

O'DONNELL is the coming town of the South Plains, has already the Santa Fe, with good water, well located in the very cream of this section. The Texas Central in making it's survey headed toward Roswell, crosses the Santa Fe at O'Donnell, and will be in operation inside of the next eighteen months. Here will be a trade center of the Great South Plains.

Every Body Come And Enjoy Yourself. Come Prepared To Buy Lots

SUNBEAM CANDY.

The Sunbeam Society of Tahoka Baptist Church, will have a candy sale on Trades Day, July 4th, on the west side of the square. The public are cordially invited to come and buy a supply of good home-made candy of these enterprising little folks.

The passenger train was nearly half hour late Monday.

Our postmaster A. B. McCloud will be issued at many orders Monday aggregating \$649.

The Ton-Ko-No Medicine Co. gave a free show Monday night which was well attended.

Jack Alley has another little ad in The News setting forth the advantages of Lynn county, Tahoka and incidently a few bargains he has listed.

From what we can learn from persons who are coming in, Lynn county has the brightest prospects for a good general crop this year of any county on the South Plains.

M. E. Gilmore, of near Redland, New Mexico, arrived in Tahoka Sunday, having left home Friday. Talking to The News man, he said it was dry where he located, although there has been several good showers near by.

We clip the following for the benefit of those of our readers who doubt the power of the press.

"Owing to the overcrowded condition of our columns, a number of births and deaths are unavoidably postponed this week.

Charley and Nancy had quarreled. After supper Mother tried to re-establish friendly relations between them. She told them of the Bible verse "Let not the sun go down on you wrath."

"Now, Charley," she pleaded, "are you going to let the sun go down on your wrath?"

Charley squirmed a little, then he replied; "Well, how can I keep the old son from going down?"

George Bennett, who is living on the G. M. Milliken farm about four miles south-east of Tahoka, called on The News Saturday and reported a fine rain and a very heavy hail Friday afternoon which completely destroyed 20 acres of nice young cotton for him. This is one of the misfortunes liable to happen to the farmer in all countries. However, here on the Plains there is still plenty of time to plant and raise a good feed crop.

Work began on the Higginbotham-Harris Co. lumber sheds Tuesday and they are showing up in fine shape. Attention is called to their advertisement in this paper. Geo Small the local manager is a firm believer in judicious advertising, and when he has anything the public wants, he wants the public to know that he has it, so he uses the columns of The News now, as he has always done. They already have a car load of Eclipse windmills stacked in the yard here.

J. W. Pascal and son Heard, of Fluvanna, called on The News Thursday. They were on their way to the ranch west of here. When a man has a rip in his coat and only three buttons on his vest he should do one of two things get married or get divorce.

SINGER

For over half a century the Singer Sewing Machine has caused the housewife to smile instead of frown when waiting upon her husband because she is not tired down running a cheap sewing machine. There's a Difference.

E. W. HANCOCK

SELLS THEM ON TWO YEARS TIME--WRITE TO HIM AT LAMESA, TEXAS.

JOE BUFORD



JOE BUFORD---A Deep Sorrell Stallion, Blaze In Face, White Hind Foot, 16 hands high, weighs 1150 pounds, 5 years old.

He Is A Beautiful Saddle And Harness Horse, Of The HAL FAMILY And Shows Many Qualities Of His Well Known Ancestors, Some Of Which Are As Follows: TOM HAL, LITTE BROWN JUG, BROOKS, BROWN PILLOW, MOHAWK, ALGERINE, MAURY CHIEF, STAR POINT, PAT MALONE And FRANK BUFORD.

He will Stand the Present Season at my Barn on the Moyer Place 13 miles South east of Tahoka.

TERMS:---\$15.00 to insure colt, \$12.50 per foal. If mare is sold or removed from county Sierage becomes due. All accidents of owners risk but all care will be taken.

P. P. BREWER

THE CITY CONFECTIONARY

J. A. HUTTO PROPRIETOR FRESH FRUIT COLD DRINKS

ICE CREAM CANDIES, CIGARS, and TOBACCOES NORTH SIDE SQUARE, TAHOKA

TIN SHOP

South of the Public Square, Tahoka, Texas We do all kinds of Tin, Pipe and Repair Work, Stove Pipe and Oven Drums.

When in need of anything in this line call on us. Prices that will please.

Yours for business, G. M. MILLIKEN & SON.