

HANSFORD COURIER  
120 MAIN  
SPEARMAN, TEXAS 79081



An apple for the teacher...



# The Spearman Reporter

VOL. 73 No. 43

THE SPEARMAN REPORTER, SPEARMAN, TEXAS 79081

THURSDAY, SEPTEMBER 2, 1982

## Lynx travel to Stratford Friday



Larry Lanier's Lynx will invade the Stratford Elks territory Friday night at 8 p.m. This will be another classic for local football fans, who have anxiously awaited the kick-off this year. Coach Lanier has announced a "tentative" starting lineup, subject to change without notice, of course. At Quarterback will be Billy Pat Underwood, at 160 lbs., back-up will be Ross Donahue, who will see some action at Stratford. Dennis "The Menace" Randall will be back at the Tail Back spot for Friday night's game. Dennis is a bouncing 200 lbs., and is expected to be one of the finest backs in the schools history this

year. A new-comer to the Lynx team this year, is Darren Goodheart. Darren will be playing full-back and weighs in at 170 lbs. Rounding out the back field, will be Ricky Torres at 150 lbs. Center for the Lynx will be Charlie Salgado, 190 lbs., with guards Darl Farris at 185 lbs., or Byron Sutterfield at 160 pounds, plus David Turner at 205 lbs. Tackles include Mark Guthrie 200 lbs., and Jan Hartsel, at 160 lbs. Ends include Steven Francis at 140 lbs., Jeff Poole at 140 lbs., and Gary Thomas at 200 lbs. Expecting to see a lot of action

on Defense, is Julio Vasquez at 140-pounds, playing cornerback. The Lynx are expected to be in the thick of one of the toughest games of the year. The Elks are rated as the top team in District I-AA. The Lynx have worked hard all month for this first game, and in spite of the Elks being picked as a favorite by some, many local fans feel the Lynx with their size, can play with anyone this year. They average 178 lbs., and are much larger than last year. On the other side of the ledger, the Stratford Elks are loaded with returning backs,

Sammy Gomez and Albert Olivas. Local fans will get a chance to see how good the Lynx are on Defense as these two boys were sensations last year. Sammy Gomez gained 1,342 yards last season and received All-District I-AA Honorable Mention. Albert Olivas gained 510 yards. Both Gomez and Olivas are linebackers. Also playing for Stratford is a former boy, Ragsdale. His father used to be city manager here, and he--Ragsdale--is an outstanding player. So, plan to be at Stratford Friday night, with the Lynx, and band, the fans and an 8 p.m. kick-off. You will enjoy the game.



Hergert Pontiac, Buick, GMC has received a Riviera Convertible from Buick Motor Division! This is the 1st Convertible built by General Motors since 1976. There were 600

of these convertibles built and allocation was determined by last year's Riviera sales. Drop by today and look at this beauty!

### Enrollment of Lynx band increases

The Spearman Lynx Band is preparing its first half-time show and the band will be somewhat larger this year. The hornline consists of 24 brasses and woodwinds, the percussion section consists of 10, and the color guard consists of 12 flaggers, for a total of 46 band members. Much excitement will be generated by the corps-style show design which allows the band to appear much larger than it actually is by using the flag corps, hornline and percussion section in special ways. The breakdown is as follows: HORNLINE--Alicia Ochoa, FLUTE--Tammy Welch, CLARINET--Tracy Taylor, Shella Schneider, SAXOPHONES--Nita Baker and Jeff Gressett, TRUMPETS--David Tucker, Tonya Curtis, Charlie Godfrey, Edward Beck, Brian Paul and Ruben Gomez, FRENCH HORN--Terje Thøgersen and

Jesse Moore, TROMBONE--Preston Taylor, Newell Percy, Chris Christy, Angela Gaitner, and Jaime Gomez, EUPHONIUM--Ernest Bowen, Greg Reimer and Karl Bynum, TUBAS--Joe Gomez and Cristie Black, PERCUSSION LINE--Greg Meek, David Sorgi, Mary Ann Kenney, Lesa Scroggs, Cynthia Hendrick, Rudy Saldivar, Michael Lopez, Shannon Scroggs, Karl Kizziar and Pearl Pacheco. FLAG CORPS--Yynn Brown, Bambi Burger, Julie Kell, Tischa Percy, Lee Barnes Ann Barnes, Angela Coombs, Mary Anne Brinson, Alicia Langston, Sara Avila, Vicki Hand and Teresa Miesner. Hornline Captains are Tracy and Preston Taylor, Guard Captains are Yynn Brown and Bambi Burger and Percussion Captains are Greg Meek and Mary Ann Kenney.

### Blood drive yields 54 pints

The blood drive held at the Sacred Heart Catholic Church Monday, August 30, yielded 54 pints of blood. This is the first drive since Hansford Hospital decided to change from using the American Red Cross to the Coffee Memorial Blood Center.

On July 1, the hospital decided the best way to supply blood to Hansford Hospital was through Coffee Memorial Blood Center in Amarillo. Coffee Blood Center can meet any requirements of Hansford Hospital and some 20 other area hospitals within a 27 county, 100-mile radius area. Even though the Red Cross has been supplying the hospital with blood, 80% of the blood used by the citizens of Hansford County had been supplied by the Coffee Memorial Blood Center to the area hospitals in Amarillo.

### Nollner makes president's roll

AMARILLO--Kyle Jason Nollner was recently named to the President's Honor Roll according to Ron DeSpain, General Manager of the Amarillo Campus. Membership to the President's Honor Roll is attained by maintaining a 4.0 grade average. Kyle Jason Nollner is majoring in Industrial Maintenance Technology, and is the son of Mr. & Mrs. Bobby Nollner of Box 932, Spearman, Texas 79081. He is also a graduate of Spearman High School.

### MARKETS

CORN	\$2.95
WHEAT	3.19
MILK	4.30

### Rev. & Mrs. Burress visit here

Rev. and Mrs. Archie Burress of Seneca, Mo. are visiting here this week in the home of their daughter and son-in-law, Mr. and Mrs. Danny Fiel. The Fiel's have a new daughter born Aug. 25. She weighed 7 lbs. and has been

named Leslie Lynne. She joins a sister, Sherri Leanne, 22 months old in the home. Rev. Burress is now pastoring a church and doing evangelistic work. He was the former pastor of the Union Church here for several years.

### DPS to conduct Labor Day Operation Motorcide

Major C.W. Bell, Regional Commander for the Texas Department of Public Safety in Region 5, said, "The Labor Day holiday period is the time for the last trip of the summer. While the Texas driver is preparing his holiday plans, the Texas Department of Public Safety is preparing to save lives and prevent injuries on the streets and highways of Texas through Operation Motorcide." Operation Motorcide is designed to focus attention on the increased dangers of accidents and deaths in holiday traffic. Operation Motorcide will begin at 6:00 PM on Friday, September 3rd and conclude at 12 midnight on Monday, Septem-

ber 6th. During this 78-hour period all available Department of Public Safety troopers will be on duty and will be especially aware of accident-causing violations--the two major violations being speed and driving while intoxicated.

Major Bell emphasized that the two phases: "Drive 55 and Stay Alive" and "If You Drink-Don't Drive And If You

Drive-Don't Drink" will be of prime importance for all motorists to adhere to during the holiday period.

## 1439 enrolled in county schools

A total of 873 students are enrolled in the Spearman school system when school began Monday, August 30.

Elementary school had 339 pupils enroll, junior high 268 and high school had 266. A school official said that they always had a few more enroll after Labor Day.

September 1981 enrollment was 891 pupils and pupils at the end of the school this year were 877.

Pringle-Morse school reports an enrollment of 79. They have kindergarten thru eighth grade classes.

Gruver schools have a total of 487 pupils enrolled. There are 242 in elementary, 114 in junior high and 131 in high school. A school official said Gruver enrollment is off 16 pupils from May last year.

### Dr. Kleeberger Estate Goes To Charities

There will be an auction Friday and Saturday, September 3 & 4 of the estate of R.L. Kleeberger, M.D.

On Friday, his office and medical equipment will be sold at 16 S W Court and Saturday, his automobiles and household furnishings will be sold at his residence at 905 South Barkley. Inspection may be made from 9 a.m. to 5 p.m. Thursday at both sale sites or on the day of each sale. Proceeds of this auction will

be distributed according to Dr. Kleeberger's last will to the following charities: Sacred Heart Catholic Church, Spearman; Texas Division of the American Cancer Society, Texas Heart Association and the Medical Education Foundation, Creighton University School of Medicine, Omaha, Nebraska. There are many items on sale at both the office and home. Check the ad in today's papers for complete descriptions of property to be sold.

### Reneau receives master's degree

During ceremonies at the coliseum of NTSU--North Texas State University--at Denton, Gene Reneau, son of Mrs. Selma Reneau, received his Master's Degree in education with a major in vocational technical education and a minor in occupational orientation. Gene has taught deaf education for 5 years in the Lubbock schools and 1 year in the Amarillo schools. He will be starting his second year as consultant for the hearing impaired for Region 16, Education Service Center serving the Panhandle area.

### Martinez on TSTI VP Roll

AMARILLO--Juanita Martinez was recently named to the Vice-President's Honor Roll according to Ron DeSpain, General Manager of the Amarillo Campus. Membership to the Vice-President's Honor Roll is attained by maintaining a 3.5 grade average. Juanita Martinez is majoring in Technical Office Training, and is the daughter of Mr. & Mrs. Isabel Martinez of 216 S. Archer, Spearman, Tx. 79081. She is also a graduate of Spearman High School.

### Hospital News

Patients at Hansford Hospital are Sid Evans, Brian Hutchins, Beverly Vinson and son, Dee Jackson, Sara Sherwood, W.E. Jones, Pete Vernon and Mary Murrell.

Dismissed were Wesley Garnett, Alice Walker, Barbara Cook, Sharon Wilson, Caroline Murphy and Sue Fiel and daughter.

ATTENTION VIDEO GAME LOVERS--Different kinds of Video Games will be provided by Don Schell for the Jerry Lewis Telethon. All the proceeds will go to the Jerry Lewis Telethon. The Video Games will be placed at the Spearman Fire Department Building. Make sure and play your favorite game, while you are having fun, just remember that you are helping Jerry Lewis and all other people to fight all Muscular Diseases!

## Jerry Lewis Telethon set for Sept. 5-6

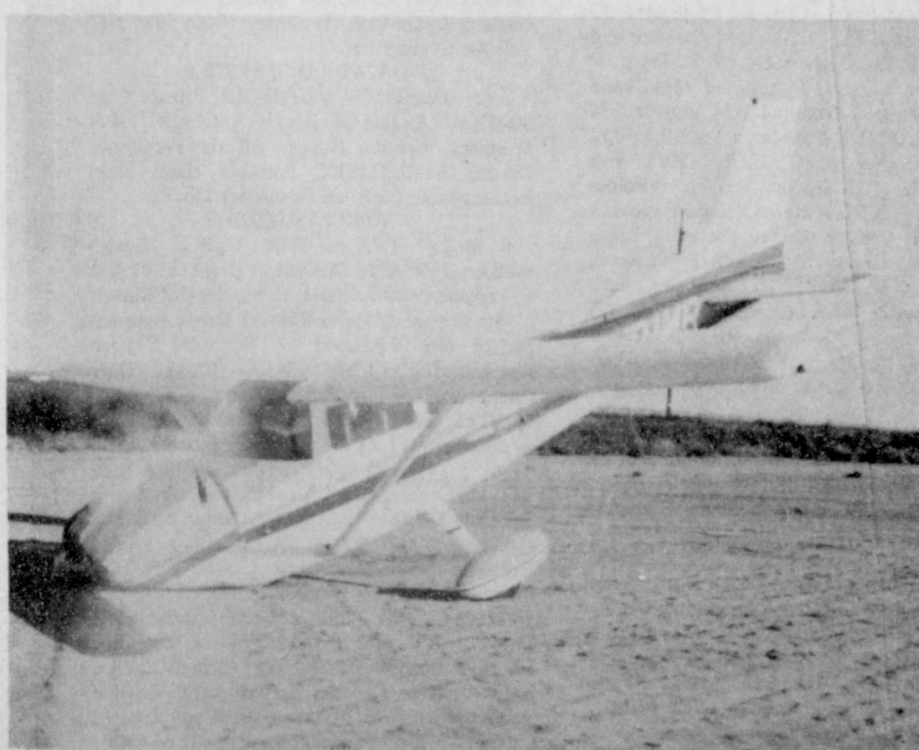

Dr. Steger, local optometrist, flew thru North Plains Electric transmission lines at the approach to the airport late

Saturday night. He was not injured, and very little damage was done to the airplane. The transmission lines are soon to be removed.

The 17th annual Jerry Lewis Labor Day Telethon to benefit the Muscular Dystrophy Association (MDA) will be broadcast in the Panhandle by KFDD-TV 10 September 5th and 6th.

Originating from Las Vegas, the TV spectacular is held to raise funds to support the Association's medical services and research programs. The entertainment marathon will be carried by a "Love Network" of some 200 TV stations in the continental U.S., Hawaii, Alaska and Puerto Rico. Ed McMahon will serve as Jerry Lewis's anchorman for the tenth straight year, backed up by Hollywood's Chad Everett.

Last year the 22½-hour super-show produced a record pledge total of over \$31 million for the national health agency's work, and was seen by an estimated 93 million Americans. The show's unduplicated total audience included more than 47% of the households with TV sets in the U.S.

Robert Considine, the show's producer, promises that this year's Telethon will be the most exciting in the show's history. Mr. Considine said, "Jerry's been preparing for the show

since Telethon '81 went off the air. His enthusiasm and interest in this production are contagious. Knowing that the Telethon is so important for the thousands of people with muscular dystrophy and related neuromuscular diseases inspires everyone involved to make this the greatest show television viewers have ever seen."

KFDD will "cut away" from the network show approximately 15-20 minutes every hour to present firsthand reports of MDA activities in the Panhandle area supported by proceeds from the Telethon and other of the health agency's fund-raising events. The progress of the Spearman pledge center will be included in many of the KFDD local segments. Manned this year by Vicky Bullard and Firefighters, the people of Spearman can call 659-5577 throughout the 22½ hour super-show to make their pledges.

Pledge center volunteers are also planning a door-to-door drive for Labor Day. Children interested in helping Jerry's Kids should come by the center location at the Fire Department on Monday, September 6th, to

pick up an official canister, Telethon badge, and instructions. Those wishing to drop off donations can bring them by the fish bowl located at the Spearman Pledge Center.



Jerry Modena, of Woodward, Oklahoma is pictured above with his 1948 Chevrolet Panel Wagon. Jerry is the nephew of Pete Stafford of Spearman. We snapped this picture as he was sprucing up

his Panel at Cates Car Wash. Jerry just returned from a 5 thousand mile trip and stopped by Spearman on his way home to Woodward. The Coors Express is painted a bright Cherry Red.



## Engagement Announced

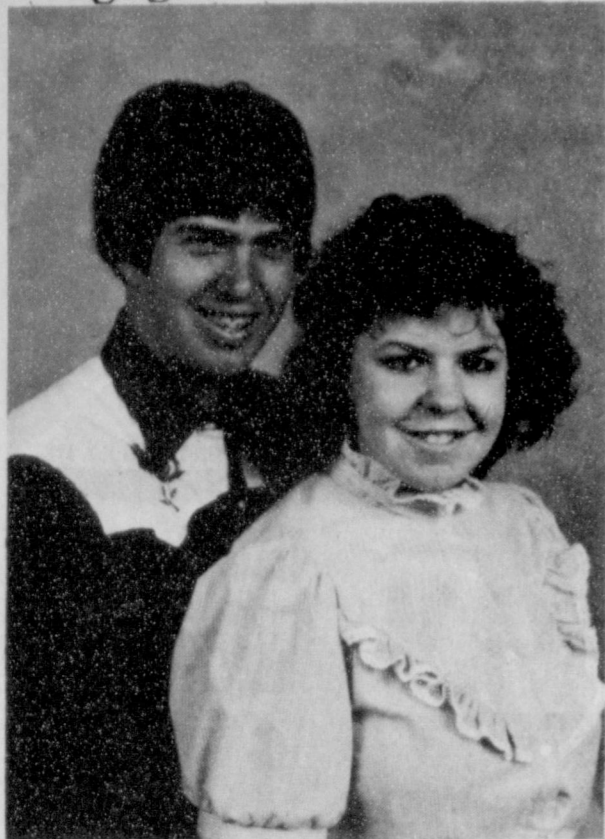

Mrs. Thelma Heth and Mr. Jack Wilson of Amarillo, Texas are proud to announce the engagement and approaching marriage of their daughter Vala Diane, to George David Schick, son of Mr. and Mrs. Dave Schick of Spearman. A September 18 wedding is planned.

## 4-H "Is"

Each year, beginning in September, more than 100,000 Texas Boys and girls aged 9 to 19 join millions of others throughout the country in the world's largest youth organization--4-H.

What is it and why do they do it?

A brief look into the nature of the 4-H program and what it has to offer youth and their families can provide the answers to these questions, says Jim Smith, County 4-H program coordinator with the Texas Agricultural Extension Service, Texas A&M University System. First of all, 4-H is fun. 4-H'ers take part in a wide variety of enjoyable activities--club meetings, recreation, camps, learning laboratories and project work. Meanwhile, their families have the joy of working together on projects, participating in fun days, and enjoying a host of other opportunities, Smith says.

Secondly, 4-H offers educational experiences. Youngsters learn that learning can be fun. 4-H learning takes place in small group work, in individual work on projects, and in conjunction with adult volunteers and family members. They learn at fairs and project shows of various sorts and in a variety of other "non-classrooms" environments.

In a sense, 4-H education involves youngsters in a "learn to do by doing" atmosphere where useful and practical skills and facts are learned.

Finally, 4-H is for everyone--young or old, rural or city, male or female--regardless of race or ethnic group. Furthermore, 4-H requires no membership fee or

dues. It is sponsored by the Texas Agricultural Extension Service which is a part of Texas A&M University System and by local, state and national donors.

So, become a part of 4-H, says Smith. You and your family will have fun, meet new people, and take part in many new and interesting activities.

Find out all about 4-H by contacting the County Extension office or enroll at the regular 4-H meetings to be held on Monday, September 13 in Spearman at 7:00 p.m. in the County Barn. Gruber 4-H will meet Tuesday, September 14 at 7:00 p.m. in the Gruber County Barn.

\*\*\*\*  
Fall is one of nature's greatest shows; you can enjoy the next few months immensely if you take time to observe what is all around you.

## Fall Exercise Classes Begin At Y.M.C.A.

Ladies! Would you like to wear one or two sizes smaller clothes by Thanksgiving--in time for the pretty outfits worn to Christmas parties? If so, get to the Y.M.C.A. as fast as you can and sign up for the fall aerobic exercise classes. The morning classes will begin Monday, September 6, at 9:00 a.m. with Cindy Schneider as teacher and the evening classes will begin on Tuesday, September 7, at 6:45 p.m. with Wanda Archer as teacher.

Aerobic exercise is an enjoyable way to firm up, lose inches [and combined with dieting--to

## Our Heritage of Faith

Please accept our good wishes for peace and joy.

At Faith Lutheran, this Sunday, the subject of choosing and choices will be dealt with in the sermon. Choices confront us constantly. We want to make good choices out of the options available. But how? The sermon theme is: Choices, Choices. --Joshua 24:1-2a, 14-18. Sunday School begins at 9:45 a.m. Worship is at 10:45 a.m.

A hearty welcome awaits all who worship with us.

Bruno Gaskamp, Pastor

\*\*\*\*

The purpose of education is to teach people to think.

## Renewal Course To Begin

An ECA or EMT Renewal Course will begin here Sept. 7 at 7 p.m. at the fire station. This will be a 40 hour course taught thru Frank Phillips College, with college credits available on successful completion of the course.

Michele Davis and Ed Williamson, paramedics, will teach the course. There will be a \$25.00 registration fee and the approximate cost of textbooks will be \$10.50. The class will meet two nights a week for approximately 7 weeks.

This course is open to the public, teaching basic life support, CPR and there are no requirements for you to work with the local ambulance.

On successful completion of the course, participants will be certified by the Texas Department of Health.

For further information you may contact Michele Davis at 3411 or Ed Williamson at 3843.

## Arts & Craft Guild Meets

The Arts & Crafts Guild met Friday, Aug. 27 in the home of Freda Sheets.

Attending were Blanche Fuller, Jewel Turner, Sada Hoskins, Mildred Daily, Deta Blodgett, Annie Allen, Margaret Gibner, Lemmie Russell, and 2 guests, Carrie Marie Berry and Mary Lee.

The next meeting on Sept. 3 will be in the home of Athalee Trayler.

## WTSU enrollment up

WTSU--One of the largest groups of preregistered freshman students at West Texas State University has contributed to an increase of 127 students during registration for the fall semester.

After the only day of regular registration, 5,414 students had enrolled for an increase over last year's fall enrollment of 5,287. The figure does not include late registration, thesis students or students who enroll only in evening or off-campus courses, said Lila Vars, WTSU associate registrar.

Final enrollment figures for the 1981 fall semester were

6,693 students.

During five summer orientation sessions, 804 freshman students preregistered for classes compared with 777 last summer.

The large freshman class is unusual, said Vars, because predictions had indicated that the high school graduating classes of 1982 would be among the smallest in several years since the "baby boom" period of post-World War II.

"This class is the first effect of the pill," she said.

Late registration at WTSU began on Thursday, Aug. 26, the first day of class, and continues through Friday, Sept. 3.

Students may register each weekday from 8 a.m. to 5 p.m.

at the Registrar's Office in the Administration Building and pay \$5 late fee.

The fall semester at WTSU will continue through Dec. 15 following final examinations.

## Senior Bridge Club Meets

The Senior Friday Bridge Club met Aug. 26 at the Golden Spread Center with Ada McLain as hostess.

Members present were Ada McLain, Ora Sanders, Ruth Baker, Viola Groves, Opal Jones, Mathilde Entreklin and guests present were Addie Novak, Willie Wallis, and Ruth Lackey.

## NOTICE CHINA PAINTERS

The China painting class will resume their classes at Mrs. Lester McLains home, on Tuesday September 21st. Classes will start at 9:00 a. m. until 4:00 p. m. According to Mrs. Lester McLain, all of those who took china painting last year, are planning to come back this year.

**WILLIAMS & WEBB**  
AN AGGRESSIVE SELLING TEAM

## AUCTION

FOR FULL DESCRIPTIVE BROCHURE CONTACT THE AGGRESSIVE SELLING TEAM  
806/374-9387 2208 Canyon Drive, Amarillo, TX 79109 TXE013-0234

### ESTATE OF R.L. KLEEBERGER, M.D.

10:00 A.M. EACH DAY-SEPTEMBER 3 & 4

FRIDAY-OFFICE & MEDICAL EQUIPMENT  
SATURDAY-AUTOMOBILES & HOUSEHOLD FURNISHINGS  
ALL SELLS-NO MINIMUM-NO RESERVATION- NO BID INS-NO BUY BACKS

#### LOCATIONS:

FRIDAY SALE- SPEARMAN FAMILY PRACTICE CLINIC-16 S W COURT  
(On the West Side of Courthouse Square) - Spearman, Texas

SATURDAY SALE-Dr. Kleeberger Residence At  
905 South Barkley-Spearman, Texas

Inspection: 9:00 A.M. to 5:00 P.M. Thursday, September 2, at both sale sites, or Day of Each Sale. [No Inspection of Residence on Friday Until Conclusion of Medical Practice Sale]

THIS SALE IS BEING CONDUCTED PURSUANT TO DIRECTIONS CONTAINED IN DR. R.L. KLEEBERGER'S LAST WILL AND TESTAMENT. PROCEEDS OF THIS AUCTION ARE TO BE DISTRIBUTED ACCORDING TO THE WILL TO THE FOLLOWING CHARITIES:

SACRED HEART CATHOLIC CHURCH, SPEARMAN, TEXAS  
TEXAS DIVISION OF THE AMERICAN CANCER SOCIETY  
TEXAS HEART ASSOCIATION  
MEDICAL EDUCATION FOUNDATION, CREIGHTON UNIVERSITY SCHOOL OF MEDICINE, OMAHA, NEBRASKA

#### MEDICAL EQUIPMENT

1 Folding Wheel Chair; 1 Hospital Bed; 1 DALLONS PHONOTEL Transmitter; 1 Electrocardiograph w/Recorder; 1 BURDICK ULTRASOUND; 1 RAYTHEON 125 Watt Microwave Diathermy Generator; 1 AMERICAN CYSTOSCOPE Portable Electro Surgical Unit; 5 WELCH ALLYN Ophthalmoscopes; 1 KEYSTONE Telebinocular Electric Eye Machine; 3 BURTON All Angle Pedestal Blue Lamps; 1 BANTAM BOVIS Electrosurgical Unit; 1 WELCH ALLYN Electric Power Unit; 2 KIDDE Dry Ice Applicators; 1 ECKSTEIN Tetra-Tone Audiometer; 1 Set Tuning Forks; 1 EMERSON Electric Vacuum Pump; 1 Nitrous Oxide Cart, Regulator, Bottle, and SURGFROST Wand; 10 Assorted Sphygmometers; 1 STRYKER Electric Cast Cutter; 1 80 Watt Hyfreator; 1 NATIONAL Antique Cartery; 1 NATIONAL Transillumination; 1 Model CT-3300 ADAMS Electric Centrifuge; 2 Infant Scales; 2 HEALTH-O-METER Platform Scales; 1 3 Power Electric Lighted Microscope; 1 Autoclave/Sterilizer w/Accessories; 15 Assorted Instrument Trays; 1 NORTHERN Massager; 5 Pedal Operated Soap Dispensers; 1 Lot Towel Dispensers, Surgical Towels, Feather Pillows, Pillow Cases, X Ray Gown Suits, Sheets, Blankets, Etc.; 10 Stethoscopes.

#### X RAY MACHINE & EQUIPMENT

1 PICKER X-Ray Machine w/Model 1362 PICKER Twin Track Tube Stand, Model CENTURY II PICKER Power Table, Model KM200 PICKER Control Panel, (Radiography and Fluoroscopy), Complete w/accessories, Film Holders, (2) Film Safes, (4) Film Viewers, Lead Chair, Etc.; 1 BLU RAY Radiograph Duplicating Printer; 1 Large Inventory Timers, Chemicals, Replenishers, Film, Goggles, Lead Gloves, Shields, Etc.

#### EXAMINATION TABLES & EXAMINATION ROOM FURNISHINGS

1 Model S-1524 MARK IV SHAMPAINE All Angle 4 Way Electric Examination Table w/attachments; 1 HAMILTON All Angle 4 Way Electric Examination Table w/Attachments; 1 Model S-4218 STEELAX All Angle Manual Examination Table w/Attachments; 1 W.D. ALLISON Antique Wood Inlaid Examination Table w/Accessories; 1 W.D. ALLISON Antique Wood Inlaid Hutch Type Instrument Cabinet w/Glass Doors; 1 W.D. ALLISON Antique Wood Inlaid Chest Type Instrument Cabinet w/Bottom Doors; 1 Stainless Steel Step Type examination Platform; 4 Doctors Stools on Casters; 7 Stainless Steel and Enamel Sanitary Trash Cans; 9 Assorted Stainless Steel and/or Enamel Equipment Carts on Casters; 1 Steel Instrument Cabinet w/Glass Doors, Shelves; 1 Steel Instrument Credenza w/Glass Doors, Shelves; 2 30" Steel Formica Topped Cabinets; 7 36" Wide Steel Wall Mount Shelf Units w/Sliding Glass Doors; 1 4 Section Dressing Divider; 2 Fold Down Wall Desks; 3 Wood Bedside Tables.

#### SURGICAL INSTRUMENTS

This Sale Has Over 300 Assorted Stainless Steel Surgical Tools. Included are forceps, Needle Holders, Mosquitos, Clips, Pelvice Meterys, Cannulas, Hammers, Saws, Scissors, Kellys, Pins, Knives, Clamps, Dialators, Metzemaums, Syringes, Catheters, suction tips, scope connectors, ring cutters, etc.

#### OFFICE EQUIPMENT & FURNISHINGS

17 Assorted Wood & Steel Bookcases & Cabinets; 10 Library Type Steel Stacking Bookcases w/Glass Fronts; 1 Large Lot Staplers, Cutters, Hole Punches, Baskets, Clocks, and Assorted Supplies; 1 SONY Cassette Tape Recorder & Cassette Eraser; 4 NORELCO\* CRAIG & GRAY DICTAPHONES; 5 ROYAL & OLYMPIA ELECTRIC TYPEWRITERS; 2 VICTOR Electric Adding Machines; 1 TEXAS INSTRUMENT Pocket Calculator; 1 VICTOR Electronic Printing Calculator; 5 Fluorescent Desk Lights; 6 Metal Waste Paper Cans; 2 3 Caster Step Stools; 1 STATESMAN Double Door Steel Cabinet; 5 SHAW-WALKER 5 Drawer Letter Size File Cabinets; 2 SHAW-WALKER 4 Drawer Letter Size File Cabinets; 2 3 Drawer Letter Size File Cabinets; 38 2 Drawer Stacking Index Card Files w/4 Base Units; 1 Metal Cabinet

w/3 Letter Size File Drawers & Door Covered Safe; 2 Double Drawer Steel Ledger Files; 3 30 Drawer Letter Size Paper Files; 1 12 Drawer Card File Cabinet; 1 5 Drawer Double Card File Cabinet w/Stand; 1 Tub File on Castors; 1 Large Lot Assorted Desk Files, Organizers, Etc.; 6 Assorted size Wood & Steel Office Desks; 3 Leather Executive Swivel Desk Arm Chairs; 4 Secretary Desk Chairs; 5 Oak and Steel Upholstered Side Chairs; 11 Naugahide Spring Base Reception Chairs; 1 80" Naugahide Sofa; 1 Pecan Octagon Coffee Table; 7 Wall, Hanging, & Table Lamps; 1 Large Lot Assorted Decorator Items; 1 Model EG301 ELECTROGRAPHIC MINOLTA Roll Type Dry copier w/Stand and Supplies; 1 COPYSTAT 500 Wet Copier w/Automatic Feed Attachment, Wood Cart Stand; 1 HALSEY-TAYLOR Water Cooler w/Glass Spigot; 1 Model 94BG 3M Background Music System Coupled w/GARRARD Turntable, COLUMBIA AM-FM Radio-Tape Deck, and Model CHB-35A BOGEN Amplifier, w/5 speakers.

#### NON CLASSIFIED

2 MONTGOMERY WARD Table Top Refrigerators; 4 Assorted Electric Heaters; 4 Electric Desk Fans; 4 Upright & Canister Vacuum Cleaners; 1 CLARK Electric Floor Polisher; 1 5' Aluminum Step Ladder; 1 Large Inventory Cleaning Supplies & Tools; 1 Large Assortment Hand Tools; 1 Pro 16A PATROLLMAN REALISTIC Police Scanner; 2 GENERAL ELECTRIC Air Purifiers.

#### GUN AND SWORD COLLECTION

16 Assorted Rifles & Shotguns (Most Collectors Items w/Balance being Popular Guns); 13 Assorted Pistols (Pistols Including Anniversary Models); 3 Sword & Scabbards.

#### GUN CABINETS:

1 10 Slot Wood Gun Cabinet w/Sliding Glass Doors, Ammo Trunk; 1 8 Slot Rifle & 6 Pistol Wood Gun Cabinet w/Glass Doors, Ammo Trunk; 2 Matching Wood Wall Mount Pistol Cabinets w/Glass Doors.

#### AUTOMOBILES [EXTRA SHARP]

1 1977 CADILLAC ELDORADO 2 Door Coupe (S/N GL57570259553) 27,116 Miles, Fully Loaded; 1 1978 OLDSMOBILE TORONADO 2 Door Coupe (S/N 3257K8M721742) 16,728 Miles, Fully Loaded.

#### ENTERTAINMENT EQUIPMENT

RADIOS, CAMERAS, T.V.'s RECORDERS] 1 Set 925 MCGREGGOR Golf Clubs; 1 Set 7 x 50 Binoculars; 1 Large Assortment Photography Equipment Including Tripods, Lights, Cases, Reflectors, Flash Packs, Carousel Projectors, 12 Antique Cameras, Etc.; 6 Assorted Cassette and Reel to Reel Tape Recorders; 9 8 Track & Cassette Tape Caddys; 6 Assorted Multi-band Radio Receivers; 7 Assorted AM and/or FM Radios; 1 REALISTIC Patrolman Pro 10 110/12 Volt Police Scanner; 1 MOTOROLA 110/12 Volt Alert Monitor; 1 5 Station Seebom Wireless Intercom Set; 2 ZENITH Stereo Record Players; 1 PHILCO Hi-Fi Console Record Player; 1 Large Antique Music Library; 2 110 Volt Eight Track Tape Players; 3 RCA & ZENITH Remote Control Color T.V.'s; 2 Black & White T.V.'s (1) w/Remote Control; 1 Model 46339-A SEARS DISCOVERER Equatorial Refractor Type Telescope w/1200MM Lens, Sightscope, Tripod, Wood Case.

#### FURNITURE

54 Pieces of quality furniture including Leather & Vinyl Chairs Couches, Coffee Tables, Ottomans, Curio Cabinets, Liquor Cabinet, Occasional Chairs, End Tables, Desks, Dining Room Suite, Log Rack, Kitchen Table & Chairs, Hutches, Bookcases, Credenzes, Etc.; 1 Early American Maple Wood Bedroom Suite w/Double Dresser With Mirror, 4 Drawer Desk, 1 Nightstand, Regular Size Bed With Box Spring & Mattress; 1 Early American Maple Wood Bedroom Suite w/Triple Dresser With Mirror, Chest on Chest, (2) Night Stands, Regular Size Bed w/Box Springs & Mattress; 1 Antique Fruitwood Rolled Corner Bedroom Suite w/Double Dresser With Mirror, Chest on Chest, Night

Stand, Twin Beds, With Box Springs & Mattresses, 5' Cedar Chest; 1 4' Cedar Chest.

#### APPLIANCES

1 MAYTAG Matching clothes Washer & Electric Clothes Dryer; 1 MAYTAG Electric Ironer; 1 AMANA Radarrange Microwave Oven; 1 GENERAL ELECTRIC Trash Compactor; 1 PANASONIC Wet Bar Refrigerator; 2 KIRBY & ORECK Carpet Sweepers.

#### DECORATOR ITEMS

32 Assorted Table, Swag, Pole, and Wall Lamps; 126 Decorator Items Including Clocks, Mirrors, Vases, Figurines, Christmas Decorations, Magazine Racks, Ashtrays, decanter Sets, Wall Hangings, Glassware, & Other Quality Items.

#### CHINA, GLASSWARE & KITCHEN FURNISHINGS

1 12 Place Setting NORITAKE China Dishes; 1 6 Place Setting Porcelain China Dishes; 1 Lot Assorted Crystal Stemware; 1 Lot Assorted Table Linens, Cloths, & Napkins; 1 Lot Assorted Kitchen Appliances Including (2) Mr. Coffees, Electric Mixers, Griddles, Toasters, Ovens, Juice Mixers, Popcorn Poppers, Skillets, Fry Daddys, Can Openers, Etc.; 1 Lot Assorted Kitchen Ware Including Silverware, Dish Sets, Utensils, Pots, Pans, Cookware, Etc.

#### LAWN & GARDEN EQUIPMENT

5 Gasoline & Electric Lawnmowers; 1 DAYTON Electric Lawn Edger; 1 SMITH GARDEN KING Gasoline Powered Sprayer; 1 Pneumatic Tired Wheel Barrow; 1 Leaf Cart; 12 Wheel Lawn Truck; 1 Wrought Iron Love Seat w/2 Matching Chairs, Cushions; 1 Wheel Mounted Aluminum Barbeque Grill; 1 Large Lot Garden Hose, Sprayers, Trimmers, Clippers, Chemicals, Fertilizer Spreaders, Rakes, Shovels, Hoes, and Other Gardening Tools.

#### TOOLS & SHOP EQUIPMENT

2 MONTGOMERY WARD 1/2 H.P. Electric Air Compressors w/Tanks, (1) Wagon Mounted; 1 REM LINE 6 Drawer Roller Tool Chest; 6 Assorted Size & Style Tool Boxes; 9 Assorted Size & Style Lockers, Storage Cabinets, Etc.; 1 Large Assortment of Mechanics & Carpenter Hand Tools; 4 Metal Work Benches, Some w/Vises; 1 Large Inventory of Electric Power Tools Including Saws, Drills, Trimmers, Soldering Irons, Bench Grinders, Hedge Trimmers, Shop Fans, Etc.; 5 Automatic Cord Recoilers; 1 Large Lot Extension Cords, Air Tanks, Step Ladders, Extension Ladders, Gas Cans, Oil Spouts, Etc.; 1 18" Gasoline Chain Saw, (1) Electric Chain Saw; 1 12 Volt Air Compressor.

#### TWO WAY RADIO SYSTEM

(2) Base & (3) MOTOROLA Private Line MOTRAC Mobile Radios w/Antennas, Dash Speakers, Remote Heads, All on Frequency 155.26; 1 REALISTIC Portable Hand Held Rechargeable Radio on Frequency 155.26.

#### NON CLASSIFIED

1 Model HW2 BATTLE CREEK Health Walker; 1 B & H Stationary Exercise Bicycle w/Tension Control, Timer, Odometer (1.3 Miles); 2 Sets Commode Hand Rails; 3 Cords Approximately Oak Firewood; 1 Portable Oxygen Respirator; 2 GENIE Electric Garage Door Openers; 1 Lot Fire Extinguishers; 1 2.5 K.W. KOHLER Gasoline Powered Stand-by Generator w/Accessories; 1 ACRON Portable Fire Resistant Vault; 1 Class C SENTRY Locking Fire Safe w/Table Cover Cabinet; 1 COLE 2 Drawer Letter Size File Cabinet; 1 5 drawer Letter Size File Cabinet; 1 30" X 60" Wood Office Desk; 1 Executive Swivel Arm Desk Chair; 2 VICTOR Electric Adding Machines; 1 ELECTRIC 220 SMITH CORONA Portable Electric Typewriter; 1 Typewriter Table; 1 Inventory of Costume Jewelry, Jewelry Boxes, Valet Stands, Wood Hangers, Etc.; 1 Model 503A Electric SINGER Sewing Machine w/Attachments, Wood Console Cabinet; 3 Electric Heaters; 6 Assorted Table Fans; 2 Blood Pressure Machines; 7 Suitcases & Briefcases; 1 Eye Testing Monacle Set.

HUNDREDS OF OTHER ITEMS

**Sacks Third Ave.**  
P. O. Box 402 203 Main Street Spearman, Texas 79081 806-659-3350

**Back to School Savings on--**

**T Shirts**  
Sizes 8-16  
Reg. 6.35-9.30  
NOW 4.35-7.30

**Jogging Outfits**  
Reg. Tops 18.25  
Pants 13.75  
NOW Tops 14.25  
Pants 9.75

**T Shirts**  
Sizes S, M, L, XL  
Reg. 7.50-10.50  
NOW 5.50-8.50

**Sym Shorts**  
Reg. 6.25  
NOW 4.95

**Purple & White Sweaters**  
Sizes S, M, L  
Reg. 21.50  
NOW 18.50

**Crowneek Sweaters**  
Reg. 13.99  
NOW 9.99

**These prices in effect Thursday Sept. 2 -  
Wednesday, Sept. 8**



# BUY, SELL, TRADE OR RENT THROUGH THE CLASSIFIED ADS

# 659-3434

**OSGOOD MONUMENT CO.**  
Amarillo, Texas  
Dealers of Rock of Ages Granite, as well as all colored granites, marble and bronze memorials.  
  
represented by  
**BOXWELL BROS. FUNERAL HOME**  
519 S. EVANS  
659-3802

**Hansford County Planned Parenthood**  
26 S. Haney  
659-2483  
Spearman  
Mon.-Fri.  
8:30-12:30

**NOTICE**  
Wallace Monument Co.  
Monuments, Curbings, Grave Covers  
Local Representative  
**LEONARD JAMESON**  
Spearman, Texas  
35s-rtm

**STEAM RINSE & VAC**  
Steam Rinse-and-Vac Shampooers; \$10.95 for up to 24 hrs, available at Gordon's Drug; also at Freddie Largent's 716 Cotter Dr. after 4 p.m. and Saturdays and Sundays.

**SERVICE:** Pits cleaned, wet or dry. Dragline or loader. Also, dozer, grader, carry-all service. Lee Roy Mitchell, 806-733-2384, Gruver, Texas 79040  
12-rtm

**SNOOPY'S DAY SCHOOL**  
Open Mon. through Fri. from 7:00 a.m. to 6:00 p.m. Call 659-3328 or come by 620 1/2 Bernice for further information.  
23-rtm

**MONUMENTS**  
Save Agents and Undertakers Profits  
If it is inconvenient for you to visit our large display, please phone collect (405) 327-0626 or write and we will call on you.

**ALVA MONUMENT WORKS, INC.**  
Alva OK 73717

New to area? Give us a try Call your local **USED COW DEALER** As soon as Possible.  
659-3544  
659-3545  
1-800-692-4043  
175-rtm

**S&H ROOFING:** Residential only. Shade Cedar Top, Spanish Tile Repair, Skylight. 5 year warranty on Mobile Homes. We give S&H Green Stamps. Call 806-383-9672 Amarillo.  
39s-rtm

**CAKE DECORATING:** Call: 659-2312.  
39s-7tp

For a lifetime of pleasure, join Shaffer's Dance Class starting Sept. 15 in Perryton. Call 435-4121 for details.  
41-8tc

**CAKES**  
Novelty Showers  
Birthday Anniversaries  
Any Occasion Made to Order  
Call 659-2049  
425-4tp

Roofing-Wood and Composition and repair. Local resident with 22 years experience. Free Estimates. R. W. (Buddy) McMillan Rt. 3, Gruver, 733-5289.  
43-9tp

**Miscellaneous**  
FOR SALE: 261 yards good used carpet with pad. Call 3584 or 3227.  
40-rtm

FOR SALE: Girls new rust pile coat with fur-look trim and hood. Washable-Size 12. Call 659-2739 for more information or come by 1118 S. Haney.  
NC

New Rental Return Pianos at used piano prices. For Complete Details call 316-624-8421. Brier & Hale Music 424 N. Kansas, Liberal, Kansas 67901. 41S-4tc

## Real Estate

**MOVING! MUST SELL** nice 3 bedroom, 1 bath, with Ben Franklin Fireplace, fenced in backyard. 1 1/2 lots. \$25,000 or buy Equity, \$10,000 and assume loan. Shown by appointment only. 512 S. Haney. Phone 9-2463.  
28-rtm T only

**FOR SALE:** 3 bedroom home, preferred southwest location, 2 baths, kitchen has built-ins, recreation room, large utility room, sun deck, single garage, fenced yard, shown by appointment only. Emmett R. Sanders, Realtor, 659-2516, nights 659-2601.  
43-RTN-T only

**FOR SALE:** Beautiful 3 bedroom brick home in Golden Circle addition. Large family room with cathedral ceiling and fireplace. Moderate size kitchen with built in appliances and lots of cabinet space. Separate utility room with walk in pantry and lots of cabinets. 2 baths. Double car garage. Assumable loan. Call 659-3960 for appointment.  
39-8tc

**HOUSE FOR SALE:** 3 bedroom, two bathrooms, fully carpeted, basement, formal dining room, detached garage, sprinkler system, corner lot in nice neighborhood. Owner will finance. Reasonable down payment and interest rate. Call Cynthia Floyd 659-3308 or 659-3123 for appointment.  
28s-rtm

## Automobiles For Sale

**FOR SALE:** 1976 Volkswagen Rabbit. Loan value \$1,754, new tires, excellent condition, AM/FM cassette tape player with 4 speakers. 2 Sony's, 2 with large magnets on back. 44,000 miles. 30+ mpg on highway, 24+ mpg in city. Call 659-3484  
42-rtm

**FOR SALE:** 1982 Chevrolet Cavalier, 4 door, 13,000 miles. Very plush, small luxury car. Good gas mileage. We need a larger car. Call 733-2157.  
42S-2tp

## Garage Sales

**Garage Sale** 202 S. Brandt St. August 30 through Sept. 4. Clothing, furniture, toys and misc. Good Bargains!  
42S-2tp

## Mobile Homes For Sale

**WE TAKE TRADES-ANYTHING OF VALUE!** Used cars, boats, mobile homes, real estate, etc. Large selections of 2 & 3 bedroom Value Brand Mobile Homes. Easy Terms. **FIRST QUALITY MOBILE HOMES** 665-0715 Pampa, Texas.  
66S-30tc

**DEALER REPO!** 2 bedroom Mobile home. Good condition, garden tub, bay window, wet bar, etc. Assume payments of \$244.04 with approved credit. **FIRST QUALITY MOBILE HOMES** 665-0715. Pampa, Texas.  
42S-30tc

**For Sale:** 12 x 65 mobile home, 2 bedroom, new carpet, new furniture & new appliances, central air & skirting. Call 659-2248.  
42S-4tp

## Help Wanted

First United Methodist Church needs nursery worker. If interested call 659-3220.  
44-6tc

**HELP WANTED:** School has started and we need Avon Representatives. Representatives usually earn \$6. to \$10 an hour. If you are interested, call collect-274-3606.  
42S-8tc

\*\*\*\*\*  
We believe most people are ready for autumn this year.

## Wanted

**WANTED:** used boat, motor trailer. Must be cheap! Just for local fishing--659-2338.  
38-nc

Will do any kind of work. Call Steve Lopez at 659-2845.  
43-1tp

## To Give Away

**PUPPIES TO GIVE AWAY:** Call 659-2827.  
43-2tc

## Legal Notice

**CONTRACTOR'S NOTICE OF HANSFORD COUNTY BRIDGE CONSTRUCTION**  
Sealed Bids, addressed to Weldon Green, Auditor, Hansford County, Spearman, Texas 79081, will be received at the office of the County Auditor and/or the Commissioner's Court until 1:00 p.m., Central Daylight Time, September 13, 1982 for furnishing all plant, labor, materials and equipment and performing all work required for the construction of one multiple box culvert, 2-10 x 9-28, across Farwell Draw, located 0.9 miles West from the intersection of Main and Broadway in Gruver, Texas and South 0.4 miles.  
All proposals shall be accompanied by cashier's or certified check upon a national or state bank in the amount of 5% of the total maximum bid price payable without recourse to the Commissioner's Court of Hansford County, Texas or a bid bond in the same amount from a reliable surety company, as a guarantee that the bidder will enter into contract and execute performance and payment bonds within ten (10) days after notice of award of contract to him. The notice of award of contract shall be given by the Owner within ten (10) days following the opening of bids.  
The successful bidder must furnish performance and payment bonds upon the forms provided in the amount of 100% of the contract price from an approved surety company holding a permit from the State of Texas to act as surety.  
The right is reserved, as the interest of the Owner may require, to reject any and all bids, and to waive any informality in bids received.  
Plans, specifications and bidding documents may be secured from the office of Harvey W. Schmidt, Consulting Engineer, 314 Sunset, Amarillo, Texas 79106.  
Attention of bidders is directed to the provisions of Article 5159 A, Revised Civil Statutes of 1925, as amended, requiring that not less than the general prevailing rates of per diem wages for work of a similar character in the locality where the work is performed, shall be paid all laborers, workmen and mechanics employed in the construction of the foregoing project.  
Bidders shall inspect the site of the work and fully inform themselves as to the conditions and matters which can in any way affect the work or the costs thereof.  
**THE COMMISSIONER'S COURT HANSFORD COUNTY, TEXAS BY: ROY L. McCLELLAN COUNTY JUDGE**  
43-2tc T ONLY

**POST OFFICE TO BE CLOSED LABOR DAY**  
The Spearman Post Office will be closed Monday, September 6, in observance of Labor Day.  
As Labor Day is a widely observed holiday, there will be no in-coming or out-going mail service.  
T. Ray Robertson, Postmaster

\*\*\*\*\*  
The time to start saving for your old age is today; you will never begin at some time in the future.

**Offered Exclusively By EMMETT R. SANDERS, REALTOR**  
  
100' by 140' commercial zoned with 26' by 32' concrete block shop building, close to downtown on Dressen Street.  
\*\*\*\*\*  
Nearly new builder's home, 4 bedrooms, 2 1/2 baths, basement, double garage, fenced yard, large tool-house, numerous amenities; shown by appointment only.  
\*\*\*\*\*  
Nice 2 bedroom home on 100 ft. corner lot adjacent to junior high and elementary school. Carpets, drapes, refrigerated air, basement, shake roof, separate one room and bath bachelor's quarters. Estate settlement.  
\*\*\*\*\*  
2 bedroom home, immaculate interior, fenced yard, detached garage, loan assumption with \$4,000.00 down payment. New furniture optional. Shown by appointment.  
\*\*\*\*\*  
Choice commercial location fronting 140 ft. on West Kenneth Street.  
\*\*\*\*\*  
Attractive 3 bedroom brick home, near Elementary School on Dressen St. Call for appointment.  
\*\*\*\*\*  
**EMMETT R. SANDERS REALTOR**  
659-2516  
659-2601 [nights]  
40-rtm T ONLY

**PUBLIC NOTICE**  
A proposed use hearing for general revenue sharing purposes will be held on September 14, 1982, for all interested citizens of the City of Spearman. The amount of general revenue sharing funds to be discussed for this fiscal year is \$31,436.00. The meeting will be held at 8:00 p.m. for the purpose of discussion of proposed uses of general revenue sharing funds at City Hall, 221 Sanders, Spearman, Texas. All interested citizens will have the opportunity to give written and oral comment on uses of the funds. Senior citizens are encouraged to attend and comment.  
43-1tc

## Card Of Thanks

I want to thank my friends for the flowers, cards and calls and the directors of Stationmaster's Museum for the pot plant while I was in St. Anthony's hospital.  
Ernest Newcomb

Just a note to say thanks to all my friends who were so thoughtful after my accident. Your prayers, calls, visits, gifts, cards, and flowers were much appreciated.  
Perry Dixon

We wish to thank everyone for the flowers, food, cards, calls and other acts of kindness shown to us after Joan's accident.  
May God bless each of you.  
Billy, Joan & Ashley and Bernice Brown

**TOO LATE TO CLASSIFY FOR SALE:** Heritage campaign gold tuxedo couch. Call 733-2958.  
2tc

**COLLEGE STATION** — Automobile owners should get used to the idea of higher fuel taxes and other fees to finance construction, repair and research on the nation's strained interstate highway system, says a transportation expert.  
"Obviously, new sources of revenues — taxes and fees — will be needed to address the problems of new construction, proper rehabilitation of existing roads and to accommodate the exploding new growth in Texas," said Dr. C. V. Wootan, director of the Texas Transportation Institute, a research agency.  
He said many transportation officials feel that money for building and repairing roads would come from user fees such as gasoline tax, license tag fees and earmarking sales taxes on new cars for highway purposes.

**TTI researcher says user fees needed to finance highways**  
Double duty . . . sprout hearts of celery in jars of water on kitchen counter. They'll look pretty and the tops can be snipped for use in salads and soups.

**KOEHN**  
Mobile Homes  
508 East Pancake  
Liberal, Kansas 67901  
Phone: 316-624-0338  
"Specializing in more QUALITY AND VALUE for your dollar!"  
CHAMPION  
MHMC  
OPEN SUNDAY AT 2 P.M.  
24-rtm

**CHRISTMAS MONEY!!**  
Homemakers-you can earn to \$2,000 or MORE plus FREE GIFTS plus a TRIP TO HAWAII demonstrating quality toys and gifts.

**FREE**  
The first 10 signing and qualifying from this ad receive \$20.00 in FREE MERCHANDISE!!  
No delivering-No collecting-FREE Hostess gifts. Call Raelene 435-2561 Now!!

Gifts 'n Gadgets-Our 32nd year.  
44S-4tp

**Need man to manage irrigated farm. Must have experience. New home furnished.**  
Phone  
405-338-5506  
or 405-338-7307



The first wristwatch of which there is any record dates from 1790, and is itemized in the accounts of the Swiss watchmakers Jaquet-Droz and Leschot of Geneva as "a watch to be fixed on a bracelet."

Facts are better than dreams, if pleasant.

## TFU head calls for homestead protection

Testifying before two committees of the Texas Legislature, the President of the Texas Farmers Union asked that the Legislature abandon efforts to weaken Texas' homestead protection laws.

Noting that Texas currently has the strongest homestead law of any state in the nation, TFU President Mike Moeller said that any changes in the law would be a major step backward for Texas farmers and ranchers as well as urban homeowners.

Moeller said, "During the last Depression, many Texas farm families were able to survive because they were able to keep their house and up to 200 acres. With another Farm Depression upon us, this protection of our homesteads is more important than ever."

According to Moeller, opening Texas homesteads up to second and third mortgages would probably result in lenders requiring homesteads to be pledged as additional collateral for existing loans. "With farm real estate values declining," Moeller said, "And farmers unable to pay the interest on existing loans, it is entirely possible that a farmer could end up losing his homestead and receive no equity whatsoever."

Moeller pointed out that attempts to weaken Texas' homestead law in 1979 and 1981 had "gone down in flames" and predicted that any such effort in 1983 would meet with strong resistance by Texas' homeowners and landowners.

**EMMETT R. SANDERS REALTOR**  
659-2516  
659-2601 [nights]  
40-rtm T ONLY

## Political Announcements DEMOCRATIC PARTY

For U.S. Congressman  
13th District  
**JACK HIGHTOWER**

State Representative  
88th District  
**J.W. "BUCK" BUCHANAN**

## REPUBLICAN PARTY

State Representative  
88th District  
**R.C. PORTER**

## TEXAS PRESS ASSOCIATION

**The Spearman Reporter**  
PUBLICATION [USPS 509-660]  
SPEARMAN, TEXAS 79081  
213 Main Box 458 659-3434  
Published Weekly at 213 Main Street  
Spearman, Texas 79081  
Owner-Publisher.....William M. Miller  
Editor.....Faye Lynch  
Second Class postage paid at Spearman, Texas 79081

Any erroneous reflection upon the character of any person or firm appearing in these columns will be gladly and promptly corrected upon being brought to the attention of the management.

POSTMASTER: Send address changes to Spearman Reporter, Box 458, Spearman, Tx. 79081.

SUBSCRIPTION RATE: Hansford, adjoining counties, combination with the Hansford Plainsman \$15.00.  
Other points, \$20.00.



Before storing leftover yarn, snip a strand from each and tape to the outside of the box. At a glance you'll know what the box contains.

\*\*\*\*\*  
We're now ready to see a few good football games.

\*\*\*\*\*  
This is the time of year to check your fire insurance.

**For The Ultimate In STORM DOORS & WINDOWS**  
Custom Built, Designed, And In Colors To Fit Your Home....  
Contact Howard Moyer at  
**Only Aluminum Industries**  
Guymon, Okla. 405-338-6966 or 73942 114 W. 1st 405-338-6176 AFTER 6 P.M.

**VIRGINIA WHITE**  
Realtor



This 3 bedroom brick home has a NEW ROOF, large corner lot, near school, and PRICE HAS BEEN GREATLY REDUCED. By appointment only.

\*\*\*\*\*  
James St.-NEW ROOF, 3 bedrooms, Cen./Heat & air Cond., 2 1/2 X 30 detached garage, big lot. PRICE REDUCED by appointment only.

\*\*\*\*\*  
Roland St.-2 bedroom house, Cen./Heat. Double garage with apartment/ Large lot, storage bldg., storm cellar. PRICE GREATLY REDUCED. BY APPOINTMENT ONLY.

\*\*\*\*\*  
RESIDENTIAL LOTS FOR SALE--southwest location.

\*\*\*\*\*  
659-3841

**Need man experienced with livestock to work at small feed yard.**  
Phone  
405-338-5506  
or 405-338-7307



## Karen's Kogy Korner

Karen Horvath  
Harris County Extension Agent  
Home Economics

### PREVENT FRUSTRATION IN THE FABRIC STORE—PLAN PURCHASES AHEAD

Decision-making in the fabric store is difficult for many home sewers. To help prevent confusion and frustration caused by the large selection of fabrics and notions available—and to assist home sewers in getting the quality of finished product they want—some advance preparation can be made.

Deciding on pattern, fabric and notions can be an exciting and creative experience. The home sewer can take these steps to help be more confident of choices and realize more satisfaction with products selected.

#### STEPS IN GETTING "READY TO BUY"

1. Study fashion forecasts, magazine and newspaper advertisements to help identify outstanding colors and styles for the coming season, and to determine "likes" and "dislikes".
2. Visit ready-to-wear stores to observe styles and fabrics. Observe the weight, texture, color and overall designs of the fabrics used, which fabrics are used with which styles, and which fabrics are most popular. Check fabric hangtags to learn which fibers are being used and whether the care required is what is wanted.
3. Try on garments to see which styles and colors flatter the figure and face. Don't make garments that aren't flattering—regardless of how fashionable they are.
4. Study the clothes in your closet! Can some of these garments be adjusted to meet needs for the coming season, or will new garments be required? For the new purchases needed, plan them so they can be mixed and matched with clothes from past seasons. Existing wardrobes can be updated by adding a fashionable skirt, a simple blouse or a few accessory items.

After home sewers have completed their homework before heading for the fabric store, there are other shortcuts to help speed-up decision-making in the store.

#### AIDS TO "IN-STORE" DECISIONS

Upon entering the fabric store, the following shortcuts may help in speeding up decisions:

1. Go directly to the pattern catalog section and check pages for the pattern type

you are seeking. It's best to have a specific pattern in mind before looking at fabric.

2. If your time is limited, look for a pattern to save time. "Quick and easy patterns" are those with few seams, straight lines and little or no fitting required; few pattern pieces—usually 4 to 6; absence of such fine details as pin tucks or topstitching; little or no hand-sewing; single closures, and with both the left and right side cut by the same pattern.

3. Read the pattern envelope for suggestions on fabrics—and any possible fabric restrictions. Also, check colors and characteristics of the fabrics, as suggested on the pattern envelope.

4. If sewing experience is limited, select fabrics that are simple to sew. These include non-slippery plain weaves, solid colors and small designs, fabrics that do not ravel and have little or no surface finish. Consider colors and textures which were most flattering to you in your earlier "fabric tests" in ready-to-wear stores. "Re-test" these fabrics by draping them about your shoulders and view them in a mirror to make sure the fabric accentuates your natural coloring.

5. Before making your final decision, check the care label, your budget, and determine how the fabric will fit into the existing wardrobe.

EDUCATIONAL PROGRAMS CONDUCTED BY THE TEXAS AGRICULTURAL EXTENSION SERVICE SERVE PEOPLE OF ALL AGES REGARDLESS OF SOCIO-ECONOMIC LEVEL, RACE, COLOR, SEX, RELIGION OR NATIONAL ORIGIN.

#### A&M biochemist says iron deficiency is worldwide problem

COLLEGE STATION — Nearly 20 percent of women in their child-bearing years exhibit some degree of iron deficiency ranging from iron depletion to anemia, warns a Texas A&M University biochemist.

Iron deficiency ranks as the most serious nutritional disease in both humans and plants today, said Dr. George Bates, and is second only to protein/calorie malnutrition in the worldwide severity of its effects.

## Local CCD Teachers Attend Workshop

The Sacred Heart Catholic Church's CCD teachers traveled to Perryton to attend a 2½ hour workshop. It was a very interesting workshop with Sister Cristina and Sister Elizabeth Marie—who are Daughters of St. Paul from San Antonio. For those that were already CCD teachers, they got a review of many things, for those that were to teach for the first time, well they learned alot, like how to make lesson plans, when and what to show on a Sunday—this being somewhat of film.

Those attending from Gruver included Diane McLain—to teach 9th and 10th, Gerry Davis—to teach 2nd graders for First Communion and Pam Stork—to teach 5th and 6th graders.

There were 4 from Spearman, Bob Farr—to teach 11th and 12th graders, Maria Pacheco—to

teach 7th and 8th graders, Criselda Vela—to teach 3rd and 4th graders and Rosemary Brown—to teach 1st graders.

Lyle and Nancy Coombs are the "official" Secretary's of the Sacred Heart CCD Program. They will also be Aides—helping out whenever possible, being substitutes whenever needed, they will take care of the film projector and run it while the teacher teaches, and so on.

Now, other Aides—to be Substitute Teachers—that did not make it to the Workshop were Tammy Janzen and Lynna Renner. Father Raymond Crosier was also on hand for this fine workshop.

Sister Cristina and Elizabeth Marie took turns explaining to the CCD teachers from the Sacred Heart Catholic Church of Spearman and the CCD Teachers from the Immaculate

Conception Catholic Church of Perryton, the how to's and the how not to's teach a student. There are many different ways. The Workshop began at 2:00 and was over at 4:30 or so in the afternoon.

The CCD Coordinator's for the Sacred Heart Catholic Church's programs include Bob Farr and Diane McLain—Mr. Farr from Spearman and Mrs. McLain is from Gruver.

I'm sure that the new CCD teachers now have a better idea and a better understanding as to how and what to teach their students and how to keep their attention.

Have you ever wondered why it's so much easier to tell someone else how to do something than it is to do it yourself?

## Art show, sale set at First National

More than 100 art pieces will be on display later this week at the First National Bank. The Bank, moving towards a gala open house on its new facilities in mid-September, is rolling out the red carpets to some 60 area artists to showcase their wares.

The bank also plans to purchase about one-fourth of the wall artwork for permanent display in various offices and conference rooms. Nearly all types of mediums will be represented, from photographs to oil and water colors.

The artists will be setting up their works Wednesday morning in the two community rooms on the lower floor. Out of the 120 or so art pieces, the bank will be choosing 25 to 30 pieces to purchase.

Thursday, at noon, the art work goes on display to the

public. Most of the art will be for sale and this should be an excellent time for art enthusiasts to do some browsing as well as purchasing. The artists are all from a 100-mile radius of Perryton. The public showing will continue through 3 p.m. Friday.

Judging the work are Claus Heppner, James Haney, Vincent and Carolyn Tolpo, and two representatives of the bank. Heppner is the interior designer for First National while Haney is the owner of a gallery in Amarillo. The Tolpos are from Colorado and were commissioned by the bank to do two large wall paintings, which measure nearly two stories high.

The bank also announced that Martha Keim has been commissioned to do 10 paintings for the bank.

The art show and sale is the culmination of several months of planning by the bank.

The construction project is nearly complete, with the installation of landscaping and inside plants to be done. In 1982, of course, the bank is celebrating its 75th year of operation.

It all adds up to an art lover's feast, so be sure to be a part of it.

Larry Speakes, deputy press secretary, on dropping interest rates:

"The president believes this is another encouraging sign of economic improvement."

Who can remember the old religious camp meetings?

PRICES GOOD THROUGH SEPT 4



QUANTITY RIGHTS RESERVED

IN UNITED'S ALL NEW

# CASINO BINGO

YOU'RE SURE TO WIN!

GAME 3

 <p><b>UNITED POTATO CHIPS</b> 8 OZ. TWIN PACK <b>68¢</b></p>	 <p><b>BANQUET DINNERS</b> ALL FLAVORS EXCEPT HAM, BEEF &amp; FISH <b>48¢</b></p>	 <p><b>FINE FARE CHARCOAL BRIQUETS</b> 10 LB. BAG <b>\$1.38</b></p>
 <p><b>KRAFT BARBEQUE SAUCE</b> 18 OZ. ALL FLAVORS <b>49¢</b></p>	 <p><b>FINE FARE MUSTARD</b> 24 OZ. <b>59¢</b></p>	 <p><b>KRAFT DILL CHIPS</b> 32 OZ. <b>89¢</b></p>
 <p><b>PLAY UNITED'S CASINO BINGO</b> ATLANTIC CITY</p>	 <p><b>UNITED CONES &amp; HAMBURGER BUNS</b> 8 CT. <b>38¢</b></p>	 <p><b>VAN CAMP PORK &amp; BEANS</b> 16 OZ. <b>28¢</b></p>
 <p><b>COKE &amp; TAB</b> 6 PK 32 OZ. <b>\$1.89</b> + DEPOSIT</p>	 <p><b>DOUBLE STAMPS</b> WITH A \$2.50 PURCHASE OR MORE EXCLUDING CIGARETTES</p>	 <p><b>SAT.</b> GREEN STAMPS</p>
 <p><b>ANTI PERSPIRANT SURE</b> 2 OZ. SOLID 2.5 OZ. ROLL-ON 4 OZ. SPRAY <b>\$1.79</b></p>	 <p><b>FINE FARE NAPKINS</b> 140 CT. <b>69¢</b></p>	 <p><b>HEFTY FOAM PLATES</b> 50 CT. 9" <b>\$1.89</b></p>
 <p><b>NUMBER ONE RUSSET POTATOES</b> 10 LB. BAG <b>\$1.59</b></p>	 <p><b>"GARDEN FRESH PRODUCE"</b> GOLDEN RIPE BANANAS 1 LB. <b>29¢</b> GREEN LEAF LETTUCE LARGE BUNCH 3 FOR <b>99¢</b> GREEN ONION OR 6 OZ. CELLO RADISHES 4 <b>\$1</b></p>	 <p><b>THOMPSON SEEDLESS GRAPES</b> 1 LB. <b>69¢</b></p>

## Strake Talk

### TWO TERMS IS ENOUGH

Texans have a healthy skepticism of their elected officials, a wariness of entrenched power that they have embodied in the state constitution. They have historically refused to keep top state officeholders more than a few terms.

Now my opponent comes along, having spent nearly ten years in the Lt. Governor's office, one of the top state policy-making offices. Mr. Hobby wants yet another term to make it 14 years in that crucial job. That is unprecedented. Never in Texas' history has any Lt. Governor served that long—or wanted to.

His desire, frankly, puzzles me. You would think he would have other goals, other challenges he might want to tackle. As his primary opponent this year said, "If he had anything to get done, you'd think he would have done it by now."

My opponent will tell you that experience is what counts. I think voters need

to look at the experience they have had with him. After ten years, our highways are in bad shape, the quality of education has declined, we still do not have a new, statewide water plan and he has refused to tackle the growing crime problem. We can't afford more of that kind of experience.

I have a long-held belief in what I call the citizen-politician: someone who holds a job, serves his country or state for a reasonable time, then returns to that job and private life. For that reason, the first order of business after I am elected will be to have a constitutional amendment introduced in the legislature limiting the Lt. Governor to two terms—eight years. That is enough time for anyone. Too great a concentration of power for too long is bad. That is a principle of democracy.

If you have any thoughts on this subject, please write me at 1213 W. 34th, Austin, 78705.

*George W. Strake*  
George W. Strake, Jr.



# YMCA NEWS

## BOY'S & GIRL'S FLAG FOOTBALL & CHEERLEADING

The Hansford County YMCA will offer these three programs for boys and girls in the 1, 2, 3, 4, 5, and 6th grades beginning with clinics and practices on Saturday, September 11th.

Girl's Flag Football is a new program this fall and will be for girls in the 4th, 5th and 6th grades. Boy's Flag Football will be for those in the first through sixth grades. A clinic and practice will be conducted on Saturday, September 11th from 10 a.m. - 11:30 a.m. on the field east of the Y. Teams will be organized at that time. Practices will be during the week, after school. Games for the boys will be on Saturday mornings, with girls games in the afternoon. Not knowing the number of girl's teams and the like the number of games and times will be determined by the coaches and announced after organization.

The cost for the Flag Football will be \$7.50 for Y members and \$15.00 per child for non-Y members and includes T-shirt which is kept. Any parent who would like to assist in the Flag Football program as a coach or assistant coach is asked to call the YMCA or make a designation on the registration form.

Girls' Cheerleading will be continued for those girls in the 1st, 2nd and 3rd grades. Cindy Schneider will help coordinate the program and arrange for the junior high school cheerleaders to conduct a clinic on Saturday, September 11th from 9:30 a.m. - 11:00 a.m. The girls will be cheerleading during the boys' flag football games on Saturday mornings, beginning September 18th. Cost is for Y members \$7.50 and non-Y members is \$15.00 which pays for a T-Shirt. SQUARE DANCE LESSONS, VOLLEYBALL AND AEROBICS Square Dance Lessons will be offered at the Hansford County

YMCA beginning September 21 (Tuesday) and continue Tuesdays and Thursdays for about 10 weeks under the instruction of Jimmy Shieldknight. If you would be interested in learning and joining the class call either 659-3460 or 3519 and enroll today.

Women's Volleyball League will begin with practices Tuesday, September 7th and Thursday, September 9th. Plans are to begin league play the week of September 13th in the junior high school gym. To enroll as a team or individual please call the YMCA 659-2591. The cost is \$50 per team and each team player must have a current YMCA membership to participate.

Women's Aerobic Exercise classes will begin the fall schedule on Tuesday, September 7th, with the evening class from 6:45 - 7:45 p.m. Wanda Archer is the instructor for the evening aerobics classes which meet Tuesday and Thursday evenings at 6:45 and on Saturday

mornings at 10:00 a.m. Each class is for 6 weeks and cost \$20 per session for those with a regular Y membership and \$10 for 6 weeks for those with a Fitness Center Membership. Cindy Schneider teaches the morning aerobics classes on Mondays, Wednesdays and Fridays from 9:00 - 10:00 a.m. The cost for these 6 weeks of classes is the same \$20 and \$10 per session. A YMCA membership is required to participate in these aerobics classes.

**Barry Goldwater, Senator, (R-Ariz), on Taiwan arms reduction:**  
"The act (Taiwan Relations Act) governs our relationship with Taiwan including arms sales."

**Ted Torda, Commerce Department economist:**  
"It appeared the economy was bottoming out from the recession and was on the verge of recovery if not actually (in) it."

## 8th Annual Allsup's marathon

The 8th Annual Allsup's/Clovis Marathon is slated to begin on Saturday, 7 a.m. October 9, 1982 in Clovis, N.M. Over 400 entrants are expected to enter this year's event which is certified by the Amateur Athletic Union (AAU).

The Allsup's/Clovis Marathon, sponsored by Allsup's Convenience Stores, Inc., will offer runners a flat, asphalt surface with choice of three courses: 26.2 mile marathon, 13.1 mile half marathon, and a 10 kilometer course. Classes include: Men: 1st five in up to 14, 15-29, 30-39, 40-49, 50-59, 60 plus age groups with trophies for the first 5 overall and first 3 in each class. Women: 1st three in up to 15, 16-29, 30-39, 40 plus age groups with trophies for the first 3 overall and first 3 in each class.

In addition, Joe Henderson, world famous writer, editor and speaker on the subject of running will be in Clovis to compete and as guest speaker.

Mr. Henderson will speak at the kick-off dinner to be held Friday, Oct. 8th, beginning at 7 p.m., mountain time. He is presently the Executive Director of International Runners Committee and holds many coveted honors and awards including being a former state high school champion 7 times in cross country and track in Iowa. He has won the Road Runners Club of America Journalism Award, he is in the RRCA Hall of Fame as well as being the author of 11 popular books on the subject of running.

All runners are invited to come to the dinner and hear Joe Henderson speak, and compete in the 8th Annual Allsup's/Clovis Marathon. You may register until Oct. 8th at 8 p.m. by writing Royce Jones, 3532 Brynhurst Court, Clovis N.M. 88101 or by calling (505) 762-5010. Registration fee is \$7.00 before September 25th and \$9.00 after the 25th. All proceeds go to the Clovis Roadrunners Club.

## Explorer post to sponsor benefit dance

The explorer post 510 in Spearman will be sponsoring a 24 hour dance to benefit the Muscular Dystrophy Association. The "extra special special" dance will begin at 3 PM, Sunday, September 5 and continue to 3 PM, Monday.

The event has become an annual affair during the Labor Day Telethon to raise money for research and patient services for those afflicted with muscular dystrophy.

If you enjoy dancing, whether country, disco or rock-n-roll, then you should be a participant. You can attempt to "get down" for the entire 24 hours or you can be like most of us and simply "dance" for an hour or so. Be it as you wish, contact any explorer of Spearman's Post 510 for details, or to obtain a sponsor packet.

The dance will be at the Spearman Fire Station, 513 S. Hazelwood, and will be open for attendance, (for a small set donation at the gate) the entire 24 hours.

The explorers have worked very hard preparing for this year's dance and the event promises to be one of the greatest. The light show and music equipment are tremendous.

Remember the dance is 24 hours beginning at 3 p.m. Sunday, September 5th at the fire station. The proceeds go entirely to muscular dystrophy to fight over 35 diseases, 24 hours a day, 365 days a year. Explorers and their telephone numbers: David Sorgi 9-3845, Scott Bullard 9-3319, Stephanie Tebeest 733-2879, Julie Deakin 733-2837, Ken Schaffer 9-2415, Kenny Bullard 9-3319

## Harston named TT coach

Kathy Harston, former Wayland Baptist University cage star and 1978 All-American, has been named the Texas Tech Assistant Women's Basketball Coach for the 1982-83 season as announced late Tuesday, Aug. 24, by Women's Athletic Director, Jeannine McHaney.

"This opportunity to coach basket on the collegiate level was too good to pass up," said Harston. "Texas Tech Women's Basketball is on the upswing. I can see only great things in its future. I also enjoy the college atmosphere and I like the West Texas Area."

Harston, 23, was a four-year letter winner at Wayland Baptist from 1976 to 1980. Her collegiate performances earned the 5-10 guard a final nomination for the prestigious Wade award in 1980. She is the third leading career scorer in Flying Queen history and has landed numerous MVP honors through out her collegiate career. Harston was also an outstanding forward at Southlake's Carroll High School where she led her team to a state championship in 1975 and was named to the All-State basketball squad for three consecutive years.

Texas Tech head basketball coach, Marsha Sharp, is optimistic about Harston's appointment to the Red Raider coaching staff.

"Kathy brings a great deal of expertise to our team and is particularly knowledgeable in the types offenses and defenses we plan to use this season. Her experiences as an All-American guard at Wayland Baptist should be a big help in strengthening our guard situation. Kathy is well-known in this area and in the state of Texas and should be an asset to our recruiting program."

Harston was the head basketball coach at Hale Center High School in 1980-81 where her team finished the season with a respectable 19-10 record, winning the second half of district.

She received a Bachelor of Science degree in Health and Physical Education from Wayland Baptist in 1980 and a Master's of Education degree from North Texas State University in 1982.

Harston will join Linden Weese as an assistant Women's Basketball coach under coach Sharp. Her appointment will become effective Sept. 1, 1982.

## Tri-State Fair amusement and rides

Take a ride on the Loop-O-Plane or try a jump from the Paratrooper. Or how about a whip-cracking ride on the Tilt-A-Wheel? Try it all with a foot-long hot dog in one hand and a stick of cotton candy in the other. You will find all this and more at the Bill Hames Shows during the Amarillo Tri-State Fair, September 20-25.

for the kiddies such as the Ferris Wheel, Merry-Go-Round and Pony Ride. And then there are the super rides for the brave of heart like the Twister, Toboggan, Coaster, Zipper on the Scrambler.

Buster Brown, president of Bill Hames Shows, is constantly bringing the newest, most thrilling rides to the fair midway each year.

There are the traditional rides Personal income up in July. France getting tough on terrorism.

**ATTENTION LIVESTOCK PRODUCERS:**  
**CATTLEMAN'S LIVESTOCK COMMISSION CO.**  
Box 50, Dalhart, TX 79022  
Phone (806) 249-5505  
4 miles West of Dalhart on HWY 54.

- Hog Sale every Wednesday
- Starts at 10:00 a.m.
- Cattle Sale every Friday at NOON

**MARKET REPORT**  
**HOG MARKET**  
**WEDNESDAY, AUGUST 25**

Sold 287 Hogs	
Top Hogs	\$61 to \$63.50
Sows	\$48 to \$54
Boars	\$42 to \$45

**CATTLE MARKET**  
**FRIDAY, AUGUST 27**

Sold 2424 Cattle	
Butcher Cows	\$34 to \$44
Butcher Bulls	\$44 to \$54
Heiferettes	\$45 to \$58
Cutting Bulls	\$58 to \$62
Feeder Steers	600 to 700 lbs. \$66 to \$69.50
	700 to 800 lbs. \$64 to \$69
	800 to 900 lbs. \$63 to \$67
Feeder Heifers	500 to 700 lbs. \$58 to \$63.50
Steer Calves	300 to 400 lbs. \$70 to \$85
	400 to 500 lbs. \$65 to \$75
Heifer Calves	300 to 400 lbs. \$57 to \$65
	400 to 500 lbs. \$57 to \$63

**WE WANT TO CONTRACT CATTLE FOR FALL DELIVERY CONTACT LARRY WING.**

**WE NEED YOUR COWS & BULLS IN THE DAY BEFORE THE AUCTION IN ORDER TO COMPLY WITH FEDERAL AND STATE REGULATIONS AS TO BLOOD TESTING. THE STATE OF TEXAS PAYS FOR THIS TESTING.**

**WE ARE NOW OFFERING A SELL & BUY BACK PLAN FOR CATTLE.**

**WOULD LIKE TO LEASE RANCH, YEAR ROUND BASIS.**

**WE ARE THE DEALERS FOR THE NECK-OVER TRAILERS.**

**LARRY WING, MANAGER, RES. 806-249-2402**  
Kenneth Knight, Asst. Manager 806-384-2136  
Craig Lawrence, Yd. Foreman 806-384-2153

**FIELD REPRESENTATIVES:**  
George Wall, Clayton, N.M. 505-374-9550  
Greg Wade, Canyon, TX 806-655-3409

**AREA WINNERS**

 CONNIE ALONZO \$100	 JOHNNY HERRERA \$1,000	 MRS. MARSALIS \$100	 RUBY RAMIREZ \$50
--	---	--	---

**OVER 50,000,000 STAMPS TO WIN NOW \$400,000 IN CASH GAME PRIZES OVER 122,700 POSSIBLE WINNERS**

**DECKER QUALITY HALF HAMS**  
WATER ADDED BONELESS  
\$1.98  
3 TO 5 LB. AVG.

**OWENS COUNTRY SAUSAGE**  
2 LB. PKG. REG. HOT, MILD  
\$3.57  
1 LB. 1.79

**FINE FARE BOLOGNA**  
12 OZ. PKG.  
\$1.19  
SALAMI 1.19

**KRAFT HALF MOON CHEDDAR CHEESE**  
\$1.98

**KRAFT AMERICAN SINGLES**  
\$1.19

**GOOCH GERMAN SAUSAGE**  
\$1.59

**RANCHER SUMMER SAUSAGE**  
\$1.19

**RANCHER HOT LINKS**  
EXCELLENT FOR COOKOUT  
98c

**DECKER QUALITY OR FINE FARE FRANKS**  
12 OZ. PKG.  
88c

**FRESH FAMILY PAK GROUND BEEF**  
88c

**DOUBLE STAMPS WED.!**  
WITH A \$2.50 PURCHASE OR MORE EXCLUDING CIGARETTES

**PLAINS SOUR CREAM & DIPS** 8 OZ. 2 FOR \$1.89c

**PILLSBURY CRESCENT ROLLS** 8 OZ. 2 FOR 89c

**YOPLAIT YOGURT** 6 OZ. REG. ALL FLAVORS CUSTARD STYLE 2 FOR 89c

**"FROZEN FOOD"**

**GREEN GIANT CORN ON THE COB** 4 CT. \$1.19

**COLE'S GARLIC BREAD** 99c

**MINUTE MAID CHILLED DRINK**  
LEMONADE & FRUIT PUNCH 64 OZ.  
89c

**UNITED Supermarkets**  
Perryton, Texas



# Greyhounds growl mean; bite Vega Friday!

"If we beat Vega, we are going to win a lot of ball games! They are a good ball team."

That was the first direct quote of the new football season from Gruver Greyhound Head Coach Rick Nix as he revealed his opening lineup for the opening game against Vega, Friday night.

The season opener is a home game.

Coach Nix and his highly qualified staff have led their Greyhound gridsters through scrimmages with Hooker, Okla. and with Dalhart.

They "skunked" the Hooker squad and Coach Nix said both

first and second 'Hound squads came off equally good in this scrimmage as did his two quarterback prospects for the season. This was no mean feat for a check with Oklahoma grid raters finds Hooker considered no slouch as a contender in its class on Sooner turf.

Then Rick Nix prefaced the Dalhart scrimmage a week later with the observation:

"We will find out how good we are -- or not, tonight."

The Monday following this scrimmage, Nix was questioned about the clash and "how good were you?"

He grinned and said, "...not as good as Dalhart!"

"But that's no put-down in anybody's league and assessing what they saw, Nix and staff come up with our opening statement.

"Vega's strong point is defense," Coach Nix said. "But they're no pushover offensively. I watched their White Deer scrimmage and their Stratford scrimmage. These were both strong squads last year.

"Well, Vega just went through White Deer like a sieve. The Stratford scrimmage was about even. In fact, I would

say that is the hardest hitting scrimmage I ever witnessed!"

The Greyhound mentor said Vega had three men that were outstanding on an overall good team. They were Brian Taylor who plays both linebacker and tailback; Harold George, nose guard and guard on offense and Dale Marchman who plays both offensive and defensive tackle.

Looking to down Vega because "...he wants to win a lot of ball games," Rick Nix will be fielding the following offensive lineup:

Chad Logsdon, quarterback; Carlton Collier, halfback; Rodney Clawson, fullback; Monty

Hawkins, tight end; Stanley Fletcher, quick end; Don Dilow, quick tackle; Durwood Cator, quick guard and John Shipp, center.

Flanking Shipp on the other side will be Lonnie Burnam, strong guard; Mike Burnam, strong tackle and Mike Barton, strong end.

The Greyhound defense will shape up like this:

Mike Martin, LHB; Rodney Clawson, FS; Marshall Cator, SS; George Villalobos, RHB; Monty Hawkins, LE; Mike Burnam, LT; Rod Been, LLB; Terry Clingan, nose guard; Cliff Barkley, RLB; Lonnie Burnam,

RT and Durwood Cator, RE.

Of course both offensive and defensive lineups are subject to change either by injuries in practice or last-minute new strategy Coach Nix deems important.

--And there is an added bonus!

Gruver and Greyhound fans everywhere--even plain ol' football fanatics, can whet their appetite to a fine edge Thursday night when the Junior Varsity takes the field. These boys play

the same brand of knock-for-knock, scramble-and-run football that will be expected when they reach the varsity squad.

Asked if there was anything else we could write, they said, "...Yeah... 'Sic 'em!"

THURSDAY 9/2/82

CABLE	[3]	[4]	[5]	[7]	[8]	[9]	[10]	[11]	[12]
PM	OETA	KAMR	TMC	KVII	CBN	WGN	KFDA	WTBS	CNN
	Oklahoma City	CH.4	Movie Channel	CH.7	Christian Netw	CH.9	CH.10	CH.17	Cable News Ntwr
6:00	MacNeil-Lehrer Report	News	Movie: 'No Nukes'	News	Bull's Eye	Andy Griffith	News	Green Acres	Moneyline
6:30	Oklahoma Report	M*A*S*H		Family Feud	Another Life	Carol Burnett and Friends	Entertainment Tonight	Andy Griffith	Sports Tonight
7:00	Sneak Previews	Fame		Joanie Loves Chachi	National Geographic	Movie: 'Fate Is the Hunter'	Magnum, P.I.	NCAA Football Preview	Prime News
7:30	This Old House			Scared Silly				NCAA Football	
8:00	All Creatures Great and Small	Gimme a Break	Movie: 'Outland'	Barney Miller	700 Club		Simon & Simon	Brigham Young at Nevada	
8:30		Teachers Only		Police Squad				(Teams Are)	
9:00	Arthur Rubinstein	Hill Street Blues		20/20		News	Knots Landing	Tentative	Freeman Reports
9:30					Sing out America				
10:00	MacNeil-Lehrer Report	News	Movie: 'Heartbeeps'	News	Nashville RFD	Twilight Zone	News		Sports Tonight
10:30	Business Report	Tonight Show		Rockford Files	Another Life	Saturday Night	U.S. Open Highlights	TBS Evening News	Crossfire
11:00	Sign Off				Burns & Allen		Quincy		News
11:30		Late Night with David	Movie: 'Fade to Black'	Nightline	Jack Benny Show	Movie: 'A Raisin in'		Movie: 'Beat The Devil'	Moneyline Update
12:00	Letterman			Vegas	I Married Joan	the Sun	Movie: 'McMillan & Wife: Point of Law'		Mike Douglas
12:30	NBC News Overnight				My Little Margie				People Now

FRIDAY 9/3/82

CABLE	[3]	[4]	[5]	[7]	[8]	[9]	[10]	[11]	[12]
PM	OETA	KAMR	TMC	KVII	CBN	WGN	KFDA	WTBS	CNN
	Oklahoma City	CH.4	Movie Channel	CH.7	Christian Netw	CH.9	CH.10	CH.17	Cable News Ntwr
6:00	MacNeil-Lehrer Report	News	Prog Cont'd	News	Bull's Eye	Andy Griffith	News	Winners	Moneyline
6:30	Oklahoma Report	M*A*S*H	Movie: 'Hell Night'	You Asked For It	Another Life	Carol Burnett and Friends	Entertainment Tonight	Major League Baseball	Sports
7:00	Washington Week/Review	NFL Pre-Season Football		Benson	National Geographic	Movie: 'Strange and Deadly Occurrences'	Dukes of Hazard	Atlanta at Montreal	Prime News
7:30	Wall Street Week	New York		Making A Living					
8:00	Oklahoma Week in Review	Giants at Miami	Movie: 'Clash of the'	Greatest American Hero	700 Club		Dallas		
8:30	Lawmakers								
9:00	Frosty Troy & Company	Titans		Strike Force		Major League Baseball	Falcon Crest		Freeman Reports
9:30					Sing out America	Chicago Cubs at San Diego		TBS Evening News	
10:00	Tony Brown's Journal	News		News	Nashville RFD		News		Sports Tonight
10:30	Masterpiece Theatre	Tonight Show	Movie: 'Times Square'	Rockford Files	Another Life		U.S. Open Highlights	All In the Family	Crossfire
11:00					Burns & Allen	Movie: 'Nunzio'		Movie: 'The Mouse That Roared'	News
11:30	Sign Off	SCTV Network		Nightline	Jack Benny Show				America Screams
12:00				Evening at the Improv	I Married Joan	Saturday Night			Mike Douglas
12:30			Movie: 'Hell Night'		My Little Margie				People Now

THURSDAY

FRIDAY

10,000 expected for Boys Ranch Rodeo

The thirty-eighth annual Boys Ranch Rodeo at Cal Farley's Boys Ranch is expected to attract approximately 10,000 people over the Labor Day weekend.

The nationally-famous rodeo will begin at 2:30 each afternoon, September 5 and 6, with a Grand Entry of area riding clubs and the Boys Ranch Honor Patrol. About 250 boys will be riding calves, steers, bulls and broncs, competing for belt buckles and the titles of Junior and Senior All-Around Cowboys.

The rodeo is also a homecoming for the Ranch's graduates who travel from around the United States with their families for the occasion. An added feature will be the barbecue beef plates for \$3.00, and boys who do not compete as contestants will be selling snow cones, soft drinks and other refreshments.

The rodeo is the only rodeo of its kind in the nation in which the only contestants are boys riding professional rodeo stock under R.C.A. rules.

To All Farmers: You Are Invited To A Funk And CIBA Geigy Sorghum Field Day.

Date: Wednesday, September 8, 1982  
Time: 12 Noon To 6 p.m.  
Where: Gary Dettle's Farm, Sherman County

Barbecue, Soft Drinks And Beer Will Be Served All Afternoon... So Come Anytime On Wednesday Afternoon From 12 to 6 p.m.

Everyone Gets A FREE Cap!... And We Are Giving Away A Winchester Rifle With Scope For A Door Prize

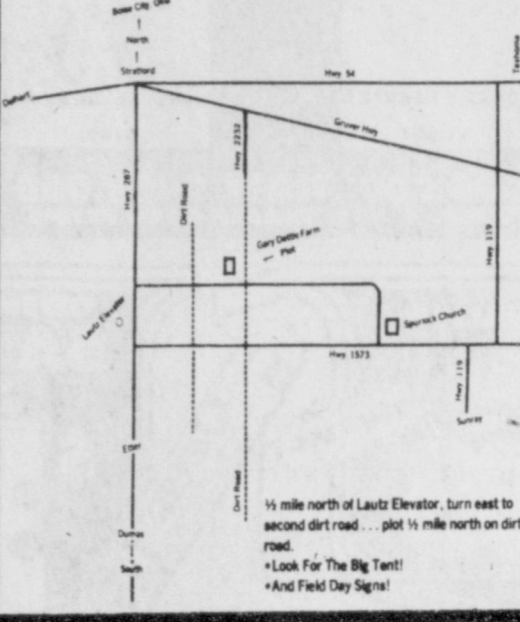

Come See All The New Material... Eat With Us... Win The Winchester Rifle And Get Your FREE Cap! Call Your Funk Or CIBA Geigy Dealer For Other Details.

Rain Date: September 15

**UNITED Supermarkets** *UNITED AND Nature Made... GREAT SAVINGS FOR GOOD HEALTH*

NATURE MADE STRESS COMPLEX VITAMINS	60 CT.	\$3.39
NATURE MADE CHILDRENS CHEWABLE MULTI VITAMINS	100 CT.	\$1.98
NATURE MADE COD LIVER OIL CAPSULES	100 CT.	\$1.89

**NATURE MADE VITAMIN C ORANGE FLAVOR** 250 MG. 100 CT. **\$1.69**

**NATURE MADE "NUTRA E" CREAM** 2 OZ. **\$1.49**

**NATURE MADE VITAMIN E** 400 I.U. 100 CT. **\$2.59**

**NATURE MADE DAILY COMBINATION VITAMINS** 100 CT. **\$1.69**

**NATURE MADE VITAMINE OIL** CONCENTRATE 1 OZ. **\$3.49**

**NATURE MADE "NUTRA E" PROTEIN SHAMPOO** 1 OZ. **\$1.89**

**NATURE MADE "NUTRA E" HAND & BODY LOTION** 1 OZ. **\$1.49**

PRICES GOOD THROUGH SEPT 4, 1982

QUANTITY RIGHTS RESERVED

**UNITED Supermarkets**

**LABOR DAY SALE**

ALLSUP'S WILL BE OPEN LABOR DAY

**FALL WAREHOUSE SALE**

DECKER FRANKS	12 OZ. PKG.	79¢
ATKINS HAMBURGER SLICED DILL PICKLES	16 OZ. JAR	59¢
REFRESHING COCA-COLA	2 LITER BTL.	\$1.09

**HOME FOR THE HOLIDAYS SPECIALS**

BORDEN'S HI-PROTEIN MILK	1/2 GAL. CTN.	\$1.09
BORDEN'S ORANGE JUICE	QUART	99¢
LADY BORDEN ASSORTED FLAVORS ICE CREAM	1/2 GAL. RD. CTN.	\$2.29

PRICES EFFECTIVE SEPT. 2-4, 1982 WHILE SUPPLIES LAST!

**ALLSUP'S CONVENIENCE STORES**

WE RESERVE THE RIGHT TO LIMIT QUANTITIES. LIMITED SUPPLIES!

**LABOR DAY WEEKEND JERRY LEWIS TELETHON**

**HEY KIDS! JOIN THE ALLSUP'S DOORBELL BRIGADE FOR MDA! SEPTEMBER 5 AND SEPTEMBER 6, 1982**

COME BY YOUR LOCAL ALLSUP'S CONVENIENCE STORE AND PICK-UP AN ALLSUP'S COKE CUP TO COLLECT MONEY FOR JERRY'S KIDS. BRING YOUR CUP IN AND TURN IN YOUR COLLECTION AND RECEIVE A FREE COKE! COMPLIMENTS OF ALLSUP'S CONVENIENCE STORES! GOOD SEPT. 5-6, 1982.



SATURDAY 9/4/82

CABLE AM	[3] OETA	[4] KAMR CH.4	[5] TMC	[7] KVII CH.7	[8] CBN	[9] WGN CH.9	[10] KFDA CH.10	[11] WTBS CH.17	[12] CNN
00	Oklahoma City	Amarillo	Movie Channel	Action Jack Comedy Hour	Financial Inquiry Weekend Gardener	Rex Humbard Issues Unlimited	Adventure Hour Bugs Bunny Road Runner	Civilisation	Money Week
8:30	Magic of Oil Painting	Kid Super Power Hour	Movie: 'Mommie'	Richie Rich/ Scooby & Scrappy Doo Show	Jimmy Houston	Charlando	Show	Movie: 'On The Beach'	News
9:30	French Chef	Spider-Man and Friends	Dearest	Fonz/Happy Days Heathcliff/Marmaduke	Fresh Idea	Superman	Voyage to the Bottom of	Blackstar	Press Box Moscow Live Big Story
10:30	Mystery!	Spec Stars		ABC Weekend Special American Bandstand	Westerns	the Sea	Trolkins		News
11:00	Alfred Hitchcock Victory Garden	Daffy-Speedy Show Sport Billy	Movie: 'Nine to Five'	Wild Bill Hickcock	Movie: 'Dark Command'	Tom and Jerry			News
11:30	Oklahoma Gardening Market to Market	Muppet Show		U.S. Open Tennis	Movie: 'Knutie Rockne: All-American'				Special Report
12:30	Over Easy	Major League Baseball: New York at Kansas City	Movie: 'Student Bodies'	That Nashville Music Kung Fu	Judge Roy Bean	Movie: 'Abbott and'			Week In Review
1:30	Austin City Limits	/or Houston at Philadelphia	Movie: 'Heartland'	Gunsmoke	Movie: 'Blue Steel'	Costello in It Ain't Hay'		Movie: 'No Man Is an Island'	News
2:30	Sneak Previews Money-makers			Wyatt Earp	America's Top Ten Soul Train				Big Story
3:30	Making of Superman: The Movie	Dance Fever		Wide World of Sports					News
4:30	Matinee at the Bijou	News		Traveler's World Pro Celebrity Golf Series	Grizzly Adams	Championship Wrestling	Georgia Championship Wrestling		Week In Review
5:30	Prog Cont'd	Lawrence Walk	Prog Cont'd	Hee Haw	Prog Cont'd	Hogan's Heroes Carol Burnett and Friends	Observer	NCAA Football: Boston College at	Sports Saturday
6:30	National Geographic Special	Diffrent Strokes Facts of Life	Movie: 'Mommie Dearest'	T.J. Hooker	Movie: 'Rio Grande'	Movie: 'Nevada Smith'	Walt Disney	Texas A&M (Teams Are Tentative)	News/Sports/Weather
7:30	Austin City Limits	Movie: 'Stranger at Jefferson High'		Love Boat			NFL Pre-Season Football: Houston at		News
8:30	27th Annual Square Dance		Movie: 'Heartland'	Rock Church Proclaims	Major League Baseball: Chicago Cubs at San Diego	Dallas	TBS Weekend News		News/Sports/Weather
9:30	Dr. Who	News		ABC News Movie: To Be	Heritage Singers		Movie: 'Moulin Rouge'		Sports
10:30	Sign Off			Announced	American Trail To Be Announced		News		World Of Love
11:30			Movie: 'Nine to Five'						Health Week

SATURDAY

SUNDAY 9/5/82

CABLE AM	[3] OETA	[4] KAMR CH.4	[5] TMC	[7] KVII CH.7	[8] CBN	[9] WGN CH.9	[10] KFDA CH.10	[11] WTBS CH.17	[12] CNN
8:00	Outdoor Oklahoma	Day of Discovery Larry Jones Ministry	Movie: 'Outland'	Kidsworld	Kenneth Copeland	Mass for Shut-Ins Chicagoland Church Hour	Herald of Truth First Baptist Church	Lost in Space	Big Story
8:30	Odyssey	Rex Humbard		Big Blue Marble Kids Are People Too	Changed Lives	Robert Schuller Outdoor Life	Sunday Morning	Movie: 'Inherit'	News
9:00	National Geographic Special	Baptist Church	Movie: 'It Rained All Night the Day I Left'	Grizzly Adams	Jimmy Swaggart	Tarzan		the Wind'	News
9:30	Nova	Jimmy Swaggart		This Week with David	New Bible Baffle Show	Cisco Kid Lone Ranger	Six Million Dollar Man		News
10:00	Washington Week/Review Week	Emergency	Movie: 'The Boss' Son'	Brinkley	Dr. James Kennedy Religion	Movie: 'Charlie Chan on the Docks of New Orleans'	NCAA Football: Class of '82	Major League Baseball	News
10:30	Firing Line	Movie: 'Green Mansions'		The US Magazine Show	Words of Hope	Faith 20	One Step Beyond	U.S. Open Tennis	Atlanta at Montreal
1:30	Arthur Rubinstein		Movie: 'Blue Lagoon'		Jewish Voice	Zola Levitt	Twilight Zone	This Week in Baseball	News/Sports/Weather
2:30	Time to Live With Leo Buscaglia	SportsWorld		Can Am Challenge U.S. Amateur Golf	Family Showcase	Major League Baseball: Chicago Cubs at San Diego			News
3:30	French Chef		Movie: 'Man with Bogart's Face'		Championship			This Week in Baseball Undersea World of	News/Sports/Weather
4:30	National Geographic Special	News		ABC News	Traveler's World To Be Announced			National Crime and Violence Test	Jacques Cousteau Nice People
5:30	Austin City Limits	Born to the Wind	Movie: 'Outland'	Hee Haw	Priority One Internat'l Larry Jones Ministry	Wild Kingdom In Search of...	60 Minutes	Best of World Championship Wrestling	Sports Sunday
6:30	Nova	CHiPs		Movie: 'Bloodline'	Special	Fight Back Place One Day at a Time	Archie's Place	Nashville Alive	News/Sports/Weather
7:30	Masterpiece Theatre	Movie: 'Wild Geese'	Movie: 'The Boss' Son'		Transformed	In Touch	Telethon: Muscular Dystrophy	Week In Review	News
8:30	Leonard Bernstein Conducts				John Ankerberg		Telethon: Muscular Dystrophy	TBS Weekend News	News/Sports/Weather
9:30	War and Peace		Movie: 'Blue Lagoon'		The King Is Coming Contact			Jerry Falwell	Sports
10:30	Sign Off				Larry Jones Ministry More Than Music			Open Up	News
11:30									Spec. Report Moscow live

SUNDAY

Clair W. Burgener, Congressman, (R-Calif): "He (Reagan) does a lot of things that may not be considered proper by a purist, but sometimes you have to compromise, and this (tax increase) is a compromise."

SMOKING & DEAFNESS

NEW YORK -- Cigarette smoking increases the incidence and severity of deafness, according to a new study from the Egyptian National Cancer Institute. The researchers found that smoking had a more damaging effect on hearing than did growing older.

POLITICAL AD



Every election, we talk about education -- and we should, because it is the most important business in any community.

We have to continue to address the question of teacher salaries, to attract the most capable people into this vital profession AND KEEP THEM THERE!

We also have to encourage continuous honing and upgrading of their professional skills, while weeding out those who ought not to be teachers.

R.C. PORTER

★ Republican Candidate for State Representative, 88th District.

(Pol. adv. paid for by R. C. Porter Campaign Fund, R. C. Porter, Texas, Rt. 2, Box 5, Spearman, Texas 79081)

T/A HIGH TECH RADIALS

The Advantage T/A™ BFGoodrich

Designed For The Driver That Demands The Most From His Tires.

- Dual compound tread gives long mileage and excellent traction.
- A traction block tread helps improve handling and cornering in the wet.

Size	Our Price	F.E.T.
BR70-13	72.83	2.17
DR70-14	79.45	2.55
FR70-14	86.16	2.84
GR70-14	90.09	2.91
HR70-15	97.81	3.19
LR70-15	108.50	3.50

Ask about Free Replacement Warranty Coverage.

Radial Sport Truck T/A™ Off-Road Traction, On-Road Quiet.

- Radial construction for excellent mileage and handling.
- Constructed with three carcass plies instead of two to provide excellent sidewall bruise resistance.
- Computer-optimized block tread design gives great wet and dry traction.

Size	Our Price	F.E.T.
10R15	133.41	4.59
12R15	152.63	5.37
10R16 5	139.37	4.63
12R16 5	155.58	5.42
12 50R15	152.63	5.37
12 50R16 5	159.58	5.42

Open 7:30 a.m. - 5:30 p.m. Weekdays  
7:30 a.m. - 12 noon Saturdays

THE PROFESSIONALS

Hayter Tire Co., Inc.

103 Main Guymon

338-8471

The Advantage T/A™ The Radial Born of High Technology.

- A dependable, high-quality radial produced by integrating materials, construction, and design technology
- Dual compound tread gives long mileage and excellent traction.
- A traction block tread helps improve handling and cornering in the wet

Size	Our Price	F.E.T.
F70-14	94.16	2.84
G70-14	98.09	2.91
F70-15	96.25	2.75
G70-15	103.11	2.89
G60-14	105.13	2.87
G60-15	110.14	2.86

Ask about Free Replacement Warranty Coverage.



### The Sulfur Oxides

"Acid Rain"--and the more subtle and sinister "acid air"--present serious threats to human and environmental health. While experts argue over how much of which is caused by whom, the damage to lakes and lungs continues.

It's time to act to stop it. Laura Van Dam in an enlightening article says a researcher for the electric power industry estimates 60 percent of the sulfur oxide emissions from the Midwest, source of most of the air pollution that causes acid rain to fall on the United States and Canada, comes from utility power plants.

New York's Sen. Daniel P. Moynihan, she reports, believes the electric industry contributes 80 percent of the destructive sulfur oxides.

Meteorologists and other scientists agree the situation is worst in those areas where prevailing weather patterns cause a mass of polluted air to hang over one area until rainfall washes the sulfurous contaminants to the ground.

The Northeast frequently experiences this on a large scale. And other areas in the middle and southern states do too when a temperature inversion acts as an atmospheric lid, holding one parcel of air over an area for days at a time.

When that stalled air is polluted, all plant and animal life is adversely affected, directly and indirectly.

Federal, state and local officials will wait forever if they wait for everyone to agree on just how much harm is done by airborne acidic wastes and what precise percentages are dumped in the air from various sources. They know already that the chief source is fossil-fuel utility plants and that the power companies can, at some expense, radically reduce their pollution output.

The technology to control the pollutants that create acid rain is known. It is not cheap. But it is infinitely less costly than dead lakes or streams without fishes or burned and damaged respiratory tissues in humans and other animals.

### Good Old Days?

Nostalgically, we often speak of the good old days. But unless one refers to the recent past, very recent, they were not better days. In fact, if we study history objectively, we have much to be thankful for--living in today's world.

Examples: In 1705 intermarriage between white and black persons was declared illegal in Massachusetts (as in other colonies) and this law remained in effect for 138 years. The year before, ministers in Maryland were given the legal power to order a separation of any marriage if the minister disapproved of the woman!

More than a decade earlier, in 1693, French settlers in South Carolina were the victims of discrimination there; in 1713, children in New York were barred by law from sledding. Constables were empowered to seize children's sleds and break them to pieces.

In Connecticut in 1721 a law was passed barring people from emerging from their homes on Sunday unless they were attending church or in an emergency! In Massachusetts in that time the death penalty for theft was actively enforced--as was true in other colonies.

In the same year the French Government sent 25 prostitutes to Louisiana to help attract settlers there away from Indian mistresses and relieve the shortage of women. There being no orphanage in all the colonies, the first was established in Savannah, Georgia, by Methodists, in 1740.

The next year in Philadelphia a child of only four or five died from consuming a great quantity of rum. Drunkenness was a very prevalent vice of colonial settlers. In 1737, reformers smashed a brothel, where sexual favors were openly advertised in print and in the window of that house, in Boston. Etc.

Four years later, in 1741 again, 11 Negroes were burned at the stake and 18 more hanged (plus four white men) for starting fires in New York City. Etc. The new, good days--today--are better days.

### On Zealots

Every so often an individual succeeds in gaining fame and acclaim, achieving something substantial in the public interest. He or she becomes something of a folk hero, and the question then becomes whether he can step back into his old lifestyle of comparative anonymity.

The same phenomenon affects organizations, either public watchdog groups or organizations acting in behalf of the public interest or freedoms and rights.

Hollywood "stars" fall over themselves trying to get TV spots promoting a worthy cause (and themselves). One would have little difficulty signing up the biggest names in entertainment for TV spots in behalf of curing ingrown toenails--if television networks donated the exposure.

None of this is world-shaking, nor is democracy or Christianity threatened. But the average citizen might keep in mind the magnetic pull of acclaim and publicity to zealots and reformers.

Ralph Nader, a zealot now known as "the consumer advocate" has accomplished much in the past.

A few days ago he received widespread media exposure by writing a letter to President Reagan suggesting that the president abolish his own office of consumer protection. In other words, the government office would be abolished and Nader would have the field to himself, with his private organization.

Nader, of course, knew this suggestion had no chance of acceptance. While he thinks the federal office a total failure, others disagree, other sincere employees working in the office for the benefit of consumers.

#### NEW THUNDERBIRDS

LAS VEGAS, NEV. -- The Air Force recently announced the selection of the six pilots who will comprise the new Thunderbird precision flying team.

#### GACY'S ART

SPRINGFIELD, ILL. -- John W. Gacy Jr., infamous for the sex killings of 33 young men, is exhibiting and selling paintings at the Illinois State Fair at prices from \$20 to \$200.

#### ON DARYON

BOSTON -- The common painkiller Daryon slows the rate at which the body uses other drugs, and this may explain why it is sometimes associated with dangerous overdoses, researchers say.

\*\*\*\*

About half of the ills that afflict the human body originate in a pampered, idle mind.

\*\*\*\*

The reason some people have so few friends is that they think a friend should give them something for nothing.

\*\*\*\*

A smile from a cute thing often brightens up the day.

### Labor Day, 1982

The first to suggest a day to be set aside in honor of labor--the working man and the spirit of industry--was probably Peter McGuire. He was president of the United Brotherhood of Carpenters and Joiners of America in 1882, when his suggestion was adopted by the Central Labor Union in New York.

The first Labor Day, then, was observed in 1882. In 1884, the Federation Organized Trades and Labor Unions, which later became the American Federation of Labor, adopted the suggestion and states (Oregon was the first) began to declare the first Monday in September a holiday. McGuire had chosen September because it was about midway between July 4 and Thanksgiving.

By 1894, when Congress declared the day a holiday in all federal offices and territories, some thirty states had acted to make Labor Day a legal holiday. After Oregon, Colorado, Massachusetts, New Jersey and New York were the next to establish the holiday.

A popular feature of Labor Day, the traditional last weekend of summer in many areas, is that it always falls on a Monday, thus creating a long weekend.

This year Labor Day is on the 6th. As on other holidays, there will be too many accidents; in observing it this year, take care to see that you live to enjoy another Labor Day.

Israel condemned by U.N. Assembly.

Congress okays tax increase.

### September, 1982

*There was that nameless splendor everywhere. That wild exhilaration in the air...*

Longfellow.

September is the month of the harvest moon, this year on the 3rd--the moon which appears above the horizon at about sunset for several days, giving enough light for farmers to harvest fields after the sun is down.

Labor Day falls on the 6th this year. The first Continental Congress met on the 5th in 1774, in Philadelphia; James Fenimore Cooper, the novelist, was born on the 7th at Burlington, N.J., in 1789. The famous Galveston hurricane struck that city on the 8th in 1900. The 9th is Admission Day in California--dating from 1850 when California became a state.

The British defeated George Washington and his army at Chadd's Ford in Pennsylvania on the 11th in 1777 and took Philadelphia two weeks later as a result, on their third try. The 12th is Defenders' Day in Maryland, dating from the War of 1812 against the British; John Barry, the father of the U.S. Navy, died on the 13th in 1803. The 15th is the birth anniversary of William Howard Taft, born in Cincinnati, in 1857 and elected president in 1908.

Baron Friedrich Wilhelm Rudolph Gerhard Augustin von Steuben was born in Prussia on the 17th in 1730; years later he came to America to train George Washington's army and help the Colonies win independence.

### The Last Battle

What was the costliest battle of World War II for U.S. forces? The Battle of the Bulge? Pearl Harbor? Midway? None of these, but the Battle of Okinawa.

The upcoming official Japanese surrender anniversary in September brings to mind the close of the war in the Pacific and the last and most costly battle of the war.

That battle began April 1, when the first of eight divisions began landing against no opposition on the 75-mile-long island. What at first seemed easy turned into grim surprise; the enemy was underground and waiting, in well prepared concrete bunkers and defensive positions.

Before the fighting ended months later, the Army and Marines had lost over 7,500 dead and missing, over 31,000 wounded, and non-battle casualties of 26,211. U.S. Navy losses had been by far the highest of any other battle--almost 5,000 dead, a similar number wounded, 36 ships sunk and 368 damaged!

Japanese losses were even more staggering. The U.S. war machine exterminated 110,000 soldiers, 7,800 aircraft (mostly suicides) and sixteen warships. This battle, the bloodiest, came when the outcome of the war was no longer in doubt. Less interest has thus been attached to it than to earlier battles. Yet its outcome was a major factor in convincing many in Japan the struggle was hopeless. The atomic bomb made that fate much more obvious.



**Support the Lynx,  
Go to Stratford!**



Spearman Football Cheerleaders for 1982-83 are:

Tiki Jackson Kim Elbert

Lana Paul Carlee Dixon Lea Ann Gibner

Cinda Novak

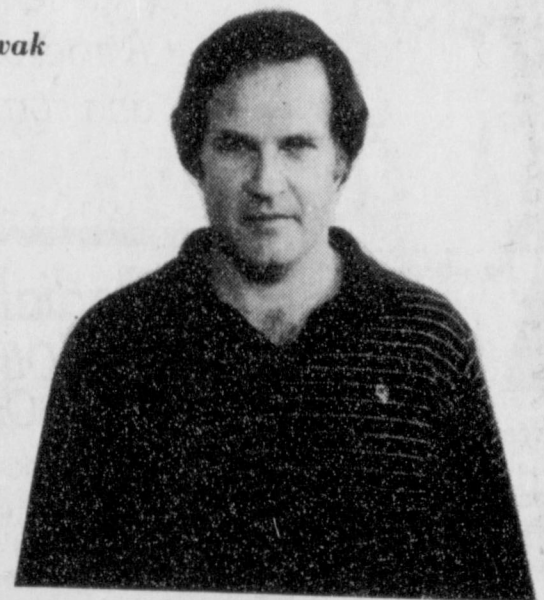
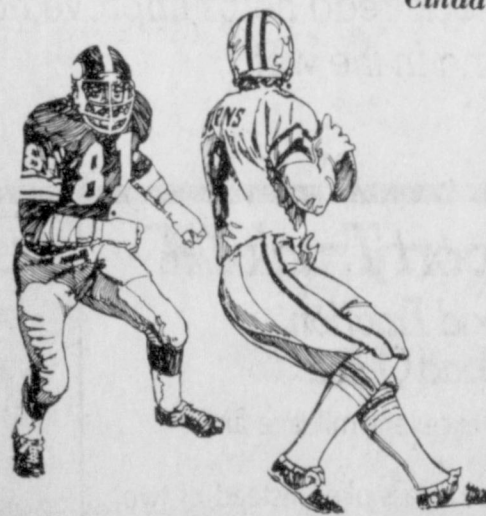

**Our Team's  
A Winner!**

306 DAVIS  
659-3792

**White House  
Lumber Co.**

**Dairy  
Queen**

**GO  
GET  
'EM**

**Dairy Queen  
Spearman Gruver**

**Your local used  
cow dealer is  
SPEARMAN BI-PRODUCTS**



**1 800 692-4043**

**VICTORY  
To You,**



**Spearman  
Redi-Mix**

**We know we can count  
on 100% effort and a  
winning season.**



309 Main - P.O. Box 993  
Phone 659-3668  
Spearman, Texas 79081  
Paint and Carpet Center

**Nelson's  
Builders Supply**



### Sex Preference

The great majority of Americans almost believe there's good in sexual preference and sexual differences. And real differences between the sexes justify some differential treatment.

Females are favored in many ways under U.S. laws; males are favored in others. Females can retire at age 62. Males must wait until 65. Females are often given preferential treatment in the courts, in jury duty, in divorce cases, in child custody cases, in the draft, in military combat, in accidents and tragedies, etc.

Males are sometimes favored in pay, in estate and legal matters and in job selection--though often laws now exist which can remedy these abuses.

Most Americans oppose some of these discriminations, but not all. And most think it's acceptable the law distinguishes between the sexes, polls show.

Reform, then, to muster maximum support should center on unequal treatment which obviously has no logical or acceptable justification.

#### The Circle

A neurotic is one who builds castles in the air; a psychotic is one who lives in them, and a psychiatrist is one who collects the rent.

-News, Dallas, Tex.

#### Late Lesson

All too many of us wake up along about mid-way in our lives to a realization that it's one of those do-it-yourself deals.

-Gazette, Mason City, Ia.

### BIBLE VERSE

"And all the tithe of the land, whether of the seed of the land, or of the fruit of the tree, is the Lord's: it is holy unto the Lord."

1. Who was the author?
2. Where is the verse found?
3. What is the general characteristic of this Book?
4. Where does the name originate?

#### Answers to Bible Verse

1. Moses.
2. Leviticus.
3. It's been called a "directory of the Old Testament worship."
4. From that of the Levites, the priestly tribe of Israel.

First group of PLO's reach Cyprus.

King Hussein of Jordan welcomes PLO fighters.

### Best Of Press

**Reserve**  
Believing all you hear is matched only by telling all you know.

-Globe, Mason City, Ia.

**Growing Up**  
You are only young once, but you can stay immature indefinitely.

-Chronicle, Odebolt, Ia.

**Debt Mountain**  
Of course there are bigger things than money. For example, bills.

-Tribune, Des Moines.

**Modern Trend**  
The feeling that you've done a job well is rewarding; the feeling that you've done it perfectly is fatal.

-Scoup, Winter, Me.

### Comment On Sports

#### BASEBALL

By Pete Fritchle

WASHINGTON, D. C. -- Some oldtime Major Leaguers believe it's easier to win pennants coming from behind late in the season. They cite examples like that of the Atlanta Braves.

The Braves looked like shoo-ins for the flag in the National West until a spectacular collapse. They had swept the world champion Dodgers on the west coast earlier and no team seemed to be capable of rattling them.

When San Diego came to Atlanta the Braves swept them. But then the Dodgers in California and the fall. Both the Dodgers and Giants swept the Braves and suddenly a ten-game lead vanished. San Diego added to the torment.

Pressure builds as an underdog team sits atop the pack. The baseball season is

long (162 games) and veteran or favored clubs take on a leader with added determination, nothing to lose and loose. The club on top has everything to lose, and tends to tighten up and get conservative.

Atlanta players exhibited unmistakable signs of jitters, and committed errors which cost them heavily in L.A. Coming on, earlier in the season, they were relaxed and played cool. So the team at the top is fair game for all contenders. It may well be that a strong finish, coming from behind, is the best psychological position for August and September.

In June, it might be recalled, Detroit, another underdog, had the best record in baseball, and went into a tailspin even worse than Atlanta's August swoon.

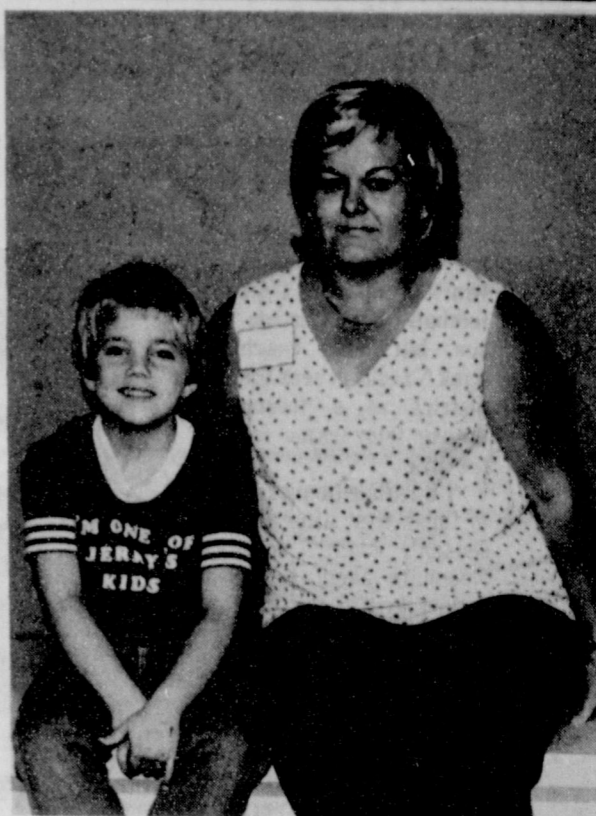

VICKY BULLARD, "ONE OF JERRY'S HELPERS," IS SHOWN WITH "ONE OF JERRY'S KIDS"--Vicky Bullard, Spearman Pledge Center Coordinator, recently attended the 1982 Jerry Lewis Labor Day Telethon Coordinator's Meeting in Amarillo, Texas. The Volunteer Fire Department will sponsor the Spearman Pledge Center located at the Spearman Fire Station during the Telethon on September 5th and 6th. Mrs. Bullard is pictured with Darrold Haddican, Jr., the Texas State Poster Child for MDA--Muscular Dystrophy Association--from Pampa.

# KICK-OFF

Kick off 8:00 p.m.

## Spearman Lynx

VS

## Stratford Elks

there

## Friday Night



DATE	OPPONENTS	PLACE	TIME
Sept. 3	Stratford	There	7:30
Sept. 10	FRITCH	HERE	7:30
Sept. 17	GRUVER	HERE	7:30
Sept. 24	STINNETT	HERE	7:30
Oct. 1	Sunray	There	7:30
Oct. 8	*Boys Ranch	There	8:00
Oct. 15	*Canadian	There	8:00
Oct. 22	*DALHART	HERE	8:00
Oct. 29	*RIVER ROAD	HERE	8:00
Nov. 5	*Perryton	There	8:00

\*Denotes District 1-AAA Games

DATE	OPPONENTS	PLACE	TIME
Sept. 9	Canandian	There	5:00-7:00
Sept. 16	Perryton	There	5:00-7:00
Sept. 23	GUYMON	HERE	5:00-7:00
Sept. 30	DALHART	HERE	5:00-7:00
Oct. 7	WHEELER (9th)	HERE	5:00
Oct. 7	BOYS RANCH (JV)	HERE	7:00
Oct. 14	CANADIAN	HERE	5:00-7:00
Oct. 21	Dalhart	There	5:00-7:00
Oct. 28	River Road	There	5:00-7:00
Nov. 4	PERRYTON	HERE	5:00-7:00

DATE	OPPONENTS	PLACE	TIME
Sept. 9	CANADIAN	HERE	5:00-6:30
Sept. 16	PERRYTON	HERE	5:00-6:30
Sept. 23	Guymon	There	5:00-6:30
Sept. 30	Dalhart	There	5:00-6:30
Oct. 7	Boys Ranch	There	5:00-6:30
Oct. 14	Canadian	There	5:00-6:30
Oct. 21	DALHART	HERE	5:00-6:30
Oct. 28	RIVER ROAD	HERE	5:00-6:30
Nov. 4	Perryton	There	5:00-6:30

### BOXWELL BROS.

519 Evans 659-3802

We Wish You  
A Super  
Season



### GEBO'S

GO! GO!



DUMAS  
501 N. Dumas 935 7403  
8 00-6 00 - Monday Friday  
8 00-1 00 - Saturday

Break Through To A  
Winning Season



First National Bank  
Perryton, Texas  
806-435-3676  
Member FDIC

VICTORY  
To You.



Boyd's Shoes



GO  
TEAM  
GO!

Sack's 3rd Ave.

### The Right

Most of the news media recently went off the deep end, again, packlike, in agreeing almost unanimously (in commentary and print reporting) that President Reagan had lost the support of the far right.

The events behind this interpretation were Reagan's call for tax reform (and some increase) and an adroit agreement with Red China. With few exceptions, commentators and columnists drew somber conclusions: the right wing of the Republican Party, which did so much to elect Reagan, was now disenchanted.

Actually, Mr. Reagan played astute politics in both cases. The tax reform bill he proposed was mostly just that--more reform than increase. And what he proposed was fair and overdue. It appealed to the middle spectrum of the electorate--which any Republican must win to be elected.

As to Taiwan and Red China: the agreement was mostly a face-saving gesture for Red China, a major Asian power Washington must keep out of the Soviet sphere. Under terms of the agreement, the U.S. would reduce arms sales to Taiwan. But nothing was said about "when." Fifty years from now or more or fewer, they may become unnecessary. China agreed not to use force to settle the dispute--a major concession.

Mr. Reagan faced reality in both these tough decisions; the majority of the American people can see that. He will win votes and support from the huge middle segment of the population by both policies.

The threats and cries of anguish from the far right mean little; the far right has nowhere else to go. Mr. Reagan, acting as a middle-roader, will always be closer to the right than the Democratic left.

### Golden Gleams

The public is a ferocious beast; one either chains it up or flees from it.

-Voltaire.

The public! How many fools are needed to make a public?

-Nicholas Chamfort.

He who serves the public hath but a scurvy master.

H.G. Bohn.

The public have an insatiable curiosity to know everything except what is worth knowing.

He that does anything for the public accounted to do it for no one.

-Thomas Fuller.

Definition  
Perfume: The most dangerous form of chemical warfare.

-Fleet, Portsmouth, Va.

### H&R Block To Offer Tax School In Perryton

Thousands of people are earning money in their spare time as income tax preparers.

H & R Block, the world's largest income tax preparation service, is offering a basic income tax course, students will study all phases of income tax preparation and receive actual experience in preparing individual returns. Experienced Block personnel will teach current laws, theory and application as practiced in Block offices nationwide. There is a classroom lecture on each subject and practice problems at every level. Courses are programmed to teach students increasingly complex tax problems as study progresses. Students will find the course both interesting and challenging.

Anyone may enroll. There are no restrictions or qualifications. Courses are ideally suited for housewives, retired persons, teachers or persons wanting to increase their tax knowledge.

Qualified course graduates may be offered job interviews for positions with Block. Many accept employment with Block because of the flexible hours available. However, Block is under no obligation to offer employment, nor are graduates under any obligation to accept employment with H & R Block.

The modest course fee includes all textbooks, supplies and tax forms necessary for completion of the school. Certificates and 7.5 continuing education units will be awarded upon successful completion of the course. The course is licensed by the Texas Education Agency.

Registration forms and brochures for the income tax course may be obtained by contacting the H & R Block office at 314 N. Industrial (Box 964) telephone 806-435-5616. ADV



## Coach sees 4-team race . . . Elks favored in District 1-AA

The Stratford Elks are heavily favored to win the district 1-AA football crown this season, but head coach Jack Needham sees the district as a tossup among four teams for the title.

"I'd rather be picked to finish first after the season's over," says Needham about being picked to win the district by three football publications -- Harris Rating System, Top-O-Texas Football and Dave Campbell's Texas Football.

"I think Gruver, Fritch, Stinnett and us are pretty close to a tossup," Needham says.

"I think we have a chance to win district, but our biggest problem is we're depth shy. This is the smallest team I've been associated with since I've been here," Needham adds.

Senior tackles Jim Jones (6-2, 205) and Rhett Ragsdale (6-2, 180) are the only two starters Needham has who weigh 180 pounds or more. On the rest of the starting team the weight of the players drops to 150.

The Elks, who have a 37-7-1 record the past four seasons, have to replace 10 starters, including a quarterback who announced just two days before workouts started that his family was moving from Stratford.

One position the Elks won't be hurting at is running back. Sammy Gomez, who gained 1,342 yards last season and received all-dis-



**RUNNING BACKS** Sammy Gomez, left, and Albert Olivas, both of whom double as linebackers, are among the returning starters for the Stratford high school football team this season.

trict 1-AA honorable mention honors, returns for his junior year.

Also returning is another junior running back, Albert Olivas,

who carried the ball for 510 yards. Both Gomez and Olivas are linebackers.

In addition to Jones, Ragsdale, Gomez and Olivas, other returning starters are senior defensive end Jere Keener and senior safety and tight end Kevin Stanley.

Needham says 56 of the 81 boys in Stratford

high school tried out for the football teams. The school has a total enrollment of 170.

The Elks open the season Friday at home against Spearman. Kickoff is set for 8 p.m. They then play at Dalhart Sept. 10, at home against Boise City Sept. 24 and at Kress Oct. 1 before district action

begins.

Stratford travels to Gruver Oct. 8 for its first district contest and then plays at home the next two Fridays against Sunray and Stinnett. The Elks close out the season with a road game with Sanford-Fritch Oct. 29 and a home game with White Deer Nov. 5.

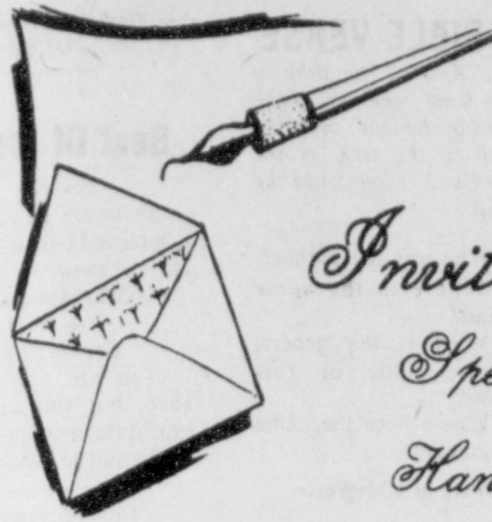

## Invitation to Artists Spearman-Gruver & Hansford County Area

You are invited to participate in the ART SELECTION SHOW on September 1, 2 and 3 at First National Bank in Perryton.

Amateur and professional artists within a 100 mile radius of Perryton can show their work (limit 3 pieces of art) at the bank. Any medium is acceptable. Art pieces should be framed and suitable for hanging.

The theme for the ART SHOW is "The Southwest: Yesterday and Today."

Contact First National Bank in Perryton at 435-3676. Call for Juanita Brillhart or Randy Brillhart.



# First Money Market Report

A Concise Report Of Rates Currently Paid On Money Market Investments At First National Bank

7 Day Certificates		
TERM	RATE	ANNUAL YIELD
7-31 DAYS	8.604%	Changes Weekly

Invest \$20,000  
Date Effective: August 31, 1982 Through September 7, 1982

Money Market Certificates	
TERM	RATE
91 Days (3 Months)	8.354%

Invest \$7500  
Date Effective: August 31, 1982 Through September 7, 1982  
Compounding interest prohibited by law.

TERM	RATE
182 Days (6 Months)	10.123%

Invest \$10,000  
Date Effective: August 31, 1982 Through September 7, 1982  
Rate based on average of Money Market Certificates for preceding four weeks.  
Compounding interest prohibited by law.

30 Month Certificates		
TERM	RATE	ANNUAL YIELD
30 Months	11.70%	12.410%

Invest \$500 or more.  
Date Effective: August 31, 1982 Through September 13, 1982  
Annual yield based on daily compounding.

Tax Saver Certificates	
TERM	RATE
12 Months (1 year)	8.96%

Invest \$500 or more.  
Date Effective: August 10, 1982  
Interest earned is tax deductible  
Compounding interest prohibited by law.

\$100,000 Certificates of Deposit		
TERM	RATE	ANNUAL YIELD
30 Days	10.00%	10.515%
90 Days	10.00%	10.515%
120 Days	10.50%	11.069%
180 Days	10.75%	11.347%
1 Year	10.50%	11.069%

Invest \$100,000.  
Date Effective: August 31, 1982 Through September 7, 1982  
Annual yield based on daily compounding.



Individual Retirement Accounts			
TYPE	TERM	RATE	ANNUAL YIELD
Fixed Rate IRA	18 Months	10.123%	10.652%
Variable Rate IRA	18 Months	10.123%	Changes Weekly

Invest up to \$2000.  
Date Effective: August 31, 1982 Through September 7, 1982  
Annual yield based on daily compounding.

All deposits insured to \$100,000. Substantial interest penalties for early withdrawal on all certificates.

**When You're Ready To Invest, Call The Money Market Advisor At 435-3676.**



### Perryton tennis classic set

If you play tennis, then plan to be in Perryton, Texas the weekend of September 18th and 19th for the first annual Perryton Tennis Classic. The event will be sponsored by KEYE Radio, and Wolff's Sporting Goods and takes the place of the seven year Perryton Open Tennis Tournament which has been held since 1975.

The event is open to all junior, high school, college, and adult tennis players in the Tri-State area.

This is the tournament to launch your fall tennis play.

The 1st Annual Perryton Tennis Classic will offer \$2500 in prize money, jackets, and trophies with both first and second places being awarded. There will be \$1100 in prize money in the Men's Championship singles and doubles events making this only the second prize money event in panhandle history. The breakdown for prize money will see the Men's singles champion picking up 500 dollars, 200 dollars for second place. The men's championship doubles team will win 300 dollars with 100 dollars going to the second place team.

ALL AMATEURS WHO MAKE THE FINALS WILL HAVE THEIR HIGH SCHOOL OR COLLEGE ELIGIBILITY PROTECTED. THE PRIZE MONEY WILL BE DONATED TO CHARITY OR TO YOUR SCHOOL ATHLETIC FUND.

IN ADDITION TO THE CHAMPIONSHIP BRACKET, there will be singles and doubles events in Class A, B, and C divisions with A and B mixed doubles as well. A minimum of four entries are required in each event. Teams as well as individuals are welcome. Matches will be held at The Perryton Club, the Perryton Junior High Courts and the Perryton High School Tennis Complex which will serve as tournament headquarters. That provides a total of eleven excellent tennis courts for tournament use. Concession stands will be open and the Perryton Club will be serving refreshments as well.

Seating areas will be provided at both the Perryton Club and the Perryton High School Tennis Complex. That provides a total of eleven excellent tennis courts for tournament use. Concession stands will be open and the Perryton Club will be serving refreshments as well.

Seating areas will be provided at both the Perryton Club and the Perryton High School Tennis Complex.

All tournament finals will be Sunday afternoon at the Perryton Club with seating for 100 persons, and spectators are welcome.

Accommodation information is available through the tournament director.

Matches will begin at 8 a.m., Saturday-September 18, 1982. ENTRY FEE: \$8.00 for each singles event, \$16.00 per team in each doubles event.

ENTRY DEADLINE: Wednesday, September 15, 1982.

FOR MORE INFORMATION OR TO ENTER:

Mike Coggins  
Tournament Director  
3222 S. Ash  
Perryton, Texas 79070  
(806) 435-3263

### United States losing high technology war

COLLEGE STATION — The United States is losing the economic equivalent of World War II and the battle over consumer electronics has been the Pearl Harbor of the conflict, an American industry executive said recently.

Steve Spence, a vice president with the Dallas-based division of Rockwell International, made the comparison during the 90th American Society for Engineering Education conference at Texas A&M University.

The enemies, said Spence, are Japan and West Germany, which are beginning to outstrip the United States in many key industrial areas.

"Japan can build a car and ship it to the U.S. for \$1700 less than it can be manufactured in the United States," he said. "The enemy's focus is on high technology goods and their weapons are cooperation between labor, industry and government."

## Second Annual Arts & Crafts Show Set

The Spearman Study Club is happy to announce that all plans for their second arts and craft show and sale are coming along great! There is a total of 30 dealers from four states who have already made reservations for the show. The club plans to have dealers by September 1, the last day to send for reservations.

Texas, Oklahoma, Kansas, and Colorado dealers are bringing everything from antiques, quilts, paintings, tole paintings,

depression glass, sculptures, bronzes, stained glasses, jewelry, breads, and many other items to long to list!

Local talents Kindra Davis, Lometa Sparks, Evelyn and Albert Mackie, Joe Close, Larry Porter, Martha Latham, Frankie Sloan and Dora Faries have

entered booths in our sale. There is still time for more of our locals to sign up for one of

the biggest events in Spearman this year.

The club asks for your support by attending their sale September 11 and September 12 at the Plains Shopping Center. A successful show will mean an annual event in Spearman every year sponsored by Spearman Study Club.

Watch in the paper for future progress of events. Nothing will be shown or sold before the first day of the sale.

For further information contact Trudie Schneider 659-3691 or Francis Biles 659-2126.

*In Fashion*

The crew-neck sweater will be very popular on the college campus. These pure Shetland wool sweaters come in a choice of colors and some shops will add a 3-initial monogram. Skirts are an attractive addition to these sweaters.

## DPS estimates Labor Day deaths

AUSTIN—Although motor vehicle fatalities are down by five per cent statewide as compared to the same time last year, the Texas Department of Public Safety is estimating 47 traffic deaths over the forthcoming Labor Day weekend.

DPS Director Colonel Jim Adams said he is not optimistic that the holiday period would reflect any fewer deaths than anticipated. However, he said that drivers could help limit the number of fatalities by using seat belts, maintaining a safe speed and refraining from drinking while driving. He said about half of the holiday deaths would probably involve alcohol.

"Some people tend to drink more during the holidays and then attempt to drive. By doing so, they show a low regard for the well-being of themselves, their passengers and other motorists. Drunk driving is obviously one of the most dangerous risk factors facing motorists today," he said.

DPS statistical reports show 23 percent of traffic deaths reported last year involved alcohol. However, Adams said, "About 50 percent or more of the traffic deaths in Texas are alcohol related."

for mandatory blood alcohol testing on drivers who were believed to have been drinking. When we compare accident reports and national statistics, it is easy to estimate the number of accidents which involve the drinking driver," he said. Last year during Labor Day, 50 persons were killed in urban and rural traffic accidents. Eight more persons died later as a result of injuries suffered from accidents which occurred during the 78-hour holiday.

At the discretion of command officers, the DPS will have extra patrols assigned to areas where heavy volumes of traffic can be anticipated or where drinking drivers can be expected.

"Local highway patrol commanders will assign the additional troopers as they deem appropriate to assist the holiday traveler and to watch for drivers who violate traffic laws," said Adams.

The Labor Day holiday is traditionally one of the last holidays of the summer vacation period and extensive travel and heavy traffic can be expected.

The DPS is urging motorists who take long trips to utilize the many rest stops provided by civic and business clubs and the State Highway Department.

Additionally, the DPS will conduct Operation Motorcade whereby the city police departments, county sheriffs' offices and troopers report the number of traffic deaths directly to the news media.

### Texas destined to be second largest state in nation by 1990

COLLEGE STATION — Texas is now the fastest growing state, says a census analyst who predicts that by 1990 the Lone Star State will be the second largest state in the nation.

Dr. Robert L. Skrabanek, a Texas A&M University sociologist and demographer, compares Texas to a "giant human magnet pulling people from all regions of the country."

"During the 15 month period ending July 1, 1981, Texas added more people than all the 22 northern states put together," said Skrabanek, "and for the first time, Texas had a larger growth rate in percentage and in number of people than the nation's most populated state, California."

SEPTEMBER 5 & 6, 1982  
2:30 P.M.

38th ANNUAL  
Cal Farley's  
Boys Ranch  
RODEO

## Q: How Can You Save On Summer Cooling Bills?

## A: Wise Energy Management

Wise energy management is your answer to holding down summer cooling bills. Installing insulation with the recommended "R" value for this area can make your home comfortable year 'round. Prevent costly cool air loss through cracks around windows and doors with caulking and weatherstripping. Make sure your attic is properly ventilated to remove excess heat and moisture. Keep your air conditioner operating efficiently... change or clean your air filter once a month, and have it professionally inspected and serviced annually. Set your thermostat at a comfortable 78; and use energy-saving fans to keep air circulating. For more answers, call or drop by our office for your free energy management booklet.

Texas-New Mexico Power Company

E35-82

# OPEN LABOR DAY

## All Prices Good Through Labor Day

PRICES GOOD ONLY AT TG&Y FAMILY CENTER  
521 HWY 207 SOUTH  
SPEARMAN, TEXAS 659-3742

**1.99**

Kingsford Charcoal Briquets Lights fast and easy to make all of your summer cook-outs a success! 10 lb. bag. Reg. 2.47

**Your Choice .99**

Fireside Cookies Choose Vanilla, Chocolate, Duplex or Peanut Butter Cremes 19 oz.

**Your Choice .87**

Snack Chips Nacho's Natural Tortilla or Papa Grande Corn Chips. 16 oz.

**Your Choice 1.37**

Vlasic Pickles Polish Style or Kosher. Dills. 46 oz. jar.

**3 1.00** save 38%

FOR Aunt Lydia's Rug Yarn 100% Kodel polyester. 70 yd. skein. Assorted colors. Reg. 53. Limit 12

**3 1.00**

FOR Comet Cleanser Price reflects 34 off label 14 oz. Limit 3

**4 1.00** save 42%

FOR Willert Bowl Fresh 3 oz. deodorizer with plastic hanger. Reg. 43 ea.

**.66** save 24%

FOR Paper Plates Stock up for easy clean ups of all your summer meals! 9" size. 100 plates per pkg. Reg. 87

**2 1.00**

FOR Hi-Dri Paper Towels 100 two-ply towels per roll. Limit 6

**12 1.00**

FOR Tubular Plastic Hangers "Bright 'N Light" in chocolate, white or almond.

**Your Choice 1.47**

Hi-C Bottled Fruit Drink Serve it on ice for a refreshing treat! Orange, Grape or Fruit Punch flavors. 64 oz.

**4 1.00** save 36%

FOR Lifebuoy Deodorant Soap Super strength. 4 1/2 oz. bath bar. Limit 4

**5 2.00**

FOR TG&Y Aluminum Foil For broiling, freezing or grilling. 25 sq. ft. 8.33 yds x 12" wide. Limit 5

# TG&Y family centers

T.G.&Y. will honor any locally advertised lower price on any item available in our store. Just bring us the Ad!!

TG&Y's policy is to always have advertised merchandise in adequate supply in our stores. In the event the advertised merchandise is not available due to unforeseen reasons, TG&Y will provide a Rain Check, upon request, in order that the merchandise may be purchased at the sale price when it becomes available, or you may purchase similar quality merchandise at a similar price reduction. It is the policy of TG&Y to see that you are happy with your purchases. \*It is TG&Y's policy to be priced competitively in the market. Regular Sale Prices may vary market by market, but the sale price will always be as advertised. \*We will be happy to refund your money if you are not satisfied with your purchase. VISA\* and MasterCard\* accepted.



# We're Having Our First Combined Model Closeout Sale!

## Between 2 Dealerships, we've got over 150 new 1982 Oldsmobiles, Cadillacs, Pontiacs, Buicks and GMC's to pick from!

### INVENTORY



#### Pontiacs:

- \* T1000 3 Door Hatchback. Gold. Hail Damaged.
- \* J2000 2 Door Hatchback. Bright Metallic Blue.
- \* J2000 2 Door Coupe. Gold. Hail Damaged.
- \* J6000 LE 4 Door. Light Jadestone. Hail Damaged.



**FIREBIRD**  
S/E. Gold.  
Trans Am. T-Top. Bright Red.

#### BONNEVILLE 4-DOOR

- Light Redwood/Redwood. Demo.
- \* Station Wagon. Diesel. White. Hail Damaged.
- \* White/Redwood. Hail Damaged.

#### BONNEVILLE BROUGHAM 4-DOOR

- \* Dark Metallic Blue/White. Diesel. Hail Damaged.
- \* Silver/Dark Blue. Diesel. Hail Damaged.
- \* Light Metallic Blue/White. Hail Damaged.

#### Buicks:

- SKYLARK LIMITED. 4 Door. Light Redwood/Redwood.
- \* CENTURY LIMITED. 4 Door. White.

#### REGAL LIMITED

- \* Light Redwood/White. 2 Door. Hail Damaged.
- \* White. 4 Door. Hail Damaged.
- White. 2 Door.
- Light Redwood/Redwood. 4 Door.
- Light Redwood/Redwood. 2 Door.

#### LIMITED PARK AVENUES — 4 DOOR.

- Light Redwood/White. Demo.
- Dark Brown Firemist/Beige. Leather.
- White (Redwood Interior).
- White (Blue Interior)
- Dark Redwood/Redwood.
- Light Redwood/Redwood.
- Medium Sandstone/Beige.
- White/Blue.
- White/Redwood.

#### LeSABRE LIMITED

- \* White. Diesel. 4 Door. Hail Damaged.
- \* Dark Metallic Blue/White. 4 Door. Hail Damaged.
- \* White/Dark Blue. 4 Door. Hail Damaged.
- Light Redwood/Redwood. 4 Door.
- Light Redwood/Redwood. 2 Door.
- White. 4 Door.

#### GMC's:

- \* S-15 LONGBED. V-6, Automatic, Air. Medium Blue. Hail Damaged.
- \* 1/2-TON SIERRA. V-8, Automatic, Air. Candy Red. Hail Damaged.



#### 1/2-TON HIGH SIERRA — ALL HAIL DAMAGED.

- \* White/Dark Blue.
- \* White (Tan Interior)
- \* White (Blue Interior)
- \* Candy Red. Diesel 4X4.

#### 1/2-TON SIERRA CLASSIC — ALL HAIL DAMAGED.

- \* Bronze/Tan.
- \* Light Metallic Blue.
- \* 2 Almond Tan/White.
- \* Candy Red.
- \* Light Metallic Blue/White.
- \* 3 Candy Red/White.
- \* Yellow/White.

#### 1/2-TON SIERRA CLASSIC

- Black/White.
- White/Dark Blue.
- Bronze/White. Diesel.
- Candy Red/White. Diesel.
- Dark Brown/White. Diesel.

#### 1/2-TON 4X4 JIMMY

- \* Almond Tan/White. Diesel.
- Hail Damaged.
- White. Diesel.

#### 3/4-TON SIERRA CLASSIC.

- Candy Red/White. 454.
- Almond Tan/White. Diesel.
- Bronze/Almond. Diesel.
- Candy Red/White. Diesel.

#### 3/4-TON CREW CAB HIGH SIERRA — ALL HAIL DAMAGED.

- \* 3 White. Diesel.
- \* Candy Red. 454.

#### 1-TON CAB/CHASSIS — ALL HAIL DAMAGED.

- \* 60" CA High Sierra. Diesel.
- \* 84" CA High Sierra. Diesel.

\* NOTE — On any hail damaged Pontiac, Buick or GMC, we will be giving tremendous year-end discounts, plus the hail damage allowance off the bottom!



**TRUCKS ARE WHAT WE'RE ALL ABOUT**

### INVENTORY



#### Pontiacs:

- J2000 —  
4 Door. Light Blue.  
4 Door. Gold.
- \* J6000 — 4 Door. Dark Jadestone.
- BONNEVILLE — 4 Door. Diesel. Medium Beige.

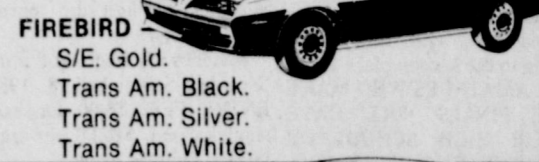

**FIREBIRD**  
S/E. Gold.  
Trans Am. Black.  
Trans Am. Silver.  
Trans Am. White.

#### Buicks:

- SKYHAWK — 2 Door. Charcoal.
- \* CENTURY LIMITED — 4 Door. Light Metallic Blue/Blue.

#### REGAL LIMITED —

- 2-Tone Sandstone. 2 Door.
- Dark Redwood/White. 2 Door.
- Silver/Dark Blue. 2 Door.
- Light Metallic Blue/Blue. 4 Door.

#### LIMITED PARK AVENUES —

- Dark Redwood/Redwood. 2 Door. Demo.
- Sandstone/Sandstone. 2 Door.
- Light Redwood/Redwood. 2 Door.
- Sandstone/Sandstone. 4 Door.
- Medium Sandstone/Beige. 4 Door.
- Slate Grey/Blue. 4 Door.
- Light Redwood/Redwood. 4 Door.



**ESTATE WAGON —**  
Light Sandstone/Woodgrain.  
Light Redwood/Woodgrain.

#### RIVERIA —

- Light Metallic Blue/White. Demo.
- Light Redwood/Redwood.

#### LeSABRE LIMITED —

- Medium Sandstone/Beige. 2 Door.
- Light Redwood/Redwood. 2 Door.
- Light Metallic Blue/Blue. 4 Door.
- Light Jadestone. 4 Door.
- White. 2 Door.

#### Oldsmobiles:

- OMEGA — 4 Door. White.
- FIRENZA SX HATCHBACK COUPE.

#### \*CUTLASS CIERA 4-Door —

- Light Redwood/Redwood. Diesel. V-6
- Light Metallic Blue/Silver.
- Light Redwood/Redwood.

#### TORONADO BROUGHAM

- Light Metallic Blue/White.
- Dark Blue/White.
- Light Redwood/Redwood.
- Light Metallic Blue/White.

#### 98 REGENCY BROUGHAM

- Light Redwood/Redwood. 2 Door.
- Medium Sandstone/Beige. 4 Door.

#### DELTA 88 ROYALE BROUGHAM —

- White. 2 Door.
- Dark Redwood/White. 4 Door.
- Medium Sandstone. Diesel.

#### CUTLASS SUPREME 2 DOOR —

- White.
- Charcoal/Grey.
- Light Metallic Blue/Blue.
- Slate Grey/Blue.

#### Cadillac:

- SEVILLE — 4 Door. Almond/White.
- COUPE DeVILLE — Pastel Yellow (Leather Interior)
- FLEETWOOD BROUGHAM D'ELEGANCE — 4 Door. Slate Grey/Silver.
- FLEETWOOD BROUGHAM — 4 Door. Demo. Slate Grey/Silver.

#### GMC's:

- 1/2-TON SIERRA —  
Light Blue/White.
- Silver — 4X4 Diesel.
- Light Blue/White. Diesel.
- Light Blue.
- White.

- 1/2-TON SIERRA CLASSIC —  
3 — Candy Red/White.
- Light Blue/White.
- Dark Blue/White.
- Bronze/White.
- Black/Silver. Diesel.
- Light Blue/Blue. Diesel.
- Dark Brown/White. Diesel.



**1/2-TON HIGH SIERRA —**  
Almond/White.  
White/Candy Red.  
Silver/Blue.

#### 1-TON CAB/CHASSIS —

- 84 CA. Candy Red. Diesel, Automatic, Air.
- 84 CA. Almond. 454. 4 Speed. Air.
- 60 CA. White. Diesel. Automatic, Air.
- 60 CA. Red. 454. 4 Speed, Air.

#### 1-TON DUALLY —

- Sierra Classic. 454. 4 Speed. Light Blue/Silver.

#### 1/2-TON 4X4 JIMMY —

- Sierra Classic. Dark Brown/White. Diesel.

#### 1/2-TON SUBURBAN —

- Sierra Classic. White/Candy Red.

#### 3/4-TON HIGH SIERRA —

- Bronze/Tan.
- Yellow/White.

#### 3/4-TON CREWCAB — HIGH SIERRA —

- 3 — 454. White.
- 1 — Diesel. White.
- 1 — Diesel. Candy Red.

#### GMC MEDIUM DUTY — CAB/CHASSIS.

- 1 — 60 Series 350, 4+2, Air Conditioned — 149" Wheelbase.
- 2 — 60 Series, 8.2 Detroit Diesel, 5+2, Air Conditioned — 149" Wheelbase.
- 1 — 70 Series, 8.2 Detroit Diesel, 5+2, Air Conditioned — 189" Wheelbase.
- 2 — 70 Series, 8.2 Detroit Diesel Turbo, 5+2, Air Conditioned — 203" Wheelbase.

**WE'VE SHARPENED OUR PENCILS AND FEEL LIKE TRADING! WE NEED TO MAKE ROOM FOR THE '83 MODELS GENERAL MOTORS HAS PREFERRED FOR US. THE MARKET FOR GOOD CLEAN USED CARS & TRUCKS HAS NEVER BEEN STRONGER.**

FOR SALES ASSISTANCE IN SPEARMAN SEE:

Donnie Hergert     Jerald Scribner

FOR SALES ASSISTANCE IN PERRYTON SEE:

Don Hergert     Darl Hergert     Troy Bolerjack     David Turner

• There is a \$400.00 Rebate from General Motors on Pontiac J6000, Buick Century and Olds Ciera.

We Would Sure Appreciate Your Business!!!

"... where SERVICE is the KEY!"

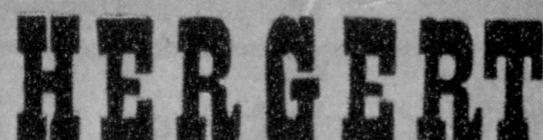

SOUTH HWY 207

(806) 659-3721

SPEARMAN, TEXAS

## DON HERGERT MOTORS INC.



420 S. Main

PERRYTON,

435-3686