

THE OBSERVER/ ENTERPRISE

Serving Coke County

(USPS 467-480)
(ISSN 8750-197X)

Vol. 108, No. 08

Friday, September 22, 1995

FSA seeks candidates

"Farmers and other eligible voters are asked to nominate candidates of their choice by October 30 for the county Farm Service Agency (FSA) committee election ballot," said Dwayne Vincent, County Executive Director. The FSA committee was previously known as the ASC County Committee.

The FSA county committee election will be conducted from November 24 to December 4 by mail ballot. FSA, an agency of the U.S. Department of Agriculture, administers farm commodity, crop insurance and conservation

Trail ride for Rehab set

The ruins of Fort Chadbourne on the historic Chadbourne Ranch in Coke County will echo with the sights and sounds of the past as an estimated 300 trail riders converge on the ranch for Trail Ride IV for Rehab September 29 through October 1. The ranch was the site of the first trail ride to benefit West Texas Rehabilitation Center in the spring of 1994.

As in the past, Trail Ride IV will provide a central campsite, a day-long ride on Saturday and a shorter ride on Sunday morning with lunch and supper on Saturday and breakfast on Sunday provided. Participation cost is a free-will donation that will go directly to benefit West Texas Rehabilitation Center in Abilene and San Angelo.

Entertainment will be provided on Saturday evening around the campfire with riders encouraged to bring their guitars, banjos, fiddles, and harmonicas and join in the fun.

Fort Chadbourne was established in 1852 and remained in use until 1864. Shortly after the Civil War, G.G. Odom settled in the area and founded the Chadbourne Ranch at the site of the abandoned fort. The ranch is still owned by his descendants. Ruins of the fort still stand on the ranch.

For more information call West Texas Rehabilitation Center, (915) 691-7290 (Abilene) or (915) 949-9535 (San Angelo). After 7:00 pm, call Mac Sayles at (915) 554-7884.

programs for farmers and makes farm ownership and operating loans.

Coke County farmers have the opportunity to nominate persons they feel would best serve their farm community on the FSA county committee. Farmers may request and receive nominating petition forms from the county office.

Vincent reminded farmers that to be valid, petitions must be limited to one nominee each, must include written certification that the nominee is willing to serve, if elected, and must be signed by at least three eligible voters in the local administrative area. Also, the petition must be received in the FSA office by the October 30 deadline.

Eligible voters may circulate or sign nominating petitions for as many candidates as they choose. Anyone wishing to nominate a farmer for the county FSA committee election may contact the county office for details, including eligibility requirements.

Coke Co. Trappers Ass'n. meeting

There will be a meeting for interested producers on Wednesday, Sept. 27, 1995, at 7:30 pm at the Robert Lee Rec Hall to discuss the possibility of sharing a second trapper with Tom Green County.

The need for a second trapper and funding for the project will be the main concerns discussed. All interested livestock producers are encouraged to attend.

RL Class of '45 celebrates

The 1945 Class of Robert Lee High School plans to celebrate with a 50th Reunion on October 7, 1995. The celebration will begin at 10:30 am at the Old Rec Hall, with a catered meal served at 1:00.

Other class members and friends are invited to join the festivities. Deadline for the meal reservation is October 1.

Class members also plan to participate in the Homecoming parade and pep rally. They will attend the football game as a group.

Serving on the planning committee are Barbara Adkins, Erma Lee Gartman, and Jamie Boren.



Hans Klingler, West Texas Regional Director for Senator Phil Gramm, addresses Robert Lee citizens concerning small towns and their voice in the nation. Mayor John Conley hosted the meeting held at Robert Lee City Hall Thursday, Sept. 7.

Dedication of historical marker

The formal dedication of the Southern Overland Trail historical marker will be held Tuesday, September 26, at 3:00 pm. Location of the marker is midway between Bronte and Robert Lee on Hwy. 158.

Hole in one!

Bill Bolton of San Angelo aced hole #6 on the Singing Winds Golf Course on Thursday, Sept. 14. The 185-yard shot was witnessed by Mike Figueroa of San Angelo, Delbert Caffey of San Angelo, and Mack Baker of Bronte. The drizzle falling at the time didn't dampen his golf game at all!

Tuesday Dance

The Coke County Cavaliers will provide C/W music for the Tuesday Special Dance on Sept. 26 at 7:30 pm. The dance is held on the fourth Tuesday of each month at the Rec Hall in Robert Lee. Tickets are available at the door.

Volunteers needed

A volunteer auxiliary is needed at the Bronte Nursing Home. If you are interested in giving a couple or three hours of your time each day to help the residents at the nursing home, please contact Pam Stokes or Dean Pope at 473-3621.

The Happy Heart Square Dancers are back and they visited with us on September 12th. Welcome back, club! The residents are all ready for you again!

4-H members win at area fairs

Several Coke County 4-H junior livestock producers have won awards at the area fairs the past several weeks. At the Mason County Lamb Show, Ashlee Millican exhibited the first place Finewool cross lamb in the middleweight class. During the Permian Basin Fair, held in Odessa, Ashlee placed seventh in the light Finewool cross class, eighth in the heavy Finewool class and tenth in the middle Medium Wool class. Erin Millican also placed tenth in the heavyweight Finewool class.

At the Howard County Fair, held in Big Spring, Shea Kelton won Reserve Breed Champion with his All Other Breeds steer, and Casey Antilley placed fourth in the medium weight Maine-Anjou class.

During the West Texas Fair in Abilene, Shea Kelton had the Reserve Champion Angus, Dustin Scott placed seventh in the lightweight European Crossbred steer class, and Casey Antilley placed fourth in the lightweight Hereford steer class. Shea also placed fourth in his showmanship class.

These and all of the other Coke County 4-H livestock producers have a tremendous set of livestock projects that will be exhibited not only at the Coke County Livestock show, but should represent our county very well in the major shows around the state this coming spring. They

should be congratulated on their hard work with these projects.

Gramm aide talks politics in RL

Mr. Hans Klingler, West Texas Regional Director for Senator Phil Gramm, was present last Thursday, Sept. 7, to answer Robert Lee's questions about the standing of small towns in the national political picture.

The Legislative Update took place at Robert Lee City Hall, one of 80 sites targeted by Senator Gramm's Lubbock office as an area in need of a voice in the political arena.

Mr. Klingler expressed to those present that one goal of the senator's agenda was to help avoid shutdown in the "information pipeline" to small towns. Mr. Klingler's job is to visit with area small towns in order to take their concerns to Senator Gramm.

One major focus of the senator, claimed Klingler, is to take as much federal control out of local and county levels as is reasonably possible. This could entail putting accountability requirements on the EPA, re-evaluating federal bills imposed on local entities, and eliminating unnecessary and potentially harmful federal departments.

Mayor John Conley hosted the afternoon meeting. Also present were Robert Lee State Bank President Bill Allen, Billy Kelly of WTU, city secretary Kay Torres and O/E reporter Angie Cox. Photography by Bobby Cox.

THE OBSERVER/ENTERPRISE
 Published Weekly Except Christmas
 707 Austin (915) 453-2433
 (USPS 467-480) (ISSN 8750-197X)
 Second Class Postage paid at Robert Lee, TX.
POSTMASTER: Please send address changes to Observer/Enterprise PO Box 1329, Robert Lee, TX 76945.

STAFF
 Hal Spain, Publisher
 Joan Davis
 Jo Nell Blair
 Angie Cox

SUBSCRIPTION RATES
 Per Year in Coke County.....\$15.00
 Per Year Elsewhere in Texas.....\$17.00
 Per Year Outside of Texas.....\$20.00

Death Notices

Eubanks

Elma Lee Eubanks of San Angelo died September 12, 1995. Services were held at 10:00 am Friday, September 15, in Johnson's Funeral Home Chapel, officiated by Dr. Dan Williams. Burial followed in Lawnhaven Memorial

Stensatters join American Angus Association

Wesley and Brian Stensatter, Bronte, are new members of the American Angus Association, reports Dick Spader, executive vice president of the national organization with headquarters in St. Joseph, Missouri.

The American Angus Association, with over 29,000 active adult and junior members, is the largest beef cattle registry association in the world. Its computerized records include detailed information on over 12 million registered Angus.

The Association records ancestral information and keeps records of production on individual animals for its members. These permanent records help members select and mate the best animals in their herds to produce high quality, efficient breeding cattle which are then recorded with the American Angus Association. Most of these registered Angus are used by the U.S. farmers and ranchers who raise high quality beef for U.S. consumption.

RL Methodist Women meet

United Methodist Women Dorcas Circle of Robert Lee met in their church's Fellowship Hall in regular second Wednesday meeting, September 13, 1995.

Fay Roe, hostess, served 12 members and one guest, Leola Bolding of Plainview.

President Charlotte McKnight presided over a business meeting before Lois Dunklin presented a challenging program concerning "Street People."

Although Robert Lee does not have the problem with homeless people that large cities have, members were made aware of U.M.W.'s funds being used in needy areas. Problems of local need were discussed, and plans were made for meeting some of them.

Gardens with full military honors, directed by Johnson's Funeral Home.

He is survived by his wife, Leo Eubanks of the home; one son, Rick Eubanks, and wife, Lenore, of Glendale, Arizona; one daughter, Pam Salmon and husband, Richard, of San Angelo; two brothers, Alex Eubanks of Tranquility, California, and Sidney Eubanks of Bronte; two sisters, Averil Taylor of Mule Creek, New Mexico, and Jo Nance of Poway, California; two granddaughters; and two great-grandchildren.

Crain

Funeral services for Cecil H. Crain of Blackwell were held Friday, September 15, 1995, at the Blackwell Church of Christ. Interment followed in Blackwell Cemetery, directed by Johnson's Funeral Home.

Survivors include five children: Jean Guthrie and husband, Jimmie, of Midkiff; Sue White and husband, Jay, of Odessa; Richard Crain and wife, Charlotte, of Bronte; Janis Hollway and husband, Ralph, of San Angelo; and Kenneth Crain and wife, Sandy, of San Angelo; 15 grandchildren; eight great-grandchildren; and one sister, Velma Younger, of Sweetwater.

River of Life Church
invites you to join them

for worship Sunday morning at 10:30 am at Texas Theatre - Bronte, TX

Call for time and location of Wednesday Prayer Meeting.

For more information call Pastor Eddie Sparks (915) 473-5901

An Interdenominational charismatic church.

CLOUD SEEDING EVENT INFORMATION AS PERFORMED BY THE COLORADO RIVER MUNICIPAL WATER DISTRICT OVER COKE COUNTY, TEXAS FOR THE SEVEN DAY PERIOD ENDING SEPTEMBER 15, 1995

On September 9, 1995, a cloud system was seeded beginning at 9:01 am and ending at 9:07 am, CDT, over an area in northern Sterling County. Clouds moved east at 25 miles per hour into northern Coke County.

O.H. Ivie
 General Manager

Colorado River Municipal Water District
 PO Box 869, Big Spring, Texas 79721

Obituaries

Blackmon

Ruby Blackmon, of Bronte passed away Thursday, September 14, 1995, at her home.

She was preceded in death by a son, Ronald Terry Blackmon.

Service was conducted at 11:00 am, Saturday, September 16, at the Central Baptist Church in Bronte. The Rev. Jimmy Rogers of San Angelo officiated the services, assisted by the Rev. Randy Johnson of Bronte.

Mrs. Blackmon was born November 5, 1919, in Houston County. She married Ronald W. Blackmon May 15, 1937. Ruby was a nurse by profession and a caregiver and homemaker by nature. After retiring from the nursing profession, she was a volunteer at the East Coke County Nursing Home, receiving Volunteer of the Year Award in 1994. Ruby was a member of Silver Baptist Church.

Along with her husband, Ruby is survived by two daughters and their husbands, Jerry and Bette McCutchen of Abilene and Sue and Eddy Spiller of Taylor; grandchildren, Kevin, Sherri and Travis Spiller, all of O'Donnell, Terry, Carol, and Alyssa McCutchen, all of Abilene, Kelly Spiller of Taylor and Johnathon McCutchen of Abilene.

The family requests that memorials be sent to the Hospice of the Big Country in Abilene.

Services were under the direction of Shaffer Funeral Home of Bronte.

08a-1tc

Schooler

Weldon C. Schooler passed away September 15, 1995, in Kona, Hawaii, following a short illness.

Mr. Schooler was born in Robert Lee on January 1, 1930. His parents were Jodie and Raymond Schooler. He graduated from Robert Lee

High School in 1947. He married Leta Dobbs from Colorado City, Texas. They operated a coffee farm and processing plant in Kona, Hawaii.

Survivors include his wife, Leta, of Kona, Hawaii; two sons, Lee Schooler and Lynn Schooler; two daughters, Lisa Nolan and Luan Wilson; three grandchildren, all of Alaska; his mother, Josie Schooler, a resident of Robert Lee Nursing Home; one sister, Mary Beth Snyder of Athens, Texas; and one niece, Michelle Boeckman of Melbourne, Australia.

A family memorial service was held in Kona, Hawaii.

08a-1tc

Reed

Cash R. Reed, Jr., 76, of 320 Hawk St., Dublin, Texas died at 5 am August 20, 1995 at DeLeon Hospital in DeLeon, Texas. He was born December 11, 1918 at Binger, Oklahoma to Cash R. Reed and Winnie Williams.

On July 12, 1941 he married Zelma May Wollet at Healdton, Oklahoma. He was a retired carpenter and a member of the U.S. Navy during World War II. He was a

member of Community Baptist Church in Dublin, Texas.

He is survived by his wife, Zelma Reed of Dublin; three daughters, Mrs. Mary Simpson of Brownwood, Mrs. Angela Gay Van of Abilene, and Mrs. Debra Kay Burns of Stephenville; and one son, Cecil Ray Reed of Brownsville.

He is also survived by Winston J. Reed of Gainesville; 12 grandchildren and three great grandchildren.

Funeral services took place Tuesday, August 22, 1995 at 2:00 pm with Rev. Mike Fritscher serving as clergy. Burial was at Reed Cemetery under the direction of Scott-Morris Funeral Chapel of Nacoma, Texas. Pallbearers were grandsons, Carl Simpson; Jarrett Simpson; Brandon Simpson; Danny Garcia; David Garcia; Michael Adkins; Anthony Proa; Charlie Reed and Cody Proa.

Memorials may be made to Bob King Ministries, P.O. Box 87, Quemado, Texas 78877-0087, to feed hungry children in Mexico.

08a-1tc

SHRINE CIRCUS



PRODUCED BY GEORGE CARDEN CIRCUS INTERNATIONAL

SPECTACULAR
3-RING EXTRAVAGANZA

SAN ANGELO COLISEUM
 San Angelo, Texas
SUNDAY, SEPTEMBER 24th
 Shows at 1:00 pm & 5:00 pm

ADULTS \$8.00 CHILD 1-12 YRS. \$4.00

Tickets On Sale NOW At All C&W One Stops in San Angelo Also at Coliseum on Showday Reserve Seating \$1.00 Extra at Coliseum

PROCEEDS FROM THIS SHRINE CIRCUS BENEFIT SUEZ SHRINE TEMPLE/CONCHO SHRINE CLUB. PAYMENTS ARE NOT DEDUCTIBLE AS CHARITABLE CONTRIBUTIONS.

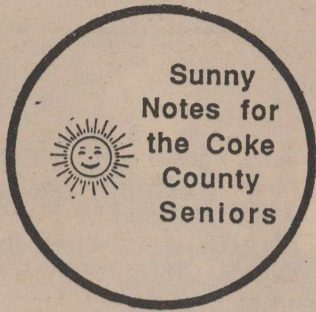

Sunny Notes for the Coke County Seniors

Medicare 101

"Everything you ever wanted to know about Medicare but didn't know how to ask." This program is open to the public on Tuesday, Sept. 26, from 10:00 am to 12:00 noon at the Texas A&M University Agricultural Extension Center, located off US 87 north of San Angelo. Admission is free, but reservations are required. To obtain reservations or additional information, call 1-800-725-8315. The program is presented by the Texas Partnership for Promotion of Health Awareness.

Potluck Luncheon

Time again for our monthly "88" and potluck luncheon day, Thursday, Sept. 28. Texas Agricultural Extension Service will provide a short video on family nutrition. Door opens at 9:00 am for games and program at 11:15, with lunch following at 11:30. Bring your favorite dish and come join us for fun and fellowship.

Br. to host RL

Thursday, October 5th is the scheduled date for another domino tournament in Bronte. Coffee and registration begins at 9:00 am, with tournament play beginning at 9:30. The Bronte ladies will provide lunch. You all come!

Menu for the Week Monday, Sept. 25

Polish Sausage, French Baked Potato Slices, Green Beans, Hot Roll, Blushing Pears

Wednesday, Sept. 27

Bar-B-Que Pork Sandwich, Baked Potato Slices, Mixed Vegetables, Oatmeal Cookies w/ raisins

Friday, Sept. 28

Pork Chops, Turnip Greens, Wheat Bread, Cucumber & Onion Salad, Apple

These programs are funded in part by the Area Agency on Aging, Concho Valley Council of Governments, through grants from the Texas Department on Aging.

Planned Parenthood hours

Planned Parenthood of West Texas, Inc. provides birth control methods and information, pap smears, breast exams, testing for sexually transmitted diseases, pregnancy testing and referrals, mid-life services, anemia and diabetes screening, and prenatal care for Medicaid-eligible patients. Mammograms are currently available to qualified patients.

Services are based on a sliding fee scale and all services are confidential. Call (915) 944-1909 for information and appointments.

The San Angelo clinic address is 2619 Sherwood Way. Hours of operation for October are: Monday, Wednesday, Thursday, and Friday 8:00 - 5:00; Tuesday, 9:00 - 6:00.

Bronte Sorosis Study Club meets

The Bronte Sorosis Study Club met last Thursday night, September 22, for a salad supper and meeting in the home of Mr. and Mrs. Royce Lee. This marked their first meeting of the year.

President Mrs. Clark Glenn presided at the meeting. Reports were made from Secretary Mrs. Bill Luckett and Treasurer Mrs. E. F. Glenn.

Committees gave reports, including Yearbook Committee: Mmes. Mildred Thomason, Royce Fancher, and Royce Lee; Project Committee: Mmes. Martin Lee, Noah Pruitt, Jr., Royce Fancher, and Royce Lee; Finance Committee: Mmes. E. F. Glenn, Bill Luckett, and Richard Hembree; Resolutions Committee: Mrs. Thomason; and Courtesy Committee: Mmes. E. F. Glenn and Frances Kemp.

The Project Committee reported projects for the ensuing year, including:

1. To continue gazebo certification.
2. To provide Christmas gifts for residents of Bronte Nursing Home.
3. Host birthday party for residents.
4. Provide support for the Coke County Juvenile Justice Center.
5. Participate in "Christmas in Olde Bronte" and "Summer Fest."
6. Annual collections for food for area food bank.

7. Support all projects with benefits from the Annual Rummage Sale to Carlsbad State School.

Officers for the coming year include: President - Mrs. Clark Glenn; First Vice President - Mrs. Mildred Thomason; Second Vice President - Mrs. Martin Lee; Secretary - Mrs. Bill Luckett; Treasurer - Mrs. E. F. Glenn; Reporter - Mrs. Margaret Martin; Parliamentarian - Mrs. Royce Fancher; Historian - Mrs. Richard Hembree; Federation Counselor - Mrs. Frances Kemp.

Those present included Mrs. Martin Lee, Mrs. Clark Glenn, Mrs. E. F. Glenn, Mrs. Royce Lee, Mrs. Martin Lee, Mrs. Bill Luckett, Mrs. Noah Pruitt, Mrs. Mildred Thomason, Mrs. Frances Kemp, and a visitor, Mrs. J. J. Bowden.

Social Security bulletin

Garland Gregg, representative for the San Angelo Social Security Office, has scheduled his September visits to Bronte and Robert Lee.

In Robert Lee, he will be in the Conference Room of the County Courthouse on Thursday, September 28th, between 11:00 am and 11:30 am. In Bronte, he will be at the Council Room of City Hall on Thursday, Sept. 28, between 1:30 pm and 2:00 pm.

Anyone who wants to file a claim for benefits, get information, or transact other business with the Social Security Administration may contact him at this time.

*Larry, Larry, quite contrary
My, How time has flown!
A few short years
of laughter and tears
Now you're forty and
almost grown!*

AUTOMOTIVE ESSENTIALS FROM ACE

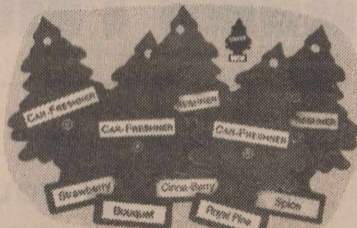

Car Freshener

Tree shaped air freshener. Comes in a sealed pouch for freshness. Pine, cinnamon and berry, bouquet, spice, vanilla, and strawberry.

69¢ EA.

No Touch Tire Care

Cleans, shines and protects tires in one easy step. No rubbing or wiping. Lasts for weeks. 21 oz.

3.00 EA.



Armor All Protectant

Renews, revitalizes, and protects rubber, leather, vinyl and plastic. Also available in Low-gloss. 16 oz.

3.99 EA.

Motor Oil

All season. Improves performance and engine life. 10W30, HD30 or 10W40.

94¢ QT.



Bob Wrinkle's Ace Hardware 416 Commerce Robert Lee (915) 453-2414

FOOD **Super H IGA** LIMIT
STAMPS RIGHTS
WELCOME RESERVED

501 Commerce - Robert Lee, TX
Store Hrs: Mon-Sat 8-8 Sun. 8-6
SPECIALS GOOD 9/20 Thru 9/26

Family Pack Split
Fryer Breast
Lb. **.99**

Fresh
Picnic Roast
Lb. **.79**

Tyson Value Pack Fryer
Thighs or Drumsticks
Lb. **.79**

IGA Tablerite Boneless
Rib Eye Steak
Lb. **3.99**

Fresh
Ground Chuck
Lb. **1.39**
Family Pak (3 Lbs. or More)

Colorado Russet
Potatoes
10 Lb. Bag **1.29**

SA Coin & Stamp Show

The San Angelo Coin and Stamp Show will be held at the Howard Johnson Motel, 333 Rio Concho Drive, San Angelo, Saturday, September 30, from 10 am to 6 pm and Sunday, October 1 from 10 am to 4 pm. Admission is free.

The 150th Birthday of Texas is in 1995. To help commemorate this event the Stamp show theme will be Texas's Birthday. There will be a special show cachet (envelope with a picture) with a Texas Statehood commemorative stamp and a special cancellation issued by the United States Postal Service. The Texas History students of San Angelo ISD will enter pictures of their Texas Birthday cards. These will be displayed at the Show.

There will be various philatelic (stamp collecting) exhibits, six stamp dealers, the United States Postal Service window, and fifteen coin dealers.

The general public is cordially invited to come and visit the show and dealers to learn more about coin and stamp collecting.

The San Angelo Coin Club meets the second Thursday of each month at 7 pm at the El Patio Motel.

The Concho Valley Stamp Club meets the second Tuesday of each month at the Main Post Office and the fourth Thursday at Norwest Bank. The meetings start at 7 pm. Both clubs welcome visitors to all meetings.

Local judge attends seminar

Judge Joan Davis was certified at the recent 20 Hour Justice of the Peace Seminar held September 10-13, 1995 in Lubbock, Texas. The seminar was sponsored by the Texas Justice Court Training Center, headquarters at Southwest Texas State University in San Marcos. The seminar is one of five held for elected Justices of the Peace so they can fulfill their Continuing Judicial Education Requirements as set forth in Article 27.005 of the Texas Government Code. The seminar addressed topics such as Judicial Ethics, Contempt, Criminal and Civil Jurisdiction and Venue, Parks and Wildlife Laws, Trial Procedure, Alternate Sentencing, Bad Checks, Examining Trials, Regulatory Laws, Small Claims, Administrative Hearings, Civil Law, Criminal Law, Dealing with Anti-Government Groups, Traffic Laws, Alcoholic Beverage Laws, Juvenile Laws, Landlord and Tenant Law and Inquests.

RL PTA holds membership drive

The Robert Lee PTA had a very successful membership drive. Ribbons were awarded to the top 3 classes of K-6 that participated in the membership drive. Classes receiving ribbons were: 1st place - Mrs. Horn's second grade class; 2nd place - Mrs. Burns's 6th grade class; 3rd place - Mrs. McCown's third grade class and Mrs. Randolph's second grade class (tie). Congratulations to the classes who worked so hard for the PTA!



Taking first place in the RL PTA membership drive is Mrs. Horn's 2nd grade class of Robert Lee Elementary.



Mrs. Burns's 6th grade class at Robert Lee Elementary took second place in the PTA membership drive.

Nursing home residents enjoy "Tuesday Special"

On September 12th, 42 residents of West Coke County Nursing Home attended a dance held in the recreation room of the facility. Entertainment was provided by the Coke County Cavaliers band. Also present to enjoy the festivities were 15 guests from the area.

The turnout was great!! There was toe tapping and hand clapping by all. As the band played a variety of country music, the dance floor was set on fire by the talented dancing abilities of Tommy Hood, J. T. Morton, and any lady lucky enough to be chosen to be their dance partner. Mr. and Mrs. Walter Paul gave the dance floor a touch of grace as they joined in the

dancing.

Coke floats were served as refreshments and enjoyed by all. With the help of great music and good fellowship, the recreation known as the "Tuesday Special" was a complete success.

4-H officers elected

The Robert Lee and Bronte 4-H Clubs elected officers for the 1995-96 4-H year. The Robert Lee Rabbit Twisters officers are: Coke Hendry - President, Stewart Millican - Vice President, Erin Millican - Secretary, and Whitney Milligan - Council Delegate. The Bronte Renegades officers are: Cara Sefcik - President, Angie Harrell - Vice President, Shannon VanVleck - Secretary and Jake Graves - Council Delegate.

The Shamrock Clinic of Robert Lee welcomes Ralph Simon, M. D.

as a temporary provider for your family's health care needs.

Clinic hours remain

Monday/Wednesday 8-11 a.m. & 12:30-6 p.m. Tuesday & Friday 12:30-5 p.m.

Closed Thursday except for business office concerns

722 South Washington
378-2112

Shamrock Clinic of Robert Lee is an affiliate of the Shannon Health System.



Third place was a tie between Mrs. McCown's 3rd grade class (pictured) and Mrs. Randolph's 2nd grade class.



Third place was a tie between Mrs. Randolph's 2nd grade class (pictured) and Mrs. McCown's 3rd grade class.

WINK INSURANCE AGENCY



Home*Auto
Life*Commercial

715 Austin - 453-4551

HEAD FOR THE HILLS

Depend on Texas Cellular to keep you within range.

- Great Rates
- Safety
- Convenience
- Peace of Mind

Great cellular communication and service from your local cellular provider!



TEXAS CELLULAR.

A service of Taylor Telecommunications, Inc.

Call Anytime.

Snyder
2403 W. 25th Street
(915) 573-2424

Roy Blair, Agent
Robert Lee
824 Austin
(915) 453-2380

Sweetwater
1901 Bristol
(915) 235-4377

The Hornets' Nest

Sports Beat

by Ted Toyias

Blackwell wins their second straight victory this season by beating Highland 32-16 for the first time in three years! Nathan Hayes rushed for 116 yards and Shawn Roberson had one completion for 55 yards. Nathan Hayes had eight solo tackles and one assisted tackle, while Jesus Solis had six solo tackles.

Shawn Roberson, sophomore quarterback, felt that the team made some positive changes at Highland. Roberson commented that "we are turning into more of a team and not concentrating so much on individuals."

According to Assistant Coach Billy Magness, "Highland came out and scored early, but had it called back by a penalty. Blackwell bounced back, but because of failed extra point attempts and called back touchdowns of our own, were behind 16 to 12 at the half. Penalties again cancelled a touchdown by B. J. Marshall on a second half kickoff return. Shawn Roberson and Joe Blackburn both left the game because of injuries, but those coming in played well, and the remaining players stepped up their efforts the second half to see Blackwell defeat Highland."

Roberson summed up the emotions of the heated battle when he shared that "in a way, I feel that the team wasn't fired-up enough. But, what keeps us together as a team and what helps us win is the pride of the Blackwell Hornets!"

Blackwell's record moves to 2-0. Hornet Pride will be celebrated with their homecoming game this Saturday at 7:30 against Leuders-Avooca.

School Beat

by Kristy Loveday

Six weeks tests will be going on this week and next week. The schedule is as follows:

Thursday, Sept. 21 - 1st period and 7th period; Tuesday, Sept. 26 - 2nd period and 4th period; Wednesday, Sept. 27 - 3rd period, 5th period, and 6th period.

Teen-agers need a place of their own

Teen-agers want a place to call their own.

But, according to Lisa Benson, who recently completed her master's degree in architecture at Texas A&M University, adolescents rarely have a place designed specifically for them.

Benson surveyed high school students and their parents to determine what locations teens have staked out for their leisure hours.

Benson concludes that adolescents do not have a place to go after school and on weekends that satisfies their developmental needs and incorporates popular youth culture.

She notes that people used to go straight from childhood into the working world of adults, so that adolescence is a recent phenomenon.

Blackwell CISD FFA/FHA officers elected

Blackwell FFA officers were elected on Sept. 8, 1995. The 1995-96 officers are as follows: President - Sr. Jesus Solis; Vice President - So. Jimmy Loveday; Secretary - Jr. Brandon Boyd; Treasurer - Jr. Jessica Shaffer; Reporter - Jr. Rose Melton; Sentinel - Jr. Jerry Watts

The 1995-96 FHA officers were also elected. They are as follows: President - Sr. Mariana Solis; Vice President - Sr. Joe Blackburn; Secretary - Fr. Kristen Harvell; Treasurer - Sr. Jesus Solis; Public Relations - So. Joanie Ussery; Parliamentarian - Sr. Clint Egger.

Congratulations!!



RL Sophomores participate in PLAN

Robert Lee High School tenth graders will take part in an exciting program this fall offered by ACT. The program, called PLAN, includes academic tests, a survey of interests, and an assessment of study skills knowledge. Students who participate in PLAN get a head start on career and educational planning. PLAN results help them plan their remaining two years of high school and set career and educational goals for their life after high school.

The PLAN program will be available to all sophomores and will be offered on October 11, 1995. Students and parents can receive more information on PLAN by contacting Melba Mauldin in the Robert Lee ISD counseling office. All sophomores are encouraged to participate in this program.

LOOK WHO'S NEW

Sloan Thomas Boren
John and Jill Boren of Snyder have announced the birth of their son, Sloan Thomas. He was born Monday, September 18, at 1:40 am at Cogdell Memorial Hospital. Sloan measured 21 inches and weighed in at six pounds, fourteen ounces. He has been welcomed by his sisters, Lauren and Jordan.

Grandparents are Jerry and Mary Hendon of Dublin and Bob and Jamie Boren of Robert Lee. Alta Bilbo of Robert Lee is Sloan's great-

grandmother.

LOOK WHO'S NEW

Ethan Jameson Wilson
Everett and Nina Wilson of Robert Lee proudly announce the birth of their son, Ethan Jameson Wilson, born in San Angelo August 30, 1995. Ethan weighed 8 pounds, 5 ounces at birth, and he was 19 1/2 inches long.

Also happy to have him in the family are grandparents Clifford and Susie Wilson of Silver, and Ralph and Pat Kalusche of Wichita Falls.



CONCHO REALTY

1-800-530-4242

1386 PECOS
SAN ANGELO, TEXAS 76901
BUS: (915) 653-4535

NELL KENNEDY
APPRAISER/REALTOR
RES: (915) 453-4355

Shannon Regional Clinics: Bringing A New Health System To West Texas.



J.M. and Margaret Shannon...
the original healthcare pioneers
of West Texas.

The new Shannon Health System isn't just for San Angeloans. Because a Shamrock Clinic or rural health clinic brings Shannon quality to a 19-county area

in West Texas. If need be, your clinic doctor can always call on the specialist physicians and resources of Shannon Medical Center.

In addition to bringing Shannon Health System to your hometown, we can also bring you to Shannon — at 150 miles an hour, using our Medivac I helicopter for air emergency medical transport.

So no matter where you live in West Texas, don't settle for anything less than Shannon Health System. We're pioneering a new health system in West Texas. Shannon Clinic, Shannon Health Plan, Shannon Regional Clinics and Shannon Medical Center form the area's first integrated network of high quality, affordable healthcare services. Call 657-6222, or outside of San Angelo call 800-640-6222 for information on Shannon Health System and how we can bring better healthcare to your hometown.

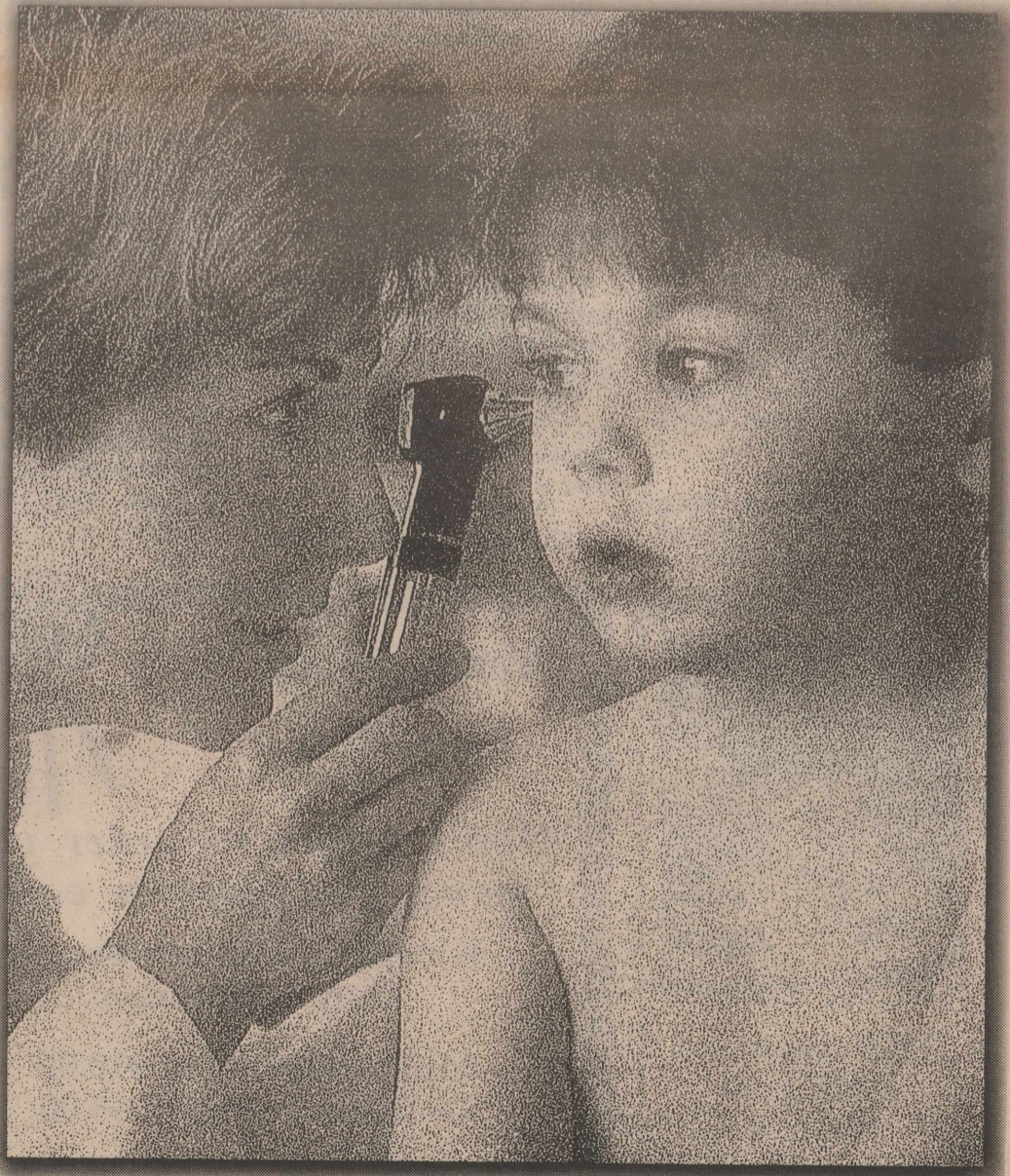

Shannon Regional Clinics:

- | | |
|------------------------------------|----------------------------------|
| Ballinger Rural Health Clinic | Coleman Doctor's Clinic |
| Ballinger Memorial Hospital Clinic | Shamrock Clinic of Menard |
| Big Spring Family Medical Center | Shamrock Clinic of Robert Lee |
| Brady Regional Health Center | Shamrock Clinic of Sterling City |



SHANNON Healthcare
HEALTH SYSTEM **Pioneers**
of West Texas

120 East Harris Avenue, San Angelo, Texas 76903
657-6222 • 800-640-6222 (outside of San Angelo)



ROBERT LEE SCHOOL NEWS

Steers hold Mountaineers scoreless

by Bill Burns

Robert Lee went on the road last Friday night for a showdown with the Santa Anna Mountaineers. It was expected to be a tough game for the Steers, but the Steers took control early and never looked back.

The Steer offense has moved the ball almost at will in the first two games this year, but the defense is a work of

art. When the Steer defense give up a yard to an opponent it is done very grudgingly.

Last week I mentioned that the Steers still had some rough edges, but those are being polished, and this week the Steers were much improved.

First Quarter

Santa Anna received the opening kick-off and went to work with a quick first down on a twenty yard pass play. The Steer defense then forced Santa Anna to punt.

The Steer offense was stopped short of a first down and had to punt. Santa Anna managed only 4 yards and punted back to the Steers. Harley Wagner broke loose for a 43 yard scamper and the Steers' first score. Gilbert Torres kicked the extra point and the quarter ended.

Steers - 7, Santa Anna - 0.

Second Quarter

The Steer defense held the Mountaineers to 21 total yards in this quarter while the offense had a field day.

Eric Hood scored on a 30 yard pass play with Aaron Hood throwing the pass. Just 3 minutes later Aaron Hood broke free on a quarterback keeper play and went 44 yards for a Steer touchdown.

With 3:25 left in the quarter, Aaron Hood again scored, this time on a three yard run. Gilbert Torres kicked the extra point. With seven seconds left in the half, Aaron Hood completed a TD pass to Jerrod Copeland.

Steers - 32 - Santa Anna - 0.

Third Quarter

The Steers rolled up 110 yards of offense, and Jerrod Copeland got his second TD of the night on a five yard run.

The Steers continued doing a fine job, with Rob Smith recovering a fumble for the Steers.

Fourth Quarter

The Steers lost two fumbles

this quarter. The Steer defense got some turnovers themselves. Jeremy Burns and Mark Owen both recovered fumbles.

Jason Key intercepted a pass and the game ended. Steers - 38, Santa Anna - 0. **Good Job Steers!!!**

RLHS homecoming

The 1995 Robert Lee homecoming will be October 6th. The homecoming parade will be at 2:00 pm. This year's theme will be "Hard Rockin' Steers."

All groups and organizations are invited to participate by entering a float in the parade. The parade will be followed by a pep rally at 3:00 in the high school gym. The football game with Cross Plains will begin at 8:00 pm.

As part of the homecoming festivities, the cheerleaders will be honoring all past Steer Award recipients in the parade, at the pep rally, and at the game. The Student Council will sponsor a dance from 10:00 pm until 1:00 am at the new rec hall.

1995-96 RLHS Student Council Officers

The RLHS Student Council elections were held Aug. 29th. These were the officers for this year: President - Heather Millican; Vice President - Korey Pitcock; Secretary - Patricia Minjarez; Treasurer - Aaron Hood; Reporter - Bree Bolding.

Class Representatives are as follows: 12th grade - Maranda Wojtek and Eric Hood; 11th grade - Meagan Hill and Jerrod Copeland; 10th grade - Tracy Millican and Scotty Wyatt; 9th grade - Holly Copeland and Justin Francis; 8th grade - Macy Hill and B. J. Bessent

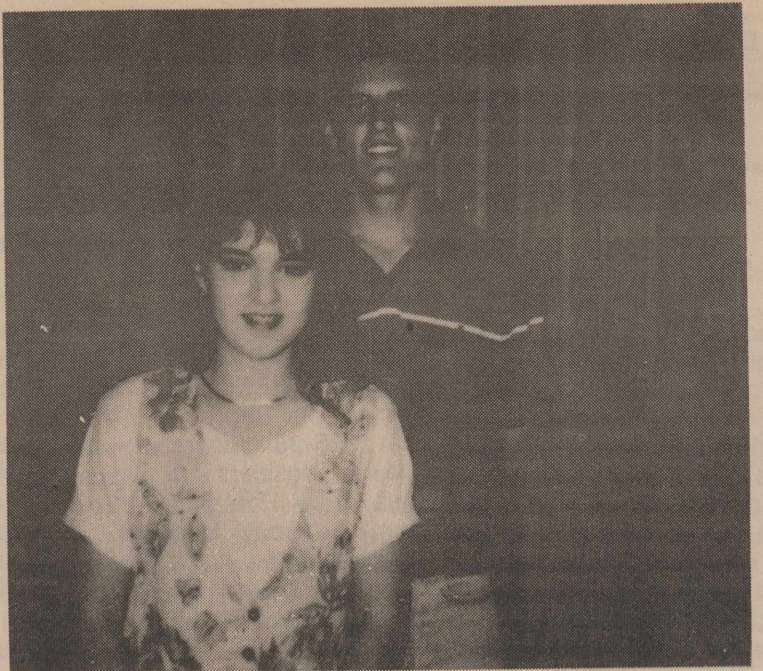

Aaron Hood and Heather Millican have been elected Mr. and Miss RLHS by the student body. The pair are seniors at Robert Lee High School.

RL Dogies Win

By B. J. Bessent

The Robert Lee Dogies played Christoval in front of their home crowd. The Dogies displayed their talent well. In the first quarter, Dogies' Daniel Cates ran the ball in for the first six points. Andrew McCabe scored and got the extra points to make the score 16-0 at the end of the first quarter.

In the second quarter, the Dogies kept scoring. Deric Brothers scored on a reverse, and McCabe took the 2-point conversion in. The Dogies scored once more to put the score at 32-0 at the half.

The Dogies defense finally let up, and that put the score at 32-8. That's the way it was when the final buzzer sounded. The Dogies are open this week, but come out to support the Dogies on September 29 at Robert Lee.

Go Dogies!

RL JV shuts out Mountaineers

By Chad Helwig

Robert Lee JV's defense held a tough Santa Anna JV team scoreless through 4 quarters. The offense got going after the first quarter after a long touchdown run by Michael Munoz. The 2-point conversion failed.

Jason Tavarez caught a pass worth 6 points from Chad Helwig for the next score. Helwig scored on the 2-point conversion try, to make it 14-0 Steers.

Will Simpson rounded out the scoring with his touchdown run. The final score of the game was 20-0. The Steers stayed perfect after a 22-8 win over Miles the week before. They have represented our school well, and we are proud of them. Way to go, Steers!

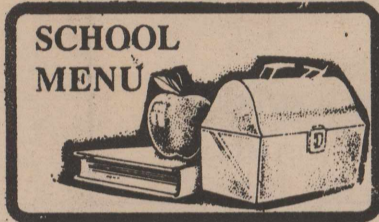

SCHOOL MENU

Breakfast

Monday, Sept. 25

Breakfast Bagel, Orange Juice, Milk

Tuesday, Sept. 26

Donuts, Cold Cereal, Orange Juice, Milk

Wednesday, Sept. 27

Breakfast Pizza, Orange Juice, Milk

Thursday, Sept. 28

Cinnamon Toast, Cold Cereal, Orange Juice, Milk

Friday, Sept. 29

Biscuits & Sausage, Orange Juice, Milk

Lunch

Monday, Sept. 25

Meat & Cheese Nachos, Pinto Beans, Tator Tots, Crackers, Apricots, Milk

Tuesday, Sept. 26

Salmon Croquettes, Macaroni & Cheese, Blackeye Peas, Buttered Rolls, Peaches, Milk

Wednesday, Sept. 27

Chicken A La King, Rice, Buttered Corn, Hot Rolls, Pineapple Tidbits, Milk

Thursday, Sept. 28

Spud Day, Chili & Cheese, Fruit Cocktail, Carrots, Crackers, Milk

Friday, Sept. 29

Lionfingers w/ Gravy, Sliced Potatoes, Green Beans, Sliced Bread, Pears, Milk



TIME comes and
TIME goes
Where it
stops...only the
Good Lord knows
One thing is for
sure and
EVERYONE
now knows
Audrey Dee is 4-0
OOOOH NO!

Homecoming '95

October 6

Don't forget to order your
mums and garters early!

We offer designer mums or
design your own.

Mums starting at \$10.00

Garters starting at \$5.00

For your convenience we will be open
late September 26, 27, & 28.

The Flower Sak

Rhonda Hood

Robert Lee

Judy Blair

453-2036

We now accept Visa & MasterCard



Robert Lee
State Bank

Member FDIC

ROBERT LEE STEERS FOOTBALL

1995 RLHS Football Schedule

DATE	OPPONENT	SITE	TIME	SCORE	
Sept. 8	Miles	Here	8:00	21	0
Sept. 15	Santa Anna	There	8:00	38	0
Sept. 22	Open				
Sept. 29	Roby	There	8:00		
**Oct. 6	Cross Plains	Here	8:00		
*Oct. 13	Bronte	Here	7:30		
*Oct. 20	Garden City	Here	7:30		
*Oct. 27	Water Valley	There	7:30		
*Nov. 3	Roscoe	Here	7:30		
*Nov. 10	Sterling City	There	7:30		

**Homecoming
*District

Friday, September 22
OPEN

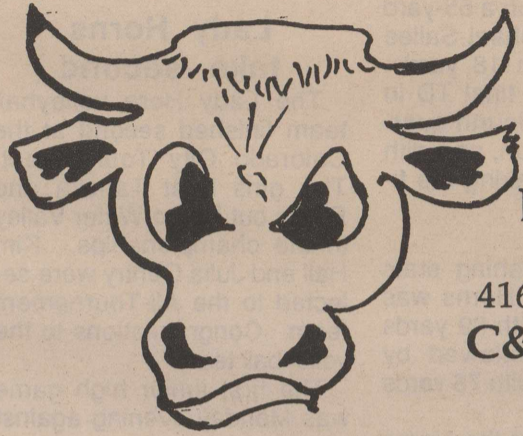

Shaffer Monument Company
Robert Lee-Silver Lions Club
Skinner's Gro. & Station
Jim & Geanette Skinner
Askins Propane Company & Coke Co. Feed & Supply
Charlie, Raynelle, Foy, Estelle & Rhonda Askins
W.E.B. Construction
Edwin, Wyndell & Family
Coke County Judge
Jackie Walker & Rosa Long
Ernest Clendennen, Inc.
Oilfield Services & Storage Rental & Sales
Silver, TX
The Flower Sak
Rhonda Hood & Judy Blair
PCR Feed Lot
Waldon & Judy Millican
J&B Lumber & Hardware
Richard & Suzann Johnson
West Coke County Community Development
Bell Auto Parts & Body Shop
Jim & Beverly Bell
Ranchland Restaurant
Robert Lee State Bank
Member FDIC

Arthur & Arthur
Attorneys at Law
Lane & Nancy Arthur

Bob Wrinkle's Ace Hardware
416 Commerce - Robert Lee
C&W One Stop #14 & Piccadilly Pizza
S&S Printing & Supply
Bruce & Fran Sonnenberg
The Carousel Fashions & Gifts
Becky & Leigh Ann
Wackenhut Corporation
Supports the Steers
Sunshine Gardens & Big Boys Toys
Laura Crenshaw
Joan Davis
Key Feed Store
Chris & Nancy Wyatt
Cracker Barrel Restaurant
Paul & Joan Burns
Tim & Pam Millican
The Best Connection
The Wayland Drennans
Coke County Pharmacy
Steve & Wanda Oleksiuk
Butane Sales Company
Doug & Grace Ditmore
Super "H" IGA
Dave & Betty Hughes

Handwritten signatures and names including: Terrod, Will Simpson, Coach Paehls, Coach Bolding, Coach Randolph, Coach McCown, Coach Cooke, Eric Day, Celda, Jeremy Burns, Bobby Long, Harley Wagner, David Millican, Jerry Howell, Aara, Adam, Morgan, Jon, Marv, etc.

BRONTE SCHOOL NEWS

Longhorns annihilate Miles Bulldogs

The Bronte Longhorns kept their record spotless Friday night, as they put away the Miles Bulldogs, 31-6. Once again the Longhorns looked good on both sides of the ball, as they rolled up another 400 plus yards of total offense while limiting the Dogs to 68 passing yards and less than two yards per carry rushing.

All this was accomplished after being down on the scoreboard for a short time in the second quarter. The Horns struck first in the opening period with a 20-yard Kale Beck field goal. Miles came back early in the second quarter with a 28-yard pass for a TD. The failed extra point made the score 6-3 in favor of the Dogs.

The Horn offense grabbed the lead for good just before the half with a 1-yard run by

Beck, and with the PAT, the score was 10-6 going into intermission.

The Horn offense struck twice in the third quarter, with Keith Treadaway on a 55-yard scamper, and Michael Sallee running it in from 18 yards. Sallee added the final TD in the middle of the fourth quarter with a 6-yard run, and with the point after, making the final score 31-6.

Leading the rushing stats this week for the Horns was Russel Vaughn with 89 yards on 12 carries, followed by Keith Treadaway with 76 yards on 5 rushes.

This Friday night the Horns will find out how good they really are as they host the tough Roby Lions. With Robert Lee having an open

date this week, their fans as well as the loyal homefolks are invited to come out this Friday night and support the Longhorns as they try to make it 3-in-a-row.

Lady Horns take second

The Lady Horn volleyball team finished second at the Colorado City Tournament. The girls beat Tahoka and Plains but lost to Water Valley in the championships. Kim Hall and Julia Gentry were selected to the All-Tournament team. Congratulations to the volleyball team.

The first junior high game was Monday evening against Santa Anna, and the Lady Longhorns took on Snyder Tuesday at 5:00.

Br. PTA meeting highlights

The Bronte PTA met September 5th in the school auditorium. The meeting was called to order by president Donna Poehls at 7:05 pm.

David Rawlings voiced a prayer.

Officers were introduced: Donna Poehls-president; Lisa Dyess - vice president; Terri Rawls - treasurer; Susan Graves - secretary; Angie Basquez - reporter; Angie Hoyt - membership officer; Kary Rawlings, Traci Rosenquist, and Karla Clark - refreshment committee.

The treasurer's report was given by Terri. A profit of \$333.89 was made on the school supplies. Current balance is \$636.55.

Possible fundraisers were discussed.

Possible ways to spend the PTA money were discussed. Mrs. Poehls stated that PTA money is usually spent on projects that benefit the school children. One idea was to purchase a marquee type sign to display upcoming school events. Purchasing computer software programs

Br. Elementary has perfect attendance again

Bronte Elementary has done it again! We had perfect attendance for the third time on September 5, 1995. We would like to salute parents and students for this accomplishment. This would not be possible without your help. Every time we have perfect attendance, we are adding a banner to our bulletin board. We now have three banners up for August 24, August 25, and now September 5.

FCE Meeting held

The Bronte FCE Club meeting was held Friday, September 15, 1995 in the home of Marie Arrott, hostess. Opening exercise "More & More" was read. Four members answered roll call "a first aid tip". Program "How Safe Is Your Home?" was given by agent Jan Yanez. Members present were, Virginia Boatright, Annie Laura McShane, Juanita Bradley, and Marie Arrott. A club trip will be held for the October meeting.

GLENN-BIVINS INSURANCE
 Home, Auto, Life, and Health
 123 W. Main Bronte 473-6791

River of Life Church
 invites you to experience the ministry of:
Peggy Cole
 Wed., Sept. 27 - 7:00 pm
 Texas Theatre - Bronte, TX
Peggy's love for the youth is exemplified in her gentle spirit and anointed teaching. Called to a personal prophetic ministry, she allows the Glory of the Lord to be revealed in the earthly realm.
Come and join us!
 For more information call Pastor Eddie Sparks (915) 473-5901

was also discussed. Sending one teacher from grades k-3rd on a guided tour to a rain forest in Costa Rica to receive hands-on experience for the upcoming Rain Forest theme was also discussed. Mrs. Poehls asked for any more ideas to be turned in to any PTA officer. No action was taken on any of these items.

PTA meetings will be held every other month.

Mr. Terry Myers, principal of Bronte Elementary, was introduced and addressed the audience. He discussed the elementary campus's exemplary rating due to TAAS scores and applauded the students, staff, parents, and community members for the efforts to achieve this rating. Next, he stated the elementary school's attendance thus far is 98%. Mr. Myers introduced administrators, faculty, and board members that were present for the meeting.

Mrs. Poehls discussed Reye's Syndrome with the audience. If your child is suspected of having any type of viral infection, do not give him/her aspirin or aspirin products.

Shorthorns roster released

A good group of Shorthorns will be representing Bronte Junior High this football season. The Shorthorn roster for the 1995 football season is as follows: Jerrod McClure, Brandon Gibbs, Sam Sanchez, Mario Minjarez, Tim Green, Josh Butts, Josh Schoenfield, Zeb Speary, Shaylon Arrott, Andy Blair, Ryan McCorkle, Randy Johnson, Jeremy Silva, Kerry Nance, Blake McKee, Chris Hamm, Justin Herold, Henry White, Justin DeLaCerde, Mark Newman, Jake Graves, Jesse McClure, Anthony Jackson, George Tomes, Jeff Reed, Anthony Gibbs, Harley Hall, Chris Kenny, and Eric Johnson.

The coaches who will be leading the Shorthorns are Rocky Rawls and Russ Peterson.

Cheering the Shorthorns on to victory are the cheerleaders: LeAnn Walker, Cindy Rhodes, Lennie England, Michaela Arrott, Brooke McCutchen, and Jade Richards. Their sponsor is Nancy Jackson.

We are looking forward to a season of success for the Shorthorns. Go guys!!

Br. Class of '96 hosts lunch buffet

The Bronte High School Class of '96 will be serving a Bunch-of-Lunch Buffet Monday, Sept. 25, from 11:00 am until 1:00 pm at the First Baptist Church Fellowship Hall.

The meal will feature salads, meats, vegetables, casseroles, desserts, and breads. There will be no charge for the meal, but donations may be made to the class's "Project Graduation" weekend plans this coming spring.

Project Graduation is a drug and alcohol free activity planned each year for seniors. Come on over for lunch Monday for this worthy cause!

Alcohol/drug abuse help available

A. B. Smith, outreach coordinator for the Mesquite Country Council on Alcohol and Drug Abuse, is in Robert Lee on a regular basis. He is in the conference room at the county courthouse each Friday, 1:00-5:00 pm. There are no charges for his services with alcoholics and their families. An open AA meeting is held at the courthouse every Friday at 7:00 pm. Families are welcome.

For more information, please call 1-800-588-3967 or 453-4680 locally.



Breakfast

- Monday, Sept. 25**
Cereal, Biscuit, Grape Juice, Milk
- Tuesday, Sept. 26**
Breakfast Burrito, Orange Juice, Milk
- Wednesday, Sept. 27**
Sausage, Pancakes, Apple Juice, Milk
- Thursday, Sept. 28**
French Toast, Mixed Fruit, Milk
- Friday, Sept. 29**
Scrambled Eggs, Waffles, Orange Juice, Milk

Lunch

- Monday, Sept. 25**
Corn Dogs, Tator Tots, Pork & Beans, Green Grapes, Apple-sauce, Milk
- Tuesday, Sept. 26**
Chicken Strips w/ Gravy, Creamed Potatoes, Green Beans, Rolls, Strawberry Jelly, Milk
- Wednesday, Sept. 27**
Tacos w/ Cheese, Spanish Rice, Refried Beans, Lettuce & Tomato, Peach Cobbler, Milk
- Thursday, Sept. 28**
Spaghetti w/ Meat Sauce, Tossed Salad, Buttered Corn, Bread Sticks, Diced Pears, Milk
- Friday, Sept. 29**
Cheeseburger, French Fries, Lettuce, Tomato, Pickle, Ranch Style Beans, Juice Bar, Milk

PARKER PLUMBING
 Residential-Commercial
 All Types Plumbing Repair
 *New Construction
 *Remodeling
 *Fixtures
 *Sewer Service
 Licensed Master Plumber
 473-2131 Bronte

MIKE LONG Auctioneers
AUCTION
 Farm Equipment
 Saturday, September 30, 1995
 Sale Time: 10:00 am
 Located: Rowena, TX - East edge of City at SPIST Hall
- Consignments Welcome -
 For info or to consign please contact: Mike Long (915) 597-0359 or Billy Rollwitz (915) 442-3141
 Note: We are selling a complete line of equipment from 1 area farmer as well as equipment from other farmers, ranchers, and lenders.
 Selling: LOADER: Caterpillar 920 Rubber Tire - TRACTORS: 72 J.D. 4320 D., 75 IH 1066 D. C&A, 67 IH 806 D., 64 IH 706 D. Cab, Moline G1000 L.P., IH 300 Gas, J.D. A.B. 70 (for parts), 89 J.D. AMT 600 5 Wheeler - STRIPPERS: J.D. 283, J.D. 282, IH 91 - (10) Cotton Trailers, 24' & 32' - Big 12 Impl. Trlr. - Bruton 6'x24' G/N Stock Trlr. - Livestock feeders, panels & equip. - (2) Fert. Spreaders - J.D. 520 3 pt. Grain Drill - J.D. 1010 21' Field Cult. - J.D. 8 Row Planter - J.D. 534 10' Dozer Blade - (2) 9 Row Bedders - Cultivators - Mlbd. Plows - Chisel Plows - Krause 21' F.W. Tandem - (2) 14' Tandem Disc - Post Hole Diggers - Marsh 10'x20' Stock Scales - 150 Jts. 3" & 4" Irr. Pipe - (2) Lake Pumps - 2 & 4 Row Planters - Round Bale Buggies - 1000 Gal. Water Wagon - Honda 3 Wheeler - Shredders - Lots of new tools - Much More
 For a complete brochure call:
Mike Long Auctioneers (6867)
 (915) 597-0359

BRONTE LONGHORNS FOOTBALL

Bronte Longhorn Football Schedule

DATE	OPPONENT	SITE	TIME	SCORE
Sept. 8	Cross Plains	Here	8:00	35 13
Sept. 15	Miles	There	8:00	31 6
Sept. 22	Roby	Here	8:00	
Sept. 29	Santa Anna	There	8:00	
**Oct. 6	Menard	Here	8:00	
*Oct. 13	Robert Lee	There	7:30	
*Oct. 20	Roscoe	Here	7:30	
*Oct. 27	Garden City	There	7:30	
*Nov. 3	Sterling City	Here	7:30	
*Nov. 10	Water Valley	There	7:30	

**Homecoming
*District

Friday, September 22
8:00 pm HERE

**BRONTE
LONGHORNS**
vs.
Roby Lions



**Texas Best De-flooding &
Carpet Cleaning**

Bob & Patti Frazee

S&S Printing & Supply

Bruce & Fran Sonnenberg

**Bronte Chamber of
Commerce**

James & Brenda Tidwell

Billy Joe & Diane Lockett

Shaffer Monument Company

Margaret's Flowers & Gifts

Eddie & Earlene Alexander

Hurley Pharmacy

Hope you have a winning season!

Glenn-Bivins Insurance Co.

Marilyn, Garry, Shalon & Mary

Wackenhut Corrections

We Support The Longhorns

All American Security

James & Katy Chambers - Tennyson

Joni Lyn Sportswear

Cheering The Longhorns

Hometown Hardware

Feed & Supply - ACCO & Alderman Cave Feeds

D's Total E. Clipse

Donna Hall - Donna Scott

Jim & Jessie Lammers

Lone Star Maintenance

Danny & Roenna

Key Feed Store

Ranchland Restaurant

Bell Auto Parts

& Body Shop

Jim & Beverly Bell

Butane Sales Company

Doug & Grace Ditmore

Bob Wrinkle's

Ace Hardware

416 Commerce - Robert Lee

Coke County Judge

Jackie Walker & Rosa Long

Askins Propane Co. &

Coke Co. Feed & Supply

Charlie, Raynelle, Foy, Estelle & Rhonda Askins

Hall's Super Save Foods

Red Barn Barbecue

First National Bank

in Bronte

Member FDIC

Kenneth's Kuts

We do it right.

BHS FOOTBALL

GO HORNS!

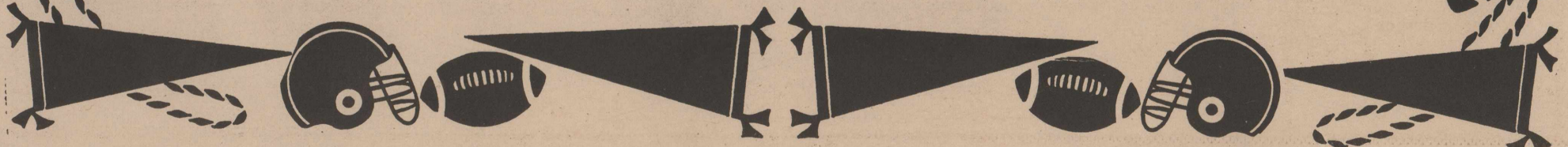

Counselor's Comments
by Vicky McCutchen

Random acts of kindness

One of the most valuable and rewarding tasks in life is to teach our children. And in that process of teaching them we learn again some simple truths about ourselves. Kindness is a powerful word and the connection that links us all together. It strengthens the bonds within our communi-

ties, schools, neighborhoods, and families.

Simple acts of kindness come very natural to children. From sharing a cookie that has had a bite taken out of it, or a wildflower picked from the pasture, the sharing of toys, the compassion shown to a playmate who has suffered an injury--all of these acts of kindness flow effortlessly and honestly from children. Chil-

dren know that we are all a part of a large community. They are innocent and dependent upon others, which leads them instinctively to this knowledge.

Our world nowadays seems fearful because of the continuous violence that rages across it. Our children face these fears, and their innocent and dependent qualities must be nurtured, respected, and appreciated. We sometimes want to hide from our world and compress our connection with it. We often will suppress the innocent beauty

of our children's sense of kindness by trying to protect them. Are we justified by this action?

The tragic result is fewer connections with others, a lost sense of community, and less hope. Children should not be stripped of their spontaneous enthusiasm for showing kindness. It would be a great disservice to them and to the people whose hearts they touch. All humanity will suffer.

Making kindness a regular part of our lives is the greatest step we can take in life, and a book entitled "Kids' Random Acts of Kindness" allows chil-

dren to do just that. I will be using this book this year to help spread "random acts of kindness." As a first grader put his version of a random act of kindness: "I let Ben cut me to the water fountain."



TRASHAWAY SERVICES INC.
ROUTE SCHEDULE for
ROBERT LEE, TX

* Because of state regulations, we can not accept any liquids, oil filters or batteries. Unauthorized materials will not be picked up and will be the responsibility of the customer to dispose of correctly.

* All rollout carts or trash cans need to be placed next to curb along the streets with the arrows.

* Residents of corner houses need to place rollout carts or trash cans next to curb along the streets with the arrows.

▶ - All streets with these arrows will be serviced on Friday.
▶ - All streets with these arrows will be serviced on Tuesday.
All commercial businesses will be serviced on Tuesdays.
Commercial businesses can have an additional pickup on Friday for an additional charge.

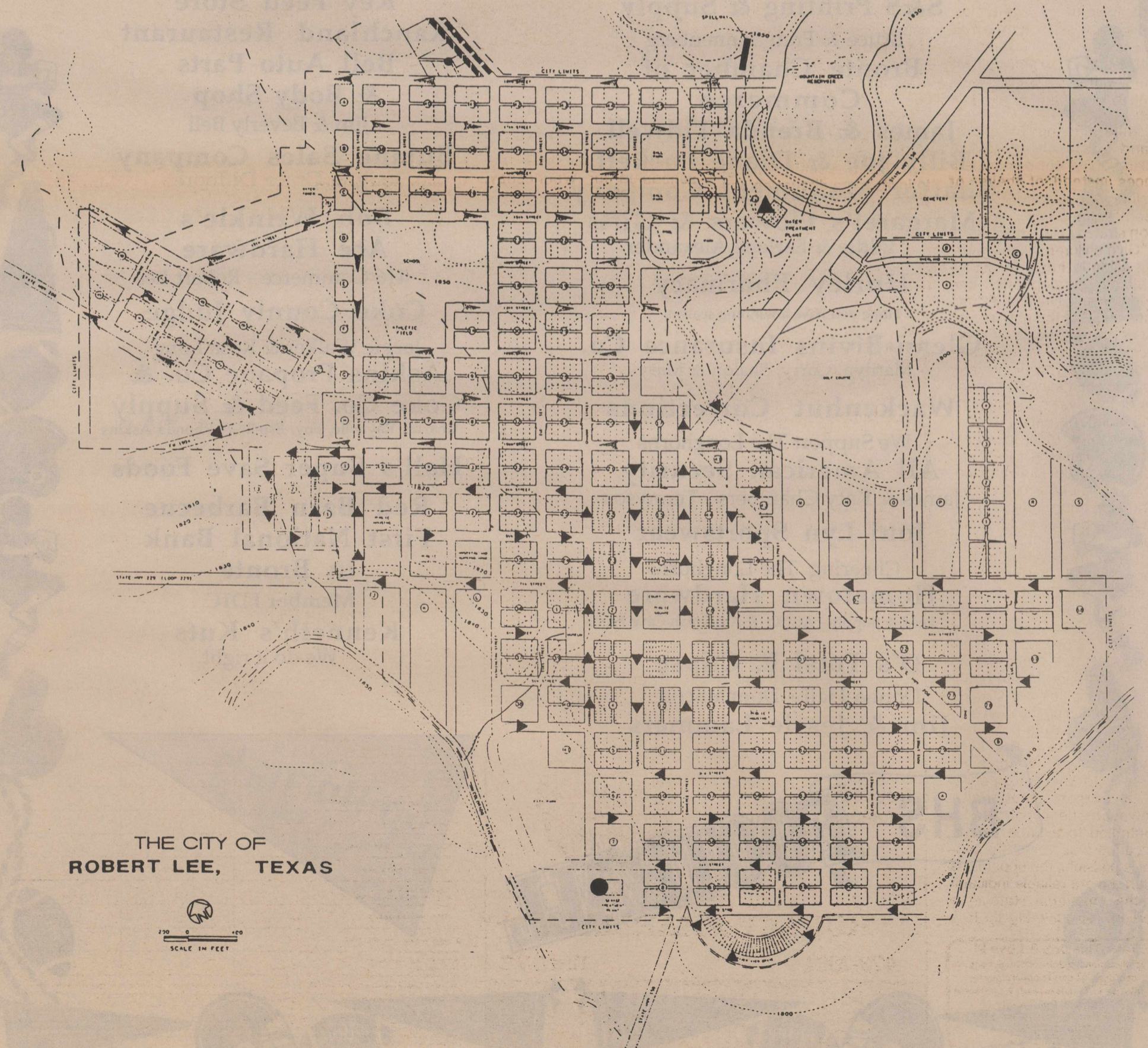

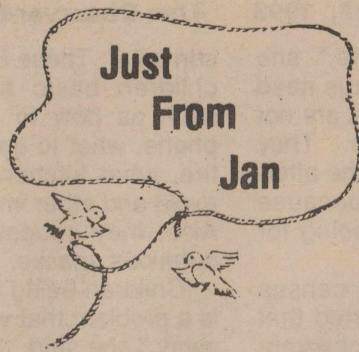

by Jan Yanez
Coke County
Ext. Agent

Listening skills foster Parent-Child relationship

Real listening is one of the highest forms of human influence. It is a learned art, and requires an inner sensitivity that goes beyond words to the feelings and real meanings of what is said. By truly listening, we are saying to our children, "You are a person of worth; I love you, respect you and want to understand you." Unfortunately, we are often so eager to get our point across that we don't pay enough attention to what is being said. The goal of listening is simply to hear, understand and accept the other person's feelings and views. Parents need to set aside their lectures and opinions and really strive to understand from the point of view of their children. It is almost impossible to train children to speak openly, honestly, and constructively of their innermost feelings, wishes and needs unless they have acquired the faith that such expression will meet with acceptance rather than with coolness or rejection.

While striving to understand, avoid giving advice, talking about our own experiences instead of theirs, or making the child's concern seem unimportant. A common strategy is the following:

*Give children full attention. Put aside lectures, reactions, feelings, perceptions, and judgments. Eliminate distractions such as the newspaper, TV or radio. Parents must put themselves in their children's shoes and try with all their heart to see the world through his or her eyes. The attitude and spirit parents adopt is probably the most important aspect of listening. They can go through the outward motions of listening but do not hear anything unless they have the proper attitude and spirit.

*Physically, parents can show children that they have their full attention by leaning toward and looking at the child to show involvement and concern. Emotions are often communicated through the eyes, and parents can better understand their child's feelings by watching their eyes.

*Pay attention to nonverbal communication. The eyes and the upper lip give us clues as to what is happening to a person emotionally. However, the eyes can be controlled to a large extent. Because less voluntary control is possible, the upper lip is often a more reliable indicator of the emotional state of a person. A quivering lip is a

pretty good indicator that a person is upset. If the lip is straight and slightly tight, a person is probably stressed. If it is relaxed and moves easily, emotions are usually less intense.

Acknowledge the child's feelings. Sometimes we don't really want to deny our children's feelings by trying to get them to see or feel the way we do. As Haim Ginnett said, "Many people have been educated out of knowing what their feelings are." Parents need to acknowledge and respect a child's feelings and views.

For example, a child may return from school and say "The bus driver yelled at me and everybody laughed!" A parent might skirt the feeling and instead ask, "What did you do to make the bus driver so upset?" A better response might be: "That must have been embarrassing for you," or "Sounds as if that was embarrassing." After acknowledging the feeling, then the parent can help the child come up with solutions to avoid future conflicts with the bus driver.

Invite more discussion. Sometimes acknowledging a child with a simple "Oh...Mmm...I see" is enough to invite more discussion and, when coupled with a caring attitude, invites children to explore their own thoughts and feelings and possibly come up with their own solutions.

Education is what you get from reading the small print. Experience is what you get from not reading it.

-Carl Albert

Longhorn yearbook staff announces pictures

School pictures will be taken on Monday, October 2, 1995. Due to all the problems with the photographers last year, we have changed companies. The company this year is Hennington Photography, who works out of Josten's and comes highly recommended by several schools in the area.

You will be provided a proof of this year's school pictures and can then place your order. Money in advance is not required for these.

Sports pictures will be also taken October 2. Packages for ordering these pictures should be available next week. These packages do need to be paid for in advance. Pictures taken will be high school and junior high volleyball and football, all teams and individuals. More information on these packages will be available as soon as it is received from Hennington's.

Organization pictures will be taken on October 2 as well. It is not certain yet whether copies of these pictures will be available through Hennington's, but sponsors will be advised as soon as this information is available.

Schedule: School Portraits - 8:00 to 12:00 noon, beginning with elementary; Organizations - 12:45 to 1:30; Sports - 1:45 to 2:45 (Jr. High volleyball and football); 2:45 to 3:40 (High School volleyball and football)

Senior portraits are scheduled for Wednesday, October 25. If you are a senior, you will be receiving information about this from Hennington Photography. The senior group portrait will also be taken on this day. Please notify the yearbook staff of where you wish to have this photo done no later than two weeks prior to that date in order to schedule a bus if necessary.

Lyme Disease demands attention

Early signs of canine Lyme disease usually include lameness or limping, typically without any visible swelling. Some animals experience fever and loss of appetite. What makes detection tricky, however, is that these early warning signs may appear anywhere from one week to six months after infection. That's why you should have your pet examined and treated as quickly as possible. Lyme disease can only be diagnosed through a blood test performed by a veterinarian and analyzed by a professional health lab.

Initially it was thought Lyme disease was transmitted only by deer ticks. We now believe many other insects, such as fleas and mosquitoes, might also transmit the disease. Some research even indicates that Lyme disease can be spread directly from dog to dog without any insect involvement. In fact, warm-blooded animals in every area of the country - including pets who stay indoors - are at risk. Lyme disease can cause paralysis, seizures, and even death.

As with any disease, the best solution is to avoid it altogether. Fortunately, a successful Lyme vaccine is now available for dogs, so the best protection is to have your dog inoculated every year. In northern Wisconsin Lyme



Birthday honorees this month at the Bronte Nursing Home were: Leola Hughes (pictured above), Lola Whittenton, and Permella Reed. The First Baptist WMU ladies sponsored the party. Dora Galloway, Zada Denman, and Marie Smith provided entertainment.

disease is prevalent, but thanks to the vaccine, 75 percent fewer cases have been reported. It also has been shown that the vaccine actually helps dogs in the early stages of infection.

Ask your veterinarian about other preventatives for Lyme disease, such as insecticides, repellents, and collars, especially those formulated for ticks. Some long-lasting flea and tick solutions are rapidly replacing messy, foul-smelling dips.

For the most complete protection, you should also treat your pet's surroundings with lawn and household flea and tick sprays.

UNITED STATES POSTAL SERVICE™ Statement of Ownership, Management, and Circulation (Required by 39 U.S.C. 3685)

1. Publication Title The OBSERVER/ENTERPRISE	2. Publication No. 4 6 7 - 4 8 0	3. Filing Date 9/15/95
4. Issue Frequency weekly except Christmas	5. No. of Issues Published Annually 51	6. Annual Subscription Price \$15/\$17/\$20
7. Complete Mailing Address of Known Office of Publication (Street, City, County, State, and ZIP+4) (Not Printer) 707 Austin PO Box 1329 Robert Lee Coke County, Texas 76945-1329		
8. Complete Mailing Address of Headquarters or General Business Office of Publisher (Not Printer) (same as above)		
9. Full Names and Complete Mailing Addresses of Publisher, Editor, and Managing Editor (Do Not Leave Blank)		
Publisher (Name and Complete Mailing Address) Harold R. Spain, Jr. (same address as above)		
Editor (Name and Complete Mailing Address) (same as above)		
Managing Editor (Name and Complete Mailing Address) (same as above)		
10. Owner (If owned by a corporation, its name and address must be stated and also immediately thereafter the names and addresses of stockholders owning or holding 1 percent or more of the total amount of stock. If not owned by a corporation, the names and addresses of the individual owners must be given. If owned by a partnership or other unincorporated firm, its name and address as well as that of each individual must be given. If the publication is published by a nonprofit organization, its name and address must be stated.) (Do Not Leave Blank.)		
Full Name Complete Mailing Address		
Harold R. Spain, Jr. PO Box 1329 Robert Lee, TX 76945		
11. Known Bondholders, Mortgagees, and Other Security Holders Owning or Holding 1 Percent or More of Total Amount of Bonds, Mortgages, or Other Securities. If none, check here. <input type="checkbox"/> None		
Full Name Complete Mailing Address		
Connie Bozarth 2545 W. Twohig San Angelo, TX 76901		
Cynthia Ann Stuart 1324 Rich Lane Mt. Zion, IL 62549		
13. Publication Name The OBSERVER/ENTERPRISE	14. Issue Date for Circulation Data Below 9/15/95	
15. Extent and Nature of Circulation	Average No. Copies Each Issue During Preceding 12 Months	Actual No. Copies of Single Issue Published Nearest to Filing Date
a. Total No. Copies (Net Press Run)	2000	2000
b. Paid and/or Requested Circulation (1) Sales Through Dealers and Carriers, Street Vendors, and Counter Sales (Not Mailed) (2) Paid or Requested Mail Subscriptions (Include Advertisers' Proof Copies/Exchange Copies)	585	630
c. Total Paid and/or Requested Circulation (Sum of 15b(1) and 15b(2))	981	985
d. Free Distribution by Mail (Samples, Complimentary, and Other Free)	10	10
e. Free Distribution Outside the Mail (Carriers or Other Means)	35	46
f. Total Free Distribution (Sum of 15d and 15e)	45	56
g. Total Distribution (Sum of 15f and 15c)	1611	1671
h. Copies Not Distributed (1) Office Use, Leftovers, Spoiled (2) Return from News Agents	361	290
i. Total (Sum of 15g, 15h(1), and 15h(2))	2000	2000
Percent Paid and/or Requested Circulation (15c / 15i x 100)	97	97
16. This Statement of Ownership will be printed in the 9/22/95 issue of this publication. <input type="checkbox"/> Check box if not required to publish.		
17. Signature and Title of Editor, Publisher, Business Manager, or Owner Date Harold Spain Owner/Publisher 9/15/95		

I certify that all information furnished on this form is true and complete. I understand that anyone who furnishes false or misleading information on this form or who omits material or information requested on the form may be subject to criminal sanctions (including fines and imprisonment) and/or civil sanctions (including multiple damages and civil penalties).

El Rancharo Restaurant
Mexican-American Food
Open Tues.-Sat. 11 am - 2 pm & 5-9 pm
CLOSED SUNDAY
224 W. Main Bronte 473-2140

At High Noon on Wednesday, September 20, your community pharmacy took part in a national day of protest against unfair health insurance practices that are undermining the quality of your pharmacy care.

Support your community pharmacy.

They can't stop us from caring for you!

HURLEY PHARMACY
473-2351 BRONTE
DEMAND QUALITY PHARMACY CARE

Take This Job & Love It!
Rapidly expanding telecommunications co. offers terrific career opportunity for aggressive self starters ready for personal freedom. Call Today!
Roy or Carla Evers 915/570-7281
EXCEL

Adolescents still need after-school care

Although the number of after-school care programs in Texas is increasing, there is still a need for programs designed specifically for young

adolescents, according to a family life specialist.

"We have seen a significant increase in the growth of after-school programs, but there is still a need, particularly when you look at pre-adolescents in fifth through seventh grades," said Dr. Sarah Anderson, pro-

gram leader for family development and resource management with the Texas Agricultural Extension Service.

"I still have concern about that young adolescent being alone, because we know from research that a lot can happen

in those three hours," she said. "Children this age need a program where they are not told everything to do. They do not like to stay at the after-school programs, because they view them as being for little kids."

The most recent census data from 1991 reported that more than 2 million children, ages 5-13, care for themselves alone at home some time of the day, while child-care experts believe that number may be three or four times higher. Other national estimates put the number at 15 million. State child-care experts believe more than a million latchkey children live in Texas.

But accurate figures are hard to obtain.

"That's because parents are reluctant to admit that their children spend time at home alone," Anderson said. "They fear being seen unfit parents. So, you get invalid statistics on latchkey children in the state."

After-school care programs have grown since 1990, said Bill Carver of the Texas Department of Human Services' licensing division. But there is no way of knowing how many such programs are available because child care centers are not required to indicate if they offer these services.

The most common type of after-school care program is located on school grounds, he said. After-school programs include those operated by:

1. Schools - offer programs and various activities after school hours. These sometimes involve a collaborative effort with groups such as parks and recreation agencies.
2. Child day care - offers services for school-age children and will send vehicles to pick them up after school.
3. Day home providers - keep young children in the home during the day and older children after school.
4. After-school home provider - only keeps older kids in their homes after school.
5. Community services - churches, civic groups and agencies such as the YMCA have programs for children after school.

Five years ago, Anderson assisted in the development of Project Home Safe, a joint effort between the Texas Agricultural Extension Service and the America Association of Family and Consumer Sciences to help parents of latchkey children find alternative solutions to self care.

The national outreach project trains volunteers to work with coalitions of local leaders to assess needs, identify available resources and develop a plan of action at the local level to solve community problems of children in self care.

The project has helped in the establishment of many after-school programs throughout Texas, Anderson said. Educational manuals also help parents choose the appropriate after-school care program, tell how to set up a program and provide enough lesson plans for the entire year.

All kids are alone at some time even when a parent is out mowing the grass, Ander-

son said. These lessons give children basic safety skills such as how to answer the phone, what to do if there's a fire, what kitchen objects to avoid and other important tips. Also, they educate youth on nutritious snacks.

"Children being home alone is a problem that will never go away," she said. "In addition, programs are not yet meeting low-income parents' needs. For the working poor, it's hard."

Some parents have after-school jobs, while others just cannot afford the cost, she added. Costs can range from \$65 to \$125, depending on the care service and whether it is for nonprofit.

"Today, we are more aware of child care and dependent care but still have a way to go," Anderson said. "I feel good about the program development and those available. We have addressed the problem, but I would not want to imply that the problem has been solved."

Beat the heat!

Do you have a room in your home that is difficult to cool in the summer (or warm in the winter)? Are you constantly adjusting your thermostat to correct that one problem room only to have higher utility bills and uneven room temperatures? If you do, you're not alone. In fact, most home owners using a forced air conditioning or air heating system report at least one room that is too hot in the summer (or too cold in the winter).

Due to bends in your duct system, or a register's long distance from the blower, some rooms simply do not receive proper register airflow. As a result, the room is difficult to keep comfortable no matter how often you adjust your thermostat.

Suncourt, Inc.'s Equalizer EQ2 Room Heating and Air Conditioning Booster pulls additional airflow from poorly performing registers . . . simultaneously increasing room comfort and decreasing high utility bills!

Placed over a 12 inch by 6 inch (or smaller) floor or wall register and plugged into a standard 110 volt outlet, the Equalizer draws air twice as fast through the duct systems every time the cooling or heating system functions. Because the air spends less time reaching the problem room, the air temperature is significantly improved.

This innovative register booster functions on and off automatically at the temperature that you select and operates for less than 3 cents a day, compared to dollars a day using other supplementary cooling and heating techniques.

The Equalizer EQ2 is self-contained, requires no installation and, because it uses no heating elements or coils, is absolutely safe.

For more information, call 800-999-3267 or write: Suncourt, Inc., 102 Fifth Street, P.O. Box 40, Durant, Iowa 52747.

We don't understand life any better at forty than at twenty, but we know it and admit it.

Jules Renard

IMPORTANT NOTICE OF PROPOSED SETTLEMENT OF CLASS ACTION AND FAIRNESS HEARING

IN THE UNITED STATES DISTRICT COURT FOR THE SOUTHERN DISTRICT OF ALABAMA SOUTHERN DIVISION

Jack H. Woodward, et al. vs. NOR-AM Chemical Company
No. 94-0780-CB-C

U.S. WORKERS WITH ON-THE-JOB EXPOSURE TO FUNDAL®

and Their Spouses, Children, Other Relatives and Legal Representatives and PRICE v. CIBA-GEIGY, Civ. No. 94-0647-CB-S (S.D. Ala. 1995), SETTLEMENT CLASS MEMBERS

FUNDAL® WAS A COMMERCIAL AGRICULTURAL PESTICIDE WHICH WAS MARKETED IN THE U.S. BY NOR-AM CHEMICAL COMPANY. FUNDAL® WAS NOT MARKETED FOR RESIDENTIAL OR HOME GARDENING USE.

U.S. WORKERS WITH ON-THE-JOB EXPOSURE TO FUNDAL® MAY BE ELIGIBLE FOR FREE MEDICAL MONITORING AND/OR CASH PAYMENTS UNDER THIS PROPOSED LEGAL SETTLEMENT.

PRICE SETTLEMENT CLASS MEMBERS ARE ALL U.S. WORKERS WITH ON-THE-JOB EXPOSURE TO GALECRON® (INCLUDING GALECRON® AND FUNDAL®) WHO DID NOT EXCLUDE THEMSELVES FROM THE PRICE SETTLEMENT. PRICE SETTLEMENT CLASS MEMBERS MAY BE ELIGIBLE FOR CASH SUPPLEMENTS UNDER THIS PROPOSED LEGAL SETTLEMENT.

PLEASE READ THIS NOTICE CAREFULLY. YOU MAY BELONG TO A CLASS OF PEOPLE COVERED BY A PROPOSED SETTLEMENT OF A LEGAL ACTION ("WOODWARD SETTLEMENT"). THE WOODWARD SETTLEMENT MAY AFFECT YOUR LEGAL RIGHTS. FOR MORE INFORMATION CALL 1-800-211-6913

By Order of the Court, a class action has been conditionally certified for settlement purposes. On January 9, 1996, a fairness hearing will be held at the Courthouse, United States District Court, Southern District of Alabama, 113 St. Joseph Street, Mobile, Alabama, 36602, at 9 a.m. Central Time, so the Court can determine if the class action should be finally certified and if the Woodward Settlement, as summarized in this Notice, should be approved as fair, reasonable and adequate. Although participation in this settlement is voluntary, all Woodward Settlement Class Members who do not timely exclude themselves from the lawsuit will be bound by the Woodward Settlement if it is approved.

I. DEFINITION OF CLASS

Under the Woodward Settlement, Fundal® is defined as chlordimeform or any chlordimeform-containing product, either manufactured, formulated, packaged, distributed or sold by or on behalf of NOR-AM Chemical Company ("NOR-AM") or related parties, regardless of the trade name of the product; or any metabolite of Fundal®, including the substances known as 4-COT or 5-CAT. Galecron® has the same meaning as it did in the Price v. Ciba-Geigy Corp., Civ. No. 94-0647-CB-S (S.D. Ala. 1995), Settlement ("Price Settlement"), and is thus defined as chlordimeform or any chlordimeform-containing product, either manufactured, formulated, packaged, distributed or sold by or on behalf of Ciba-Geigy Corporation or related parties, regardless of the trade name of the product; or any metabolite of Galecron®, including the substances known as 4-COT or 5-CAT.

The Woodward Settlement Class is defined as:

- (1) All persons who fall into one of the following categories, and who reside in the United States as of the date of filing of the Class Action Complaint, who have been exposed in the United States to Fundal® only, but not to Fundal® and Galecron® or to Galecron® only ("NOR-AM Exposed Persons"):
 - a. **Formulators:** An individual (whether or not employed by NOR-AM Chemical Company) who in the course of his or her employment was exposed to Fundal® while at a plant or site which was involved in mixing, blending, packaging, handling or otherwise formulating pesticides which contained, in whole or in part, Fundal®;
 - b. **Applicators:** An individual (whether or not employed by NOR-AM Chemical Company) who in the course of his or her employment, was exposed to Fundal® while involved in the application of pesticides which contained, in whole or in part, Fundal®, including, without limitation, aerial and land applicators, flagmen, mixers, blenders, loaders and other individuals who handled such pesticide prior to or during the application process; or
 - c. **Other Covered Workers:** (i) An individual employed by NOR-AM Chemical Company who, in the course of his or her employment, was exposed to Fundal®; (ii) an individual who worked at Empak, Inc. in Deer Park, Texas and/or Micro Chemical in Louisiana and who was exposed to Fundal® in the course of his or her employment; (iii) an individual who worked in a testing or research laboratory and who was exposed to Fundal® in the course of his or her employment; or
- (2) The spouses, parents, children, other relatives, or legal representatives of the NOR-AM Exposed Persons described above.
- (3) All members of the Price Settlement Class. The Price Settlement Class means all members of the settlement class certified by the court in Price v. Ciba-Geigy Corp., Civ. No. 94-0647-CB-S (S.D. Ala. 1995), excluding persons determined by the court to be opt-outs of that class. That settlement class thus includes persons residing in the United States who in the course of their employment were exposed to Galecron® or to Galecron® and Fundal® ("Ciba Exposed Persons"); and the spouses, parents, children, other relatives, or legal representatives of the Ciba Exposed Persons described above.

(Collectively "Woodward Settlement Class Members"). Note: If you are an NOR-AM Exposed Person or a Ciba Exposed Person, you are a Woodward Settlement Class Member whether or not you have been diagnosed with an illness. Spouses, parents, children, other relatives, and legal representatives are Woodward Settlement Class Members but the claims they are settling are limited to those arising from a NOR-AM Exposed Person or Ciba Exposed Person's exposure.

II. IMPORTANT MEDICAL NOTICE

To NOR-AM Exposed Persons and Ciba Exposed Persons (as defined above):

You may have an increased risk of developing bladder cancer if you had on-the-job exposure to Fundal® and/or Galecron®. Workers exposed to Fundal® and/or Galecron® should participate in a medical monitoring program because early detection of bladder cancer can result in more effective treatment.

If you had on-the-job exposure to Fundal® and/or Galecron®, it is recommended that you or your doctor call 1-800-211-6913 to learn how you can obtain further medical information or enroll in medical monitoring.

III. PROPOSED SETTLEMENT

The Woodward Settlement provides for the establishment by NOR-AM of two funds to provide medical benefits and compensation to eligible Woodward Settlement Class Members or their legal representatives. This settlement is intended, where applicable, to work as a complement to the Price Settlement.

The total package of benefits potentially available to a NOR-AM Exposed Person is the same as the total package of benefits potentially available to a Ciba Exposed Person. Thus, Woodward Settlement Class Members may be eligible for the same benefits whether they were occupationally exposed to Fundal® only, or to Fundal® and Galecron®, or to Galecron® only.

(1) The NOR-AM Medical Monitoring and Treatment Fund ("The NOR-AM MMT Fund")

If the Woodward Settlement is approved, NOR-AM will make an initial deposit of \$3,500,000 into the NOR-AM MMT Fund, and will thereafter make additional deposits on an as-needed basis. There is no limit to the amount of money NOR-AM can be required to contribute over the life of the NOR-AM MMT Fund, which will last a minimum of 20 years.

NOR-AM Exposed Persons will be entitled to participate in the NOR-AM medical monitoring and treatment program; Ciba Exposed Persons may receive medical monitoring and treatment benefits only through the Price Settlement. The NOR-AM medical monitoring and treatment program and the medical monitoring and treatment program provided through the Price Settlement are identical. The NOR-AM MMT Fund will pay for a medical monitoring program designed to detect at an early stage the form of bladder cancer alleged to be associated with exposure to Fundal®; specifically, primary urothelial carcinoma of the urinary collecting system, i.e., renal pelvis, ureter, bladder and urethra. The NOR-AM MMT Fund will also pay for all medically necessary treatment for NOR-AM Exposed Persons.

(2) The NOR-AM Disease Compensation and Administration Fund ("The NOR-AM DCA Fund")

If the Woodward Settlement is approved, NOR-AM will also make an initial deposit of \$21,000,000 into the NOR-AM DCA Fund, up to a required maximum of \$30,000,000. The NOR-AM DCA Fund will make cash payments of up to \$626,500 on behalf of a NOR-AM Exposed Person who, after exposure to Fundal® only, has developed or in the future develops the form of bladder cancer alleged to be associated with Fundal®. In addition, the NOR-AM DCA Fund will make cash supplements amounting to 40% of the amounts scheduled for and paid as compensatory payments pursuant to the Price settlement, up to \$179,000, on behalf of a Ciba Exposed Person who, after exposure to Fundal® and Galecron® or to Galecron® only, has developed or in the future develops the form of bladder cancer alleged to be associated with Fundal® and Galecron®. The NOR-AM DCA Fund will also pay for administrative costs and class counsel's and administrative class counsel's attorney fees, costs and expenses

as determined by the Court. The total attorney fee award to be requested will not exceed 20% of the benefit conferred upon the class. The benefits of the NOR-AM DCA Fund will continue as long as the NOR-AM MMT Fund continues, or until the NOR-AM DCA Fund is exhausted. If the NOR-AM DCA Fund is exhausted, NOR-AM may continue paying for compensable claims. If NOR-AM does not continue to pay for these compensable claims, Woodward Settlement Class Members will be able to opt-out of the NOR-AM DCA Fund and pursue any legal claims they may have, except for claims for medical monitoring, medical treatment, fear of illness or cancer, or increased risk of illness or cancer.

(3) **Other Conditions.** The Stipulation of Settlement presently provides for medical monitoring, treatment and compensation payments for certain medical conditions set forth in this Notice. In the event, however, that a Court-approved Epidemiology Panel determines to a reasonable medical certainty that any other medical condition is caused by Fundal® or Galecron® exposure, that condition will be deemed a compensable claim, and will be eligible for medical monitoring (if feasible), medical treatment, and cash payments.

(4) **Release.** Woodward Settlement Class Members who do not exclude themselves from the Woodward Settlement Class release all past, present and future claims (i) relating to the covered medical conditions listed above; and (ii) relating to a Woodward Settlement Class Member's exposure to Fundal® or Galecron®, including all claims alleging that any other cancers, personal injuries or risks are caused by exposure to Fundal® or Galecron®.

IV. CLASS REPRESENTATIVES AND CLASS COUNSEL

The Court has designated the following Woodward Settlement Class Members, Jack H. Woodward, Alta Woodward, Tom Lofton, Cindy Lofton and Rita Snow, as class representatives to represent all Woodward Settlement Class Members. The Court has also designated as Class Counsel the following individuals: Timothy E. Eble, S.C. Middlebrooks III, and David R. Donaldson.

V. RIGHTS AND OPTIONS OF WOODWARD SETTLEMENT CLASS MEMBERS

If you are a Woodward Settlement Class Member, you have the following options:

- (1) You may do nothing and remain a Woodward Settlement Class Member. If you choose to take no action, your interests as a member of the Woodward Settlement Class will be represented by the Class Representatives and Class Counsel at no cost to you.
- (2) You may remain a Woodward Settlement Class Member and either represent yourself or hire your own attorney to represent you at your own cost.
- (3) You may remain a Woodward Settlement Class Member and object to the settlement.
- (4) If you choose to remain a Woodward Settlement Class Member (under options 1, 2 or 3 above), you may receive the benefits afforded by this settlement within six months of the Court's Order directing this Notice.
- (5) You may request exclusion from this settlement.

DEADLINES FOR ABOVE OPTIONS. The deadline for filing an Entry of Appearance if you choose to represent yourself or retain an attorney; for filing objections to this settlement; for filing a Notice of Intent to Appear at the fairness hearing; or for filing a request to be excluded from the Woodward Settlement Class is **DECEMBER 1, 1995. TO LEARN MORE INFORMATION ABOUT HOW TO FILE ANY OF THE ABOVE ITEMS, PLEASE CALL 1-800-211-6913 OR WRITE TO: Woodward Class Action, P.O. Box 974, Charleston, SC 29402.**

VI. PROOF OF CLAIM PROCEDURE

In order for any Woodward Settlement Class Member to receive any of the benefits of this settlement, he or she must comply with the proof of claim procedure. To learn how you may receive benefits under this settlement or to obtain a Proof of Claim Form for medical monitoring, medical treatment or disease compensation, call 1-800-211-6913 or write to Woodward Class Action, Post Office Box 974, Charleston, SC 29402.

VII. FOR FURTHER INFORMATION

THIS NOTICE IS ONLY A SUMMARY. If you believe you are a Woodward Settlement Class Member you are urged to call 1-800-211-6913 or write to Woodward Class Action, Post Office Box 974, Charleston, SC 29402 to obtain further information regarding this settlement, how to exclude yourself from the class, and how to obtain benefits. **DO NOT CALL THE CLERK OF COURT** with questions about this Notice or this settlement.

Mobile, Alabama
Dated: August 21, 1995
By Order of the Court
Judge Charles R. Butler, Jr.

REQUEST FOR INFORMATION FORM (This is not an Exclusion Request)

I would like to have more detailed information of the Woodward Settlement mailed to:

PLEASE PRINT LEGIBLY

NAME: _____

ADDRESS: _____

CITY: _____

STATE: _____ ZIP: _____

PHONE _____

(Including area code): _____

Mail this Request for Information to:
Woodward Class Action
Post Office Box 974
Charleston, SC 29402

Bronte OES meeting held

Obligation Night was observed at the meeting of Bronte Chapter #1048, Order of the Eastern Star, on Monday night, September 11, at the Masonic Lodge Hall.

Betty Lee was in charge of the Obligation program. Worthy Matron Ettie Hubbard and Noah Pruitt, Jr., Worthy Patron, presided at the meeting.

Royce Lee presented information about the Masonic Lodge Hall being used for community meetings including county, state, and national

elections, monthly meetings of the Bronte Chamber of Commerce, and for other occasions, in addition to the meetings of Bronte Masonic Lodge and Eastern Star.

Reports were heard from other committee chairpersons.

It was also reported about the renovation of the Capitol Gazebo sponsored by the Sorosis Club and the depot grounds being designated by the helicopter from Shannon Hospital to pick up emergency patients in the area.

Following the meeting, a social hour was hosted by

Betty and Royce Lee and Margaret Martin in the fellowship hall.

Reduce risk of prostate cancer

Men who restrict fat in their diets may lower their risk for prostate cancer.

That's the indication of a six-month study to determine if limiting fat intake to 20 percent of total calories would reduce levels of prostate specific antigen, a blood marker used to indicate the risk for prostate cancer.

"In patients with really elevated PSA, we observed a 10 percent reduction," said Dr. Dov Kadmon, a urologist at Baylor College of Medicine in Houston. "We hoped this study would tell us if there was a downward trend in PSA levels associated with a lower-fat diet. We wanted to know the feasibility of conducting a larger study with a larger reduction of fat intake, perhaps as low as 10 percent."

The average PSA reduction in study subjects was one

point. "That's not a huge amount," Kadmon said, "but it was a measurable drop, and perhaps such drops in PSA levels have a cumulative effect."

Prostate cancer, the major cancer killer in men 50 and older, occurs significantly more often in black men than in white men.

"I think that in prostate cancer it makes all the sense in the world to address prevention rather than treatment and cure," Kadmon said, "because there is worldwide epidemiological evidence that extraneous factors, most likely including diet, make a difference."

Kadmon also suggested that all men 50 and older be screened annually for prostate cancer using a PSA blood test and a digital examination.

Black men and men with a family history of prostate cancer should be screened annually beginning at age 40.

Students meet to pray for school, nation

About sixty-five students and adults, including administration personnel and teachers, gathered at the Robert Lee School flag pole Tuesday, September 20, at 7:00 am.

The event was to celebrate the International Student-led Day of Prayer. The service was led by representatives of each junior high and high school class. Following the ceremony, a breakfast was served for the students at the Robert Lee Baptist Church.

Racing heartbeat may be genetic

A faulty protein may make some people's hearts race, say scientists at Baylor College of Medicine in Houston.

MVP's symptom's include a rapid heart beat, fatigue, lightheadedness, headache, chest pain, anxiety, and nausea. The disease is prevalent in tall, thin individuals, particularly women.

"In our studies, we were able to examine how the adrenaline system works and pinpoint certain proteins that increase heart rates," said Dr. Al Davies, an associate professor of medicine at Baylor.

Chief among them was the "G-protein" that causes MVP patients' hearts to overreact to their own adrenaline and adrenaline-like hormones.

Davies says that a patient with MVP dysautonomia might have 110 heart beats per minute, compared to 70 beats per minute in an otherwise healthy individual.

"The symptoms we observed clearly suggest an abnormality of the make-up of the adrenaline system," said Davies. "We wanted to have a better understanding of how this system works and offer more effective treatment."

Current therapy involves minimizing stressful situations that may trigger the excess adrenaline action, moderate exercise, and salt tablets combined with a hormone to decrease adrenaline flow to the bloodstream. In severe cases, a beta-blocker is also prescribed.

PUBLIC NOTICE
BRIEF EXPLANATORY STATEMENTS
OF PROPOSED
CONSTITUTIONAL AMENDMENTS
SPECIAL ELECTION
NOVEMBER 7, 1995

PROPOSITION NO. 1 ON THE BALLOT

House Joint Resolution 50 proposes a constitutional amendment providing that the legislature by general law may authorize the Texas Higher Education Coordinating Board to issue general obligation bonds of the state in an amount not exceeding \$300 million to finance educational loans to students. The maximum interest rate to be borne by the bonds must be set by law. The legislature may provide for the investment of bond proceeds and may establish an interest and sinking fund to pay the bonds.

The proposed amendment will appear on the ballot as follows:

"The constitutional amendment providing for the issuance of \$300 million in general obligation bonds to finance education loans to students."

PROPOSITION NO. 2 ON THE BALLOT

Senate Joint Resolution 36 proposes a constitutional amendment that would authorize the legislature to exempt from ad valorem taxation the property of an organization chartered by the Congress of the Republic of Texas if the property is used primarily for the charitable, benevolent, or public service activities of the organization as defined by general law. The Comptroller's Property Tax Division has identified the Grand Lodge of Texas, also known as the Masonic Lodges, as the primary organization which would qualify for this tax exemption.

The proposed amendment will appear on the ballot as follows:

"The constitutional amendment to authorize the legislature to exempt from ad valorem taxation property of an organization chartered by the Congress of the Republic of Texas that is used primarily for the charitable, benevolent, or public service activities of the organization."

PROPOSITION NO. 3 ON THE BALLOT

Senate Joint Resolution 51 proposes a constitutional amendment that provides that the farm and ranch finance program fund shall be administered by the Texas Agricultural Finance Authority and not by the Veterans' Land Board, as provided by current law. In addition, the proposed amendment provides that the proceeds of \$200 million of the \$500 million in bonds authorized by the Texas Constitution for the farm and ranch finance program fund may be diverted to the agricultural fund and the rural micro-enterprise development fund, also authorized by the Texas Constitution, to be used for agricultural and rural economic development programs.

The proposed amendment will appear on the ballot as follows:

"The constitutional amendment allowing the use of existing bond authority of the farm and ranch finance program to include financial assistance for the expansion, development, and diversification of production, processing, marketing, and export of Texas agricultural products."

PROPOSITION NO. 4 ON THE BALLOT

Senate Joint Resolution 46 proposes a constitutional amendment that would allow an encumbrance to be fixed on homestead property for an owelty of partition. In divorce and probate situations, a piece of property may be owned jointly by two

or more people, and each person owns an undivided interest in the property, as opposed to a specific portion of the property. If one owner wishes to purchase the other person's interest in the property and wishes to obtain a loan to finance the purchase, the lending institution requires all interests in the property to be used as security for the loan; this is called an owelty of partition. Senate Joint Resolution 46 would allow the lending institution to foreclose on the homestead property for an owelty of partition if the purchaser defaulted on the loan. In addition, the proposed amendment would allow the refinancing of a lien against a homestead. Finally, the proposed amendment would allow a purchaser or lender to rely on an affidavit that states that the property to be conveyed or encumbered is not the homestead of the affiant.

The proposed amendment will appear on the ballot as follows:

"The constitutional amendment permitting an encumbrance to be fixed on homestead property for an owelty of partition, including a debt of a spouse resulting from a division or award of a homestead in a divorce proceeding, and for the refinancing of a lien against a homestead, including a federal tax lien resulting from the tax debt of the owner."

PROPOSITION NO. 5 ON THE BALLOT

House Joint Resolution 34 proposes a constitutional amendment which would increase by \$500 million the constitutional authorization of the Veterans' Land Board to issue and sell general obligation bonds of the state to provide housing financing to Texas veterans. The proceeds from the bonds authorized by this amendment shall be used to augment the Veterans' Housing Assistance Fund II to be administered and invested as provided by law. The bonds authorized by this amendment shall be incontestable after execution by the Veterans' Land Board, approval by the attorney general, and delivery to the purchaser.

The proposed amendment will appear on the ballot as follows:

"The constitutional amendment to increase by \$500 million the amount of general obligation bonds that may be issued to augment the veterans' housing assistance fund II."

PROPOSITION NO. 6 ON THE BALLOT

House Joint Resolution 64 proposes a constitutional amendment which would extend the tax exemption under article VIII, section 1-b(b) of the Texas Constitution for the residence homestead of a person age 65 or older to the surviving spouse of a person who received the exemption. The surviving spouse must be age 55 or older when the deceased spouse died, and the property must be the residence homestead of the surviving spouse when the deceased spouse died and remain the surviving spouse's residence homestead. A surviving spouse who already receives an exemption under this section of the Texas Constitution is not entitled to an additional exemption under the amendment.

The proposed amendment will appear on the ballot as follows:

"The constitutional amendment exempting from ad valorem taxation the residence homestead of the surviving spouse of an elderly person."

PROPOSITION NO. 7 ON THE BALLOT

House Joint Resolution 73 proposes a constitutional amendment that would reduce the amount of general obligation bonds authorized for the superconducting super collider fund from \$500 million to \$250 million.

The proposed amendment will appear on the ballot as follows:

"The constitutional amendment reducing the amount of general obligation bonds authorized for undertakings related to the superconducting super collider research facility from \$500 million to \$250 million."

PROPOSITION NO. 8 ON THE BALLOT

House Joint Resolution 80 proposes a constitutional amendment abolishing the office of constable in Mills, Reagan, and Roberts counties. In Mills County, the office of constable is abolished, and the powers, duties, and records of the office are transferred to the sheriff. In Reagan and Roberts counties, the office of constable is abolished and the powers, duties, and records of the office are transferred to the sheriff only if a majority of voters in each of the respective counties favors the proposed amendment.

The proposed amendment will appear on the ballot as follows:

"The constitutional amendment providing for the abolition of the office of constable in Mills, Reagan, and Roberts counties."

PROPOSITION NO. 9 ON THE BALLOT

Senate Joint Resolution 7 proposes a constitutional amendment that would allow investment of money from the Texas growth fund in a business without the business's disclosure of its investments in or with South Africa or Namibia. Currently, such investments are prohibited by article XVI, section 70(r) of the Texas Constitution, which would be repealed.

The proposed amendment will appear on the ballot as follows:

"The constitutional amendment allowing investment of money from the Texas growth fund in a business without the business's disclosure of its investments in or with South Africa or Namibia."

PROPOSITION NO. 10 ON THE BALLOT

Senate Joint Resolution 1 proposes a constitutional amendment that would abolish the constitutional office of state treasurer effective September 1, 1996. The transfer of specific constitutional powers and duties to the comptroller of public accounts takes effect on that date. The statutory powers and duties and the property and other obligations of the state treasurer are transferred to officers and agencies of state government as the legislature provides by general law.

The proposed amendment will appear on the ballot as follows:

"The constitutional amendment abolishing the office of state treasurer."

PROPOSITION NO. 11 ON THE BALLOT

House Joint Resolution 72 proposes a constitutional amendment requiring that land devoted to wildlife management be taxed on the basis of its productive capacity. The proposed amendment also adds a temporary provision to the Texas Constitution validating the changes to the law made by Chapter 560, Acts of the 72nd Legislature, Regular Session, 1991, which amended the Tax Code to allow land used for wildlife management to be appraised as agricultural land. The temporary provision also provides that a property owner is not authorized to claim a refund of taxes paid unless the tax payment was challenged before the effective date of the proposed amendment. The temporary provision expires on January 1, 1998.

The proposed amendment will appear on the ballot as follows:

"The constitutional amendment to allow open-space land used for wildlife management to qualify for tax appraisal in the same manner as open-space agricultural land, subject to eligibility limitations provided by the legislature."

PROPOSITION NO. 12 ON THE BALLOT

House Joint Resolution 31 proposes a constitutional amendment providing that the legislature may exempt from ad valorem taxation income-producing personal property and mineral interests that have a taxable value which is insufficient to recover the costs of administering the tax.

The proposed amendment will appear on the ballot as follows:

"The constitutional amendment authorizing the legislature to exempt from ad valorem taxation personal property and mineral interests having a value insufficient to recover the administrative costs of collecting the taxes."

PROPOSITION NO. 13 ON THE BALLOT

House Joint Resolution No. 35 proposes a constitutional amendment authorizing the governing body of a political subdivision to exempt from ad valorem taxation boats and other equipment used primarily in the commercial taking or production of fish, shrimp, shellfish, and other marine life.

The proposed amendment will appear on the ballot as follows:

"The constitutional amendment authorizing the governing body of a political subdivision to exempt from ad valorem taxation boats and other equipment used primarily in the commercial taking or production of fish, shrimp, shellfish, and other marine life."

PROPOSITION NO. 14 ON THE BALLOT

House Joint Resolution 68 proposes a constitutional amendment that allows the legislature to raise the current ad valorem tax exemption for disabled veterans and their surviving spouses and minor children. The tax exemptions would be raised based on a veteran's disability rating as follows:

Disability	Maximum Tax Exemption
10%-30%	\$ 5,000
30%-50%	\$ 7,500
50%-70%	\$10,000
More than 70%	\$12,000
Age 65 and 10% or higher	\$12,000
Loss or loss of use of limb	\$12,000
Blindness or paraplegia	\$12,000

The spouse and children of any veteran who dies while on active duty may be granted an exemption of up to \$5,000. The amounts of the exemptions provided for in this proposed amendment may be repealed by the legislature by general law.

The proposed amendment will appear on the ballot as follows:

"The constitutional amendment relating to raising the limits of the exemption from ad valorem taxation of property owned by disabled veterans or by the surviving spouses or surviving minor children of disabled veterans."

Este es el informe explicatorio sobre la enmienda propuesta a la constitución que aparecerá en la boleta el día 7 de noviembre de 1995. Si usted no ha recibido una copia del informe en español, podrá obtener una gratis por llamar al 1/800/252/8683 a por escribir al Secretario de Estado, P.O. Box 12060, Austin, Texas 78711



**BUY IT.
SELL IT.
FIND IT.**

CLASSIFIED.

CLASSIFIED ADVERTISING RATES

1st. Insertion...
20c Per Word
(\$3.00 Minimum)

2nd. and Subsequent
Insertions...
16c Per Word
(\$2.50 Minimum)

Additional 50c
for Blind Ads

Cards/Thanks...
20c Per Word

Legal Notices...
25c Per Word

COPY DEADLINE

Class Ads..5 pm Tues.
Display Ads..5 pm Tues.
Classified Ads & Cards of
Thanks are payable in
ADVANCE unless customer
carries regular account.

FOR SALE

**WE HAVE A
LARGE SELECTION**
of quality used homes at low
prices. Call Nationwide of
Midland, 800-456-8944 or
915-520-5850.

08a-1tc

"GOLD MAKER"
haygrazer, \$2.50 per bale.
Portis Robbins, 473-2037 or
655-7577.

07B-4tc

**GOOD BLACK-FACED
BUCK**
\$100.00. Portis Robbins,
473-2037 or 655-7577.

07B-2tc

'92 FORD RANGER PU
V-6; 5 speed. 453-2775.

06-3tc

**WE ARE NOW
OFFERING WINTER
FEED CONTRACTS**
thru Sept. 30. Cubes, Creep,
Protein Blocks. For more
information please call 453-
2611. Key Feed Store

08a-2tc

FOR SALE

Robert Lee

SUPER NICE CABIN, fur-
nished. Lots of room. Call to-
day.

ARROWHEAD POINT a
stone's throw from water's
edge. 3 bdrm., 2 bath home
on approx. 2 acres. Get de-
tails and let's look.

Elaine Lee
453-2995



**COKE COUNTY
CEMETERY BOOKS**

Third printing received.

Wanda Smith
Box 356
Robert Lee, TX 76945
915-453-2738

Bonita Copeland
Box 302
Robert Lee, TX
76945
915-453-2698

30 USED HOMES
12-14-16 wides and double
wides. Come by and make us
an offer. Must sell!!! Nation-
wide of Midland 915-520-
5850 or 800-456-8944.

08a-1tc

FOR SALE
16 ft. VIP walk-through boat
with 140 horsepower inboard
motor. Also skis and depth
finder. 473-7153.

07B-2tc

**ATTN: ALL
APARTMENT
RENTERS!!**
Own your own home for the
same price as you are paying
for rent. Call Bill 800-456-
8944 or 915-520-5850.

08a-1tc

FOR SALE
1967 Ford Mustang, 302, AC,
AT. Jason Key, 453-2307.

08a-2tc

SELF SERVICE ICEBOX
for store, 2 grocery carts, 1
glass top counter, 1 - 12 ft.
open shelf, 1 - 5 ft. counter,
pickup tool box, air compres-
sor, air jack, wash pump, odds
& ends. 453-2214, FM 1904,
Robert Lee.

08-3tc

\$32 PER SQ. FT.
buys 1900 sq. ft. new home
ready to live in. We pay taxes
and closing. Call 800-456-
8944 or 915-520-5850.

08a-1tc

FOR SALE
Wurlitzer console piano in
new condition, exercise bike,
treadmill, couch, older RCA
TV. 411 Cumbie, Bronte.

07B-2tp

**AMANA
ELECTRIC DRYER**
for sale. \$150. Call 473-5451
after 6 pm.

08-1tc

FOR SALE
3 exercise machines; excel-
lent condition. \$200.00. Call
453-2287 after 5:00 pm.

08-1tc

FOR RENT

MOBILE HOME LOT
for rent in RL. All city hook-
ups, carport, workshop,
shade trees, and much more.
949-5844.

07-3tc

**ONE OR TWO
BEDROOM
APARTMENTS
FOR RENT**

Taking applications Mon.,
Wed., and Fri., 9 am - 3 pm.
Housing Authority of Robert
Lee, 170 N. Bishop, 453-
2912. Equal Housing Oppor-
tunity.

16a-EOW

GARAGE SALES

**COOL WEATHER
BACKYARD
PATIO SALE**

501 N. Franklin St. (Beside
Burwick's in Bronte). Friday,
22, 8-4. Drafting table, office
chair, nice quality clothes for
men, women, children,
boys/girls. Solid brass baby
bed, lots more listed on fliers.

08B-1tc

GARAGE SALE

Clothes, air conditioners, Emu
gates, satellite dish and re-
ceiver and much more. Old
Bronte Highway 158. 3rd
house on the left. Saturday,
8:00 am - 4:00 pm.

08-1tp

**4 FAMILY
GARAGE SALE**

Infant car seat, baby swing,
baby & toddler clothes, lots of
cookbooks, toys, household
items, lots of misc. 1123
Washington, Robert Lee. Fri-
day, 8-4; Saturday, 8-12.

08-1tc

**3 FAMILY
GARAGE SALE**

Friday & Saturday, 9-6.
Clothes, odds & ends. Dren-
nan's, Sanco Rd., Robert
Lee.

08-1tp

**THREE FAMILY
GARAGE SALE**

1208 W. 11th, Robert Lee
(Margaret Jones). Friday &
Saturday. Misc. items, square
dance dresses, size 10;
shoes, size 8. Sears garden
tractor attachments. Child-
ren's clothes and coats,
boots.

08-1tp

FAMILY YARD SALE
409 W. Howard, Bronte.
Books, clothes, & misc. Sat-
urday only.

08B-1tp

MISC

**HOUSE AND
OFFICE CLEANING**

Also ironing. Honest, de-
pendable, reasonable. Ref-
erences, Kathy Melton, 453-
4610.

08-2tp

**"TEXAS BEST" CARPET
CLEANING AND FLOOD
RESTORATION**

Serving all Coke County for
carpet cleaning, fire and water
damage. Call toll free 1-800-
473-2807 or 473-6603,
Bronte. Free estimates.

01B-tnc

D & L DOZER SERVICE
Larry Spivey, Owner-Oper-
ator. PO Box 160, Bronte, TX.
Phone (Oak Creek Lake) 915-
743-2577.

21b-tnc

FOUND

6-8 month old mix-breed
puppy wearing purple flea
collar. Call 453-4720.

08-1tc

**Johnson's
Water Well
Service**

Farm
Ranch Home
Windmills & Pumps
24 HR. SERVICE
658-6039 or 655-0379
1-800-797-6039

TEXTRONICS

TV, VCR, Microwave
Oven Repairs & Fence
Charger Repair

1705 Hutchings - Ballinger
365-5934 or 1-800-310-8398

We make service calls to the
following towns &
surrounding areas within 50
miles of Ballinger: Blackwell,
Bronte, Miles, Paint Rock,
Robert Lee, Rowena

**Customer
Appreciation**

Lunch
Monday, Sept. 25th
12 Noon - 1:00 pm

Beans - Sausage
& Cornbread

Register for

Door Prizes!
Bring your branding iron
(We will be adding to our
livestock brand display)

Winter Feed Contracts
Fall Ivomec Specials
Lawn Winterizer

Company sales reps will
be available to answer
any questions.

KEY FEED STORE

Robert Lee, TX

LYNDA'S PAWN SHOP
welcomes your business.
Come on by 2814 Sherwood
Way. See if you don't get
treated right.

08-4tc

CARD OF THANKS

THANKS FOR THE
cards, phone calls, visits, and
flowers after my accident.
Each act of kindness and
concern is deeply appreci-
ated. My sincere thanks to
each of you.

Peggy Jackson
08B-1tc

DEAR FRIENDS,

My heartfelt thanks for the
visits, flowers, and cards I re-
ceived during my recent hos-
pitalization in San Angelo. I
am currently a resident at the
Robert Lee Nursing Home and
encourage you to visit me
as often as possible.

Ruth Brown
We thank you, too!
Dale & Juanell Brown
Pritch & Dorothy Brown
Billie Sue Douthit
08-1tc

WE WISH TO THANK
all of you for the flowers,
cards, calls, and food, espe-
cially the Red Barn and 911,
Larry, Gwen and Jerita for
coming to my rescue, and to
all that stood by Ken at a time
like this.

Armene and Ken
08B-1tp

WE SINCERELY THANK
all the people of Coke County
for their prayers, words of
sympathy and encourage-

ment, for the food, flowers,
and your attendance at
Ruby's memorial service. We
also thank the ladies of Cen-
tral Baptist Church for their
service in serving food to our
family and our friends from out
of town.

We also thank Ballinger
Home Health Care, both of
our ambulance services,
along with Hospice of the Big
Country of Abilene. Also,
Brother Randy Johnson,
Brother Jimmy Rogers, and
Brother Garry Bivins for the
messages that comforted us,
and gave us strength.

We also want to thank the
membership of Silver Baptist
Church, and the men of the
church who served as pall
bearers.

Sincerely, we thank every-
one from our hearts, and ask
that you continue praying for
us.

The Blackmon Family
R.W. Blackmon, Bette and
Jerry McCutchen, Sue and
Eddy Spiller, and all the
grandchildren
08B-1tc

NOTICES

**PUBLIC NOTICE
ANNUAL BUDGET OPEN
FOR INSPECTION**

On Monday, September
18th, 1995, Coke County
Commissioners enacted the
County's Budget for Fiscal
Year 1996. A summary of the
adopted budget showing the
intended uses and informa-
tion supporting the budget
action taken by the
commissioners are available
for public inspection in the
office of the County Auditor,
County Clerk, and the County
Judge, Coke County
Courthouse during the hours
of 8 am to 5 pm Monday
through Friday.

Jackie Walker
County Judge
08a-1tc

PUBLIC NOTICE
Bronte ISD is accepting bids
on a 20 foot stock trailer. For
specifications contact the Su-
perintendent's Office. 915-
473-2511.

08B-2tc

**AMENDED NOTICE OF
APPLICATION**

Notice is hereby given that
the Applicant, Exxon Corpor-
ation, PO Box 1600, Midland,
TX 79702, has made applica-
tion for a spacing exception
permit under the provisions of
Railroad Commission
Statewide Rule 37 (16 Tex.
Admin. Code Section 3.37).
Applicant seeks exception to
the distance between wells
requirement to plug back if
completed in the Bronte
(Capps Lime) field, Bronte
Capps Unit, Well No. 210,
1023.7 Acres; if completed in
the Bronte field, Bronte Palo
Pinto Unit, Well No. 210,
2411.3 acres; if completed in
the Bronte (Gardner), Wildcat
and Bronte (4800 Sand)
fields, Well No. 210, R.E.
Hickman C Lease, 309.6
acres, C.&M. R.R. Co. #5 Sur-
vey, A-62 Field(s), Coke
County, being 1.5 miles in a
southwest direction from
Bronte, Texas. The location
of this well is as follows:

IF COMPLETED IN THE
BRONTE (CAPPS LIME)
FIELD, BRONTE CAPPS
UNIT LOCATION IS AS FOL-

...Classifieds

NOTICES

5682' from the north line and 2033' from the east line of lease. 2882' from the southerly northeast line and 650' from the northwest line of survey.

IF COMPLETED IN THE BRONTE FIELD, BRONTE PALO PINTO UNIT LOCATION IS AS FOLLOWS:

4409' from the northeast line and 3193' from the southeast line of lease. 2882' from the southerly northeast line and 650' from the northwest line of survey.

IF COMPLETED IN THE BRONTE (GARDNER), WILDCAT AND BRONTE (4800 SAND) FIELDS, R.E. HICKMAN C. LEASE LOCATION IS AS FOLLOWS:

2503' from the southwest line and 650' from the northwest line of lease. 2882' from the southerly northeast line and 650' from the northwest line of survey.

Field Rules for the Bronte and Bronte (4800 Sand) fields are 330/933, 40 acres.

Field Rules for the Bronte (Capps Lime) field are 330/933, 80 acres.

Field Rules for the Bronte (Gardner) and Wildcat fields are 467/1200, 40 acres.

This well is to be drilled to an approximate of 5333 feet.

PURSUANT TO THE TERMS of Rule 37 (h) (2) (A), this application may be granted administratively if no protest to the application is received. An affected person is entitled to protest this application. Affected persons include owners of record and the operator or lessees or record of adjacent tracts and tracts nearer to the proposed well than the minimum lease line spacing distance. If a hearing is called, the applicant has the burden to prove the need for an exception. A protestant should be prepared to establish standing as an affected person, and to appear at the hearing either in person or by qualified representative and protest the application with cross-examination or presentation of a direct case. The rules of evidence are applicable in the hearing. If you have questions regarding this application, please contact the Applicant's representative, Alex M. Correa, Sr. Regulatory Specialist, at (915) 688-6782. If you have any questions regarding the hearing procedure, please contact the Commission at (512) 463-6718.

IF YOU WISH TO REQUEST A HEARING ON THIS APPLICATION, YOU MUST FILL OUT, SIGN AND MAIL OR DELIVER TO THE AUSTIN OFFICE OF THE RAILROAD COMMISSION OF TEXAS THE ENCLOSED NOTICE OF INTENT TO APPEAR IN PROTEST. A COPY OF THE INTENT TO APPEAR IN PROTEST MUST ALSO BE MAILED OR DELIVERED ON THE SAME DATE TO APPLICANT AT THE ADDRESS SHOWN ABOVE. THIS IN-

TENT TO APPEAR IN PROTEST MUST BE RECEIVED IN THE RAILROAD COMMISSION'S AUSTIN OFFICE BY SEPTEMBER 30, 1995. IF NO PROTEST IS RECEIVED WITHIN SUCH TIME, THE REQUESTED PERMIT WILL BE GRANTED ADMINISTRATIVELY, TO BE EFFECTIVE THE DAY FOLLOWING THE TERMINATION OF SUCH THREE-WEEK PERIOD.

This notice of application requires publication.

05a-4tc

NOTICE TO BIDDERS

Notice is hereby given that Coke County Commissioner's Court will accept bids until 9:00 am Monday, Nov. 6, 1995, in the Office of the County Clerk for a new pickup for the Coke County Extension Agent as follows:

- One new 1995 or 1996 extended cab pickup - minimum 8500 # GVW V-8 engine minimum 5.7 liter
 - 3.55 Rear Axle Ratio
 - Air Conditioner
 - Tilt Wheel
 - Cruise Control
 - Cloth Bench Seat
 - Vinyl Floor Covering
 - Intermittent Wipers
 - Tinted Glass
 - AM-FM Radio
 - Low Amount Swing Away Mirrors
 - Heavy Duty Radiator
- For trade-in one used 1989 Ford pickup. For additional information contact County Extension agent Tommy Antilley, courthouse, Robert Lee, Texas.

Coke County Commissioner's Court reserves the the right to reject any and all bids, and waiver any technicality.

Stover Taylor
County Auditor
07a-2tc

NOTICE OF REQUIREMENT TO COMPLY WITH THE SUBDIVISION SERVICE EXTENSION POLICY OF COKE COUNTY RURAL WATER SUPPLY CORPORATION

Pursuant to Chapter 13.2502 of the Texas Water Code, Coke County Water Supply Corporation hereby gives notice that any person who subdivides land by dividing any lot, tract, or parcel of land, within the service area of Coke County Water Supply Corporation, Certificate of Convenience and Necessity No. 11382, in Coke County, into two or more lots or sites for the purpose of sale or development, whether immediate or future, including re-subdivision of land for which a plat has been filed and recorded or requests more than two water connections on a single contiguous tract of land must comply with the Subdivision Policy contained in Coke County Water Supply Corporation's tariff policy.

Coke County Water Supply Corporation is not required to extend retail water utility service to a service applicant in a subdivision where the developer of the subdivision has failed to comply with the Subdivision Policy.

Among other requirements, the Subdivision Policy requires:

Applicable elements of the Subdivision Policy, depending on the specific cir-

cumstances of the subdivision service, may include:

Evaluation by Coke County Water Supply Corporation of the impact a proposed division service extension will make on Coke County Water Supply Corporation's water supply and payment of the costs for this evaluation;

Payment of reasonable costs or fees by the developer for providing water supply;

Payment of fees for reserving water supply;

Forfeiture of reserved water supply for failure to pay applicable fees;

Payment of costs of any improvements to Coke County Water Supply Corporation's system that are necessary to provide the water;

Construction according to design approved by Coke County Water Supply Corporation and dedication by the developer of water facilities within the subdivision following inspection.

Coke County Water Supply Corporation's tariff and a map showing Coke County Water Supply Corporation's service area may be reviewed at Coke County Water Supply's office at Hwy. 158 W., Robert Lee, Texas; the tariff/policy and service area map also are filed of record at the Texas Natural Resource Conservation Commission in Austin, Texas and may be reviewed by contacting the TNRCC, c/o Utility Rates and Services (Certification and Rate Design) Section, Water Utilities Division, PO Box 13087, Austin, Texas 78711.

07a-2tc

ORDINANCE NO. 289
AN ORDINANCE WHEREBY THE CITY OF BRONTE, TEXAS, AND GTE SOUTHWEST INCORPORATED agree that, for the purpose of operating its telecommunications business, the telephone company shall construct, erect, build, equip, own, maintain and operate in, along, under, over and across the streets, avenues, alleys, bridges, viaducts and public grounds of the City, such posts, poles, wires, cables, conduits and other appliances, structures and fixtures necessary or convenient for rendition of telephone and other communication services in said city; prescribing the conditions governing the use of public rights-of-way for the telephone company's telecommunications business; prescribing the annual compensation due the city under this ordinance; providing an indemnity clause; specifying governing laws; providing for assignment; for a period of agreement; for future contingencies; for repeal of conflicting ordinances; for release of all claims under prior ordinances; providing for designation of administrative officers and right to information; for partial invalidity; for termination; for exclusion of video services; and for the method of acceptance.

APPROVED THIS 10TH DAY OF AUGUST, A.D. 1995

Martin Lee
Mayor

08B-1tc

ORDINANCE #292 AMENDMENT TO ORDINANCE #3

THE AMENDMENT TO ORDINANCE #3 IS AS FOLLOWS:

THEREFORE, BE IT ORDAINED, by the City Council of the City of Bronte, Texas, as follows, to-wit:

1. **Jurisdiction:** The Corporation Court shall have exclusive original jurisdiction within the territorial limits of the municipal in all criminal cases that:

a. Arise under the ordinances of the municipality.

b. Are punishable by a fine not to exceed (1) \$2000.00 in cases arising under municipal ordinances that govern fire, safety, zoning, or public health and sanitation, including the dumping of refuse, or (2) \$500.00 in all other cases.

2. **Concurrent Jurisdiction:** The Corporation Court has concurrent jurisdiction with the Justice Court of the precinct in which the municipality is located and all criminal cases arising under state law that:

a. Arise within the territorial limits of the municipality.

b. Are punishable by fine not to exceed \$200.00.

The Corporation Court has jurisdiction in the forfeiture and final judgment of all bail bonds and personal bonds taken in all criminal cases of which the court has jurisdiction.

3. **Judge:** The Corporation Court shall be presided over by the "Judge of the Municipal Court" who shall be appointed for a term of one year.

4. **Rules of Procedure:** The authority and the procedure of the Municipal Court of the City of Bronte shall be governed by Chapter 45, Texas Criminal Procedure Code and Rules as amended by Article 45.01 through 45.54 and any additional articles as may be enacted.

THE EFFECTIVE DATE OF THE AMENDMENT IS OCTOBER 1, 1995.

PASSED AND APPROVED THIS THE 7TH DAY OF SEPTEMBER, 1995.

CITY OF BRONTE
By: Martin Lee, Mayor
08B-1tc

CORRECTED NOTICE OF APPLICATION

NOTICE IS HEREBY GIVEN that the Applicant, Exxon Corp., PO Box 1600, Midland, TX 79702, has made application for a spacing exception permit under the provisions of Railroad Commission Statewide Rule 37 (16 Tex. Admin. Code Section 3.37). Applicant seeks exception to the distance between wells requirement to drill if completed in the Bronte Field, Bronte Palo Pinto Unit, Well No. 303, 2411.3 Acres; if completed in the Bronte (Capps Lime) Fields, Bronte Capps Unit, Well No. 303, 1023.7 Acres; if completed in the Bronte (Cambrian) Field, Bronte Cambrian Unit, Well No. 303, 486.7 Acres; if completed in the Wildcat and Bronte (4800 Sand) Fields, R E Hickman C. Lease, Well No. 303, 309.6 Acres, C. & M. R.R. Co. #5 Survey, A-62, Coke County, being 1.5 miles in a southwest direction from Bronte, Texas.

IF COMPLETED IN THE BRONTE FIELD, BRONTE PALO PINTO UNIT, 2411.3 ACRES LOCATION IS AS FOLLOWS:

5731' from the north line and 2998' from the east line of lease. 3295' from the northeast line and 1241' from the northwest line of survey.

IF COMPLETED IN THE BRONTE (CAPPS LIME) FIELD, BRONTE CAPPS UNIT, 1023.7 ACRES LOCATION IS AS FOLLOWS: 5599' from the north line and 1852' from the east line of lease. 3295' from the northeast line and 1241' from the northwest line of survey.

IF COMPLETED IN THE BRONTE (CAMBRIAN) FIELD, BRONTE CAMBRIAN UNIT, 486.7 ACRES LOCATION IS AS FOLLOWS:

3616' from the south line and 1495' from the east line of lease.

3295' from the northeast line and 1241' from the northwest line of survey.

IF COMPLETED IN THE WILDCAT, BRONTE (4800 SAND) AND BRONTE (GARDNER) FIELDS, R E HICKMAN C. LEASE, 309.6 ACRES LOCATION IS AS FOLLOWS:

2091' from the south line and 1241' from the west line of lease.

3295' from the northeast line and 1241' from the northwest line of survey.

Field Rules for the Bronte, Bronte (4800 Sand) and Bronte (Cambrian) fields are 330/933, 40 acres.

Field Rules for the Bronte (Gardner) and Wildcat fields are 467/1200, 40 acres.

Field Rules for the Bronte (Capps Lime) field are 330/933, 80 acres.

This well is to be drilled to an approximate depth of 5700 feet.

PURSUANT TO THE TERMS of Rule 37(h) (2) (A), this application may be granted administratively if no protest to the application is received. An affected person is entitled to protest this application. Affected persons include owners of record and the operator or lessees of record of adjacent tracts and tracts nearer to the proposed well than the minimum lease line spacing distance. If a hearing is called, the applicant has the burden to prove the need for an exception. A protestant should be prepared to establish standing as an affected person, and to appear at the hearing either in person or by qualified representative and protest the application with cross-examination or presentation of a direct case. The rules of evidence are applicable in the hearing. If you have questions regarding this application, please contact the Applicant's representative, Alex M. Correa, Sr. Regulatory Specialist, at (915) 688-6782. If you have any questions regarding the hearing procedure, please contact the Commission at (512) 463-6718.

IF YOU WISH TO REQUEST A HEARING ON THIS APPLICATION, YOU MUST FILL OUT, SIGN AND MAIL OR DELIVER TO THE AUSTIN OFFICE OF THE RAILROAD COMMISSION OF TEXAS A NOTICE OF INTENT TO APPEAR IN PROTEST. A COPY OF THE INTENT TO APPEAR IN PROTEST MUST ALSO

IF YOU WISH TO REQUEST A HEARING ON THIS APPLICATION, YOU MUST FILL OUT, SIGN AND MAIL OR DELIVER TO THE AUSTIN OFFICE OF THE RAILROAD COMMISSION OF TEXAS A NOTICE OF INTENT TO APPEAR IN PROTEST. A COPY OF THE INTENT TO APPEAR IN PROTEST MUST ALSO

IF YOU WISH TO REQUEST A HEARING ON THIS APPLICATION, YOU MUST FILL OUT, SIGN AND MAIL OR DELIVER TO THE AUSTIN OFFICE OF THE RAILROAD COMMISSION OF TEXAS A NOTICE OF INTENT TO APPEAR IN PROTEST. A COPY OF THE INTENT TO APPEAR IN PROTEST MUST ALSO

(cont'd. on page 16)

Classifieds

NOTICES

BE MAILED OR DELIVERED ON THE SAME DATE TO THE APPLICANT AT THE ADDRESS SHOWN ABOVE. THIS INTENT TO PROTEST MUST BE RECEIVED IN THE RAILROAD COMMISSION'S AUSTIN OFFICE BY OCTOBER 20, 1995. IF NO PROTEST IS RECEIVED WITHIN SUCH TIME, THE REQUESTED PERMIT WILL BE GRANTED ADMINISTRATIVELY, TO BE EFFECTIVE THE DAY FOLLOWING THE TERMINATION OF SUCH THREE-WEEK PERIOD. THIS NOTICE OF APPLICATION REQUIRES PUBLICATION.

08a-4tc

NOTICE OF APPLICATION

NOTICE IS HEREBY GIVEN that the Applicant, Exxon Corp., PO Box 1600, Midland, TX 79702, has made application for a spacing exception permit under the provisions of Railroad Commission Statewide Rule 37 (16 Tex. Admin. Code Section 3.37). Applicant seeks exception to the distance between wells requirement to drill Well No. 304, if completed in the Bronte Field, Bronte Palo Pinto Unit, 2411.3 Acres; if completed in the Bronte (Capps Lime) Field, Bronte Capps Unit, 1023.7 Acres; if completed in the Bronte (4800), Bronte (Gardner) and Wildcat Fields, R E Hickman C Lease, 309.6 Acres; if completed in the Bronte (Cambrian) Field, Bronte Cambrian Unit, 486.7 Acres, C. & M. R.R. Co. #5 Survey, A-62, Coke County, being 1.5 miles in a southwest direction from Bronte, Texas.

IF COMPLETED IN THE BRONTE FIELD, BRONTE PALO PINTO UNIT, 2411.3 ACRES LOCATION IS AS FOLLOWS:

4263' from the north line and 2910' from the east line of lease line.

4263' from the northeast line and 116' from the southeast line of survey.

IF COMPLETED IN THE BRONTE (CAPPS LIME) FIELD, BRONTE CAPPS UNIT, 1023.7 ACRES LOCATION IS AS FOLLOWS:

415' from the south line and 1067' from the east line of lease.

4263' from the northeast line and 116' from the southeast line of survey.

IF COMPLETED IN THE BRONTE (4800), BRONTE (GARDNER) AND WILDCAT FIELDS, R E HICKMAN C LEASE, 309.6 ACRES LOCATION IS AS FOLLOWS:

1126' from the south line and 116' from the east line of lease.

4253' from the northeast line and 116' from the southeast line of survey.

IF COMPLETED IN THE BRONTE (CAMBRIAN) FIELD, BRONTE CAMBRIAN UNIT, 486.7 ACRES LOCATION IS AS FOLLOWS:

2189' from the south line and 1069' from the east line of lease. 4263' from the northeast line and 116' from the

southeast line of survey. Field Rules for the Bronte, Bronte (4800 Sand) and Bronte (Cambrian) fields are 330/993, 40 acres. Field Rules for the Bronte (Capps Lime) field are 330/993, 80 acres. Field Rules for the Wildcat and Bronte (Gardner) fields are 467/1200, 40 acres. This well is to be drilled to an approximate depth of 5700 feet.

PURSUANT TO THE TERMS of Rule 37 (h) (2) (A), this application may be granted administratively if no protest to the application is received. An affected person is entitled to protest this application. Affected persons include owners of record and the operator or lessees of record of adjacent tracts and tracts nearer to the proposed well than the minimum lease line spacing distance. If a hearing is called, the applicant has the burden to prove the need for an exception. A protestant should be prepared to establish standing as an affected person, and to appear at the hearing either in person or by qualified representative and protest the application with

cross-examination or presentation of a direct case. The rules of evidence are applicable in the hearing. If you have questions regarding this application, please contact the Applicant's representative, Alex M. Correa, Sr. Regulatory Specialist, at (915) 688-6782. If you have any questions regarding the hearing procedure, please contact the Commission at (512) 463-6718.

IF YOU WISH TO REQUEST A HEARING ON THIS APPLICATION, YOU MUST FILL OUT, SIGN AND MAIL OR DELIVER TO THE AUSTIN OFFICE OF THE RAILROAD COMMISSION OF TEXAS A NOTICE OF INTENT TO APPEAR IN PROTEST. A COPY OF THE INTENT TO APPEAR IN PROTEST MUST ALSO BE MAILED OR DELIVERED ON THE SAME DATE TO APPLICANT AT THE ADDRESS SHOWN ABOVE. THIS INTENT TO APPEAR IN PROTEST MUST BE RECEIVED IN THE RAILROAD COMMISSION'S AUSTIN OFFICE BY OCTOBER 20, 1995. IF NO PROTEST IS RECEIVED WITHIN SUCH TIME, THE REQUESTED

PERMIT WILL BE GRANTED ADMINISTRATIVELY, TO BE EFFECTIVE THE DAY FOLLOWING THE TERMINATION OF SUCH THREE-WEEK PERIOD. THIS NOTICE OF APPLICATION REQUIRES PUBLICATION.

08a-4tc

Asian ambrosia beetle spreading through state

Entomologists across the state are keeping a wary eye out for the Asian ambrosia beetle, which has already created problems in several nurseries in southeast and northeast Texas.

Four counties - Brazoria, Burleson, Grimes, and Van Zandt - have been added to the list of infested counties this year. Hunt County was added late in 1994. This brings to 41 the total number of counties where the ambrosia beetle has been found since specialists with the Texas Agricultural Extension Service first began monitoring its movement across the state in 1994, said Bill Ree, Extension entomologist.

The pest attacks numerous

woody plants, and its damage may be identified by the toothpick-like spines which protrude 1 1/2 inches from the host plant. These spines are the "sawdust" left after the female beetle bores into the host to make brood galleries, or nurseries.

The ambrosia beetle bores horizontally into the tree, not vertically like most wood pests. That eventually causes more damage to the different sections or layers, of the branch, notes the Texas A&M University-based entomologist.

The pest has been found in Shumard oak, burr oak, chinquapin, red bud, Chinese pistachio, Mexican plum, golden raintree, and Bradford pear in Texas nurseries. It also may attack pecan trees.

American Heart Association
Fighting Heart Disease and Stroke

AMERICAN HEART ASSOCIATION
MEMORIALS & TRIBUTES

1-800-AHA-USA1

This space provided as a public service.
©1994, American Heart Association

HALL'S SUPER SAVE FOODS

120 W. MAIN BRONTE 473-2065

FOOD STAMPS WELCOME

OPEN 7 DAYS A WEEK
MON.-SAT. 7:30 AM-9 PM
SUN. 8 AM-8 PM

PREFERRED TRIM TOP



Sirloin Steak

LB. 2.29

STAR KIST OIL OR WATER PACK CHUNK LIGHT



Tuna

6 OZ. CAN .59

NEW CROP COLORADO



Potatoes

15 LB. BAG 1.99

SHURSAVING HOMOGENIZED



Milk

GAL. 1.99

FREEZER PACK - \$59

All Freezer Packs are Cut, Wrapped & Frozen Fresh

3-2 Lb. Cube Steak, 3-2 Lb. Pork Chops, 2-3 Lb. Boneless Roast, 5-2 Lb. Ground Chuck, 2-2 Lb. Boneless Skinless Fryer Breast

FREEZER PACK - \$39

4-1 1/2 Lb. Sirloin Steaks, 4-2 Lb. Ground Chuck, 3-2 Lb. Country Style Pork Ribs, 2-2 Lb. Split Fryer Breast

FREEZER PACK

A WEEK OF MEAT FOR ONLY \$25.00

2 Lbs. Split Fryer Breast - 2 Lbs. Extra Lean Cube Steak - 3 Lbs. Boneless Roast - 2 Lbs. Lean Ground Chuck - 3 Lbs. Sirloin Steak - 2 Lbs. Pork Chops



Dr. Pepper or Pepsi

6 pk. 12 oz. cans 1.69

HORMEL REG./HOT NO BEANS OR REG. WITH BEANS



Chili

19 oz. can .99

KELLOGG'S



Corn Flakes

24 oz. box 1.99

THOMPSON SEEDLESS



Grapes

Lb. .79

Coffee

12-13 oz. can 2.29

PRICES EFFECTIVE 9-20 THRU 9-25-95

We reserve the right to limit quantities.