

WEATHER

Sept. 15	79	60
Sept. 16	83	55
Sept. 17	66	56
Sept. 18	80	50

Muleshoe Journal

The Community Of Opportunity-Where Water Makes The Difference

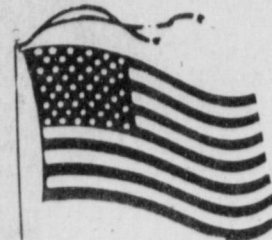

Vol. 69, No. 37

Published Every Thursday At Muleshoe, Bailey County, Texas 79347

MEMBER
TA TEXAS PRESS ASSOCIATION **20c**

THURSDAY, SEPTEMBER 19, 1991

Industrial Foundation Pursues Prison

around
muleshoe

Educator of the Week at Watson Junior High is Belinda Steinbock. Ms. Steinbock teaches seventh grade science.

The Principal's awards went to Cassidy Cleavinger, sixth grade; Shane Scoggin, seventh grade; and Leroy Flores, eighth grade.

The seventh and eighth grade white teams will not play here. Instead the game will be played in Denver City. Time slot is the same.

Friday night the parents of the senior class will sponsor a dance at the Legion Hall from 10:30 p.m. to 12:30 a.m. for project graduation.

The Muleshoe City Council will meet at 8:30 a.m. Tuesday, September 17. The following items will be on the agenda:

1. Correction or approval of the minutes of the Council Meetings held August 20, and Budget Work Session held August 28 and September 12.

2. Public Hearing for Budget for Fiscal Year 1991-92.

3. Council discussion and consideration of ordinance relating to the adoption of a Budget for the Fiscal Year beginning October 1, 1991.

a. ORDINANCE NO. 315A-An ordinance approving the adopting of a Budget for the Fiscal Year beginning October 1, and ending September 30.

b. Ordinance No. 316A-an ordinance levying taxes of use and support of the municipal government of the city of Muleshoe and the year 1991-92, and providing for the time and manner of paying the ad valorem taxes levied.

c. Ordinance No. 317A-an ordinance authorizing and allowing under the act governing the Texas municipal retirement system, "Updated service credits" in said system for service performed by qualifying members of such system who presently are in the current service annuities for retirees and beneficiaries of deceased retirees of the city, and establishing an effective date for

Cont. Page 6, Col. 1



FIRST PLACE FLOAT--The Muleshoe Jennyslippers took first place in the Mules Day Parade Saturday. (Journal Photo)

Farm Safety Week, Opportunity To Evaluate Safety Attitude

Farm Safety Week provides agriculture to evaluate their safety attitude and work habits and rededicate their efforts to make each day a safe day on the farm.

The following safety information is furnished by Deere & Company and the nearly 2900 John Deere dealers worldwide who remind farmers and ranchers to protect agriculture's greatest resource--you, and those who live and work with you.

SAFETY RECOMMENDATIONS

1. *Take the time to be safe.* Farming puts a lot of demands on everyone's time. Sometimes, when time is tight, experienced equipment operators and farm workers take shortcuts. Those shortcuts can result in accidents that harm or kill. Saving a couple of minutes is not worth the chance of losing a lifetime. Don't be too busy to be safe.

2. *Just say "no" to children.* Many accidents could be prevented by simply keeping kids away from farm equipment. Do not permit a child to do an adult's job. Even when young people become mature enough

to operate equipment, it's vitally important that they be able to properly use all of the machine's controls and work safely. Be sure they receive thorough safety and operating instruction. Basic tractor and machinery safety courses are available from many schools and extension offices.

Farm Bureau Hosts Annual Barbecue Meal

The Bailey County Farm Bureau hosted their annual meeting Saturday night, September 14 for their members and directors.

The barbecue meal, with all the trimmings, got under way at 6:30 p.m. and the business meeting convened at 7:45. The invocation was given by Mack Hodges. The pledge to the flag was led by Boy Scout Jeremy Tosh.

David Tipps, local office manager, welcomed the members and introduced the special guests, The Texas Farm Bureau Director of District 2, Leland White and his wife, who were also present.

Allen Smyer, president of Bailey County Farm Bureau introduced the Citizenship Seminar students, Stacie Harris, Rebecca Green, Tina Copley, Margarita Posadas and Galin Latham. Stacie and Margarita spoke of their experiences and what they had learned at the seminar this summer at San Antonio.

Reports were given by various officers and Norma Bruce, representing Sudduth Field and Co. gave the financial report.



MIKE RATKE

Minimum/Medium Facility Sought

During a press conference Monday afternoon Muleshoe Area Industrial Foundation announced its intention to pursue the location of a minimum medium security prison site adjacent to this community.

Speaking for the foundation, Jay Messenger stated that a prison facility would be built within a 60 mile radius of Muleshoe. "If prisoners are sent to a facility elsewhere who pays? we do. If they are sent here, who pays? we do," this one way to keep our tax dollars at home," Messenger stated. "This is one industry that won't be here a year or two and then leave, it will be here to stay."

"The Foundation Board sites the positive economic impact and the overpowering support of the community as some of the reasons for their decision," Messenger continued.

"A few months ago about 20 selected community leaders were asked what they thought and they strongly supported the idea of a prison site here in Muleshoe."

If awarded, this prison site would provide for 1,000 minimum and medium custody inmates (lower risk inmates) and provide employment to approximately 317 personnel.

Similar facilities have been built at Snyder, Lamesa, Childress, and Amarillo. These sites were developed through a personal process in 1987 and 1989," Messenger continued. "This is the same process we will be following."

"Over the weekend, we had the opportunity to tour the Childress Prison," Kenneth Henry added. "It wasn't a bad looking building and with its high fences you don't have to be afraid of the prisoners escaping."

Leaders in these communities have praised the benefits to

FHA Will Serve Pre-Game Supper

Muleshoe High School FHA is having a pre-game dinner Friday, from 5:30 to 7:30 at the High School cafeteria.

Mexican food will be served in addition, there will also be a food bar and drinks.

Tickets are \$5.00 each for adults and \$3.50 for children.

Tickets are available from any FHA member.

their towns from the new industry. Several are planning to apply for additional facilities. These communities have experienced lower unemployment, increased housing demands, stronger retail sales, and an increased tax base. Local businesses and workers benefit during the construction process. Once the facility is opened many support services are constructed locally.

This is a state owned facility, to be operated by the Texas Department of corrections, and will provide benefits to our area for many years to come.

The current facilities of the Texas Prison System are far below current needs and projections of future needs. The lack of facilities and unsuitable facilities have resulted in the

Wilson Wins Weekly Football Contest

It must have been an easy week for the contestants in the Muleshoe Merchants Football Contest because very few games were missed.

R.G. Wilson and Tom Burgess only missed three games so we had to go to the tiebreakers to determine the first place winner. Wilson missed the tie breaker by 23 points and was determined first place winner and received 10 points and a check for \$10.00.

Burgess also missed three points and was 30 points off in the tie breaker for a second place win. He will receive 6 points and a check in the amount of \$7.50 for his efforts. He was first place winner in last week's contest and had 10 points, add this week's points and he has 10 points toward the big contest.

James Hanson, Alene Bryant and Millie May also missed four games, so again we had to go to the tiebreakers. Hanson was 13 points off the tiebreakers while Alene Bryant was close behind with 19 points off, and Millie May also missed four games and was 31 points off in the tiebreakers.

Be sure to keep those entries coming in, its still anyone's game at this time. You still have a chance in winning the grand prize of \$150.00.

Lazbuddie Longhorns Defeat Valley 52-14

The Lazbuddie Longhorns had another good night Friday when they defeated Valley 52-14 on their home field.

Clay Edwards put the first score for the night on the scoreboard, when he ran 40 yards for a touchdown. The kick after by Bradley Price was good.

Eric Williams came back for the Longhorns and scored on a 15 yard pass from Brad Thomas. Louis Gonzales kicked the extra point.

Eric Jesko came back with a 10 yard run for Lazbuddie. The extra point was no good.

Increasing the lead Leland Brockman had a 4 yard run and added 6 more points to Lazbuddie's lead. The kick failed.

Terry Darling scored on a 53 yard pass thrown from Brett Thomas. Louis Gonzales kicked the extra point.

Lazbuddie led at the end of the first quarter 30-7.

In the second quarter Kirk Jesko was the only player to

score. He scored on a 50 yard run and the kick was good.

The half time score was Lazbuddie 36 and Valley 8.

Bradley Price passed the ball 43 yards to Laurance Hendrix giving Valley another touchdown. The kick after failed.

Lazbuddie was on the receiving end of the next score when Leland Brockman scored on a 5 yard run and the kick after was good.

Advancing their lead a little more Terry Darling scored on a 9 yard pass from Mario Zamora. The extra point was good.

At the end of the game the score was Lazbuddie 54 and Valley 14.

"We had three offensive players who did a great job Friday night," Coach Williams said. "Kirk Jesko ran 13 times for 203 yards and two touchdowns. Brett Thomas touched down 11 of 15 passes for 227 yards and two touchdowns. Terry Darling caught four times for 62 yards and two touchdowns."



MULESHOE AND IDALOU TANGLE--This unidentified Idalou Wildcat tries to gain more yardage during the Muleshoe-Idalou game which was played in Idalou. He is being tackled by Mule No. 78 Mike Friend and other Mules. The Wildcats were successful in their endeavor by winning the game by a score of 14-3. The Mules next game will be played in Benny Douglas Stadium against the Denver City Mustangs. Game time is set for 8 p.m. (Journal Photo)

RING UP BIGGER REDUCTIONS

SHURFINE REGULAR/ HOT WHOLE HOG **PORK SAUSAGE** 1 LB. ROLL **\$1.79**
2 LB. ROLL **\$3.57**

HEAVY GRAIN FED BEEF BONELESS **CALIFORNIA ROAST** LOTS OF MEAT COUNTRY STYLE **\$1.79**
PORK RIBS LEAN TRIM CENTER CUT **\$2.39**
PORK CHOPS PORK LOIN **\$1.79**
SIRLOIN ROAST OSCAR MAYER **\$1.59**
SLICED BOLOGNA OSCAR MAYER P&P/ LUNCHEON LOAF/ LIVER CHEESE/ OLIVE LOAF **\$1.59**
LUNCHEON MEATS

All American Breakfast Month



Congratulations to Cecile McMath For Winning A \$100.00 Shopping Spree from Thriftway!

HILLSHIRE FARMS REG./ LITE/ BEEF/ POLISH **SMOKED SAUSAGE** LB. **\$1.99**



LEAN TRIM ASSORTED **PORK CHOPS** 9-11 CHOPS **\$1.47** LB.

 ASSORTED BANQUET DINNERS 11 OZ. BOX 99¢	 ASSORTED MR. P'S PIZZA 7 OZ. BOX 69¢	 VEGETABLE/ CORN CRISCO OIL 48 OZ. BTL. \$1.49	 ABSORBENT PAPER HI-DRI TOWELS JUMBO ROLLS 2 \$1 FOR
 KLEENEX PREMIUM ASSTD. BATH TISSUE 4 ROLL PKG. 89¢			

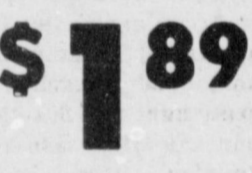
 13 OZ. CAN ASSORTED GRINDS HILLS BROS. COFFEE 12 OZ. CAN \$1.49	 2 BAR PKG. 15' OFF LABEL CARESS BATH BARS \$1.49	 42 OZ. BOX LAUNDRY DETERGENT ULTRA BOLD \$1.59	 JELLO GELATIN 3 OZ. BOXES \$1.89
--	---	---	---

 LIQUID CLEANER TOP JOB 28 OZ. BTL. \$2.29	 LIQUID CLEANER MR. CLEAN 28 OZ. BTL. \$2.29	<p>GARDEN FRESH BELL PEPPERS LARGE SIZE 4 \$1 FOR</p> 	<p>DOLE ICEBURG LETTUCE HEADS 2 \$1 FOR</p> 
 LIQUID CLEANER SPIC & SPAN 15 OZ. BTL. \$1.39	 PINE COMET CLEANSER 14 OZ. CANS 2 \$1 FOR	<p>FRESH CRISP CARROTS 2 LB. BAGS \$1.00 U.S. NO. 1 BAKING POTATOES 3 LBS. \$1.00 DOLE COLE SLAW 1 LB. BAG 79¢ FRESH BROCCOLI LB. 69¢ SNO-WHITE CAULIFLOWER EA. 99¢ FRESH POMEGRANATES LB. 99¢</p>	<p>QUAKER MASA TRIGO 8 LB. BAG \$2.99 QUAKER MASA HARINA 10 LB. BAG \$3.79</p> <p>PURINA PURINA CAT FOOD 6 OZ. CANS 4 \$1 FOR ASSORTED FLAVORS JELLO GELATIN 3 OZ. BOXES 2 89¢ FOR</p>

<p>RHODES CINNAMON ROLLS 10 CT. PKG. \$1.99</p> <p>ORE-IDA CORN THE COB 4 CT. PKG. \$1.49</p>	<p>FISHER BOY FISH STICKS 8 OZ. BOX 89¢</p> <p>BANQUET CHICK/ TURK/ BEEF POT PIES 7 OZ. BOXES 2 89¢ FOR</p>	<p>RHODES WHITE/ TEXAS WHITE/ FLAKED WHEAT DINNER ROLLS 24-36 CT. PKG. \$1.99</p> <p>HEALTH BREAK ASSTD. YOGURT 1/2 GAL. CTN. \$1.99</p>	<p>BLUE BONNET QUARTERS MARGARINE 16 OZ. BOXES 2 99¢ FOR</p> <p>PILLSBURY ALL READY PIE CRUST 15 OZ. BOX \$1.79</p>	<p>MINUTE MAID ORANGE JUICE 96 OZ. JUG \$2.99</p> <p>KRAFT LT. AMERICAN/ AMER./ SWISS/ PIMENTO SINGLES 12 OZ. PKG. \$1.99</p>	<p>TABLETS/ CAPLETS ACTIFED PLUS 20 CT. SIZE \$3.49</p> <p>TOOTH PASTE CLOSE-UP 4.6 OZ. TUBE \$1.39</p>	<p>VASELINE INTENSIVE CARE LOTION 15 OZ. BTL. \$3.19</p> <p>SCULPTING/ MEGA MOUSSE 6 OZ. SIZE \$2.39 SPRITZ OR MEGA SPRITZ 7 OZ. SIZE \$2.39 SPRAY MEGA FIX 6 OZ. SIZE \$2.39 PUMPING CURLS/ MODEL GEL 8 OZ. SIZE \$2.39 STYLE GEL/ MEGA GEL 5.2 OZ. SIZE \$2.39</p>
---	---	--	---	---	---	--

AMERICAN BEAUTY 24 OZ. PKG. LONG OR **THIN SPAGHETTI**
BUY ONE GET ONE **FREE**

401 W. Amer. Blvd. Muleshoe 272-4585

ALL TYPES **DR. PEPPER**
6 PACK 12 OZ. CANS **\$1.69**

WE ACCEPT FOOD STAMPS...
WE RESERVE THE RIGHT TO LIMIT

PRICES EFFECTIVE
SEPTEMBER 15-21, 1991

Loan Assistance For Small Businesses

The U.S. Economic Development Administration has awarded the South Plains Association of Governments \$500,000 to continue a revolving loan fund that is assisting financially-strapped small businesses in 15 West Texas counties, U.S. Sen. Phil Gramm and U.S. Rep. Larry Combest announced.

Specifically, the revolving loan fund will continue to extend low-interest loans to small businesses in any of the 15 counties that have been hurt financially and need working capital to maintain or expand operations.

Loan funds can also be used for fixed assets, such as purchase of land, construction of plants and purchase of machinery and equipment.

"I believe this assistance will benefit South Plains small businesses that have had difficulty obtaining credit locally and help pull them through the rough economic times the area has been experiencing," Gramm said. "I believe these businesses need a chance to become totally self-sufficient and am confident this assistance will help them maintain and expand operations into the future."

The senator said small businesses from Bailey, Cochran, Crosby, Dickens, Floyd, Garza, Hale, King, Lamb, Lynn, Lubbock, Motley, Terry, Hockley and Yoakum counties are eligible for the loan assistance.

The total loan fund will be \$667,000 with SPAG contributing the additional \$167,000. The average loan will be \$67,000 while the maximum loan will be \$200,000.

"This additional half-million dollar grant speaks well of SPAG'S commitment to the continued development of the South Plains," Combest said. "These low-interest loans hand merchants the financial reins to guide the small businesses which provide a significant number of jobs and economic drive to our part of the country."

Gramm said that loans will be extended to local small businesses with long-term economic development and job creation potential.

The mission of EDA, an agency within the Department of Commerce, is to stimulate commercial and industrial growth in economically distressed areas of the United States through a variety of grant and loan guarantee programs.

Football Highlights

Two of the top offensive teams in the country last fall were Nebraska and Washington. The Cornhuskers finished 4th among Division I-A teams in scoring, amassing 413 points while holding their opponents to 147. It'll be quite a match-up Saturday as the two high-powered offenses go at each other in Lincoln. Washington won the Pac-10 title last season, whipping Iowa in the Rose Bowl 46-34. Nebraska tied Oklahoma for the runner-up spot in the Big Eight in 1990, then took a 45-21 pasting from Georgia Tech in the Cotton Bowl. Both teams are again contenders for the national title, and both showed off their power in season-opening wins, Washington 42-7 over Stanford and Nebraska, 59-28 over Utah State. Our pick: Washington.

Michigan State travels to Notre Dame Saturday to try to make amends for the 20-19 squeaker they lost to the Irish last year. The Spartans have taken four consecutive beatings from Notre Dame. The last State win, 20-15, was in 1986. Both teams were involved in close post-season contests last fall, the Spartans edging Southern California in the John Hancock Bowl 17-16, and the Irish losing to Colorado in the Orange Bowl 10-9. Notre Dame is at home and we think it'll win its fifth straight over Michigan State.

Here are our winners and losers through the weekend of August 31 and September 7: 178 right and 63 wrong for a .739 average.

There are many other great ones this weekend, but in Austin, last year's Southwest Conference champion, the Texas Longhorns entertain Auburn of the Southeast Conference. The 7-3-1 Tigers nudged Indiana in the Peach Bowl 27-23 while the 10 and 1 Longhorns were slaughtered by Miami 46-3 in the Cotton Bowl. Just have the feeling that Texas is going to re-bound from its upset loss to Mississippi State and nip Auburn.

How To Get Your Name Off Mailing Lists

While junk mail comes from a multitude of sources, contacting one organization can reduce the volume of mail received, explained a Texas Christian University marketing professor.

"It's staggering how much information is available on you," said Dr. Shannon Shipp. He noted one mailing list vendor that sells lists providing great detail on the solicited person.

"The company has lists which you just couldn't imagine—lists of all the people that live in the Northeast that have incomes of \$50,000 and who have purchased a major appliance within the last two years," Shipp outlined.

The data are collected from a variety of sources including such public records as state driver's license and motor vehicle registration.

Making automobile and drivers' license data public record has the consequence of making it available to direct marketers, Shipp said. "If people don't want that information to be available, they're going to have to work through their legislators to make that information not a matter of public record," he said.

Shipp suggested a more immediate way to reduce the tide of solicitations is by writing to the Direct Marketing Association. This voluntary association of direct marketers registers requests to be removed from mailing lists.

Before a DMA member makes a solicitation, it compares its list with the one of those who have been asked to be removed. Names appearing on the DMA list are removed from member's list.

Shipp stressed that DMA membership is voluntary and not all solicitations will cease. He said, however, that writing to the DMA can reduce the flow of direct mail.

To have your name removed from solicitation lists write: Direct Marketing Association, Mail Preference Service, 11 West 42nd St., P.O. Box 3861, New York, NY 10163-3861.

English-Spanish Real Estate Glossary Available

Real estate transactions between speakers of English and Spanish now can be simplified thanks to a new glossary from the Real Estate Center at Texas A&M University.

"Many U.S. real estate terms have no direct counterpart in Spanish, yet an understanding of them is crucial as markets between the two cultures expand," explained Center Director Richard L. Floyd.

The 3.5 x 7 inch pocket guide defines 249 key real estate terms in English, with a Spanish translation immediately following. Even the most technical terms are defined in everyday language and examples are included for clarification.

"The glossary was compiled for brokers who have bilingual clients, metropolitan markets and international investors," said Floyd. "The need for this resource is tremendous, especially as the Hispanic population continues to increase faster than any other racial or ethnic group in the United States."

By the year 2000, Hispanics are expected to represent nearly 9.5 percent of the total U.S. population, up from about 8 percent in 1990. In the Southwest, these percentages are

expected to be even higher. Many Hispanics are first or second generation Americans who predominant language is Spanish.

The Hispanic population in Texas is projected to increase from 24 percent in 1990 to 27 percent in 2000. The state's total population is expected to increase from 17.3 million to 19 million during the decade.

The English-Spanish Real Estate Glossary is available for \$2.50 (\$5 out of state) plus \$1 handling from Department NR, Real Estate Center, Texas A&M University, College Station, Texas 77843-2115. Master Card or VISA orders can be placed by calling 409-845-2031, ext. NR. Request publication 864.

The Real Estate Center celebrates its 20th anniversary this year. It was created in 1971 by the Texas Legislature to meet the needs of many audiences, including the real estate industry, instructors, researchers and the general public. The Center's comprehensive program of research and education yields publications, audio-visuals and computer software distributed widely under the slogan "Solutions Through Research."

Back To School Rail Safety Program

Railroad Commission Chairman Lena Guerrero today announced a back-to-school rail safety effort for school districts designed to reduce the chances of a school bus-train collision.

At a press conference at Manor Elementary School near Austin, Guerrero said she is mailing a rail safety training brochure to school district superintendents and PTA coordinators across the state. "We want school districts to be able to assess their risks, identify all the places where school buses have to cross railroad tracks, and train their bus drivers how to negotiate these crossings safely," Guerrero said.

According to the Commission chairman, Texas recorded more than 500 accidents involving passenger vehicles and trains at rail crossings last year. "Fortunately, none of these accidents involved school buses," Guerrero said. "But we can't afford to take chances with our children's safety. We want to help school districts improve school bus safety where railroad operations are involved."

Guerrero said the rail safety brochure will help school officials answer questions like:

- How can we tell if we have a potential problem at rail-highway grade crossings?
- How can we get more

information about each rail-highway grade crossing in our area?

How can we use the information to train regular, relief or substitute drivers?

Who do we contact about grade crossing improvements?

Guerrero also encouraged school district and PTA officials to schedule railroad safety education programs for meetings and school assemblies.

"We have excellent education programs available," she said.

"Railroad and Commission representatives can come to schools and PTA meetings with videos and other educational materials."

Guerrero said, "Since Texas has more miles of track and more rail-highway grade crossings than any other state in the country, parents, teachers, kids, everybody needs to know how dangerous it is to try to beat a train to a grade crossing."

School rail safety brochures and information about educational programs are available by writing the Railroad Commission of Texas, Rail Safety Section, P.O. Box 12967, Austin, Texas 78711-2967, or by calling 512-463-7116.

What is done hastily cannot be done prudently.
-Publius Syrus.

Ben Franklin Better quality for less

2002 W. Amer. Blvd. 272-3855
Mon. - Sat. 8 a.m. - 8 p.m. Sun. 12 - 5 p.m.

★ Committed To Bring ★
★ You Lower Prices! ★

Create Your Own Mum!



Gold & Silver Footballs 6 / \$1	Gold & Silver Mini Cowbells 4 / \$1
Helmets 29¢	Coaches Whistles 99¢
Megaphones 4 / \$1	

We Have The Largest Selection of Mum Supplies In Town.

- Black & White Booster Pom Poms
- Mum Backs
- Pom Poms
- Mums
- Black & White Ribbon (in assorted widths)
- Garters
- Teddy Bear Garland
- Tassels
- Picks
- Chains
- Numbers
- Military Braids
- Letters
- Instruction Books
- Metallic Ribbon
- Love Chains

We Also Have School Colors For Surrounding Communities Available!

PUBLIC NOTICE

On September 13, 1991, the Commissioners Court of Bailey County, Texas, ordered, by way of resolution, that commissioner precinct voting boundaries be changed. The maps shown below show the changes on the boundaries.

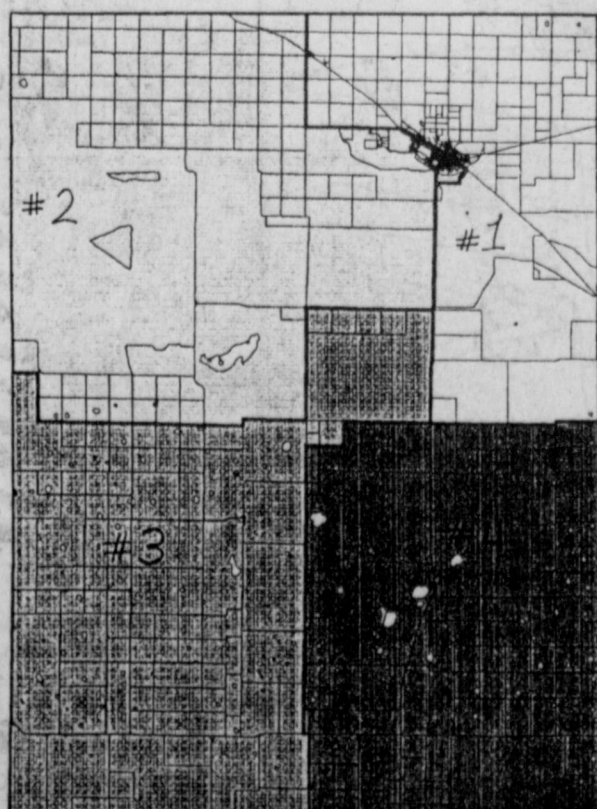

Bailey County Precincts County

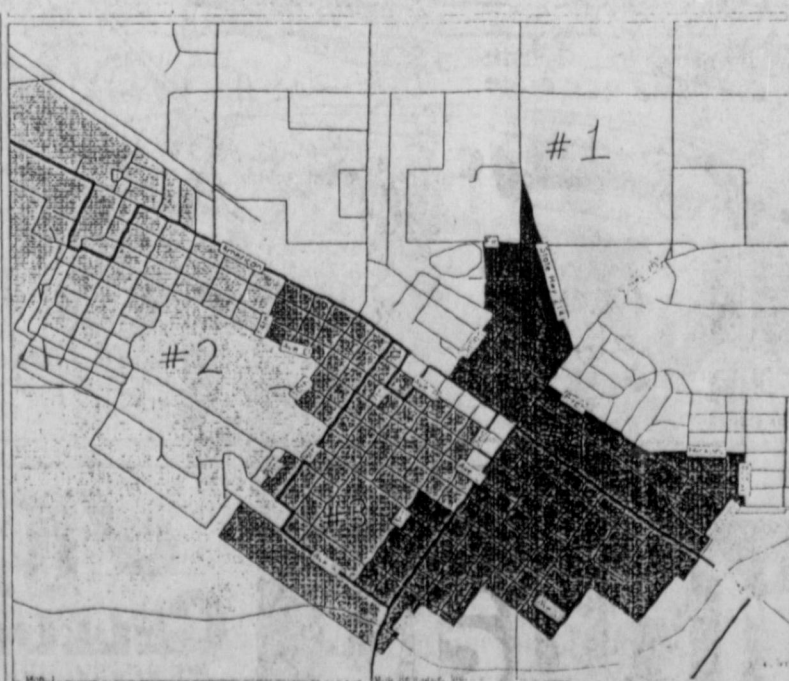

Bailey County Precincts City Of Muleshoe



MULE DAYS SWEETHEARTS-J.C. and Edna Pearson celebrate their 59th wedding anniversary on Saturday, September 14 by riding in the Mule Days parade. They purchased this mule wagon in 1971. (Journal Photo)

Sweethearts of Mule Days

J.C. Pearson was born February 17, 1909 to James and Rachel Pearson. Carrell was born in Coppell, Texas in Dallas County. Carrell has two brothers, John and George; and nine sisters, Rosy, Bessie, Lizabeth, Louise, Kathryn, Ruth, Neoma, Lois and Wannie.

Edna Hill was born October 31, 1917, in Mangum, Oklahoma. Her parents were Earl and Miriam. Edna had two brothers, Raymond and Alva.

Carrell moved to Hockley County in 1927, while Edna did not move until 1932. It was in Hockley County that Carrell and Edna met and fell in love. They married on September 14, 1932. The ceremony was performed while they sat in the car. Carrell would not get out of the car for fear of their friends doing a "chivary" on them.

Carrell and his family moved from Pettit where they lived in a half dug-out house to Watson in Bailey County in 1943. They lived there for about one year, then moved to Enochs in August, 1944. Their older three children, James, Ruby, and Juanita went to school in Watson. Lee, their youngest at the time was not old enough for school. Linda and J.C., Jr. came along and by that time Bula had opened a school and all of their children went to Bula for a time.

Carrell retired from farming

Homemakers Set Crafts Show

Jeannie Willeke of the Olton Young Homemakers announces that the annual Sandhills Arts and Crafts Show, sponsored by the Olton Young Homemakers has been scheduled for Saturday, November 30, 1991. The event will take place in the school lunch room located at 8th and Ave. G in Olton, Texas. Hours will be 9 a.m. to 6 p.m.

All crafters are invited to participate in our show. We will have 48 x 10 booths with entry fee set at \$30 per booth. Application will be accepted through November 15, 1991. For more information, please contact Tina Hardcastle, P.O. Box 465, Olton, Texas 79064 or phone Mrs. Hardcastle at 806-285-2485 or 806-285-7760.

Hispanic groups oppose Thomas' nomination.

THE FITTIN'EST...
(East or West of the Pecos!)



1177 **The Fair Store**
120 Main 272-3500



Noah Now! Coming to Methodist Church

Noah Now! sponsored by the First Methodist Church in Muleshoe will be held Saturday, October 5 at 7 p.m. at the First United Methodist Church Fellowship Hall, 507 W. 2nd, Muleshoe.

Noah Now!, a new one-man multi-media production, will be presented on Saturday, October 5 at 7 p.m. This is a community event. Admission is free with pie a la mode following the one hour dramatic presentation.

The production, created and performed by Ralph Stone, is a probing look at vital global issues through the eyes of the patriarch Noah. Stone states, "I was struck by the similarities between the flood that Noah faced and our own perilous global situation. The ark with its precious cargo of life seemed the very image of our own planet adrift in space."

Noah Now! grew out of Stone's deepening fascination with the monumental, and yet very human character of Noah. "It was Noah who carried the cargo of life through the flood, and who was shown the sign of the rainbow. He seems to offer the most promising perspective of how we relate to life as a whole on the earth."

Stone has brought Noah Now! to religious, education and environmental gatherings nationwide. The production has consistently stimulated thought through the wide appeal of Noah, and the play's direct approach to environmental problems confronting our time.

Minister, theater professional and social issues activist, Ralph Stone has devoted much of his career to expressing religious issues through dramatic presentation. As one of the ministers for 26 years at Fort Worth's

University Church, he produced and directed many original plays. His "Circus, Parable and Construction" became a Bethany Press best seller.

Stone believes that the strength of the production lies in its positive affirmation. "Life on earth faces serious threats from pollution, overpopulation, extinctions, wars and many other problems. The Noah perspective is hopeful and optimistic. Rather than dominate and exploit life, we are called to serve it-to nourish and protect it as if it were Noah's own cargo of Life."

Don't miss this opportunity to see an enormously talented man of God share insights of hope for our future on the planet earth.

Rebekah Lodge

By Reporter Pat Langfitt

Rebekah Lodge met September 10 with refreshments served by Mary Ann Ramirez, Linda Tosh and Fern Davis. Lodge was opened by Joyline Costen and the opening prayer given by Mickey Montgomery. June Green called roll of 16 members present.

The September 14 breakfast on the sidewalk on Main Street was discussed. Orange juice, coffee and breakfast burritos, blueberry muffins are some of the items to be sold. Members are asked to help make blueberry muffins and to help serve breakfast between 8 a.m. and 10 a.m.

The Thanksgiving dinner which is our annual fundraiser will be held on November 7 from 11 to 2 in the Lodge Hall. The Bow Tie Quilt will be given away than evening at 5 p.m. and will be announced on KMUL and Channel 6. Remember tickets will soon be out for the dinner at \$6 a plate. The quilt will be donation only and the proceeds will be to send 2 high school kids to the United Nations Tour. This is a vastly educational trip and well worth the donation.

Members worked around the quilt on Tuesday night to finish tacking. Now, we all know what's involved. Several said they were ready to do another.

Lodge was closed by Joyline.

Isn't it?

Isn't it odd how each family on Main Street wonders how its neighbors can consistently live beyond their means?

-Christian Science Monitor.

Muleshoe Squares News

A surprise birthday party for Louise Engleking highlighted the club meeting September 12. Daughters Britt and Chandra and family treated the group to homemade ice cream and cake.

Guests for the evening included the Federation officers and dancers from Lubbock, Plainview, Floydada, Clovis, Portales, Olton and Littlefield for a total of 7 and a half squares.

Coming dances are: September 19, Barn Dance, Kalbus Barn, James Pettus, caller, 8 p.m.; September 26, Club Dance, Legion Hall, 8 p.m.; September 28, Olton Ag Pavilion, James Pettus, Jimmy Gouge, callers, 7 p.m.



Latest Arrivals

Tessa Elise Burris

Orvis and Sharon Burris announce the birth of a daughter, Tessa Elise Burris, born September 7 in Clovis. She weighed 7 lbs, 1 oz and was 20 inches long. Grandparents are Rev. and Mrs. Bob Burris of Muleshoe and Betty Carpenter of Idabel, Oklahoma.

Great-grandparents are Ester Magby of Muleshoe, Harold and Dot Leavitt of Vega and Mary Carpenter of Idabel, Oklahoma.

Austin Carl Bamert

Nick and Rayniel Bamert announce the birth of a son, Austin Carl Bamert. He was born September 10 at 12:54 p.m. in Methodist Hospital, Lubbock. The child weighed 8 lbs., 2 oz. and was 21.5 inches long. He has one brother, Brett, who is 3 years old.

The baby's grandparents are Carl and Cookie Bamert of Muleshoe and Lee and Gladys Broussard of Nome.

LIBERTY CELLULARPHONE! CAR PHONES As Low As \$10.95 per month

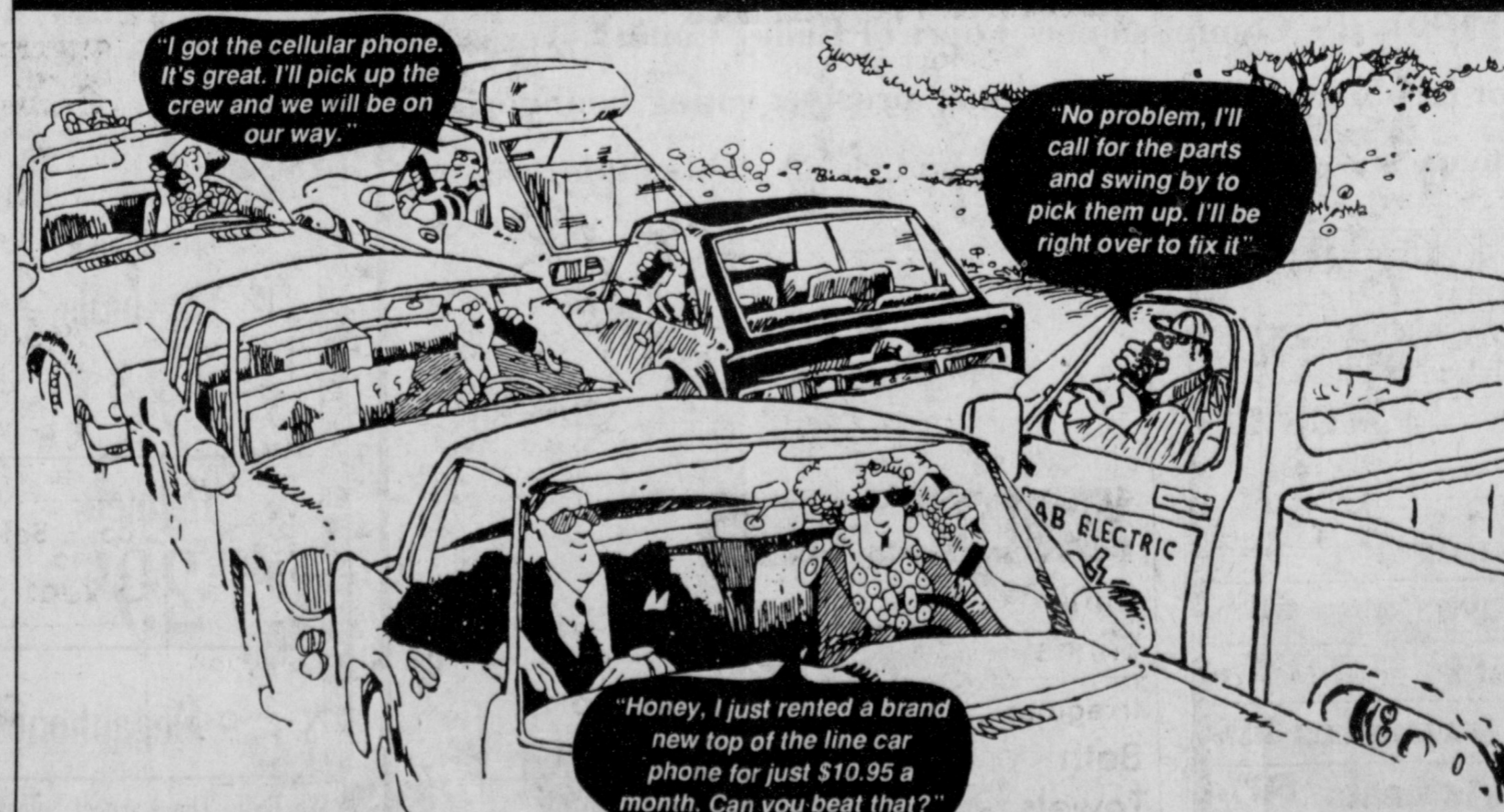

Mobile phones - \$10.95 per month
Bag phones - \$12.95 per month

Now you too can have the convenience of a cellular phone for a low monthly rental price*. That's right - there is no large cash outlay.

Call Now For Details
1-800-234-LIBerty
And Remember To Ask
About Our Special
Rent-To-Own Opportunity

* Annual Service Contract & Set-up Fee Required
Monthly Access & Airtime Fees Not Included

LIBERTY CELLULARPHONE
NETWORK

Authorized Agents:

Wilson Appliance 272-5531

HEALTH INSURANCE
CALL Mark Mortis 109 S. 1st Muleshoe 272-7519
State Farm Mutual Automobile Insurance Company - some office Birmingham, Minn.

BREEZE FROZEN YOGURT TREAT 12-OZ.

TWO TACOS

NEW! SEASONED CURLY FRIES

ALL ON SALE SEPT. 9-29, 1991
THIS WEEK'S DQ VALUE

Reg. U.S. Pat. & Tm. Off. Am. D.Q. Corp.
*TM Reg. U.S. Pat. & Tm. Tx. D.Q. Op. Coun.
© Tx. D.Q. Op. Coun. At participating Dairy Queen stores.



JIMELLA CLEMMONS AND AMELIA

Shower Honors Jimella Clemmons

A baby shower for Amelia Clemmons, daughter of Jerome and Jimella Clemmons was held September 15 from 2-3 p.m. in the home of Kay Lepard.

Guests were greeted by Druscilla Hutton. Serving was Johnette Marlow

A pink tablecloth with lace edging covered the serving table and crystal and brass appointments were used.

The table arrangement was pink and blue flowers arranged in a Southwest vase with pink and blue carousel.

Cookies and renaissance spirit punch were served.

The honoree's corsage was of pink baby socks.

Hostess gift was a changing table, baby carrier and a diaper bag.

Hostesses for the occasion were Kay Lepard, Bonnie Green, Kerma McGuire, Dianne Brown, Betty Wagnon, Hollye Hooten, Druscilla Hutton, Jan Morris, Charlotte Field, Lenda Trussell, Johnette Marlow, Julie Broyles, Barbara Murphy and Marilyn Wilson.

Words of Wisdom
It is hard to believe that America was founded to avoid taxation.

-Journal, Sioux City.

Jennifer Green, Greg Dowell United in Marriage

Honor Heights Park in Muskogee, Oklahoma was the setting for the wedding of Jennifer Green, daughter of Mr. and Mrs. Ben Green of Muleshoe and Greg Dowell, son of Mr. and Mrs. J.E. Dowell of Walnut California. Vows were exchanged in the Rose Garden Gazebo at 10 a.m. Saturday, August 17. The gazebo was decorated with vines of stephanotis and English ivy and accented with big white bows. Vance Crowe, director of Blue Haven Youth Camp in Las Vegas, New Mexico, officiated.

Escorted up the path of the rose garden by her father to the musical arrangement of "Maid Marian," the bride wore an elegant gown of white silk taffeta and schiffli lace. The bodice, heavily beaded with sequins and pearls, featured a sweetheart neckline, ball gown sleeves and a basque waistline. The full skirt, adorned with beaded lace motifs, flowed to floor length. To complete her attire, the bride wore a tiara of alencon lace beaded with sequins and pearls and highlighted with a silk illusion two-tiered fingertip veil. She carried a traditional crescent shaped bouquet of orchids, stephanotis and roses entwined with ivy and jade and white ribbon streamers.

Waiting at the gazebo, the groom was dressed in a black tuxedo with black cummerbund and black tie. His boutonniere was jade stephanotis to compliment the stephanotis in the bridal bouquet.

The bridesmaids, escorted up alternate paths by the groomsmen to the music of "Marian at the Waterfall," wore tea-length floral dresses with scooped necklines, fitted, shaped, dropped waist bodices, flared skirts, and puffed sleeves with barrel cuffs. They carried arm bouquets of jade roses and white satatice with jade ribbon streamers. The groomsmen were attired in black tuxedos with jade cummerbunds and ties. Their boutinieres were jade starflowers.

Rebecca Green, sister of the bride, served as the maid of honor. The other bridesmaids were, Miss Kim Jarvis, Manchester, Connecticut, Diane Dill, Cleburne, Texas; Pam Jaegar, Diamond Bar, California; Mrs. Candy White, sister of the groom, Dorado Beach, Puerto Rico; and Roni Harding, Walnut, California.

The groomsmen were Derek Chance, Round Rock; Jon Greenbaum, Los Angeles, California; Bart Herridge, Abilene; Johnny Leanos, Walnut, California; Eric Moden, Austin; and Nick White, nephew of the bride, Muskogee, Oklahoma, who served as ring bearer.

Guests were registered at the

rose garden by Courtney Dowell, sister of the groom. Musical selections of the bride and groom's favorite love songs were played as the guests arrived.

The reception was held in the historic Severs Building in downtown Muskogee. The traditional 3-tiered wedding cake and the peanut butter and chocolate ice cream groom's cake were served from a table covered with a white lace, floor length, ruffled cloth. The bridal bouquet and a precious moments figures, "Bless You Two," served as table decorations. Renaissance spirits punch was served from a silver punch bowl at a separate table. Finger foods which included tiny sandwiches of ham and chicken salad, trays of raw vegetables with dip, assorted cheeses and crackers, and trays of fresh fruits and dip were served from a lace covered table accented with the bridesmaids bouquets.

Heather Hutton and Debbie Brown, both of Muleshoe, and Desiree Delio of Walnut, California served the cakes and punch. They were assisted by the bride's aunts, Mrs. Karen Barrett of Dallas and Mrs. Betty Blakeslee of Muskogee, Oklahoma.

The wedding was attended by a host of family and friends. Attending from Muleshoe were Mr. and Mrs. James Brown, Mr. and Mrs. Terry Hutton, and Mr. and Mrs. June Wagnon.

Following a wedding trip to Hawaii, the couple will be at home in Houston, Texas. Greg is a 1990 graduate of Abilene Christian University and is employed as Youth Minister at the Bammell Road Church of Christ. Jennifer is a senior at Abilene Christian University and plans to do her student teaching in the Houston area during the spring semester. She will graduate from ACU in May, 1992.



MRS. GREG DOWELL
(nee Jennifer Green)

Mason Open House Set September 22

You have an opportunity to pop those questions you may have wanted to ask about Masonry but were reluctant to ask before, according to Fred A. Allen of Mt. Pleasant, Grand Master of the Masonic Grand Lodge of Texas.

Your chance comes Sunday, September 22 between 2 and 5 p.m. when Allen has proclaimed a second Public Awareness Open House to be observed simultaneously by some 940 Masonic Blue Lodges ranging from rural areas to metro centers of the state.

Hugh Young, Master of Muleshoe's Lodge No. 1237, said a cordial invitation is extended anyone interested in learning more about Masonry. The Lodge is located at 124 W. Ave. C.

Allen, titular head of the 180,000 Masons in Texas, hailed the first Public Awareness Open House last March 10 as "a smash success" in drawing more than 48,200 registrants and over 700 petitions for the first three degrees in Freemasonry (often described as the Blue Lodge Degrees).

Young noted that this open-

ness refutes the mistaken notion that Freemasonry is a secret society and that Masons can't talk about Masonry. He said while the ritual of the fraternity is not discussed with others, the membership, meeting places and activities of the Masonic fraternity are actually well known to anyone interested, with volumes of Masonic literature readily accessible in public libraries.

He further explained that many non-Masons may be surprised to know that the friend who might ask them to read some Masonic literature will never ask them to petition for membership--thus anyone interested in seeking membership must of his own free will make that interest known to an active member of the fraternity.

Officers and members of Muleshoe Lodge and associated Masonic bodies will be on hand during the open house to answer specific questions. Should you find yourself in another Texas city or town on September 22, just ask for the nearest Masonic Lodge.

Farm expenses up 6 percent in 1990 to \$124 billion.

ANTHONY'S

Once & For All SALE

FINAL! TODAY THROUGH SUNDAY

<h4 style="text-align: center;">MEN'S</h4> <div style="text-align: center;"> </div> <p>Select Group Men's Levi Dockers & Jeans Values to 31.00 Now \$19.99</p> <p>Men's Short Sleeve NoFade Dress Shirts Reg. 11.00 Now 7.99</p> <p>Short Sleeve Western Shirt Reg. 15.00 8.99</p> <h4 style="text-align: center;">SHOES</h4> <p>Select Group Womens Shoes Values to 32.00 40% off</p> <p>Select Group Men's Casual Shoes Values To 69.00 30% off</p> <h4 style="text-align: center;">HOME</h4> <p>Mini Blinds Reg. 7.99 \$5.99</p> <p>Irregular Bath Towels Reg. 4.99 for 3 \$10</p> <p>Pillows Reg. 3.99 for 2 \$7</p>	<h4 style="text-align: center;">WOMEN'S</h4> <p>Junior's Short Sleeve Pocket T-Shirts Reg. 7.99 2 for \$10</p> <p>Select Group Women's Dresses up to 1/3 off</p> <p>Select Group Junior's Leggings Values to 22.00 1/3 off</p> <p>Select Group Women's Knit & Woven Tops 20% off</p> <h4 style="text-align: center;">CHILDREN'S</h4> <p>Boy's Roller Print Shirt sizes 8-20 \$9.99 Reg. 20.00</p> <p>Boy's Select Group Sweat Shirts \$4.99</p> <p>Select Group Girl's Dresses 1/3 off</p> <p>Select Group Girls Short Sleeve Knit Shirts 20% off</p>	<h4 style="text-align: center;">Your Last Chance to Save on Summer Fashions</h4> <p>Men & Women Leather Bomber Jacket Reg. 165.00 \$119.00</p> <p>Ladies Sleepwear Clearance Price</p> <p>\$6.00 to \$11.00..... \$4.00</p> <p>\$15.00 to \$20.00..... \$9.00</p> <p>\$21.00 to \$25.00.... \$12.00</p> <p>Mexican Wedding Shirt Guayabera Reg. 16.00 \$12.00</p> <div style="text-align: center;"> </div> <p>Sergio Valente Short Sleeve Sport Shirt Reg. 25.00 \$15.99</p> <p>Bugle Boy Short Sleeve Wovens Reg. 17.00 \$12.00</p>
--	---	---

321 Main Muleshoe 272-3478

ANTHONY'S Looking Better Every Day!

Sale Prices Effective Through Sunday

MICROWAVE TIPS

.....

How can one be sure meat will cook evenly in a microwave? The best way is to cut meat into squares less than two inches in diameter. Microwaves penetrate meat to a depth of 3/4 to 2 inches. Thus small pieces of meat will cook evenly, being penetrated throughout by the microwaves.

Back-Seat Driver
With all her faults, the back-seat driver at least has enough interest in life to look ahead.
-Times, Chilton, Mo.

Going Out of Business

<h4>All Coats</h4> <p>Denim Leather Poplin Long Short 30% Off</p>	<h4>All Sweaters</h4> <p>100% Cotton Acrylic Regular & Talls 30% Off</p>
--	---

Shop Now For CHRISTMAS

<h4>Vest</h4> <p>WARM FILLED 8 Pockets Reg. 35.99 14.95</p>	<h4>Turtle Necks</h4> <p>& Mock Turtles 8 Colors 50% Off</p>
<h4>Sports Shirts</h4> 50% Off	<h4>Sweaters</h4> Shaker Knit Reg. 25.99 14.95
<h4>Overalls</h4> By Boss 60% Off	<h4>Active</h4> Tanks and Shorts 50% Off
<h4>Belts</h4> Leather Snake 50% Off	<h4>Socks</h4> Burlington Intersworn Four J 50% Off
<h4>Jockey Underwear</h4> 25% Off	<h4>All fragrances</h4> 30% Off
<h4>Dress Shirts</h4> White Blue, Grey Tan, Pink 11.95 Reg. 19.99	<h4>Sports Coats</h4> 50% Off
<h4>Wallets</h4> Leather and Felt 30% Off	<h4>Navy Blazers</h4> 69.95 Reg. 105.99
<h4>Blazers</h4> Tan Green 14.95 Reg. 95.99	<h4>Dress Pants</h4> 11.95 Reg. 28.32
<h4>Suits</h4> Double Breasted 59.95	<h4>Fashion Suits</h4> 50% Off

BOB'S M. R. shop

502 Main, Clovis

"The difference between classy & class"

9:00-5:30 MON. THRU SAT.

Pursues Prison

Cont. from Page 1

state being monitored by federal court orders. In addition, the lack of prison facilities has created a backlog of convicted felons in county jails, causing an overcrowding crisis in many of those jails.

The lack of prison space is destroying the entire criminal justice process. The average sentence for an inmate released in 1990 was 113 months. Because of insufficient capacity, the average length of stay for those inmates was 23 months, only about 20 percent of their sentences.

Messinger also stated that prisoners in Muleshoe who are to move into the State system can only be sent one day a month and then only by appointment subject to prisoners being released and freeing bed space.

The need of prisons in Texas is great and will not go away. In the late 1900's Texas changed its policy regarding facility placements from a constricted one to a policy of locating correction facilities throughout the state. There were several reasons for this policy change. A major reason was a new policy of locating prisoners in the regions they originally came from. Also, this new policy spreads a tremendous amount of economic benefit throughout the regions of the state instead of a few concentrated areas.

Due to the high level interest, the Muleshoe Area Industrial Foundation has decided to come out in support of a County wide effort to put together a proposal for submission to the Texas Department of Corrections.

While the exact bid requirements have not yet been released, William Barry of the

Texas Department of Corrections has provided the board with enough information to begin working on the project. The Texas Department of Corrections (TDC) will request proposals for the donation of land to be used as construction sites. These sites will be used for the construction of various size units. Proposals will need to be submitted by late November.

The typical facilities would provide 1,000 to 2,250 beds of various custody levels. The facility would utilize cell-type construction for living areas along with additional areas provided for educational and recreational programs. There would be an industrial program and possibly limited farming operations. The site must be a minimum of 300 acres. The unit compound and security road will use 43 to 73 acres in the center of the site.

The unit will provide employment for 300 to 800 personnel. These jobs will range to description from clerical support

to correctional officers to unit administrators. It is expected that most employees would reside in the adjacent communities. Annual payroll for the facility would range over \$6 million to about \$17 million. Salaries would range from \$12,000 to \$37,000 annually.

Mules, Mustangs To Battle Friday Night

The Denver City Mustangs will invade the Muleshoe Mules Territory Friday night hoping for another victory. The Denver City Mustangs won 24-14 over Kermit last Friday night.

The Mustangs kept Kermit scoreless for the season as they improved to 1-1 in non-district play.

At halftime the score was Denver City 17-Kermit 0. Kermit tailback Roger Padron drove 1 yard for 6 points in the third quarter and Jorge Morales' PAT was good for a 17-7 score.

Bobby Azam scored again on an 86 yard touchdown with time running out in the fourth quarter. The PAT was good and

Cross Country

Teams Win

Plainview Meet

Muleshoe participated in the Plainview Invitational on Satur-

day 14, and continued to succeed. The boys won the 4A-5A division, sealing a victory with 48 points. Amarillo High was their closest competitor, followed by Plainview. The girls placed fifth in the Division 1 race.

The individual results were impressive. The first five individuals from the boys and girls teams were:

Corley Hutton, 5th, 16:41; Andy Crawford, 11th, 16:58; Eric Cisneros, 12th, 17:00; Adrian Pineda, 13th, 17:01; and Shawna Wheeler, 16th, 17:16.

And Shane Schuster, 22nd, 14:12; Rebecca Green 28th, 14:21; Monica Clemmons, 44th, 14:37; Julie Gilleland, 46th, 14:41; and Keetha Glover, 49th, 14:50.

Denver City won the game 24-14.

Freddy Martinez' 33 yard touchdown run in the first quarter provided the widening margin as the Idalou Wildcats won 14-3 over the Muleshoe Mules.

Michael Harwick's 13 yard fieldgoal put the Mules on the scoreboard early in the first quarter, only to have Idalou Wildcat Martinez run 33 yards with 3:39 left in the quarter to take the lead.

Idalou boosted their lead when Ty Harmon connected with Tatum Lynn with a 9 yard aerial touchdown with 6:37 left in the first half. The point after was good making the final score 14-3 Idalou.

This Friday night will be an all new game for the Mules when they take on the Mustangs in Benny Douglass Stadium at 8 p.m. Come out and back the Mules and show them we are backing them all the way.



PRESENTING A CHECK--for \$100 to Bailey County law enforcement officials are representatives of the Jennyslipppers Mary Ann Ramirez, president, (at left) and Donna Kirk, treasurer. Receiving the check are Brad Harmon, DPS trooper and Jerry Hicks, Bailey County Sheriff (at right). The donation is to be used for purchase of a video camera for the squad cars. (Journal Photo)

Farm Safety

Cont. from Page 1

few minutes of rest can produce big returns in safety and productivity.

6. When working alone, keep others informed. If it's necessary to work alone, always tell someone where you'll be and when you'll return--just in case you have an accident and need help. A significant number of farmers and ranchers who were injured while working alone would be alive today if they had been found sooner.

7. Make sure equipment is in proper operating condition.

Properly maintained and adjusted equipment is an important element in a safe and productive operation. Before the beginning of the use season and periodically during the season, inspect each machine thoroughly. Look for worn parts that may affect the smooth operation of reliability of the machine and replace or repair as required. This includes all shields, guards and safety signs.

8. Carefully read the operators MANUEL. The single best source of safety information about a machine and instruc-

tions for servicing and adjusting it for proper operation is the operators manual. Study it thoroughly before operating a machine and keep it handy. If the operator's manual cannot be found, order a new one from the equipment dealer.

9. Shut it off before getting off. Always disengage the power and shut off the engine before working on any part of a machine. When working with others, make sure everyone is clear of the machine and in full view before restarting the engine.

10. Maintain a strong safety attitude. Most experienced farm workers and operators know how to work safely, but sometimes the temptation to take shortcuts and ignore safety principals proves too great to resist. Unfortunately, this momentary lapse in safety consciousness can result in injury or death. Success in making the farm a safer place to work and live requires the mental toughness to do a job safely every second of every day.

Enochs News

by: Mrs. J.D. Bayless

Guests in the home of Mr. and Mrs. Harvey Blackstone Friday were Dorothy and Adrin Weir of Acuff.

Ellen Bayless received word that her sister Mrs. Ida Henderson of Azle fell and broke her hip in 4 places and broke her shoulder and had surgery on her hip at Huguley Memorial Medical Center in Ft. Worth.

Money is the most contemptible of all manmade idols.

Graciousness is a virtue many people mistake for weakness.

Bailey County Clerk's Office New Office Hours

Effective September 30, 1991

8:00 a.m. to 12:00 noon

1:00 p.m. to 3:00 p.m.

(Due to Reduced Staff)

Muleshoe...

Cont. from Page 1

such actions.

4. Ordinance No. 318A-An ordinance by the City Council of the city of Muleshoe, Texas, amending the budget for the fiscal year 1990-91.

5. Paul Rhinehart, General Telephone Company, will meet with the Council.

6. Opening and consideration of police car bids.

7. Council discussion and consideration of an agreement for the assessment and collection of taxes by the Bailey County Appraisal District.

8. F.Y.I.

Joe Simnacher will be honored at a community wide reception Saturday, Sept. 21 at 7:30 p.m. Simnacher has been a long time resident of the Lariat and west camp community.

The meat will be furnished by Joe and Darla Rhodes and everyone attending is asked to take either a salad or desert. Cards and personal notes would be appreciated.



Goodness Sakes

Alive Look

Who's 45 !!!!

Happy Birthday

Love Ya Dad

NOTICE TO POSSIBLE CLAIMANTS FOR GRAIN STORED AT FARMERS COOPERATIVE ELEVATOR OF MULESHOE, TEXAS

The United States Department of Agriculture (USDA) under authority of the United States Warehouse Act and with permission of the Board of Directors took control of the grain inventory of Farmers Cooperative Elevator of Muleshoe, Texas, (Including Clays Corner and Enoch's, Texas) on July 9, 1991. The grain inventory is being liquidated for the benefit of the owners of the grain. All persons are hereby notified that they must file a claim with the USDA by August 15, 1991, if they believe they are entitled to participate in the distribution of money received from the sale of the grain. The claim must be on a notarized Proof of Claim form provided by the USDA and must be supported by copies of documents specifying the claim or establishing that the claimant delivered grain for storage at the Farmers Cooperative Elevator of Muleshoe, Texas. Copies of the Proof of Claim form may be obtained during normal business hours from the Kansas City Commodity Office at the address listed below, the Bailey County ASCS Office, the Texas State ASCS Office, or at the office of this publication. Claims must be received by the License Compliance Branch, Licensing Authority Division, Kansas City Commodity Office, Post Office Box 419205, Kansas City, Missouri 64141-6205 by the close of business on August 15, 1991. Claims received after that time will not be considered. Grain depositors who are believed to have claims based on a review of the warehouse records have been notified by letter. Persons filing claims in response to that letter need not file additional claims based on this notice.

The proceeds from the sale of the grain, plus interest accrued thereon, will be distributed to persons who own grain stored at Farmers Cooperative Elevator of Muleshoe, Texas, as of close of business on July 9, 1991, as determined by USDA.

Grain Funds will be kept separate by commodity. Each fund will be distributed to persons with valid claims on a pro-rata basis. Claims may be filed against the warehouse bond for losses, if any, not fully covered by the grain funds.

Persons who have sold or agreed to sell grain delivered to Farmers Cooperative Elevator of Muleshoe, Texas, are not eligible to participate in this grain fund or claim against the bond. They should contact the Texas Department of Agriculture (409) 542-3691, regarding any rights they might have under the Texas Law.

THE BOB HARMON FORECAST

Sat., Sept. 21 - Major Colleges - Div. 1-A

Alabama	28	Georgia	14
Arkansas	21	SW Louisiana	14
Ball State	28	Kent State	13
Baylor	27	Missouri	14
Bowling Green	24	Cincinnati	14
California	27	Arizona	20
Central Michigan	21	Akron	17
Clemson	34	Temple	7
Colorado	23	Minnesota	10
Duke	35	Colgate	7
East Carolina	30	Central Florida	10
Florida	31	Syracuse	13
Fresno State	34	Oregon State	10
Georgia Tech	21	Virginia	17
Hawaii	35	Pacific	6
Houston	33	Illinois	27
Indiana State	23	Kentucky	17
Iowa State	23	Wisconsin	14
Kansas	38	New Mexico State	7
Kansas State	26	Northern Illinois	21
L.S.U.	24	Vanderbilt	15
Louisiana Tech	42	Eastern Michigan	6
Maryland	31	West Virginia	7
Memphis State	33	Arkansas State	6
Mississippi	42	Ohio U.	6
Mew Mexico	27	Nevada-Las Vegas	21
North Carolina	26	Army	10
North Carolina State	24	Wake Forest	10
Northridge	24	Fullerton State	17
Notre Dame	23	Michigan State	13
NW Louisiana	23	Texas-El-Paso	21
Ohio State	38	Washington State	10
Oklahoma	40	Utah State	7
Oregon	31	Utah	10
Penn State	28	Brigham Young	17
Rutgers	24	Northwestern	21
San Diego State	31	Air Force	24
San Jose State	33	Long Beach State	13
South'n Mississippi	22	Colorado State	21
Southern California	24	Arizona State	23
T.C.U.	27	Oklahoma State	20
Tennessee	20	Mississippi State	13
Texas	20	Auburn	17
Texas A & M	26	Tulsa	13
Tulane	23	Rice	22
V.P.I.	24	South Carolina	20
Washington	31	Nebraska	17
Western Michigan	22	Toledo	20
William & Mary	26	Navy	7
Wyoming	24	Texas Tech	22

Other Games - East

Allegheny	45	Oberlin	6
American International	24	Springfield	23
Bates	26	Amherst	24
Bloomburg	26	Lock Haven	12
Dickinson, PA	26	Muhlenberg	10
Duquesne	20	Bethany, WV	19
Edinboro	33	Southern Connecticut	14
Indiana U., PA	31	East Stroudsburg	7
Ithaca	35	Albany, NY	10
Juniata	24	Delaware Valley	12
Lycoming	33	Labaron Valley	10
Middlebury	30	Bowdoin	21
Montclair	30	Buffalo U.	13
New Haven	23	Clarion	14
Plymouth	48	Massachusetts-Boston	17
Ramapo	24	Wagner	15
Shippensburg	22	Kutztown	21
Susquehanna	26	Moravian	14
Trinity, CT	30	Colby	14
Tufts	27	Wesleyan	21
Washington & Jefferson	26	Widener	14
Waynesburg	34	Grove City	14
West Chester State	24	Central Connecticut	13

Other Games - Midwest

Adrian	21	Defiance	14
Ashland	24	California State	13
Baker	45	Oklahoma State	7
Baldwin-Wallace	37	Oakland	10
Beloit	39	Hiram	7
Beneditine	20	Grinnell	0
Carroll, WI	26	Concordia, NE	14
Central Arkansas	26	Carthage	17
Central Missouri	27	SW Oklahoma	21
Coe	35	Missouri Southern	20
Dayton	48	Lawrence	6
East Central Oklahoma	24	Anderson	6
Emporia State	22	Cameron	22
Friends	21	Missouri Western	21
Georgetown, KY	34	Kansas Wesleyan	10
Gustavus Adolphus	24	Lincoln	6
Harding	21	St. Olaf	10
Headberg	24	Iowa Wesleyan	20
Hillsdale	27	Muskingum	23
Indianapolis	26	Ferris	7
Kearney	26	St. Joseph's	14
Midwestern	23	Moorhead	22
NE Oklahoma	27	Evangel	22
Nebraska Wesleyan	21	Arkansas-Monticello	6
North Dakota State	28	Missouri Valley	14
North Dakota U.	24	Augustana, SD	7
NW Missouri	28	South Dakota State	10
Saginaw Valley	26	Missouri-Rolla	17
SE Oklahoma	24	Northern Michigan	17
Sioux Falls	26	Ouachita	20
St. Ambrose	23	Sioux Falls	20
St. Cloud	23	Northwood	20
St. John's, MN	24	Nebraska-Omaha	17
St. Mary, KS	23	Carleton	7
St. Norbert	26	Belhany, KS	21
SW Minnesota State	31	Monmouth	13
Wayne State, MI	24	Peru	13
Westmar	24	Vanderparso	14
Westminster	27	Hastings	15
Wheaton	22	Findlay	13
William Jewell	30	Illinois Wesleyan	20
Wittenberg	23	Central Methodist	7
		Wooster	10

Other Games - South & Southwest

Albany, GA	23	Livingston	10
Arkansas Tech	41	McMurry	6
Carson-Newman	24	Wingate	14
Catawba	26	Mars Hill	14
Central State, OH	24	Alabama A & M	13
Centre	30	Marshall	7
Clark	27	J.C. Smith	14
East Texas	42	Southern Arkansas	7
Elon	27	Fayetteville	6
Emary & Henry	20	Anderson, VA	14
Gardner-Webb	17	Newberry	20
Guilford	23	Hampden-Sydney	20
Jacksonville State	35	West Georgia	12
Mississippi College	38	Handerson	7
Rhodes	28	Davidson	13
Sacramento State	23	Abilene Christian	14
Savannah State	33	Morhouse	7
Shenandoah	26	Glenville	17
Slippery Rock	24	Fairmont	17
Texas A & I	22	Portland State	21
Tuskegee	24	Morris Brown	7
Union, KY	22	Lambuth	20
Valdosta	23	Fort Valley	10
West Virginia Wesleyan	33	West Virginia State	21
Winston-Salem	24	Virginia State	15
Wofford	26	Lenoir-Rhyne	13

Other Games - Far West

Adams State	23	Western State	20
Cal Poly	23	Sonoma	17
Cal-Davis	21	Santa Clara	17
Humboldt	26	Azusa	21
LaVerne	28	Whittier	12
Lewis & Clark	21	Calif. U., OR	14
Monte Park	24	Claremont	6
Millisaps	30	Colorado College	7
Northern Colorado	24	Mankato	22
Occidental	26	Romona	14
Portland	21	Linfield	14
Redlands	24	San Diego U.	17
Santa Barbara	24	Cal Lutheran	13
Southern Utah	23	Eastern Oregon	15
St. Mary, CA	34	Hayward	21
Whitworth	23	Eastern Oregon	14

Proudly Presented By:

Muleshoe Co-Op Gins

Charles Moraw, Mgr.

272-4794

**Higginbotham
-Bartlett Co.**
215 Main 272-3351

**Kwikset
Lockset
\$9⁹⁵**

Washington vs. Nebraska

**MISSION
CABLE**
208 W. 2nd (806)272-3310
Muleshoe, Texas 79347

FALL '91 CABLE EXPRESS!

- FREE Connection to HBO or HBO & Cinemax
- 30-Day FREE Trial of HBO or HBO & Cinemax!
- Big Savings on Great Entertainment! expires October 11, 1991

V.P.I. vs. South Carolina

**Church's
CHICKEN**
1411 W. Amer. Blvd. 272-5581

**We Support The
Muleshoe Mules
100%**

Tulane vs. Rice

Ask Us About Family Insurance Review!
Call Ricky Barrett or David Tipps

FARM BUREAU TEXAS

Bailey County Farm Bureau

- LIFE • CROP
- AUTO • HOME

1612 W. Amer. Blvd. 272-4567
Farwell vs. Hart

The Spudnut Shop
The Upper Crust of the Donut World
THE ORIGINAL POTATO FLOUR DONUT

Check Our Weekly Luncheon Specials
Mon. - Sat. 5 a.m. - 2 p.m.
328 South Main Street
Muleshoe, Tx. 272-3542

California vs. Arizona

FOOTBALL CONTEST
Grand Prize: \$150⁰⁰

Weekly Prizes:

1st **\$10** 2nd **\$7⁵⁰** 3rd **\$5⁰⁰**

Weekly Winners
1st. R.G. Wilson
2nd. Tom Burgess 3rd. James Hanson

Leal's
1606 W. Amer. Blvd. 272-3294

**Backing The Mules
100%**

Closed On Mondays
South'n Mississippi vs. Colorado State

Bailey Gin Co.
946-3397

-owners-
Don Heathington
Peanut Hawkins
Doyce Turner

Peanut Hawkins, mgr.
Dimmitt vs. Amarillo River Road

Contest Rules:

1. IN EACH ADVERTISEMENT YOU WILL FIND A GAME LISTED. CIRCLE THE TEAM YOU THINK WILL WIN. The person's score that most closely matches the TIE BREAKER SCORE will be declared the winner. If several persons are still tied the prize money will be split.
2. The contestant must be 12 years of age or older.
3. Only one entry per person may be made for any one contest.
4. Bring your entry by the *The Journal* office by 5:00 p.m. Friday, or if mailed, the entry must be postmarked no later than 5:00 p.m. Friday. Write "FOOTBALL CONTEST" on the mailed entry, and mail to P.O. Box 449, Muleshoe, Texas 79347.
5. Circle the Winners and WRITE IN THE SCORE of the tiebreaker games. This score will be used to break weekly as well as determine the grand prize winner. Decision of *The Journal's* scoring judges will be final.
6. Check the team you think will win; 10 points for first place, 6 points for second place and 4 points for third place.
7. To count for the grand prize, entries must be on official blank printed in the paper.

Western Drug Co.
114 Main 272-3106

"For All Your Prescription Needs Visit The Friendly People At Western Drug"

Littlefield vs. Snyder

Henry Insurance Agency, Inc.
KENNETH R. HENRY
CERTIFIED INSURANCE COUNSELOR
REAL ESTATE BROKER

111 W. Ave. B 272-4581
Wyoming vs. Texas Tech

Stacey, JoAnn and Staff
**Backing The Mules
100%**

Pizza Hut
1412 W. Amer. Blvd. 272-4213
Houston vs. Illinois

Viola's Restaurant
**For The Best Mexican Food
Come To Viola's**
Open 11:00 a.m. - 9:30 p.m.
Closed On Tuesdays

2002 W. Amer. Blvd. 272-3838
Indiana vs. Kentucky

Official Entry Blank

Name _____
Address _____
Phone _____

TIEBREAKERS

T.C.U. vs. Oklahoma State
Texas vs. Auburn

Wilson Drilling & Southwestern Geothermal
Box 405 272-5521
Stanley Wilson Dee Puckett
Tx. Lic. 02628W
NM. Lic. WD1152
Texas A&M vs. Tulsa

Bob Stovall Printing
221 E. Ave. B. 272-3373

**No Job Too Large
Or Too Small!**

**Come By And Visit With Us
For All Your
Commercial Printing!**

Southern California vs. Arizona State

MULESHOE MULES Varsity Schedule		JUNIOR VARSITY Schedule		FRESHMEN Schedule	
Sept. 6	BROWNFIELD H 8:00	Sept. 5	BROWNFIELD T 7:00	Sept. 5	BROWNFIELD T 5:00
Sept. 13	IDALOU T 8:00	Sept. 12	IDALOU H 8:00	Sept. 12	FRIONA T 5:30
Sept. 20	DENVER CITY** H 8:00	Sept. 19	DENVER CITY T 8:30	Sept. 19	DENVER CITY T 5:00
Sept. 27	COOPER T 8:00	Sept. 26	COOPER H 8:30	Sept. 26	COOPER H 5:00
Oct. 4	RIVER ROAD H 8:00	Oct. 3	RIVER ROAD T 8:30	Oct. 3	RIVER ROAD T 5:00
Oct. 11	DIMMITT** H 7:30	Oct. 10	DIMMITT* T 7:00	Oct. 10	DIMMITT* T 5:30
Oct. 18	TULIA* T 7:30	Oct. 17	TULIA* H 7:00	Oct. 17	TULIA* H 5:30
Oct. 25	FLOYDADA* T 7:30	Oct. 24	FLOYDADA* H 7:00	Oct. 24	FLOYDADA* H 5:30
Nov. 1	LITTLEFIELD* H 7:30	Oct. 31	LITTLEFIELD* T 7:00	Oct. 31	LITTLEFIELD* T 5:30
Nov. 8	FRIONA* T 7:30	Nov. 7	FRIONA* H 7:00	Nov. 7	FRIONA* H 5:30

* Homecoming ** District Games ** Parents Night

WAT SERVICES INC.
319 E. American Blvd.
MULESHOE, TEXAS 79347

**Mobile Communications
Two-Way Radio Repair**

GARY PARKER
Technician
Muleshoe - 806-272-4888
Hereford - 806-364-7311

San Diego State vs. Air Force

Combination Motors And Salvage
Gerry Pierce

Day: 806-272-4458
Night: 806-272-5057

Rt. Box 240
Muleshoe, Tx. 79347

Three Way vs. Meadow

Scoggin Ag Center, Inc.
1532 W. Amer. Blvd. 272-4613

Kearney Scoggin
FOR YEAR - ROUND PROTECTION AGAINST BUGS, USE THE PROVEN INSECTICIDE

CIA
A Latex Insecticide coating, goes on like paint, stays where it is applied and keeps working for up to two years.

New Mexico vs. Nevada-Las Vegas

Muleshoe Floor Covering
122 Main St. 272-3555

Come By And See Curtis or Shelli Carpenter For All Your Floor And Wall Needs!

Rutgers vs. Northwestern

Connie's Place
121 Main 272-3126
Hrs: 5 a.m. - 4 p.m. Mon. - Fri.
Sat. 5 a.m. - 2 p.m.

Daily Buffet
Includes Salad Bar & Cobbler
Serving Breakfast Daily
Connie Dominguez, Owner
Canyon vs. Friona

Grants are Part of Project CARE

We all know what it's like to see a frail-looking older man or woman moving slowly along the aisle of a supermarket or sitting on the porch of a sagging old home and to wonder: Who cares for this person? Who would know if they were sick or hurt? If they needed help, who would they turn to?

Soon, as many as three Texas communities will be able to use \$20,000 cash grants from the Texas Department on Aging (TDoA) and the federal Administration on Aging (AoA) to help transform their concern for their elderly, frail citizens into meaningful, coordinated systems of support.

These grants are part of a national AoA initiative called Project CARE, which is intended to encourage the development of local coalitions made up of groups that normally don't focus upon the needs of the elderly.

"Our new U.S. Commissioner on Aging, Dr. Joyce Berry, believes volunteerism and community support for the elderly can be increased by 30 percent or more if the states will just publicize the need for it and offer a little startup funding," said TDoA Executive Director Polly Sowell. "That's what these grants are meant to do. We're asking communities to mobilize non-traditional coalitions to help seniors who are at risk of injury, financial catastrophe or loss of independence."

Examples of the non-traditional organizations who can apply for these grants include (among others) civic groups and clubs, local governments, business or labor affiliations, churches, educational institutions, foundations and charities. The coalitions would be made up of similar groups, as well as individual volunteers.

For the purposes of the grants, a "community" will be defined as:

- An inner city neighborhood in a large city or metropolitan area;
- A medium-sized or small city; or a rural area.

Applicants will be asked to provide general information about the frail and at-risk seniors in their areas, and to identify their major needs. They must also describe in detail how their proposed local coalitions would work together to address unmet needs like transportation, adult day care, chore assistance, home repair and others.

"It's important to understand that you don't have to be apart of the human services bureaucracy to apply for these grants," Sowell noted. "In fact, we're actively soliciting proposals from people who have never administered a program for the elderly. The main things we're looking for are solid, well thought-out plans, a proven ability to coordinate diverse groups of people working toward a common goal, and the ability to keep the program going once it's started."

The grant will include \$20,000 in first-year funding, as well as second and third-year funding based on an evaluation of first-year performance. Applicants will be required to provide 50% match. This match can consist of cash or commodities such as office space, supplies, volunteer time, printing, postage or telephone service.

The deadline for application is September 16, 1991. For more information, contact James Grabbs or Linda Heath at the Texas Department on Aging, P.O. Box 12786, Capitol Station, Austin, Tx. 78711. Grabbs and Heath can also be contacted by telephone at (512) 444-2727.

Every day, however trifling, seems too long to a man in haste.

-Seneca.

It's no use making haste: the thing to do is to set out in time.

-Jean de la Fontaine.

Nursing home News

by: Joy Stancell

Sunday afternoon the Muleshoe Singers came for Gospel Music and singing and fellowship.

Tuesday afternoon Olive Cox, Claudine Embry, Bonnie Green, Beth Watson and Laverne James came to shampoo and set the ladies hair.

Tuesday afternoon ladies from the Ave. D. Church of Christ brought and served freshly baked homemade pies. What fun and enjoyment it brought to residents as well as staff to choose and eat from the wide variety of delicious and beautiful pies. Thank you, ladies.

Melvin Griffin hosted our Men's Coffee Time Wednesday

ENMU Theatre Season Tickets On Sale

Season ticket sales for the 1991-92 ENMU Theatre and Dance Season Begin September 18 and continue through September 28.

The 1991-92 season is the season of classics, beginning with the Shakespearean farce, "The Comedy of Errors," September 26-28 and the Tennessee Williams' classic "Cat on a Hot Tin Roof," November 14-16.

The season continues in the spring semester with the musical comedy "Once Upon a Mattress," February 13-16 along with the electrifying drama "Agnes of God," April 1-5. The year will close with the last of the Neil Simon trilogy "Biloxi Blues," April 23-25.

Season ticket prices are \$20 for general admission, \$16 for senior citizens, \$15 for Pre-College and \$10 for ENMU

Students-a 20 percent savings, or 5 shows for the price of 4. To purchase season tickets, come by the Theatre Box Office or call 562-2710 for more information.

Patients in Muleshoe Area Medical Center

SEPTEMBER 13

Jon Adam Orozco, Steven Hatfield, Delter Wenner, Comedith Colson, Anna Contreras, Dee Clements, Shirley Martinez
SEPTEMBER 14

Anna Contreras, Dee Clements, Shirley Martinez
SEPTEMBER 15

Ryan Saylor, Doyle Turner, Eugene Tigie, Dee Clements

PUBLIC NOTICE BRIEF EXPLANATORY STATEMENTS OF PROPOSED CONSTITUTIONAL AMENDMENTS SPECIAL ELECTION NOVEMBER 5, 1991

PROPOSITION NO. 1 ON THE BALLOT

House Joint Resolution 114 proposes a constitutional amendment that would authorize home rule cities having a population of 5,000 or fewer inhabitants to amend their city charters by a majority vote of a city's qualified voters at an election held for that purpose. The amendment makes clear that home rule cities that have declined in population below the population required to initially adopt a charter may nevertheless continue to amend their charters.

The proposed amendment will be described on the ballot as follows: "The constitutional amendment allowing home-rule cities with a population of 5,000 or less to amend their charters by popular vote."

PROPOSITION NO. 2 ON THE BALLOT

House Joint Resolution 10 proposes a constitutional amendment that would allow the legislature to authorize the Texas Department of Transportation to expend money, from any source available, for the costs of the turnpikes, toll roads, or toll bridges of the Texas Turnpike Authority, provided that any monies expended from the state highway fund shall be repaid to the fund from tolls or other turnpike revenue.

The proposed amendment will be described on the ballot as follows: "The constitutional amendment mandating the repayment to the Department of Transportation of monies expended to assist the Texas Turnpike Authority in the construction, maintenance, and operation of turnpikes, toll roads and toll bridges."

PROPOSITION NO. 3 ON THE BALLOT

Senate Joint Resolution 26 proposes a constitutional amendment that would authorize the Veterans' Land Board to invest, as authorized by law, moneys of the Veterans' Land Fund which are not immediately committed to the payment of principal and interest on bonds issued by the Veterans' Land Board, the purchase of lands, or the payment of expenses. Investment of such moneys would no longer be restricted to investments in bonds or obligations of the United States. The proposed amendment would also authorize the Veterans' Land Board to invest, as authorized by law, moneys of the Veterans' Housing Assistance Fund which are not immediately committed to the payment of principal and interest on general obligation bonds issued by the Veterans' Land Board for the benefit of the Veterans' Housing Assistance Fund, the making of home mortgage loans, or the payment of expenses. Investment of such moneys would no longer be restricted to investments in bonds or obligations of the United States. The proposed amendment gives the legislature power to implement the amendment and to delegate such duties and authority to the Veterans' Land Board as it deems necessary.

The proposed amendment will be described on the ballot as follows: "The constitutional amendment to authorize the legislature to further implement and enhance the administration of the veterans' housing assistance and land programs and to expand the investment authority of the Veterans' Land Board."

PROPOSITION NO. 4 ON THE BALLOT

Senate Joint Resolution 4 proposes a constitutional amendment that would allow the legislature to authorize the issuance of a maximum of \$1.1 billion in general obligation bonds. The proceeds of the bonds are to be used to acquire, construct, or equip new prisons and substance abuse felony punishment facilities, mental health and mental retarda-

tion institutions, and youth corrections institutions, to repair and renovate existing facilities of those institutions and to acquire, repair, or renovate other facilities for use as state prisons or substance abuse felony punishment facilities. The \$1.1 billion is in addition to the \$900 million currently authorized by the constitution to be expended on bond issues for facilities of correctional and mental health and mental retardation institutions. The bonds would constitute a general obligation of the state. The bonds and interest on the bonds would be paid from the first money coming into the state treasury that is not otherwise appropriated by the constitution, less any amount in a sinking fund at the end of the preceding fiscal year that is pledged to payment of the bonds or interest.

The proposed amendment will be described on the ballot as follows: "The constitutional amendment authorizing the issuance of up to \$1.1 billion in general obligation bonds for acquiring, constructing, or equipping new prisons or other punishment facilities to confine criminals, mental health and mental retardation institutions, and youth corrections institutions, for major repair or renovation of existing facilities of those institutions, and for the acquisition of, major repair to, or renovation of other facilities for use as state prisons or other punishment facilities."

PROPOSITION NO. 5 ON THE BALLOT

Senate Joint Resolution 39 proposes a constitutional amendment that would allow a county, junior college district, or municipality to exempt tangible personal property from ad valorem taxation if: (1) the property is acquired or brought into the state in an enterprise zone to be forwarded outside the state, (2) the property is assembled, stored, repaired, maintained, manufactured, processed, or fabricated in the enterprise zone, (3) the property is transported outside the state not later than 175 days after being acquired or brought into an enterprise zone, and (4) the person who acquired or brought the property into an enterprise zone is a qualified business. A county, junior college district, or municipality may exempt such property by entering into a written agreement with a qualified business that states the duration of the exemption and the terms on which the exemption is granted. Any action to exempt property must be taken before April 1 of the first year in which the property would otherwise be taxed. The term "enterprise zone" means an area that (1) has been designated as such by a state agency responsible for economic development, and (2) has pervasive poverty, unemployment, and economic distress. The term "qualified business" means a business that meets the qualification established by general law, and requires that the qualified business is actively engaged in a new business in the enterprise zone or is expanding a business that is already active in the enterprise zone. An enterprise zone is created to foster economic development in an area of pervasive poverty and unemployment.

The proposed amendment will be described on the ballot as follows: "The constitutional amendment authorizing the exemption for ad valorem taxes of certain property in an enterprise zone."

PROPOSITION NO. 6 ON THE BALLOT

Senate Joint Resolution 8 proposes a constitutional amendment that would establish a Texas Ethics Commission with the powers and duties provided by law. The commission would consist of eight appointed members selected as follows: two members of different political parties appointed by the governor from a list of at least ten names submitted by the members of the house of representatives from each major political party; two

members of different political parties appointed by the governor from a list of at least ten names submitted by the members of the senate from each major political party; two members of different political parties appointed by the speaker of the house of representatives from a list of at least ten names submitted by the members of the house from each major political party; and two members of different political parties appointed by the lieutenant governor from a list of at least ten names submitted by the members of the senate from each major political party. A major political party is a political party required by law to hold a primary. With the exception of the initial appointees, commission members would serve for four-year terms. A member who has served for one term and any part of a second term would not be eligible for reappointment. The commission would be authorized to recommend the salary of the members of the legislature and may recommend that the salary of the speaker of the house of representatives and the lieutenant governor be set at an amount higher than that of other members. If the commission recommends a change in salary, the voters would be authorized to accept or reject the salary change at the next general election for state and county officers. If the voters approve the recommended salary, that salary would take effect January 1 of the next odd-numbered year; if the voters reject the recommended salary, no change in salary would occur. The commission would set the per diem of the members of the legislature and of the lieutenant governor. The per diem could be raised or lowered biennially as necessary to pay members' costs, but could not exceed the amount allowed as of January 1 that year as a federal income tax deduction for living expenses incurred in a legislative day in connection with a member's business as a legislator, disregarding any federal income tax exception for legislators residing near the Capitol. The commission would have other powers and duties provided by the commission's enabling act (Senate Bill 1, 72nd Legislature, Regular Session). The amendment would also provide that an increase in the emoluments of the office of Lieutenant Governor would not make a legislator ineligible to serve in the office of Lieutenant Governor.

The proposed amendment will be described on the ballot as follows:

"The constitutional amendment creating the Texas Ethics Commission and authorizing the commission to recommend the salary for members of the legislature and the lieutenant governor, subject to voter approval, and to set the per diem for those officials, subject to a limit."

PROPOSITION NO. 7 ON THE BALLOT

Senate Joint Resolution 6 proposes a constitutional amendment that would allow the board of trustees of each statewide public retirement system to invest the funds of the system in such manner as the board considers prudent. The board would no longer be limited to investing the funds of the system in securities.

The proposed amendment will be described on the ballot as follows:

"The constitutional amendment to allow the board of trustees of a statewide public retirement system to invest the funds of the system in a manner that the board considers prudent."

PROPOSITION NO. 8 ON THE BALLOT

Senate Joint Resolution 21 proposes a constitutional amendment that would permit the legislature to create debt by or on behalf of the state if the legislature submitted the debt question to the voters of the state in the form of a proposition and a majority of those voting approved the proposition. The legislature may call the election, by joint resolution approved by at least two-thirds of the members of each house, during any regular session or during any special session if the subject of the proposition is included in the Governor's proclamation for that special session. A proposition must clearly describe the amount and purpose for which debt is to be created and must describe the source of payment for the debt. The amount of debt stated in the proposition may

not be exceeded and may not be renewed unless the right to exceed or renew is stated in the proposition. The legislature may enact laws necessary to implement the authority granted by a proposition. A law enacted in anticipation of the election on a proposition is valid if, by its terms, it is enacted subject to approval of the related proposition. State debt that is created following voter approval of a proposition and that is approved by the Attorney General is incontestable for any reason.

The proposed amendment will be described on the ballot as follows:

"The constitutional amendment authorizing the voters of this state to consider state debt questions in the form of ballot propositions that must clearly describe the amounts, purposes, and sources of payment of the debt only after approval of the propositions by a two-thirds vote of each house of the legislature."

PROPOSITION NO. 9 ON THE BALLOT

Senate Joint Resolution 11 proposes a constitutional amendment that would authorize the commissioner of the General Land Office to issue patents for certain public free school fund land for which there is not a valid transfer of title from either the State or the Republic of Texas to a private party. A patent is a document of title issued by the state. On application to the School Land Board, a person is entitled to receive a patent if: (1) the land is surveyed public free school fund land, (2) the land was not patentable under the law before the adoption of this proposed amendment, (3) the person acquired the land without knowledge of the title defect of the State of Texas and the Republic of Texas and held the land under color of title, the chain of which dates from at least January 1, 1941, (4) the person has a recorded deed on file in the county courthouse and, in conjunction with his predecessor in interest, has claimed the land for at least fifty years as of January 1, 1991, and (5) the person, in conjunction with his predecessor in interest, for at least 50 years has paid taxes on the land together with all interest and penalties associated with any delinquency. If the applicant is denied a patent, the applicant may file suit against the School Land Board in a district court in the county where the land is located within 60 days from the date of denial. The proposed amendment does not apply to beach land, submerged land, or islands, and may not be used to resolve a boundary dispute. The proposed amendment also does not apply to land found by a court to be state-owned or to land on which the state has given a mineral lease that is in effect when a patent is sought. A patent under this proposed amendment for land within five miles of mineral production shall reserve minerals to the state in the manner provided by law for reservations of minerals in sales to claimants of unsurveyed school land within five miles of production. An application for a patent under this proposed amendment must be filed with the School Land Board before January 1, 1993.

This proposed constitutional amendment is similar to the version of article VII, section 4A, that was in effect between 1981 and 1990. The main difference is that under the earlier version the applicant for a patent to land had to have a chain of title that dated back to at least as early as January 1, 1932.

The proposed amendment will be described on the ballot as follows:

"The constitutional amendment authorizing the commissioner of the General Land Office to issue patents for certain public free school fund land held in good faith under color of title for at least 50 years."

PROPOSITION NO. 10 ON THE BALLOT

Senate Joint Resolution 15 proposes a constitutional amendment that would allow the legislature to pass general laws to exempt property owned by a nonprofit corporation organized to supply water or provide wastewater service from ad valorem taxation. A nonprofit corporation would be eligible for the exemption if its bylaws provide that

on dissolution, the assets remaining after the discharge of the corporation's indebtedness will be transferred to an entity providing water supply or wastewater service, or both, which is exempt from ad valorem taxation. The transferred assets must be property that is reasonably necessary for and used for water supply and wastewater services.

The proposed amendment will be described on the ballot as follows:

"The constitutional amendment authorizing the legislature to exempt from ad valorem taxes certain property of a nonprofit corporation that supplies water or provides wastewater service."

PROPOSITION NO. 11 ON THE BALLOT

House Joint Resolution 8 proposes a constitutional amendment that would allow the legislature to pass laws to authorize the State of Texas to operate lotteries and to enter into a contract with one or more legal entities that will operate lotteries on behalf of the State of Texas.

The proposed amendment will be described on the ballot as follows:

"The constitutional amendment authorizing a state lottery."

PROPOSITION NO. 12 ON THE BALLOT

Senate Joint Resolution 34 proposes a constitutional amendment that would increase the total amount of bonds that may be issued by the Texas Water Development Board to provide wholesale and retail water and wastewater facilities to economically distressed areas of the state. The proposed amendment increases the maximum principal amount of the bonds from 20 percent to 50 percent of the \$500 million amount authorized by article III, section 49-d-7, of the Texas Constitution. The proposed amendment would increase the maximum aggregate dollar amount of bonds that the Texas Water Development Board could issue from \$100 million to \$250 million.

The proposed amendment will be described on the ballot as follows:

"The constitutional amendment to increase from 20 percent to 50 percent the percentage of Texas water development bonds previously authorized by Texas voters that may be issued for economically distressed areas."

PROPOSITION NO. 13 ON THE BALLOT

Senate Joint Resolution 2 proposes a constitutional amendment that would allow the legislature to pass general laws authorizing Texas Higher Education Coordinating Board or its successor to issue and sell up to \$300 million of general obligation bonds to finance education loans to students. The maximum net effective interest rate to be borne by the bonds would be set by law. The amendment would also authorize the legislature to provide for the investment of bond proceeds and to establish an interest and sinking fund to pay the bonds and provide for the investment of such fund. Bonds authorized under this amendment would be paid from the first money coming into the treasury in each fiscal year that is not otherwise appropriated by the constitution, less any amount in an interest and sinking fund established at the end of the preceding year that is pledged to the payment of the bonds or interests.

The proposed amendment will be described on the ballot as follows:

"The constitutional amendment providing for the issuance of general obligation bonds not to exceed \$300,000,000 to continue existing programs to provide educational loans to students, with repayments of student loans applied toward retirement of the bonds."

Estos son los informes explicatorios sobre las enmiendas propuestas a la constitución que aparecerán en la boleta el día 5 de noviembre de 1991. Si usted no ha recibido una copia de los informes en español, podrá obtener una gratis por llamar al 1/800/252/8683 o por escribir al Secretario de Estado, P.O. Box 12060, Austin, Texas 78711.

Published by the office of the Secretary of State of Texas

Azteca Milling Co.

Is Now Contracting

White Food Corn

Please Contact

Luis Flores

at

806-293-0110

Plainview, Texas

CLASSIFIEDS 272-4536

CLASSIFIED RATES

15 Words & Under
Minimum Charge \$2.30
Thereafter \$2.00
16 Words & Over
1st Insertion 15 cents per word
2nd Insertion 12 cents per word
3rd Insertion 10 cents per word

CLASSIFIED DISPLAY RATES

\$1.75 Per Column Inch
DEADLINES
12 noon Tues.
For Thursday Paper
12 noon Friday
For Sunday Paper

To receive the reduced rate after the first insertion ad must run continuously.

We reserve the right to classify, revise, or reject any ad. We are not responsible for any error after ad has run once.

1. Personals

CONCERNED
About Someone's Drinking?
HELP IS AVAILABLE
through Al-Anon
Call 272-2350 or 965-2870 or come to visit Tuesday and Thursday nights, 8:00 p.m. & through AA call 965-2870 or come visit Tuesday nights, 8:00 at 620 W. 2nd, Muleshoe.

Lose weight now, feel terrific with The Micro Diet, it's safe, affordable and it works. Call Independent Advisor--Ruth 1-800-858-7413.

Reward for information on whereabouts and recovery of a 1000 lb. black steer with white face. Lost 1 mile east of Muleshoe on August 24, 1991. Call (806) 894-3573. F1-36s-4tc

LOST DOG
Lost 1/2 Boxer and 1/2 Lab. Black with white chest and white tip on tail answers to the name of Jim. Lost in the vicinity of Old Corral. Call Houston or Margaret Johnson, 272-5501 or 272-3794. J1-38t-2tc

3. Help Wanted

TELEPHONE COMPANY JOBS
Start \$7.80-\$15.75/hr. your area. Men and women needed. No experience necessary. For information, call 1-900-740-4562. ext. 8265 6 am-8 pm-7 days-\$12.95 fee. E3-37s-3tp

WANTED: Part-time Sales Clerk. Apply in Person--Ince Oil Co., Inc. 102 W. American Blvd. 12-38t-2tc

About the only thing one can't buy these days is a reputation.
Service clubs sometimes do not live up to their designation.

4. Houses For Rent

HOUSE IN COUNTRY FOR RENT 3-4 bedrooms, 3 baths, den with fireplace, double garage, approx. 2,000 sq. ft. Call 806-435-5578 or 806-965-2758 after 6 p.m. M4-36t-8tc

11. For Sale Or Trade

FOR SALE: Wheat Seed--Cleaned & Sacked-60 lb. sacks. \$5.50/bushel. Call 965-2193 or 965-2776 11-29t-8tp

PIANO FOR SALE
Wanted: Responsible party to take on small monthly payments on piano. See locally. Call Manager at 800-635-7611. M11-37t-6tc

15. Misc.

FOR RENT: Large Self Storage rooms with 24 hour a day access. Call J & J Self Storage at 272-4307. S15-37t-tfc

BIRD DOG PUPPIES TO GIVE AWAY TO A GOOD HOME.
272-3540

WANTED!
Wheat Pasture. We will provide caretaker.
a.m. 806-354-8936
p.m. 806-372-8018
Bill

ROOFING
Call Collect (505) 762-8335
TEEL ROOFING
A division of Paul Teel Const't Co. Clovis, N.M. Referrals in Muleshoe & Elsewhere
PLEASE CALL FOR FREE ESTIMATE!!

BRIEFS
VA mortgage rate lowered to 9 percent.
Pentagon: MIA photos linked to Soviet magazine.
Bush: New wetlands policy doesn't break '88 promise.

Quit smoking and improve your circulation.

It's never too late to quit smoking. Call 1-800-4-CANCER
His Handicap
Little Bobbie--Aw, I could walk that tight rope as well as the girl in the circus if it wasn't for one thing.
Little Jimmie--What's that?
Little Bobbie--I'd fall off.

Lundberg:

Americans should be disturbed by the recent warning from Dr. George Lundberg, editor of the American Medical Association's newspaper.

Lundberg says there's racism aplenty on the American medical care scene. He says it's a long standing problem, and that the main and urgent need today is to extend health care to an estimated 31 to 37 million Americans who don't have it.

Congress is now studying reforms and changes. Some proposals are that more employers be compelled to provide health care to employees. Others favor a government-controlled health care program similar to Canada's existing program.

Whatever reform and expansion is chosen, it deserves a fair trial and public support. There's no place for racism in the health care of Americans.

A smile from a cute thing often brightens up the day.



SMILES

Got Ya
"If a bookie, a card shark, a confidence man, a burglar, a bootlegger all got under one umbrella at one time, which one got wet?"
"I give up, which one?"
"No one, it wasn't raining."

More To Do
"When first we were married you were only too glad to wash the dishes."
"I know, but we only had two dishes then."

Boys Will Be Boys!
Little Tom had just been vaccinated. When the doctor tried to put a bandage over the spot Tom insisted that he wanted the bandage on the other arm.

"Why Tom, the bandage should be put on the sore arm so the boys at school won't hit it," the doctor said.
"Put it on the other arm, Doc," Tom replied. "You don't know those guys."

15. Misc.

Fresh Vegetables DVJ FARMS

6 Miles South of Farwell on State Line Road 348
CALL (806) 825-3420

We grow tomatoes, chili peppers, watermelon, green beans, pickling and slicing cucumbers, squash, okra and cantaloupe.

8. Real Estate

8. Real Estate

8. Real Estate

8. Real Estate

Bingham & Nieman Realty 272-5286

116 E. Ave. C. George Nieman, Broker 272-5285

RICHLAND HILLS
PRICE REDUCED-IMMACULATE 3-2-2 Brick, Cent. A&H, built-ins, newly remodeled kitchen, FP, sunken lv. area w/cathedral ceiling, ceiling fans, earhtone carpets, storage !!!!!!!

3-3-2 Brick, Cent. A&H, built-ins, FP, Spklr. sys., storage-wkshp., fenced yd., much more!!!!!!

PRICED REDUCED-ASSUMABLE LOAN 9 1/2 A.P.R.-3-2-2 Brick, Cent. A&H, built-ins, FP, fans, workshop-storage, fenced yd. Make Offer

3-3-1CP HOME, Cent. A&H, built-ins, FP, spacious lv. area, loads of closets & storage, cov. patio, fenced yd., 2 st. bldgs.!!!!!!

3-2-1 Brick, Cent. A&H, built-ins, fans, fenced yd. \$40!!!!

NICE RESIDENTIAL LOTS/ \$5,000 UP....

Nice-3-2-1 Home, built-ins, heat pump, fans, storm windows, & doors, workshop-storage, fenced yd., & more. \$30's!!!!!!

NICE 3-3-2 Brick, Heath Pump, built-ins, FP, gameroom, sunroom, finished basement, 2,800+ sq. ft. of lv. area, fenced yd. & more. \$80's!!!!

PARKRIDGE-IMMACULATE 3-2-2 Brick, Heat Pump, built-ins, FP, nice finished basement, cov. patio, insul. & wired st.-workshop, fenced yd. GREAT VIEW!!!!

HIGH SCHOOL
2-1 Home, nicely remodeled kitchen & den, Cent., heat, fenced yd., large garage-shop. \$20's!!!!!!

HIGHLAND AREA
3-2-1 Brick, Cent. A&H, built-in, FP, Fenced yd. 2100+ lv. area, fenced yd., & st. bldg. MAKE OFFER!!!!!!

3-2-1 Home, wall furnace, window evap. fenced yd. \$20's!!!!

Nice 3-1-1, heat pump, nice carpets, fenced yd. Much More. \$30's Price Reduced LENAUE ADD.
3-2-1 ↑ 2CP HOME, storm windows & doors, built-ins, fans, MUCH MORE!!!!
2-2-2 Brick, Cent., A&H, built-ins, FP, spklr. sys., fenced yd. Price Reduced!!!!

TRAVEL UPDATE

By Connie Sherley.

Villa Favorita is enchanting art museum

Baron Heinrich Thyssen-Bornemisza had homes all over Europe, but as the name implies, Villa Favorita, the estate near Castagnola on Lake Lugano, was his pride.

He inherited a priceless art collection from his father, August Thyssen, who also founded the family fortune in iron and steel, and decided to build a gallery for the masterpieces at Villa Favorita. In 1948 the present Baron Hans Heinrich Thyssen opened the gallery to the public.

The Lugano municipal bus stops at the gates of Villa Favorita. A short walk enables visitor to savor 20 rooms built to showcase one of the world's finest private art collections.

The anterooms and staircases contain treasures, too, and even the furnishings are museum pieces.

Villa Favorita is open Friday through Sunday from Easter through October.

Swiss Miniatur near Lugano is a delight

The visitor to the delightful Swiss Miniatur at Melide, a short boat ride across the lake, from Lugano, feels like Gulliver in Lilliputian land.

Each Swiss canton's most picturesque features have been reproduced at 1/25 actual size. Villages, monuments and historic buildings are included in the project, which was started in 1959 and which has been expanded over the years to become one of the unique attractions of Europe.

Almost two miles of computerized model railways, as well as perfectly scaled boats, postal buses, trolleys and cars enhance the effects. At night the miniature kingdom is beautifully lighted.

Swiss Miniatur is open from mid-March through October. It's a treat for adults but a special delight for children.



The oldest known song written in English is a ballad called Judas. A manuscript of this survives from the 13th century.

"Pop Stars" Give Away Pop Music

This summer, Coca-Cola USA delivers the power of its long association with hit music to the consumer in a new way.

"Coca-Cola Pop Music," a huge compact disc giveaway and audio-cassette offer, combines the company's "pop stars"—Coca-Cola classic, diet Coke and Sprite—with some of pop music's hottest emerging artists.

The promotion begins in May and features:

- 5.6 million three-inch compact discs—available free inside specially marked "Pop Music" multipacks;
- nearly 100 million certificates for audiocassettes, redeemable for \$1.

The CDs and cassettes showcase Columbia and Epic recording artists—including some of the biggest new acts already soaring up the billboard charts.

Nineteen artists will star in the four volume Coca-Cola Pop Music CD series, including: Grammy Award-winners Shawn Colvin and Rosanne Cash, as well as C+C Music Factory, Will to Power and Celine Dion.

The Cover Girls, Candyman, Peabo Bryson and Ricky Van Shelton are among more than 85 Sony Music entertainers on the Pop Music cassette series.

Every specially marked soft drink carton contains either an actual CD or the cassette offer. One out of every 19 special multipacks fea-



Steve Koonin inspects a carton with a three-inch CD inside.

Approximately 100 million Pop Music multipacks will include an order form for any of the 10 separate cassettes, featuring pop, rock, jazz, country, urban, dance music and more.

"By turning multipacks into valuable music packs, we are providing exposure for dynamic new talent to the widest audience possible," said Steve Koonin, director of national promotions, Coca-Cola USA. "We've used music as a communication vehicle for decades, but this latest effort truly breaks new ground in the music world. No one has initiated an in-pack CD giveaway on a national basis before."

BRIEFS

Crime increases in postwar Iraq.

8. Real Estate

FOR SALE BY OWNER: Quiet country living with unbelievable amenities. 3-2-2, Central A & H, 2 living areas, Den with cathedral wood plank ceiling, skylights, rock fireplace, barn, workshop, oversized garage, orchard, satellite dish. Home with 4 acres or with 149 irrigated acres. South of Muleshoe. Phone 946-3440. E8-37t-tfc

NO DOWN PAYMENTS
New homes, 2 new loan programs. Gold Leaf Homes. 1-800-989-1445. G8-34s-11tc

8. Real Estate

NEW LISTING
For Sale--3,547 sq. ft. remodeled and renovated brick residence featuring spa and sunroom, located at 622 West 7th Street. Call Mike Caldwell at 272-7535 or 272-5146 for information. C8-32s-tfc

FARM FOR SALE
160 acres: two wells, circle sprinkler. 1833 sq. ft. home. 2000 sq. ft. insulated barn--call (806) 225-6325. 8-37t-8tp

BAILEY COUNTY IRRIGATED LAND FOR SALE
With irrigation equipment. Fall wheat planted. Owner will finance.
385-4487 day
385-5613 night

Henry Realty

111 W. Ave. B. 272-4581
Muleshoe, Tx.

2 bedroom, 1 bath, 1 car garage, fireplace, fenced yard, carpet, Lenau Addition \$15,000.00.

Spacious 2 bedroom, 2 bath with one car garage. Fireplace. Ready to move in.

New listing-2 bedroom, 1 bath, redone for qualified buyer.

3 bedroom, 2 bath, carport, spacious home outside city limits near city on highway. Lot is 85' X 402'. Metal building is 29' by 40'. Great setup for workshop.

COMMERCIAL PROPERTY
Ideal location on West American Blvd. 150' highway frontage. A great business opportunity.

Brick veneer restaurant 150 seating. Over 5000 sq. ft. with modern equipment. Ready for operation. Located on U.S. Highway 84 in Muleshoe. 7,000 sq. ft. paved parking. Excellent financing available for qualified buyer.

West American Boulevard 150' frontage. Priced to sell.

Commercial building 30'x52' located on 12th Street. Lot is 97' x 140' and paved. Come by for appointment to see.

Good Attendance At Bailey County West Plains Fair

Journal Photos



Chamber of Commerce INFORMATION---Carolyn Johnson, manager of the local Chamber of Commerce, and her husband, Buck, tend the Chamber of Commerce Information Booth at the fair Saturday.



CHIEF OF POLICE---Even Chief of Police Wayne Holmes watched a booth at the Bailey County South Plains Fair last weekend.

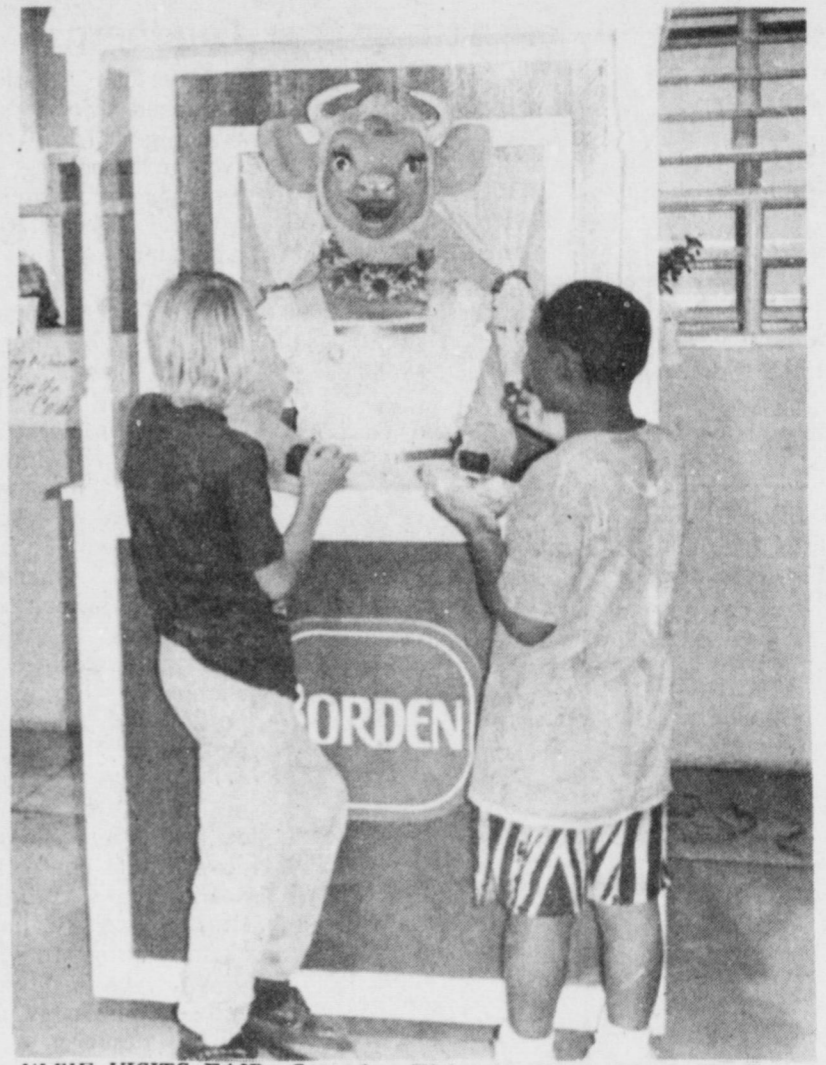

ELSIE VISITS FAIR---Saturday Elsie the Cow visited the Bailey County West Plains Fair and talked with the youngsters.



PET SHOW WINNERS---Stephanie Kirk showed her dog in the Pet Show last Saturday at the Bailey County West Plains Fair.



BOY SCOUTS---Mrs. Arnold Price, right, and Cub Master Betty Griswold, watches over the Boy Scout Booth at the Bailey County West Plains Fair Saturday.



BEST TRAINED DIVISION---Alice Cocker showed her Great Dane in the Pet Show Saturday.



SUPPORT THE GIRL SCOUTS---Mary Ann Ramirez and Linda Tosh sell Girl Scout cookies at the Bailey County West Plains Fair.



LITTLEST DOW---Blake Gable showed the littlest dog, a teacup poodle, in the pet show Saturday. He was the grand prize winner.



JENNYSLIPPERS BOOTH---Thursie Reid, left, and Rae Logg tend the Jennyslippers booth at the fair Saturday.



LABADOR ENTERS DOG SHOW---Terry Hutto and daughter showed their black labrador in the pet show Saturday.